

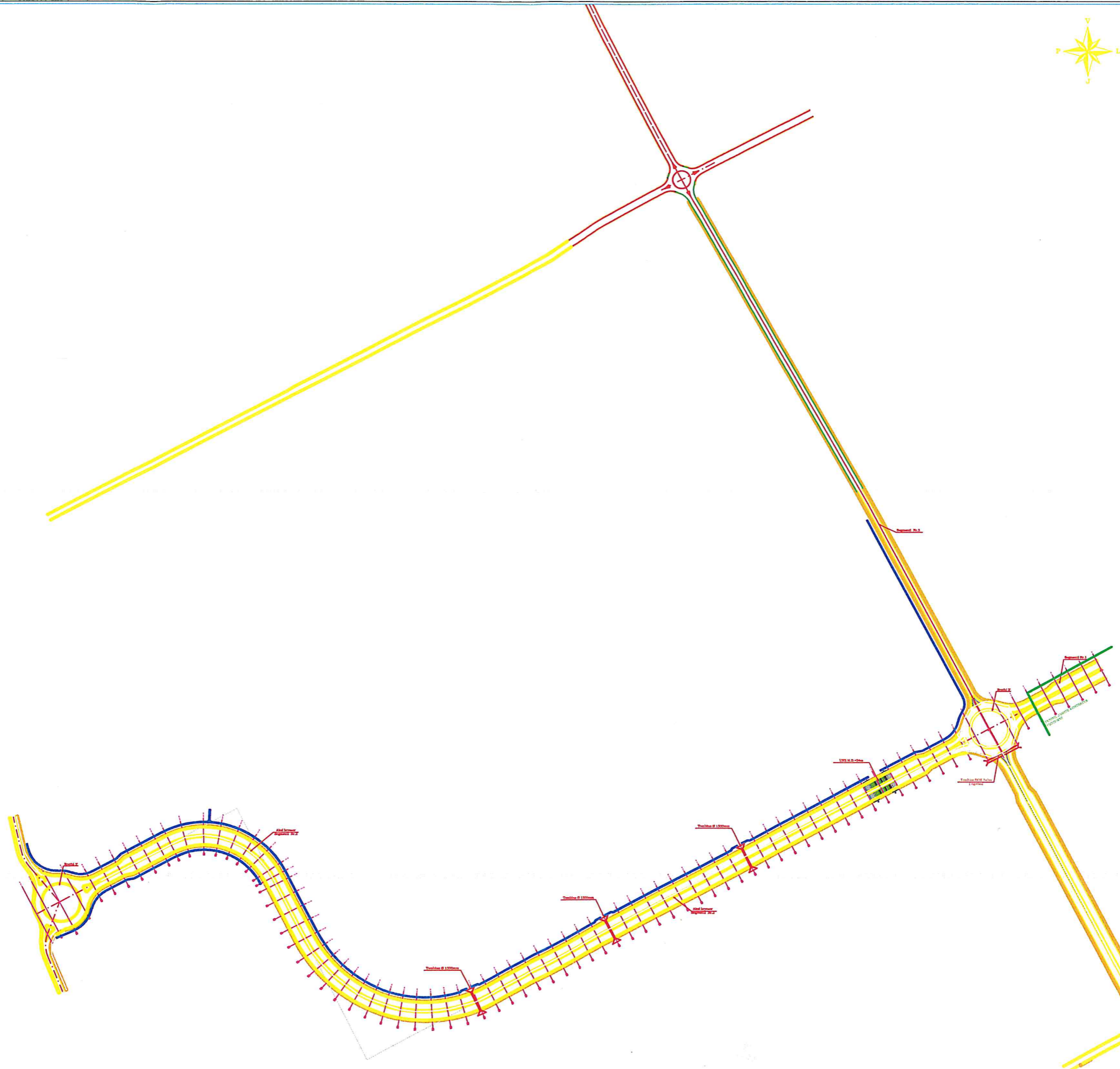

 ERUGA NE PROJEKT  
 AKSI I ERUGES



Titulli i Projektit  
 \_\_\_\_\_  
 \_\_\_\_\_  
 \_\_\_\_\_  
 \_\_\_\_\_  
 \_\_\_\_\_  
 \_\_\_\_\_

**MINISTRIA E INFRASTRUKTURES  
 DITE ENERGETIKE  
 AUTORITETI RRUGOR SHQIPTAR**  
Praga Sassi Prashit, Nr.23, Tirane - Shqipëri

Titulli i Projektit  
**"RISHIKIM PROJEKTI  
 NDRERTIM RRUGA PORTO ROMANO  
 DURRES, LOT 3 (VAZHDIMI)"**

Nr.  **"KLODIANA SH.P.K."**  
Shërbime Inxhinierike dhe Projektimore  
 Ing. YLLI KARATCI  
 Ing. HIKOLLAQ ALEKSI  
 Ing. EJONA BEZHANI  
 Ing. DENISA SHULLERI  
 Vite: \_\_\_\_\_

Nr. **RRJETI RRUGOR**  
 Titulli i Dokumentit  
**PLANVENDOSJA**  
 Data  
**MARS 2022** Skala  
**1 : 1500**  
**A.1 - 01**



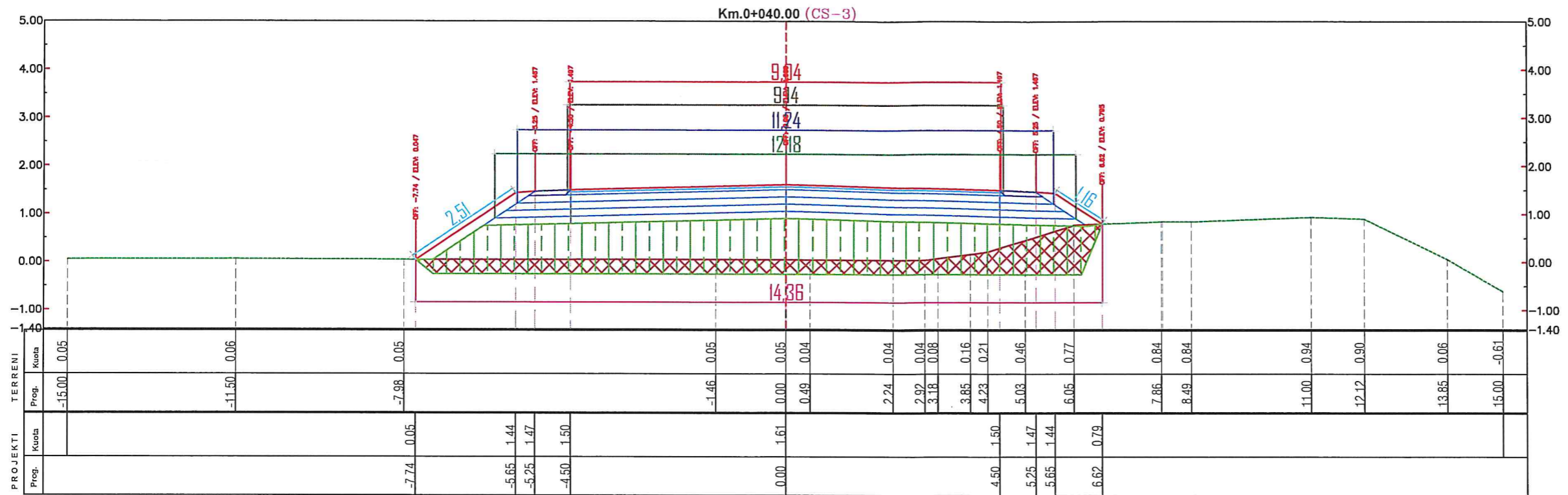

- SHPJEGUES**

  - 2.1 Baza me material te thyer, 5-40mm, 2x15cm
  - 2.2 Stabilizant me material te thyer, 0-31.5mm, 2x15cm
  - 2.3-Stabilizant per bankina, idem 0-31.5mm, h=22cm
  - 2.5-Binder me trashesi 6cm (perfshi tack coat, 0.5l/m<sup>2</sup>)
- SHPJEGUES**

  - 1.1 Germim i zakonshem i tabanit te mbushjes seksion i detyruar deri ne 0.30m thellesi per heqjen e tokes vegjetale, plus transport auto ± 5km
  - 1.2 Germim i zakonshem per nivelime, kanale etj
  - 1.4-Formimi i trupit te rruges ne mbushje me material shkembor karriere
  - 1.5-Vendosje gjetextil dhe gjeogrid

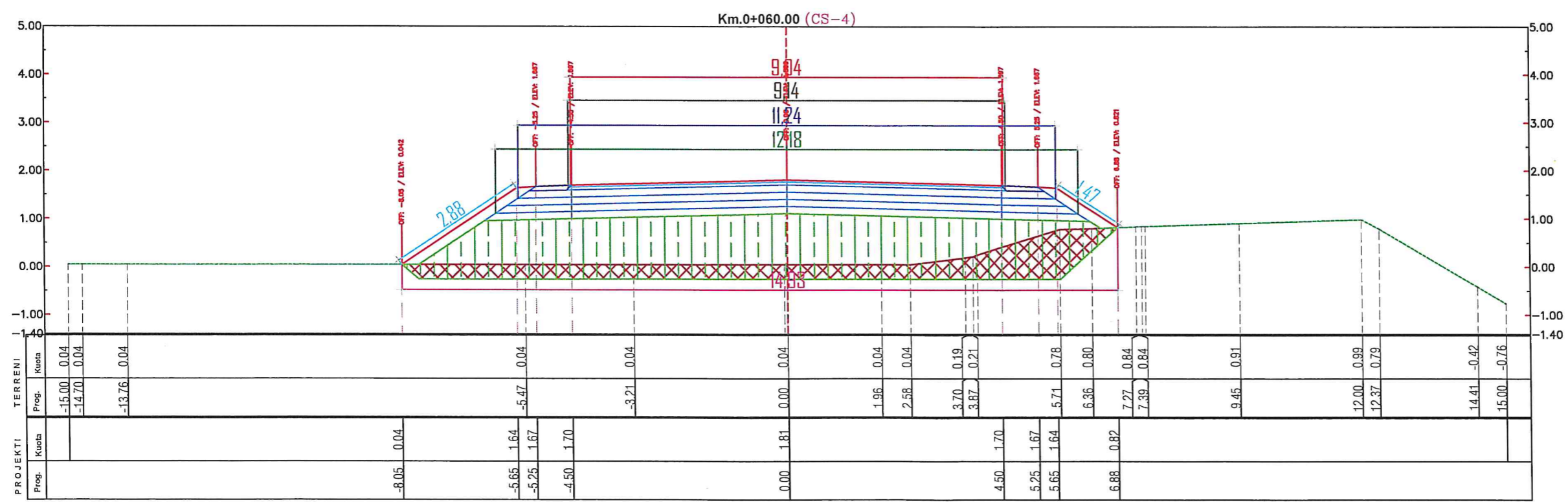

**INVESTITORI**

AUTORITETI RRUGOR SHQIPTAR

**MBIKQYRESI I PUNIMEVE**

"CIVIL CONS" & "ENGINEERING CONSULTING GROUP"  
Ing. Kostanca MARTINI

**OBJEKTI: NDERTIM RRUGA PORTO-ROMANO DURRES, LOT 3**

Profile Terthore  
(Aksi C 3\_3, Rrethi C 3\_3 - 2)

**FAZA - PROJEKTI ZBATIM**

SHKALLA 1:100	DATA: Janar - 2021	Rev.01
FLETA E VIZATIMIT. Nr. 52		





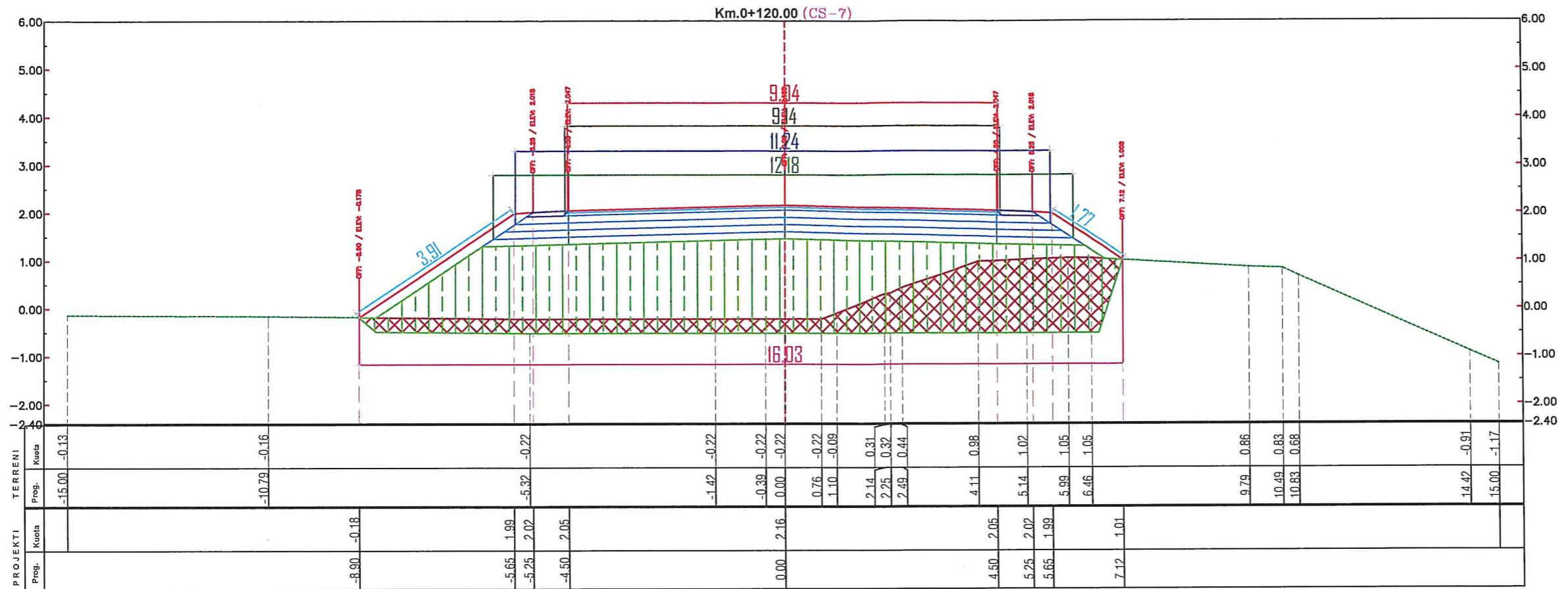

- SHPJEGUES**
- 2.1 Baza me material te thyer, 5-40mm, 2x15cm
  - 2.2 Stabilizant me material te thyer, 0-31.5mm, 2x15cm
  - 2.3 Stabilizant per bankina, idem 0-31.5mm, h=22cm
  - 2.5 Binder me trashesi 6cm (perfshi tack coat, 0.5l/m<sup>2</sup>)
- SHPJEGUES**
- 1.1 Germim i zakonshem i tabanit te mbushjes seksion i detyruar deri ne 0.30m thellesi per heqjen e tokes vegjetale, plus transport auto ± 5km
  - 1.2 Germim i zakonshem per nivelime, kanale etj
  - 1.4 Formimi i trupit te rruges ne mbushje me material shkembor karriere
  - 1.5 Vendosje gjeotextil dhe gjeogrid

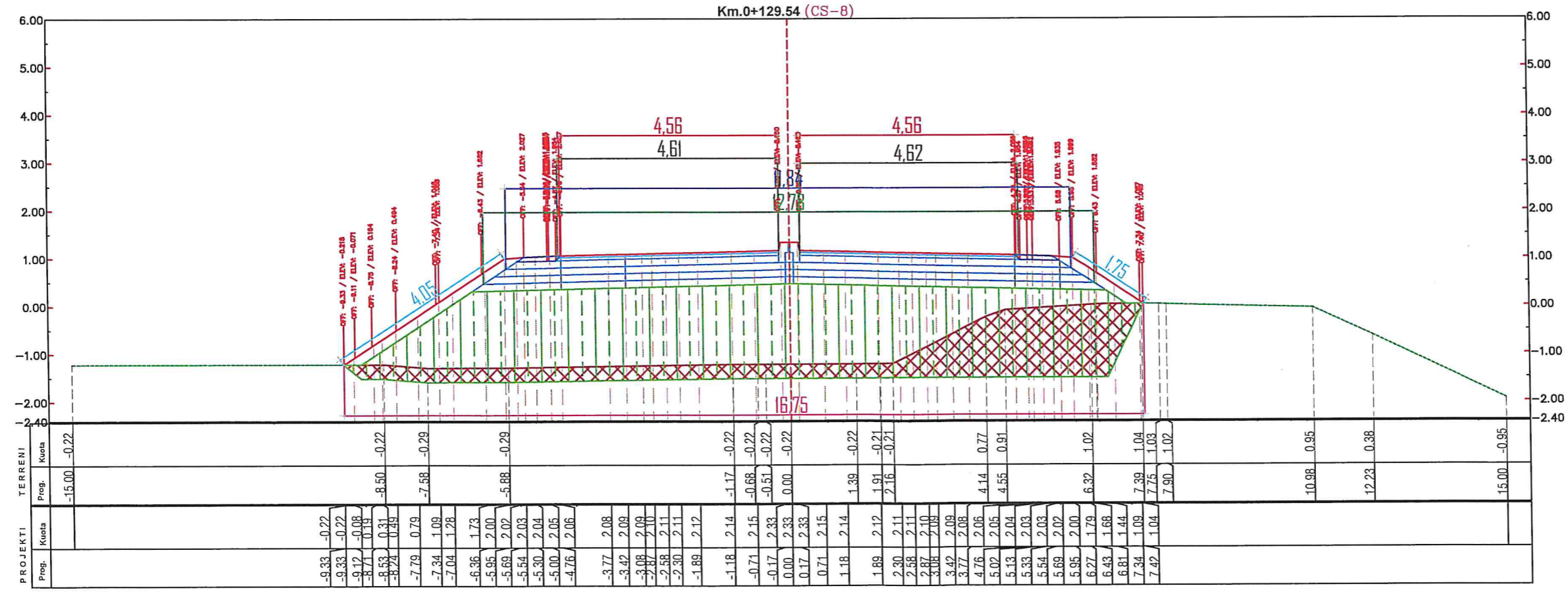

<b>INVESTITORI</b>  AUTORITETI RRUGOR SHQIPTAR	<b>MBIKQYRESI I PUNIMEVE</b> "CIVIL CONS" & "ENGINEERING CONSULTING GROUP" Ing. Kostasca MARTINI	<b>OBJEKTI: NDERTIM RRUGA PORTO-ROMANO DURRES, LOT 3</b>  Profile Terthore ( Aksi C 3_3, Rrethi C 3_3-2)	<b>FAZA - PROJEKTI ZBATIM</b> <table border="1" style="width: 100%; border-collapse: collapse;"> <tr> <td style="width: 33%;">SHKALLA 1:100</td> <td style="width: 33%;">DATA: Janar - 2021</td> <td style="width: 33%;">Rev.01</td> </tr> <tr> <td colspan="3">FLETA E VIZATIMIT. Nr. 54</td> </tr> </table>	SHKALLA 1:100	DATA: Janar - 2021	Rev.01	FLETA E VIZATIMIT. Nr. 54		
SHKALLA 1:100	DATA: Janar - 2021	Rev.01							
FLETA E VIZATIMIT. Nr. 54									



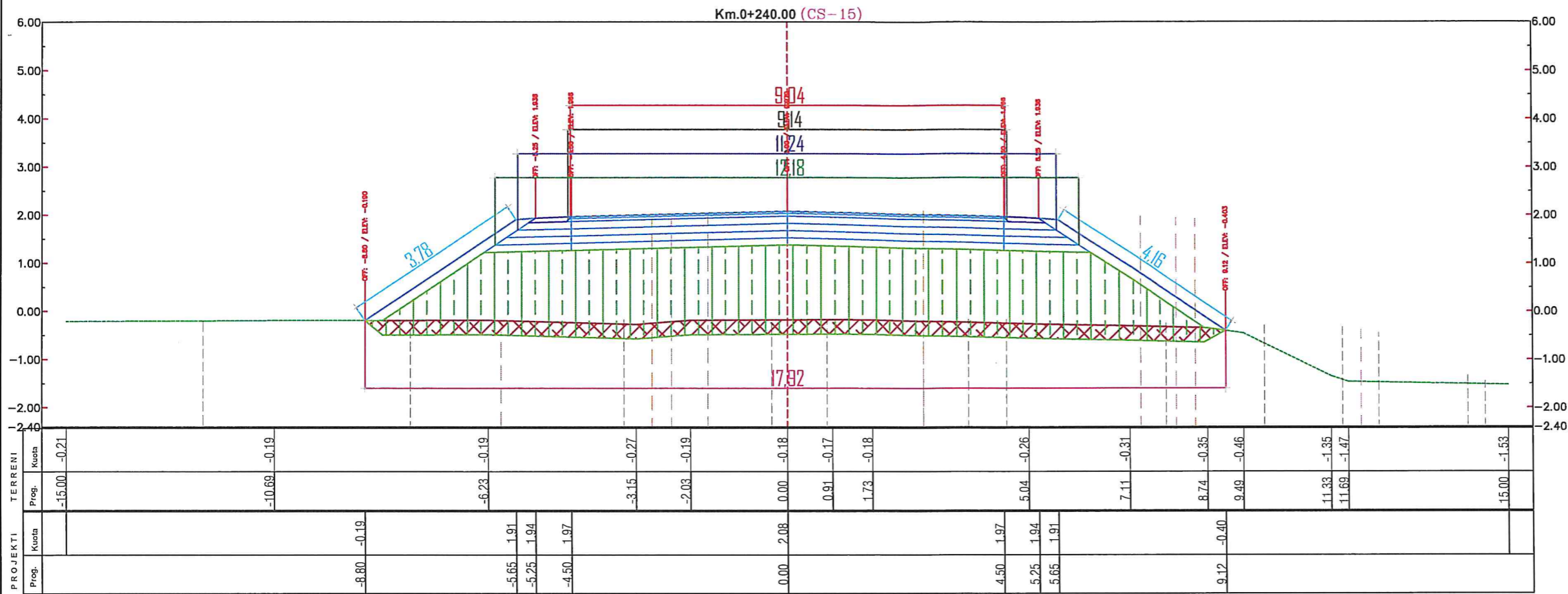

SHPJEGUES	
	2.1 Baza me material te thyer, 5-40mm, 2x15cm
	2.2 Stabilizant me material te thyer, 0-31.5mm, 2x15cm
	2.3-Stabilizant per bankina, idem 0-31.5mm, h=22cm
	2.5-Binder me trashesi 6cm (perfshi tack coat, 0.5l/m2)

SHPJEGUES	
	1.1 Germim i zakonshem i tabanit te mbushjes seksion i detyruar deri ne 0.30m thelesi per heqjen e tokes vegjetale, plus transport auto± 5km
	1.2 Germim i zakonshem per nivelime,kanale etj
	1.4-Formimi i trupit te rruges ne mbushje me material shkembor karriere
	1.5-Vendosje gjeotextil dhe gjeogrid

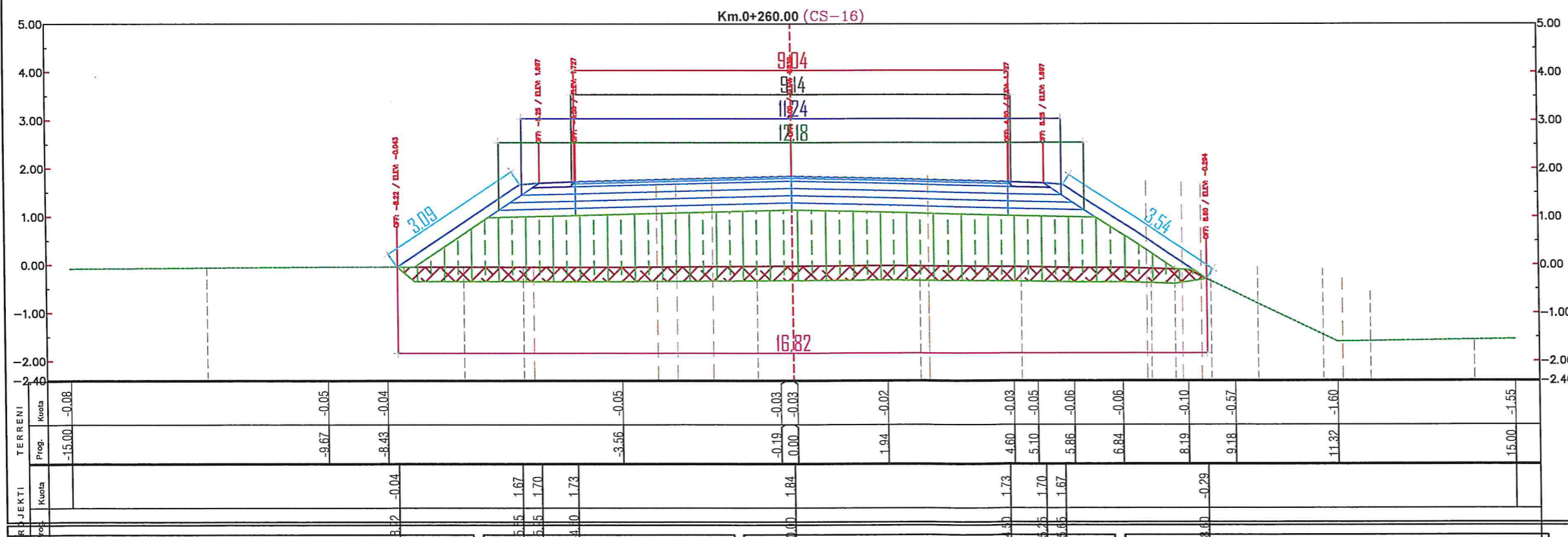

**INVESTITORI**  
AUTORITETI RRUGOR SHQIPTAR

**MBIKQYRESIT PUNIMEVE**  
"CIVIL CONS" & "ENGINEERING CONSULTING GROUP"  
Ing. Kostasna MARTINI

**OBJEKTI: NDERTIM RRUGA PORTO-ROMANO DURRES, LOT 3**  
Profile Terthore  
(Aksi C 3\_4)

**FAZA - PROJEKTI ZBATIM**  
SHKALLA 1:100    DATA: Janar - 2021    Rev.01  
FLETA E VIZATIMIT. Nr: 8



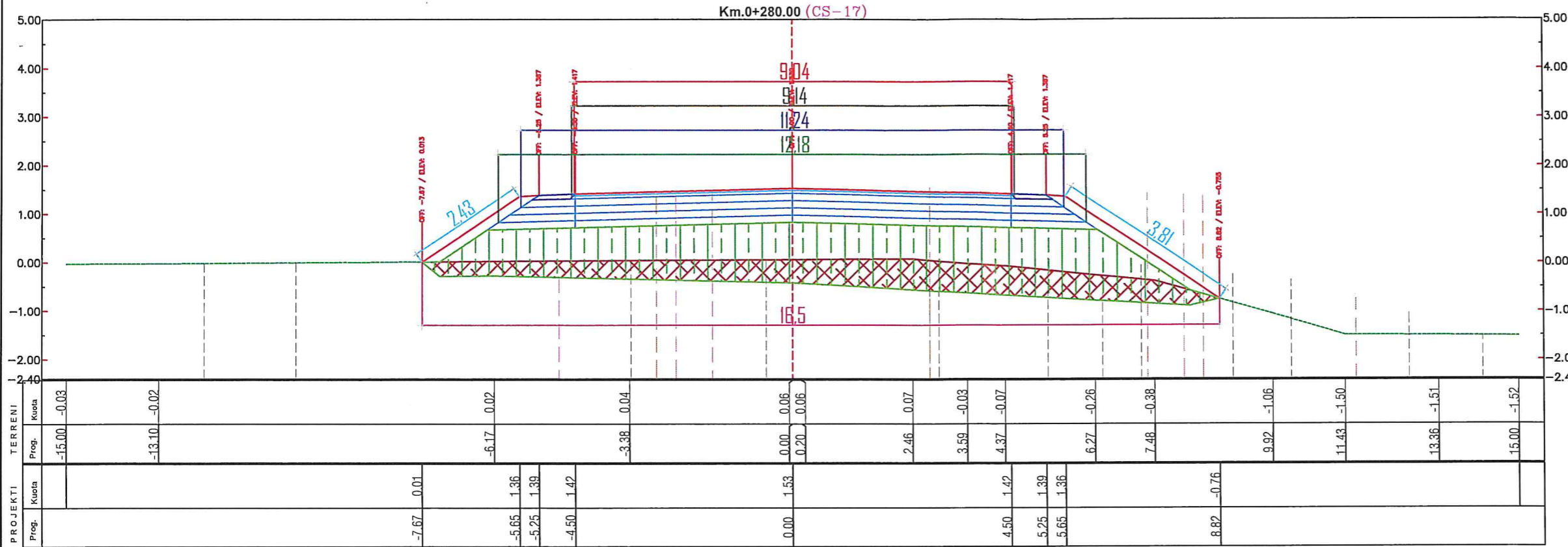

SHPJEGUES	
2.1	Baza me material te thyer, 5-40mm, 2x15cm
2.2	Stabilizant me material te thyer, 0-31.5mm, 2x15cm
2.3	Stabilizant per bankina, idem 0-31.5mm, h=22cm
2.5	Binder me trashesi 6cm (perfshi tack coat, 0.5l/m2)

SHPJEGUES	
1.1	Germim i zakonshem i tabanit te mbushjes seksion i detyruar deri ne 0.30m thellesi per heqjen e tokes vegjetale, plus transport auto± 5km
1.2	Germim i zakonshem per nivelime, kanale etj
1.4	Formimi i trupit te rruges ne mbushje me material shkembor karriere
1.5	Vendosje gjeotextil dhe gjeogrid

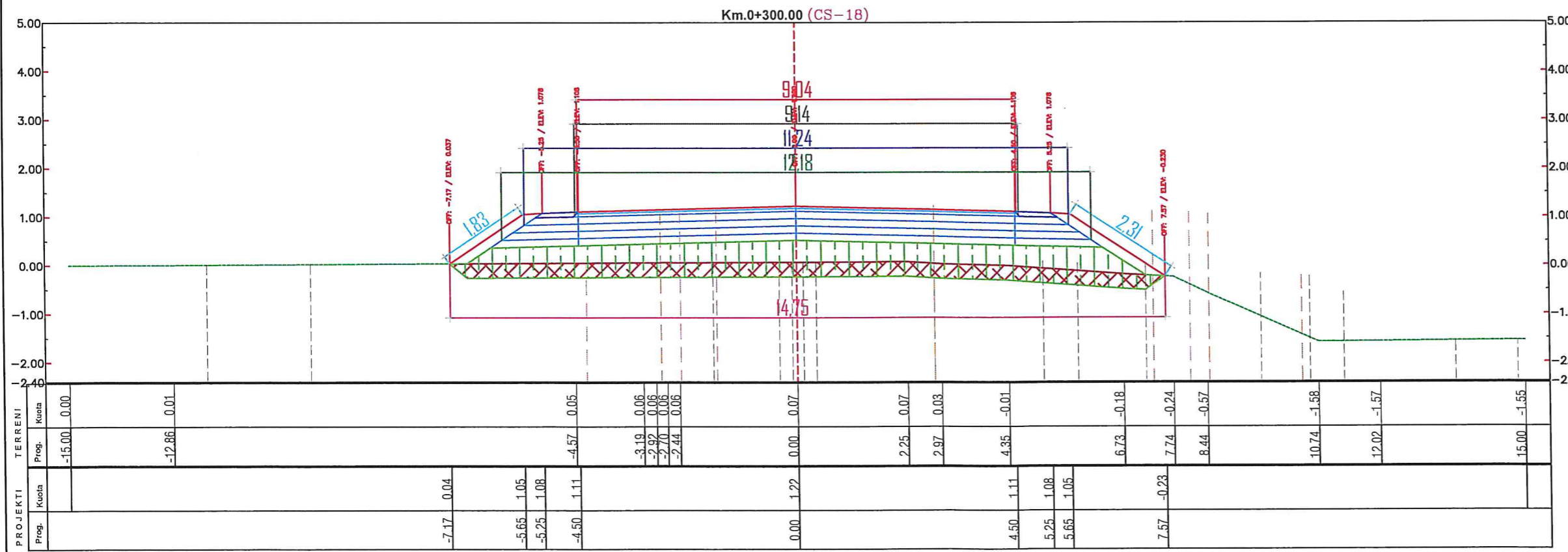

**INVESTITORI**

AUTORITETI RRUGOR SHQIPTAR

**MBIKQYRESI I PUNIMEVE**

"CIVIL CONS" & "ENGINEERING CONSULTING GROUP"  
Ing. Kostasca MARTINI

**OBJEKTI: NDERTIM RRUGA PORTO-ROMANO DURRES, LOT 3**

Profile Terthore  
(Aksi C 3\_4)

**FAZA - PROJEKTI ZBATIM**

SHKALLA 1:100	DATA: Janar - 2021	Rev.01
FLETA E VIZATIMIT. Nr: 9		



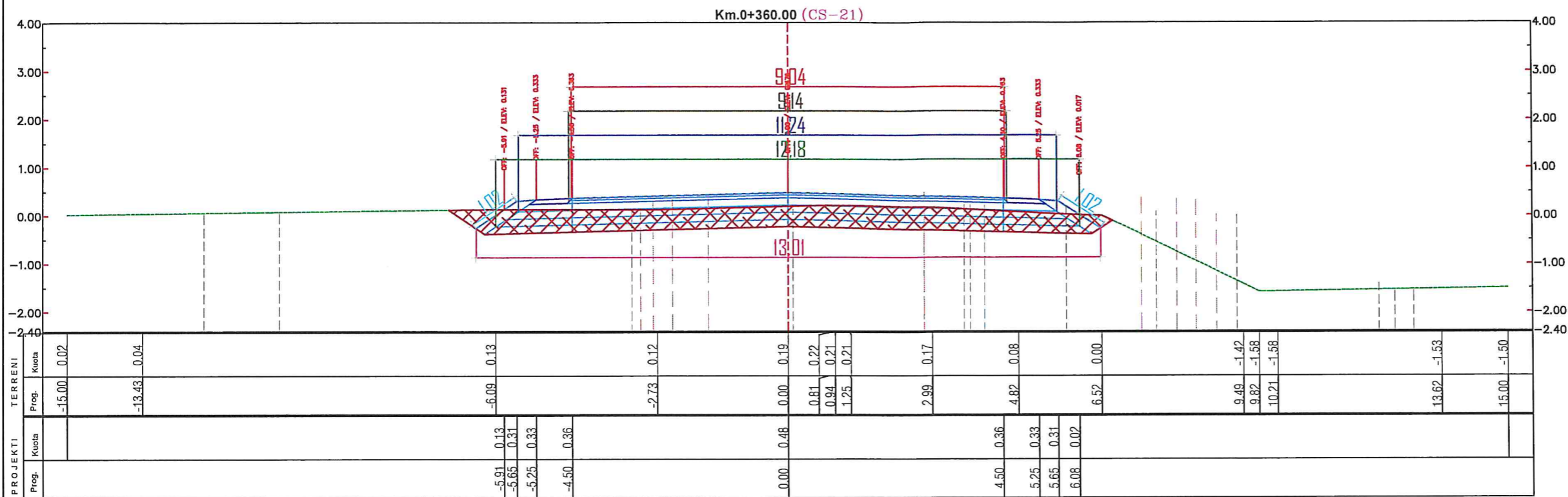

**SHPJEGUES**

—	2.1 Baza me material te thyer, 5-40mm, 2x15cm
—	2.2 Stabilizant me material te thyer, 0-31.5mm, 2x15cm
—	2.3-Stabilizant per bankina, idem 0-31.5mm, h=22cm
—	2.5-Binder me trashesi 6cm (perfshi tack coat, 0.5l/m <sup>2</sup> )

**SHPJEGUES**

[Cross-hatch]	1.1 Germim i zakonshem i tabanit te mbushjes seksion i detyruar deri ne 0.30m thelesi per heqjen e tokes vegjetale, plus transport auto± 5km
[Blue cross-hatch]	1.2 Germim i zakonshem per nivelime,kanale etj
[Green cross-hatch]	1.4-Formimi i trupit te rruges ne mbushje me material shkembor karriere
[Red line]	1.5-Vendosje gjeotextil dhe gjeogrid

**INVESTITORI**  
  
AUTORITETI RRUGOR SHQIPTAR





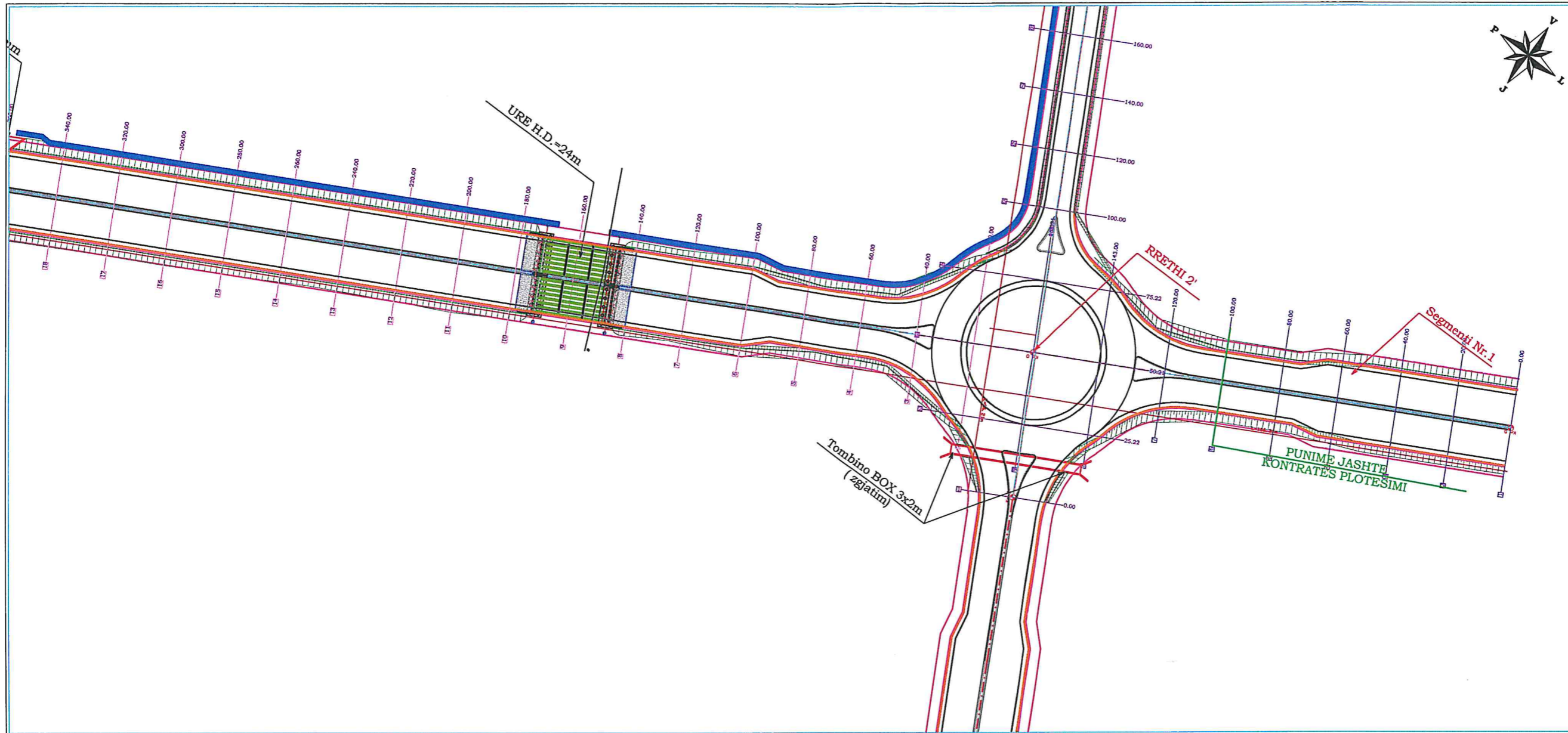

**MBIKQYRESI I PUNIMEVE**  
"CIVIL CONS" & "ENGINEERING CONSULTING GROUP"  
Ing. Kostasca MARTINI

**OBJEKTI: NDERTIM RRUGA PORTO-ROMANO DURRES, LOT 3**  
  
Profile Terthore  
(Aksi C 3\_4)

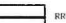
**FAZA - PROJEKTI ZBATIM**

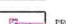
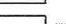
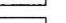
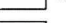
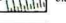
SHKALLA 1:100	DATA: Janar - 2021	Rev.01
FLETA E VIZATIMIT. Nr: 11		



-  BRIGA NE PËRQIET
-  AKSI I RRUGES
-  PROFILAT E RRUGES DHE NR. PËRSATES
-  KUOTA TERRESEM
-  IDRIQSE
-  SKAFIATA
-  BARRAZHE
-  TOMBINO
-  URE
-  KANAL

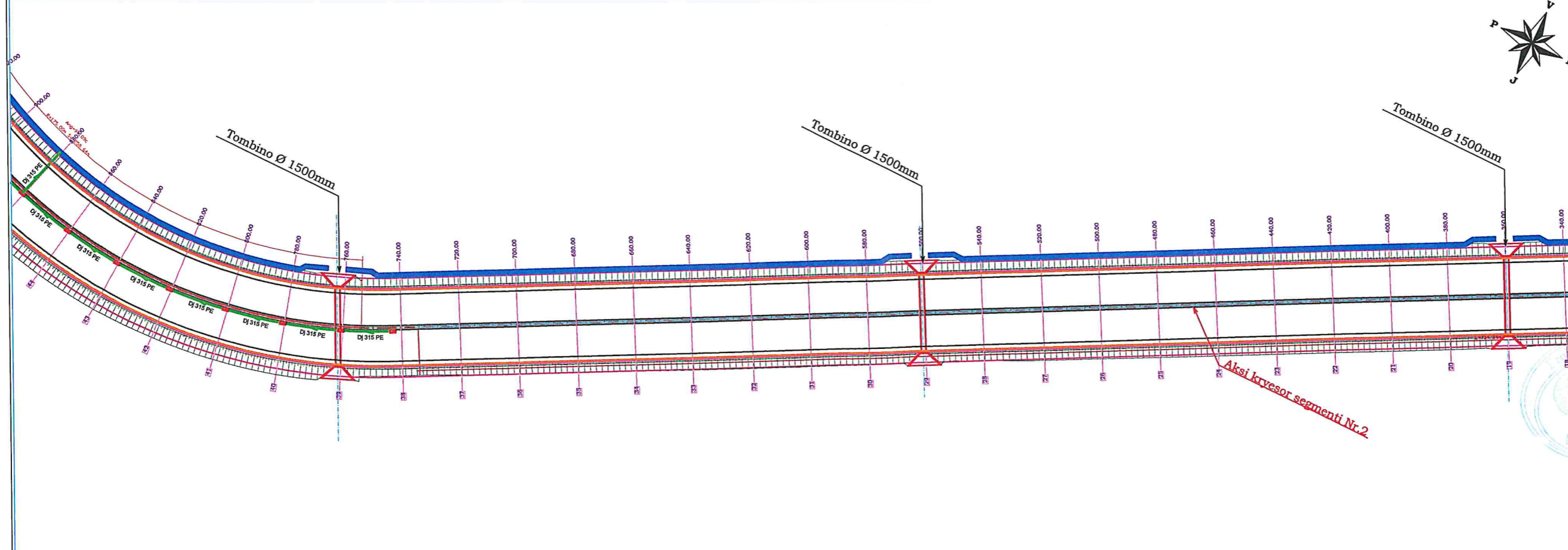

\_\_\_\_\_

\_\_\_\_\_

\_\_\_\_\_

\_\_\_\_\_

MINISTRIA E INFRASTRUKTURËS  
DHE ENERGJISË  
AUTORITETI I RRUGOR SHQIPTAR  
Rruga Sali Frashëri, Nr.31, Stradë - Shkupitë

PROJEKTI  
NDERTIM RRUGA PORTO ROMANO  
DURRES, LOT 3 (PLOTESIMI)

“KLODIONA SH.P.K.”  
Rr. Durrës, P.118, Sh. P. 2, Tërësi, Shkupitë  
Klodion Sh.P.K.  
Klodion Sh.P.K.  
Klodion Sh.P.K.

Inj. YLLI KARAFIÇI  
Inj. NIKOLLAQ ALEKSI  
Inj. E.KOHA BEZHANI  
Inj. DENISA SHULLERIS

RRJETI RRUGOR

PLANIMETRIA E RRUGES

MARS 2022 1 : 500

**B.1 - 01**

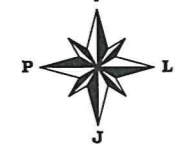

- Legjenda
- BRUGA NE FRUÇAJKËT
  - AKSI RRUGËS
  - PROFILAT E RRUGËS DHE NR. PËRSIATËS
  - KUOTA TË RRËJËT
  - EDHËRË
  - SHARËZATA
  - BANKINË
  - TOMBURO
  - URË
  - KANAL

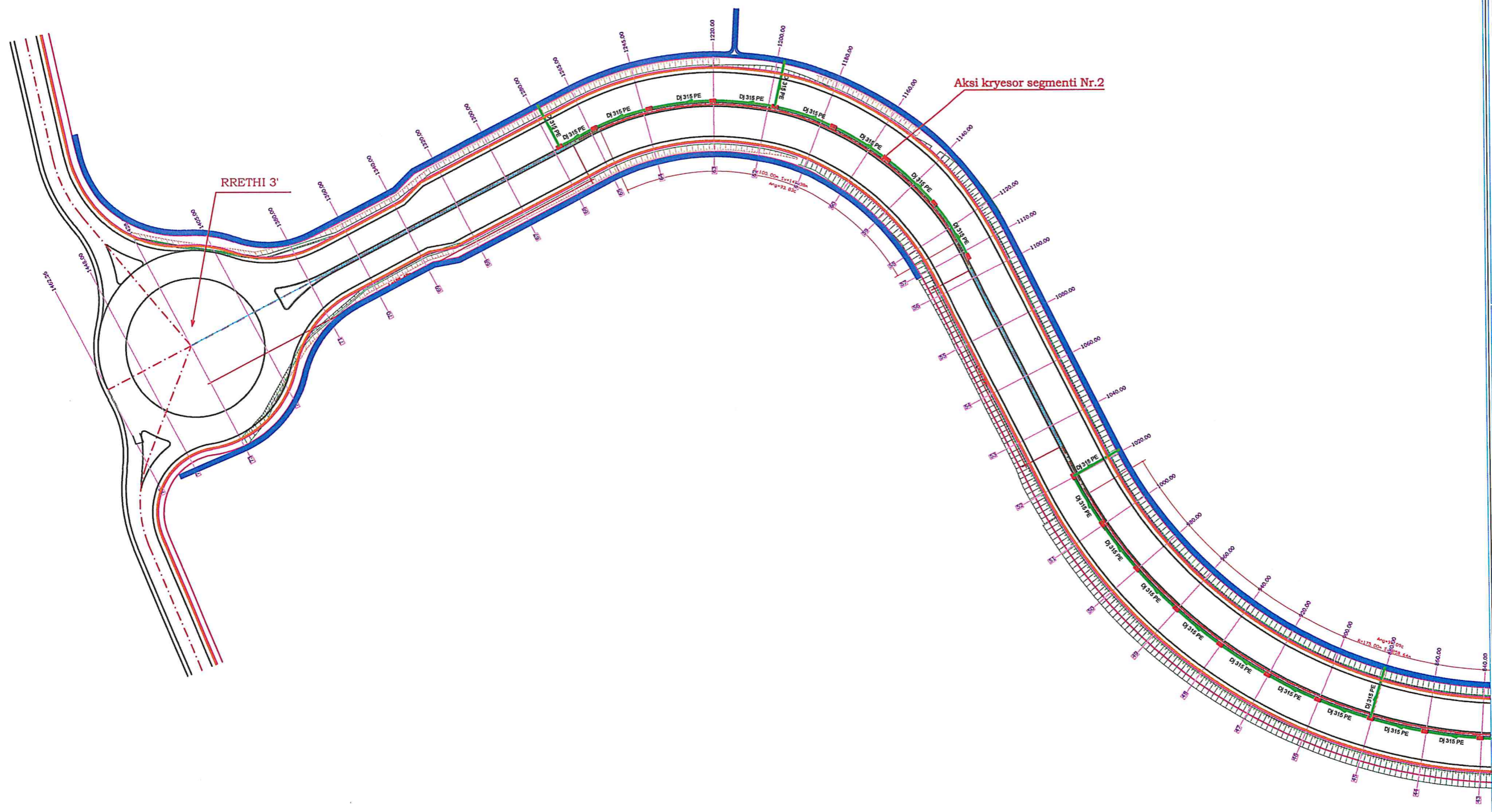

Shënime

\_\_\_\_\_

\_\_\_\_\_

\_\_\_\_\_

\_\_\_\_\_

\_\_\_\_\_

**MINISTRIA E INFRASTRUKTURËS  
DHE ENERGJISË  
AUTORITETI RRUGOR SHQIPTAR**  
Rruga Sami Frashëri, Nr. 33, Tiranë - Shqipëri

Titulli i Projektit  
**PROJECTI  
NDERTIM RRUGA PORTO ROMANO  
DURRES, LOT 3 (PLOTESIMI)**

Autoriteti  
 \_\_\_\_\_  
 Data  
 \_\_\_\_\_

"KILODODA SH.P.K."  
Dr. Bashaqiri, P. P. 1111111111, Tiranë, Shqipëri

Ing. YLLI KARATCI  
 Ing. NIKOLLAQ ALENI  
 Ing. ELONA HESHIANI  
 Ing. DENISA SHALLEXI  
 Vite

Autoriteti  
**RRJETI RRUGOR**

Titulli i Projektit  
**PLANIMETRIA E RRUGËS**

Data  
**MARS 2022**

Skala  
**1 : 500**  
**B.1 - 02**









**PROFIL TIP 1**  
MËNYRA E NDËRTIMIT TË RRUGËS  
SH 1:100

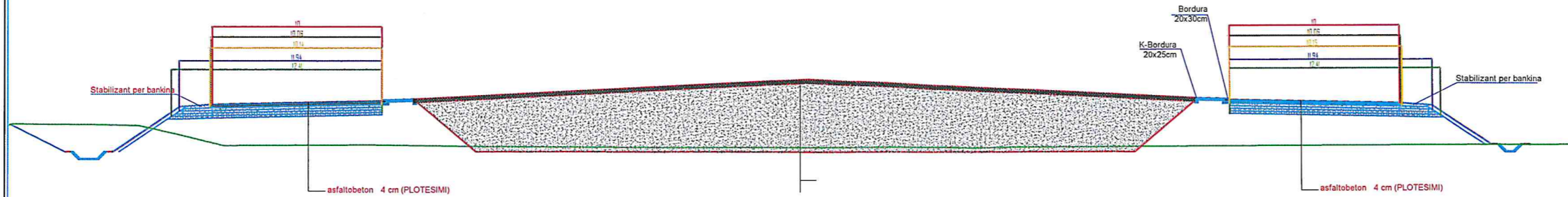

**PROFIL TIP 2**  
MËNYRA E NDËRTIMIT TË RRUGËS  
SH 1:100

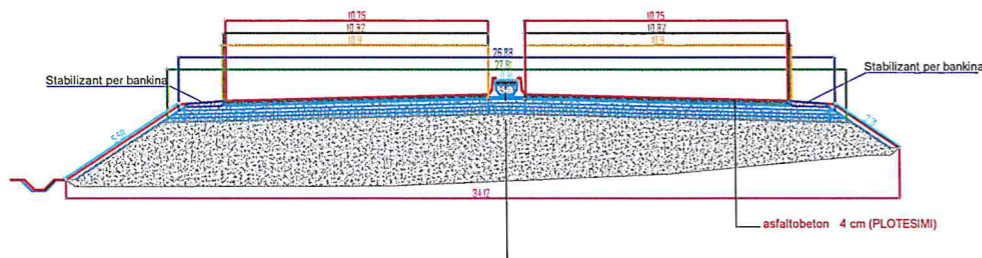

**PROFIL TIP 3**  
MËNYRA E NDËRTIMIT TË RRUGËS  
SH 1:100

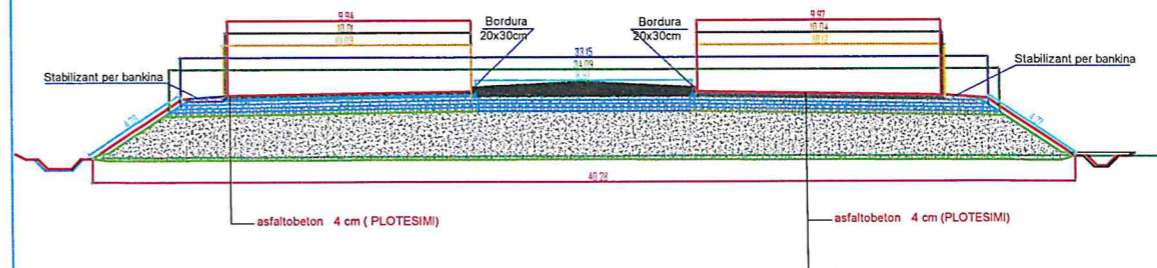

**PROFIL TIP 4**  
MËNYRA E NDËRTIMIT TË RRUGËS  
SH 1:100

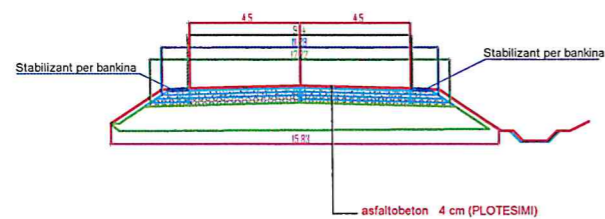

**ARMIMI I NEW JERSEY**  
SH 1:25

New Jersey sipas standartit ASTM C823

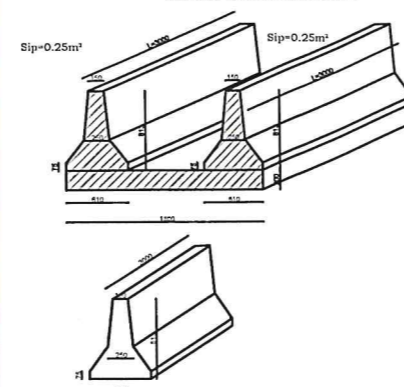

Per lloj barier:  
1)-150x16 L=110cm=19\*1.58kg/m<sup>2</sup> 1ml=33.02kg  
2)-120x15 L=170cm=7\*0.88kg/m<sup>2</sup> 1ml=10.56kg  
3)-120x15 L=210cm=7\*0.88kg/m<sup>2</sup> 1ml=13.68kg  
L=56.64kg/ml

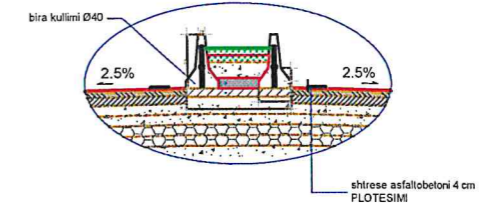
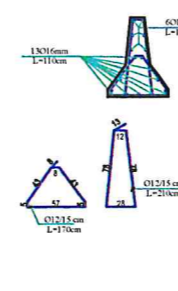

Shenim :  
Pemasat e New Jersey jane dhene ne mm

MINISTRIA E INFRASTRUKTURES  
DHE ENERGJISE  
AUTORITETI RRUGOR SHQIPTAR  
Krye Shteti, Fierri, Nr.33, Tiranë - Shqipëri

"PROJEKTI  
NDËRTIM RRUGA PORTO ROMANO  
DURRES, LOT 3 (PLOTESIMI)"

"KLODIDA SH.P.K."  
No. Fierri, Nr. 114 Str. No. 3 - Tiranë, Shqipëri  
Inj. YLLI KARAFICI  
Inj. NIKOLLAQ ALEKSI  
Inj. EKONA DEZHANI  
Inj. DENISA SHALLEZI

RRJETI RRUGOR

PROFILAT TIP

MARS 2022 VARION

**B.4 - 01**





- RRUGA NE PROJEKT
- AKSHI RRUGES
- PROFILAT E RRUGES DHE NR. FERRATES
- KUOTA TERREIN
- EZDIFSE
- SHARPATA
- BANGZIN
- TCHERINO
- URE
- KANAL
- KOLEKTOR KJISH
- FJESLITE KJISH
- SHENIME KUJSH

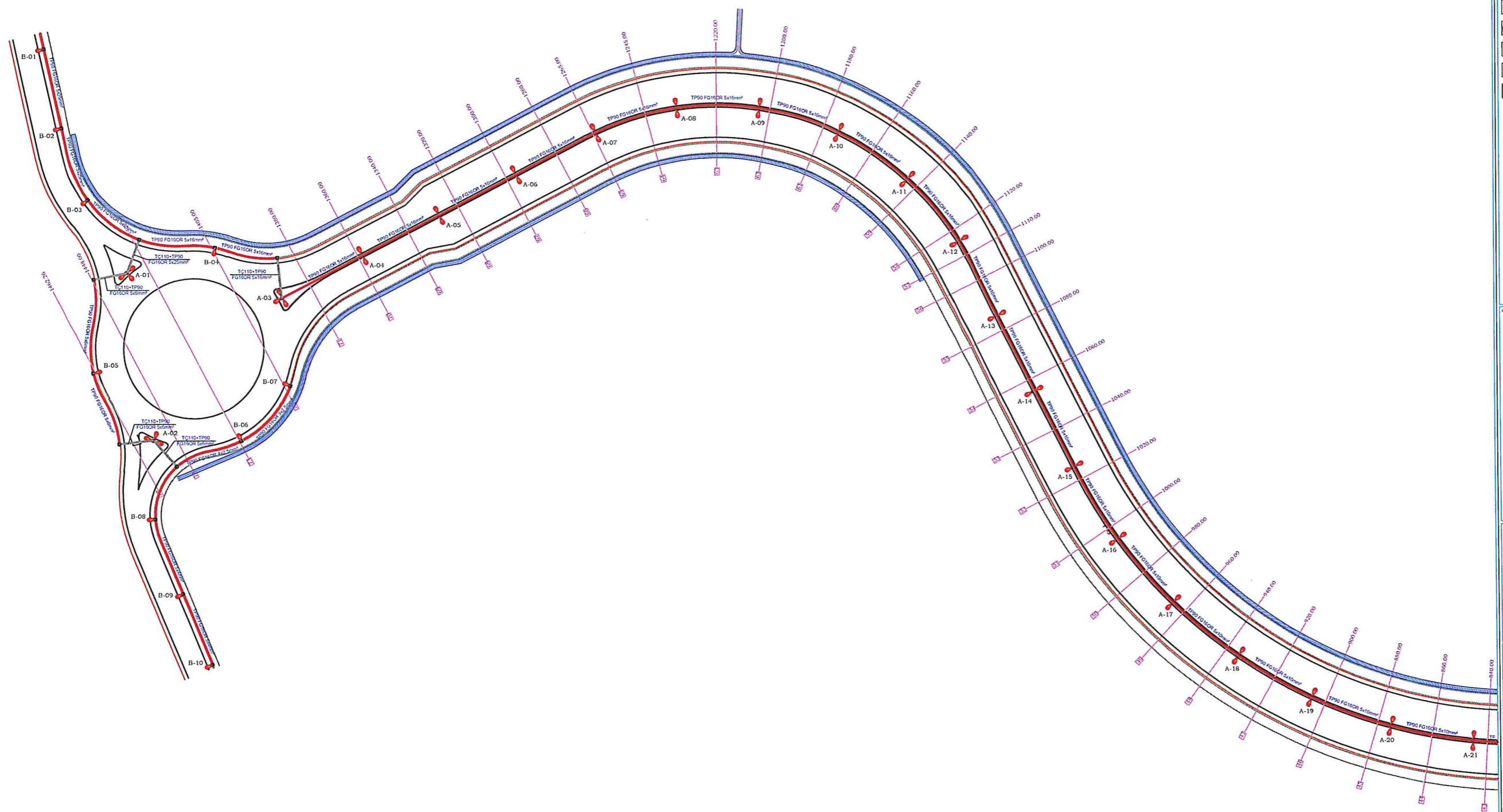

Stacioni Përcaktuar

**MINISTRIA E INFRASTRUKTURËS  
DHE ENERGJISË**  
**AUTORITETI RRUGOR SHQIPTAR**  
Rruga Smalë Ferizit, Nr. 23, Tiranë - Shqipëri

Projekti: **PROJEKTI  
NDERTIM RRUGA PORTO ROMANO  
DURRES, LOT 3 (PLOTESIMI)**

**"KLODIONA SH.P.K."**  
Rr. Buzëkallë, P.1111, Nr. 2 - Tiranë, Shqipëri  
 Inzh. YLLI KARAPISI  
 Inzh. NIKOLLAQ ALEKSI  
 Inzh. EJONA BEZHANI  
 Inzh. DENISA SHULLESI

**RRJETI RRUGOR**  
**PLANIMETRIA E RRUGES**  
 MARS 2022      1 : 500  
**B.1 - 02**

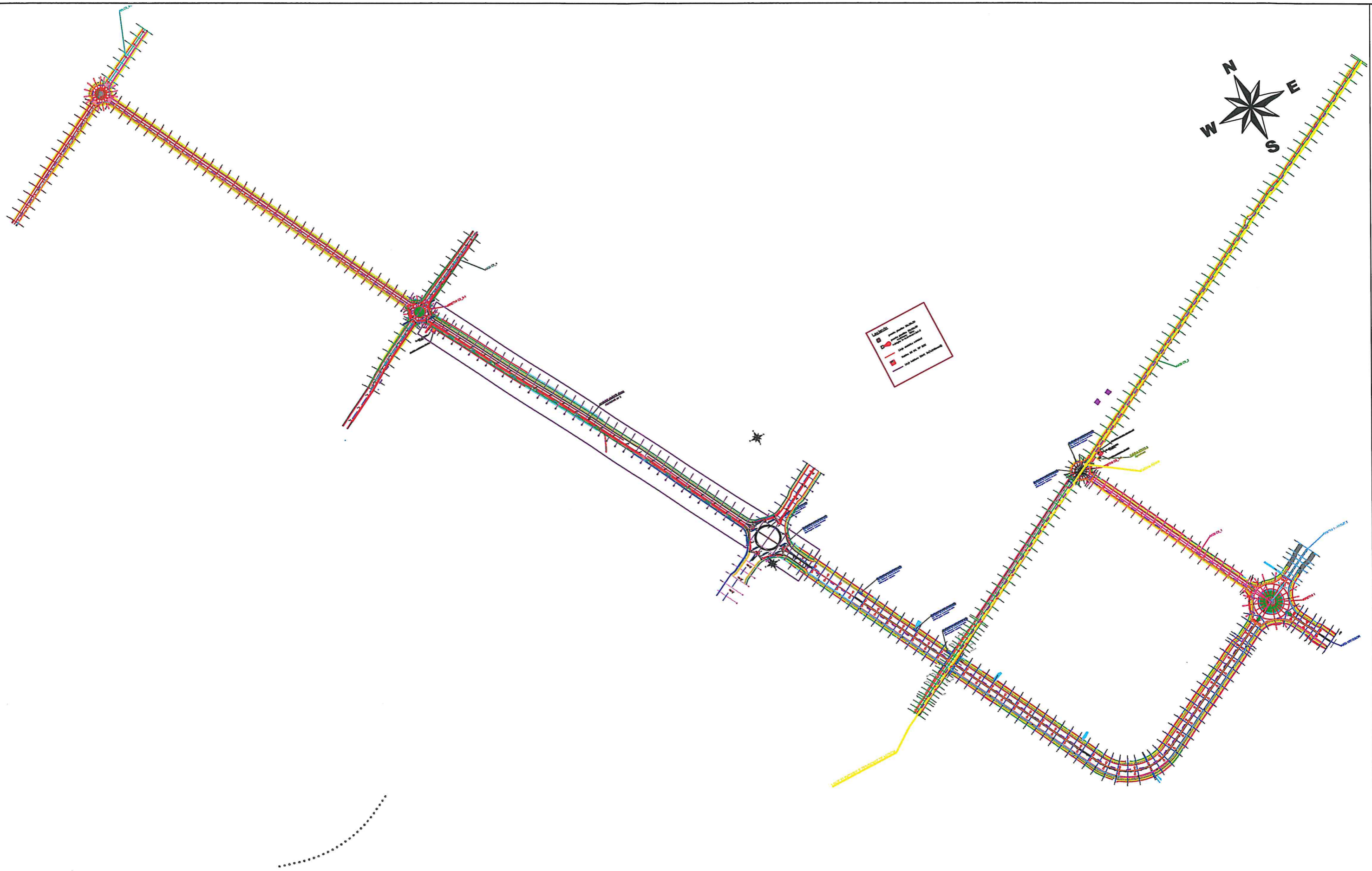

**INVESTITORI**  
 AUTORITETI RRUGOR SHQIPTAR

*MBIKQYRESI I PUNIMEVE*  
 "CIVIL CONS" & "ENGINEERING CONSULTING GROUP"  
 Ing. Kostasca MARTINI

**OBJEKTI: NDERTIM RRUGA PORTO-ROMANO DURRES, LOT 3**  
 Profile Terthore  
 ( Aksi C 3\_4 )

**FAZA - PROJEKTI ZBATIM**  
 SHKALLA 1:100      DATA: Janar - 2021      Rev.01  
 FLETA E VIZATIMIT. Nr: \_\_\_\_\_