

GENERAL PLAN
WETLAND-L12 WETLAND GARDENS
AND FOOT BRIDGE
SCALE 1:500

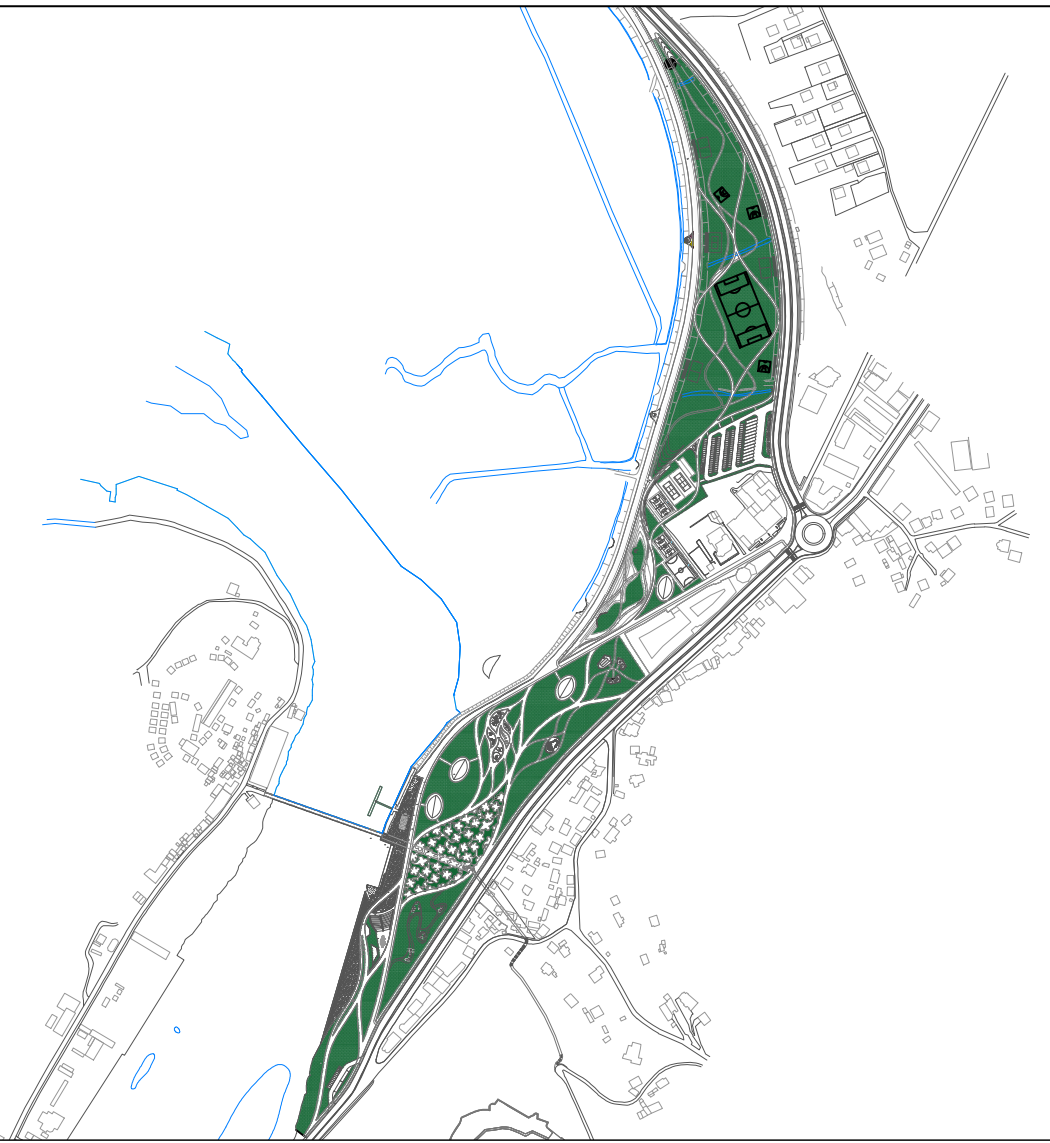

LEGEND

SYMBOL	DESCRIPTION
EG	Existing Ground Elevation (m)
FG	Final Ground Elevation (m)
	Different Plants
	Sand
	Fine Picked Granite Cobblestone
	Compacted Gray Gravel

CLIENT:
ALBANIAN DEVELOPMENT FUND
Contact person: Emi Dautaj (Menaxhere Kontrates)
Rr. "Sami Frasheri", Nr. 10, Tirana, Albania
Phone / Fax: 00355 4 234 885
E-mail: edautaj@albanianadf.org

CASANOVA+HERNANDEZ ARCHITECTS
NIPT LB2016014E
Contact person: Mr. Jesus Hernandez
Ibrahim Rugova, Pallati 17, H3, Apt. 12, Tirana
tel: +31 (0)10 2409353
contact@casanova-herandez.com

SRP Albanian Engineering s.h.p.k.
NUIS LB1728013G
Contact person: Blerim Kurti
Rruga Tom Pleshja, Pallati Klenski, Shkalla 4, Kali 1, Ap. 2, Yzberisht, Tiranë 1051, Albania
Tel.: +355 49 272 529
Mobile: +355 68 2020 335
E-mail: blerim.kurti@srp-consult.de

SRP Schneider & Partner, Ingenieur-Consult GmbH
Augustaanlage 50, D-68165 Mannheim, Germany
Handelsregister-Nr.: HRB 2082 Coburg
Contact person: Frank Ehrlicher, Director International Division SRP
Tel.: +49 / 621 400 462 - 11
Mobile: +49 / 170 916 25 74
E-mail: frank.ehrlicher@srp-consult.de

DD-C-GP-1-02 General Plan of Wetland

Drawing number		Description	
Detailed Design		1067 x 594 mm.	1:500 22-09-2022
Phase	Format	Scale	Date
L077		Master Plan of Interventions at the Entrance of Shkodra	
Project number	Project name		
casanova+herandez architects			
SRP Schneider & Partner, Ingenieur-Consult GmbH			
SRP Albanian Engineering sh.p.k			
		Lombardiae 24A, 20171 Rai (Rostum), T +31 (0)10 240 9233 F +31 (0)10 240 9229 casanova@casanova-herandez.com	

Lombardstraße 24A
3011 AH Rotterdam
T +31 (0)10 240 6333
F +31 (0)10 240 9229
contact@casanova-herandez.com

GENERAL PLAN
WETLAND-L12 WETLAND GARDENS
AND FOOT BRIDGE
SCALE 1:500

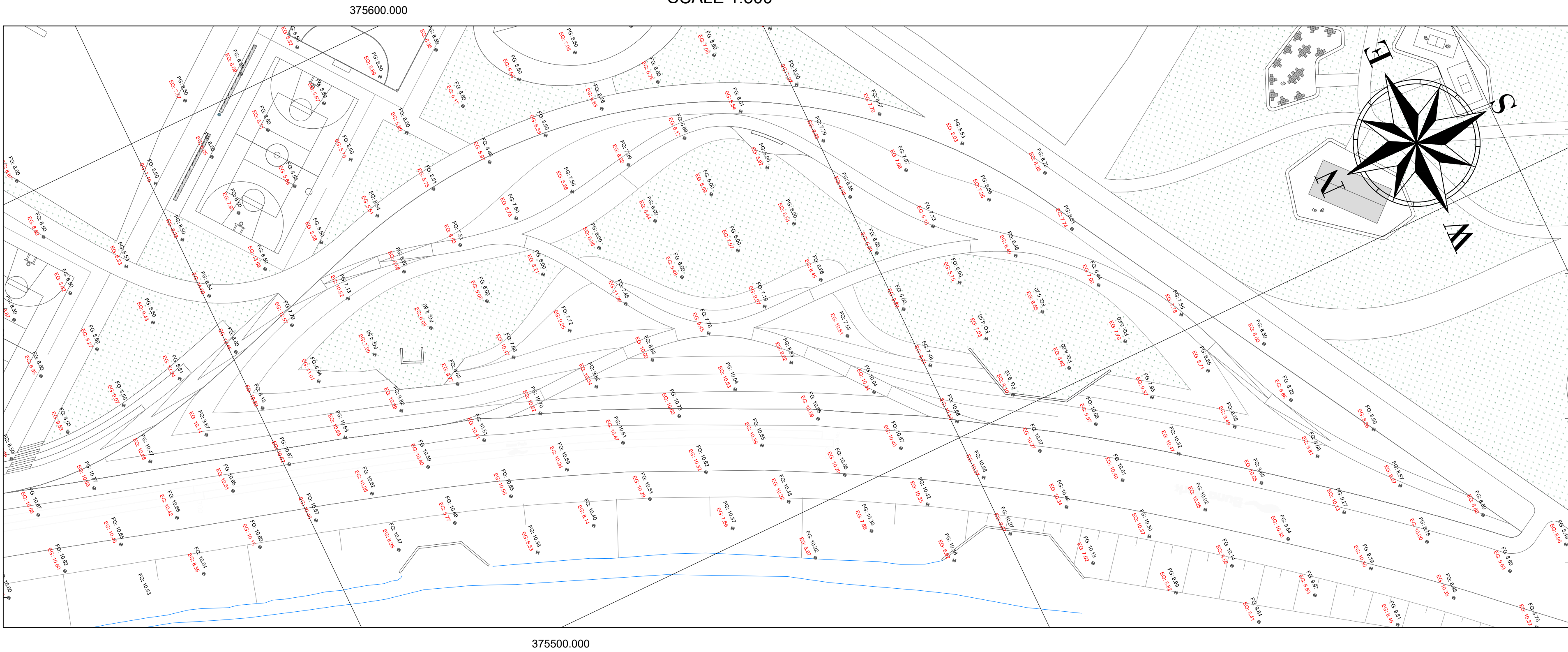

GENERAL PLAN
WETLAND-L12 PARKING
SCALE 1:500

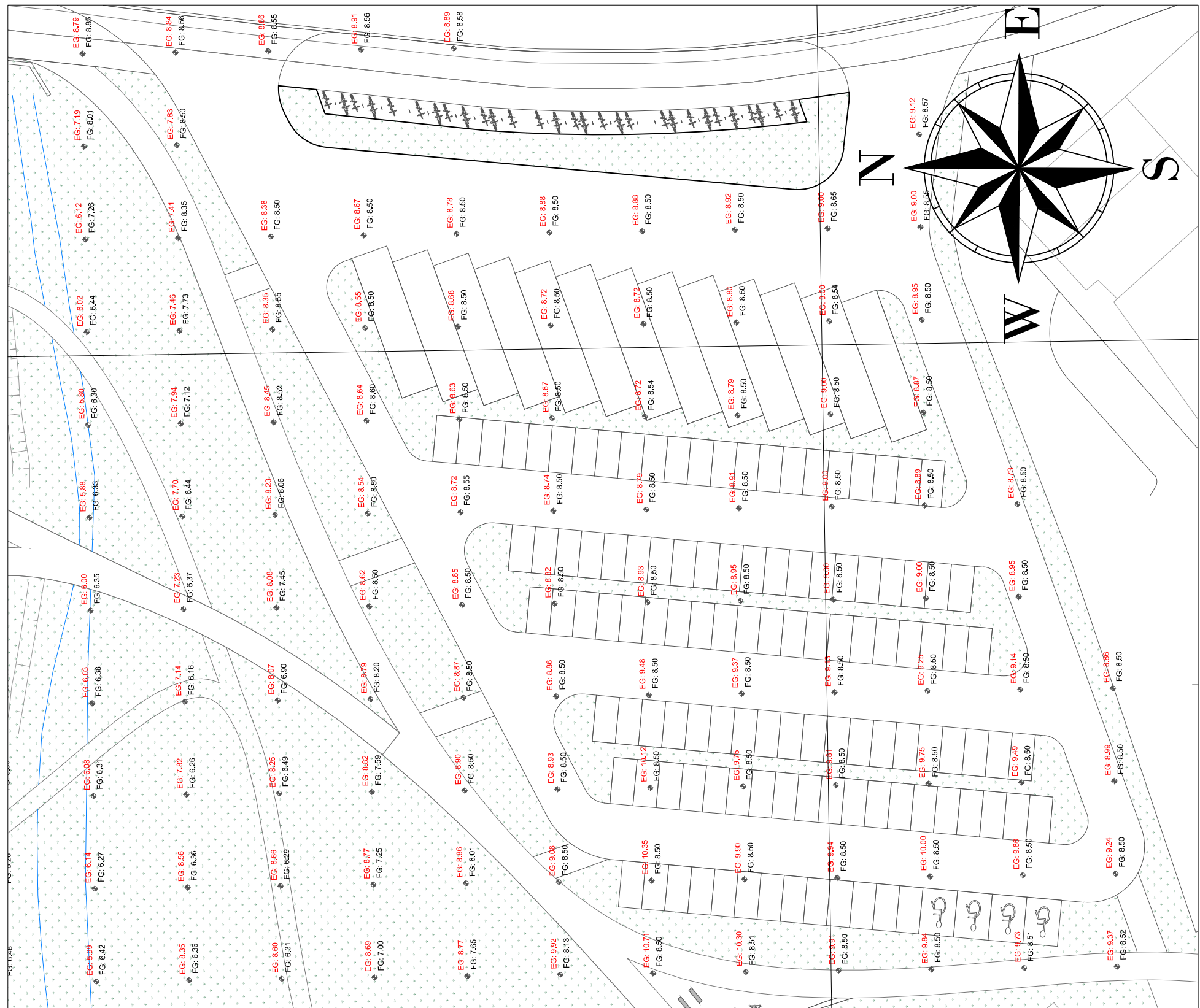

GENERAL PLAN
WETLAND-L14 SPORTS AREA
SCALE 1:500

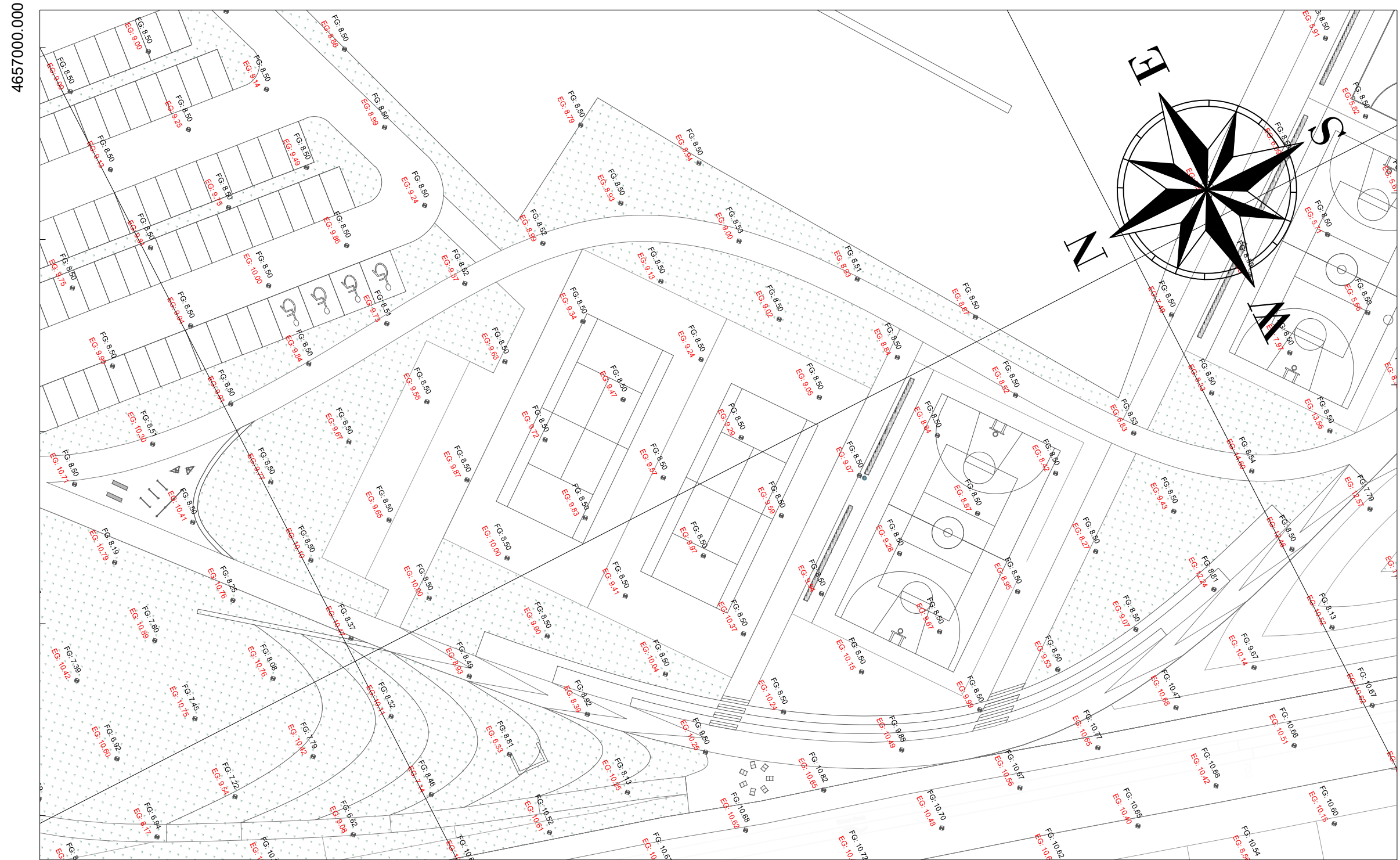

GENERAL PLAN
WETLAND-L14 SPORTS AREA
L11 CAFE GARDENS
SCALE 1:500

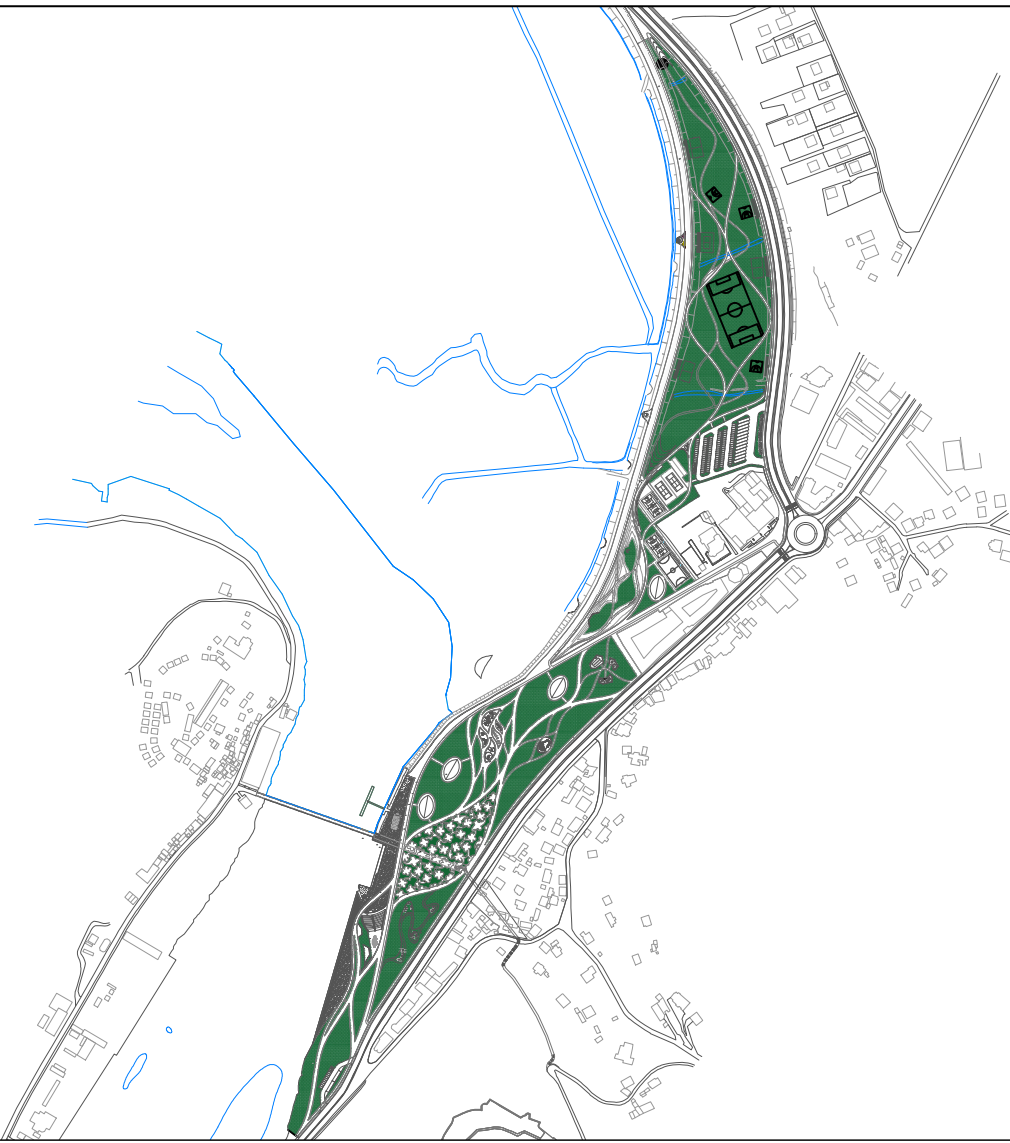
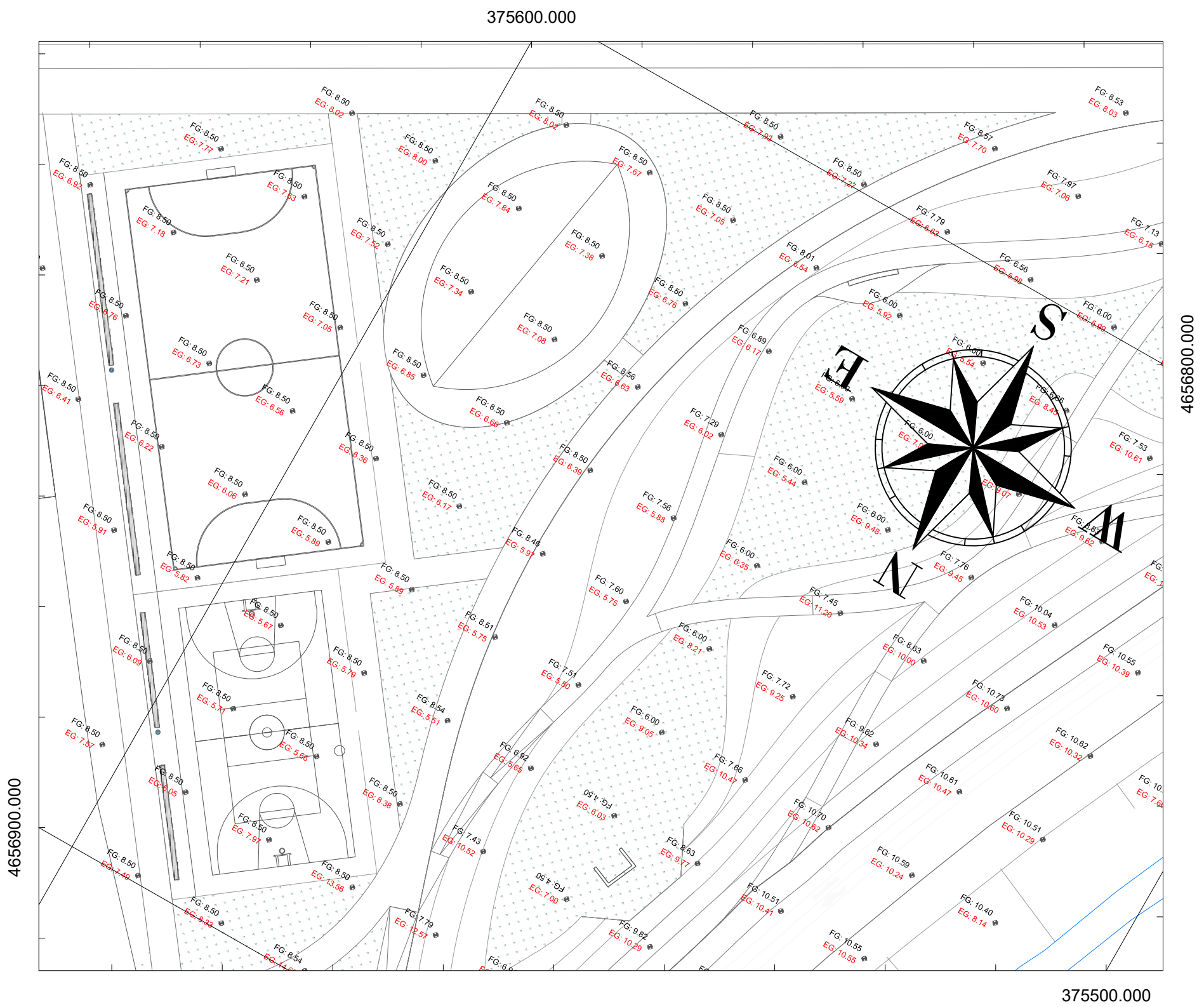

LEGEND	
SYMBOL	DESCRIPTION
EG	Existing Ground Elevation (m)
FG	Final Ground Elevation (m)
	Different Plants
	Sand
	Fine Picked Granite Cobblestone
	Compacted Gray Gravel

CLIENT:
ALBANIAN DEVELOPMENT FUND
Contact person: Emi Dautaj (Menaxhere Kontrates)
Nr. 'Sami Frasheri', Nr. 10, Tirana, Albania
Phone/ Fax: 00355 4 234 885
E-mail: edautaj@albaniandf.org

CASANOVA+HERNANDEZ ARCHITECTS
NIPT L82016014E
Contact person: Mr. Jesus Hernandez
Ibrahim Rugova, Pallati 17, H3, Apt. 12, Tirana
tel: +31 (0)10 2409333
contact@casanova-hernandez.com

SRP Albanian Engineering s.h.p.k.
NIUS L81728013G
Contact person: Blerim Kurti
Rruga Tomi Pezha, Pallati Klensi, Shkalla 4, Kali 1, Ap. 2, Yzberisht, Tiranë 1051, Albania
Tel.: +355 49 272 529
Mobile: +355 68 2020 335
E-mail: blerim.kurti@srp-consult.de

SRP Schneider & Partner, Ingenieur-Consult GmbH
Augustaanlage 50, D-68165 Mannheim, Germany
Handelsregister-Nr.: HRB 2082 Coburg
Contact person: Frank Ehrlicher, Director International Division SRP
Tel.: +49 / 621 400 462 - 11
Mobile: +49 / 170 916 25 74
E-mail: frank.ehrlicher@srp-consult.de

DD-C-GP-1-03		General Plan of Wetland	
Drawing number	Description		
Detailed Design	1067 x 594 mm.	1:500	22-09-2022
Phase	Format	Scale	Date
L077	Master Plan of Interventions at the Entrance of Shkodra		

casanova+hernandez architects
SRP Schneider & Partner, Ingenieur-Consult GmbH
SRP Albanian Engineering sh.p.k

Lombardskade 24A
3011 AH Rotterdam
T +31 (0)10 240 9333
F +31 (0)10 240 9229
contact@casanova-hernandez.com

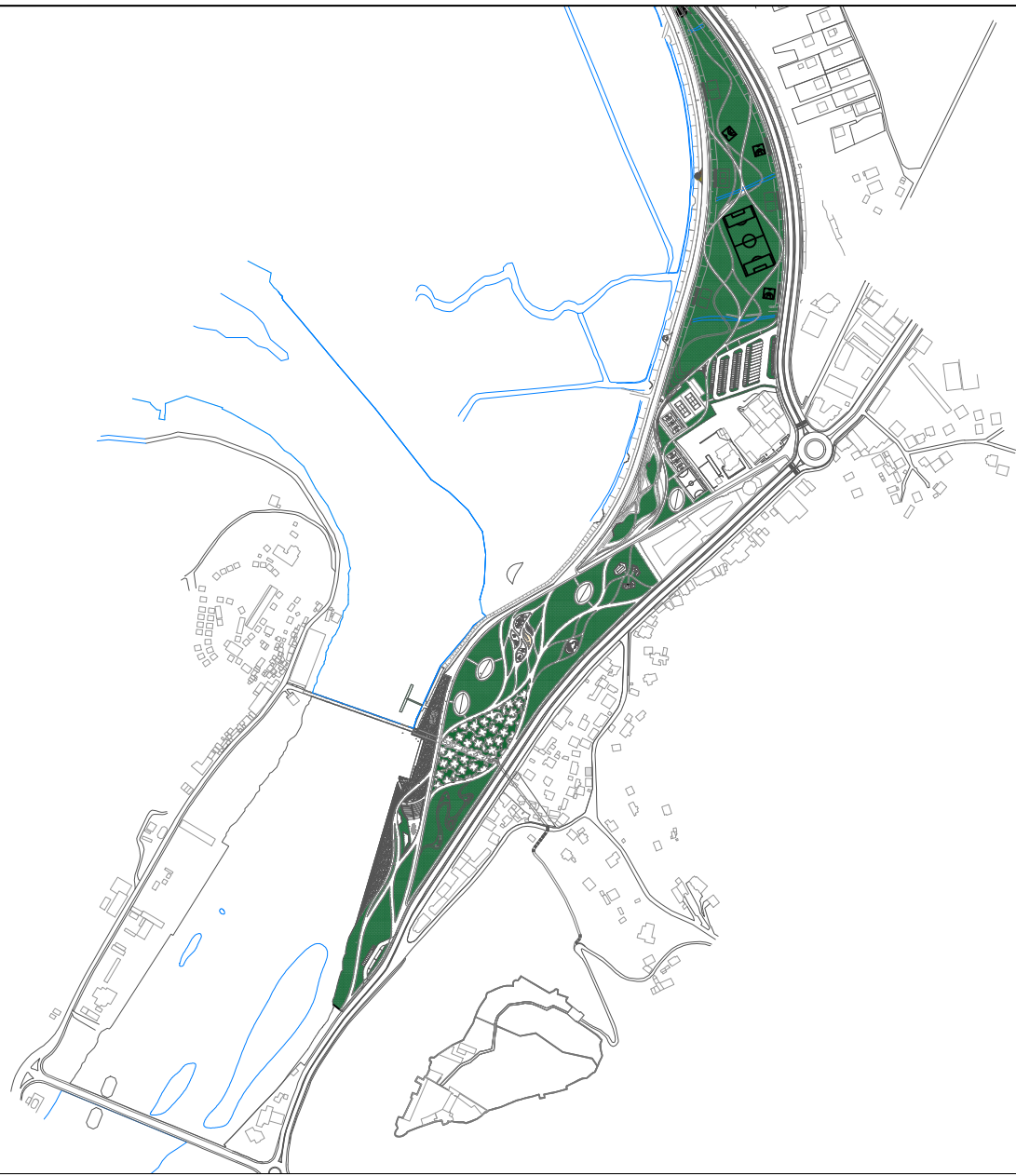
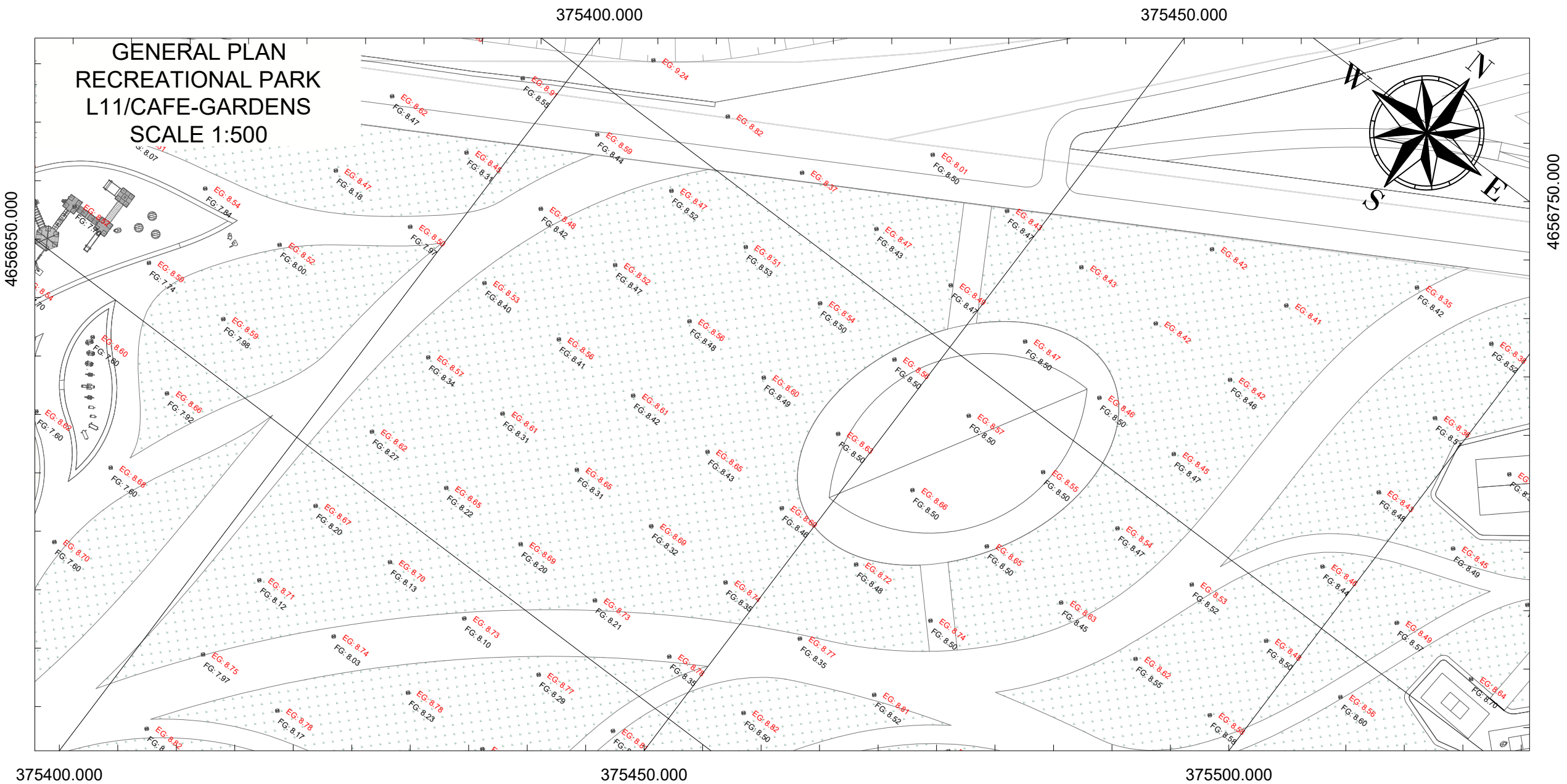
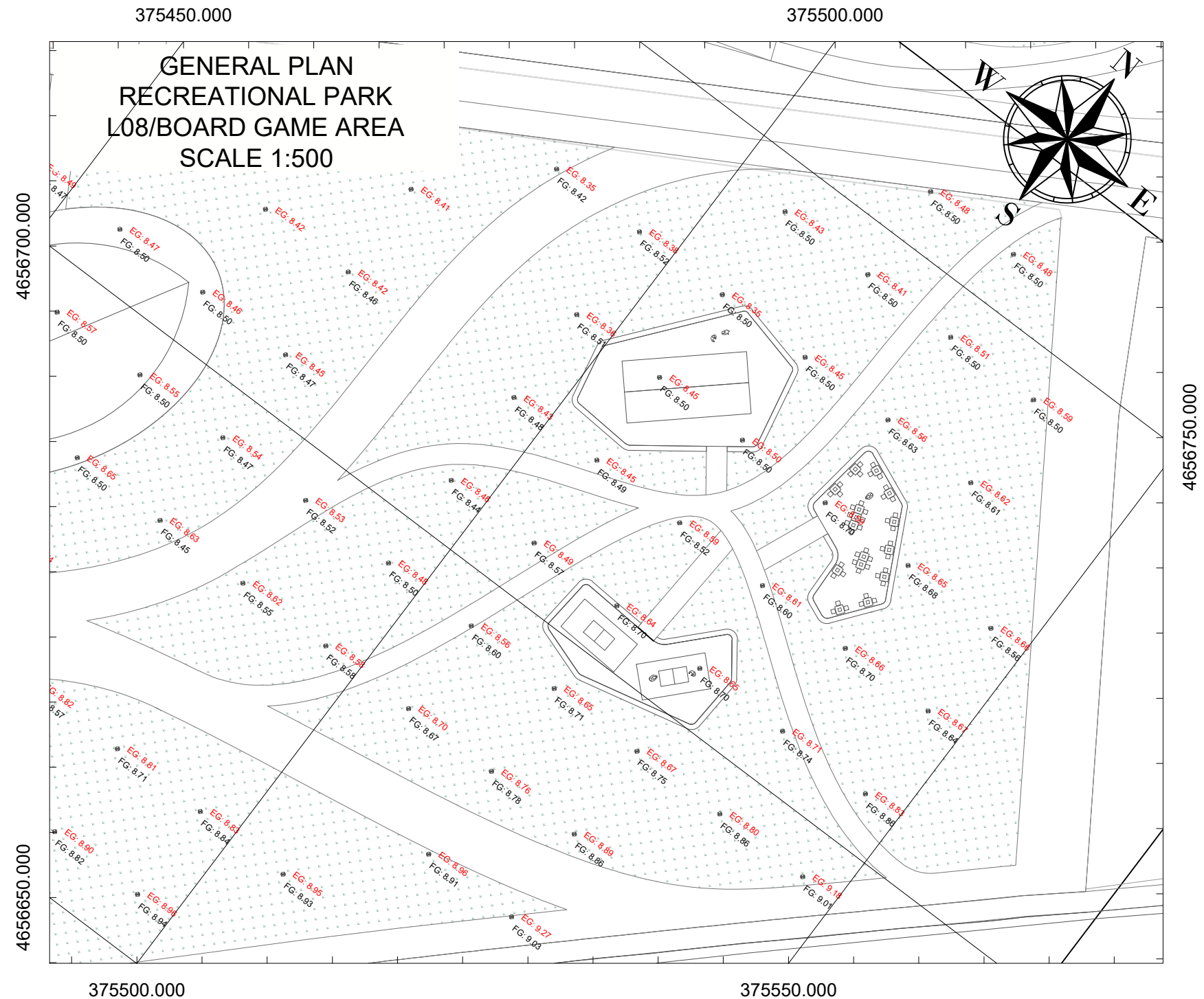
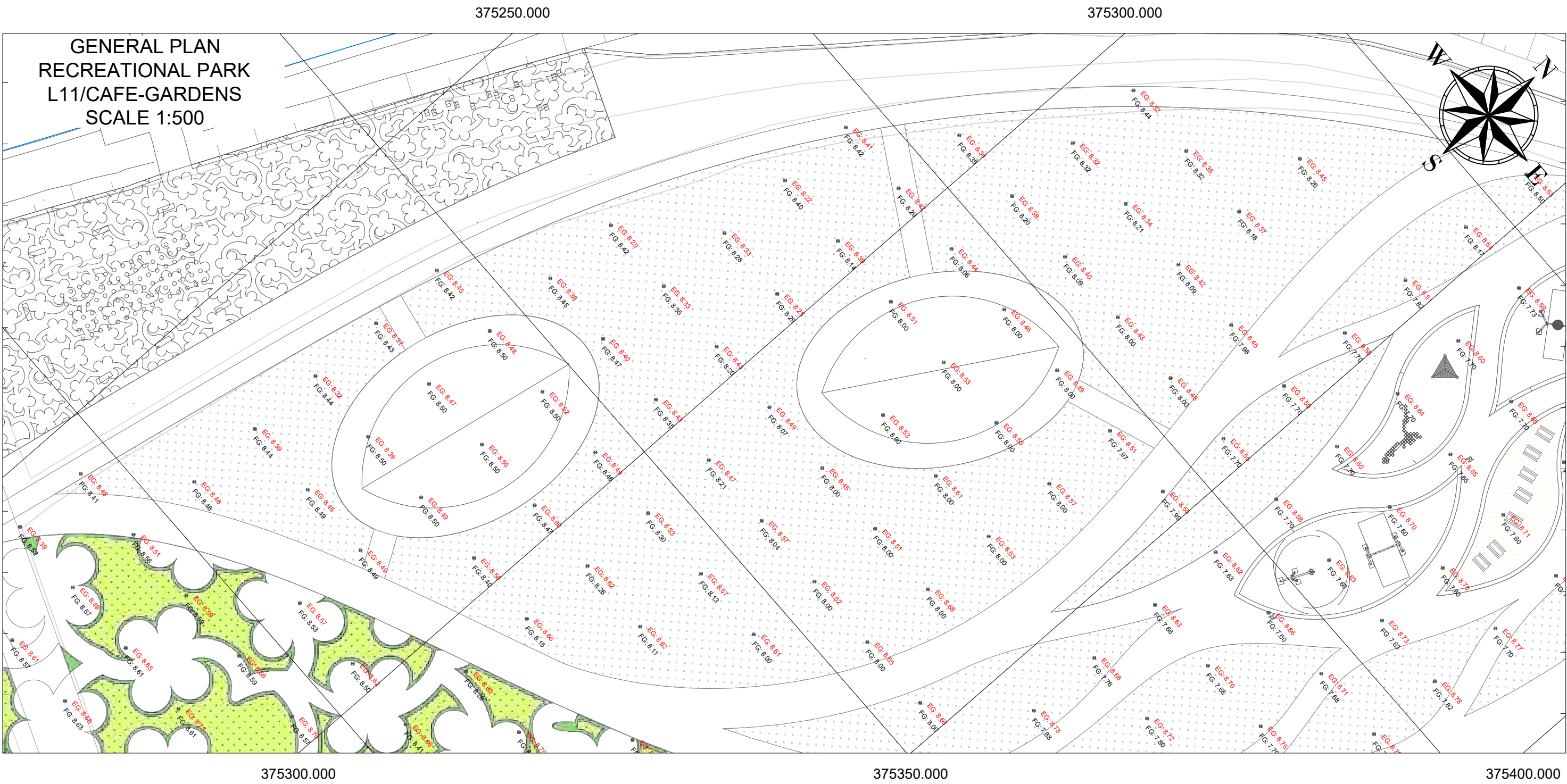
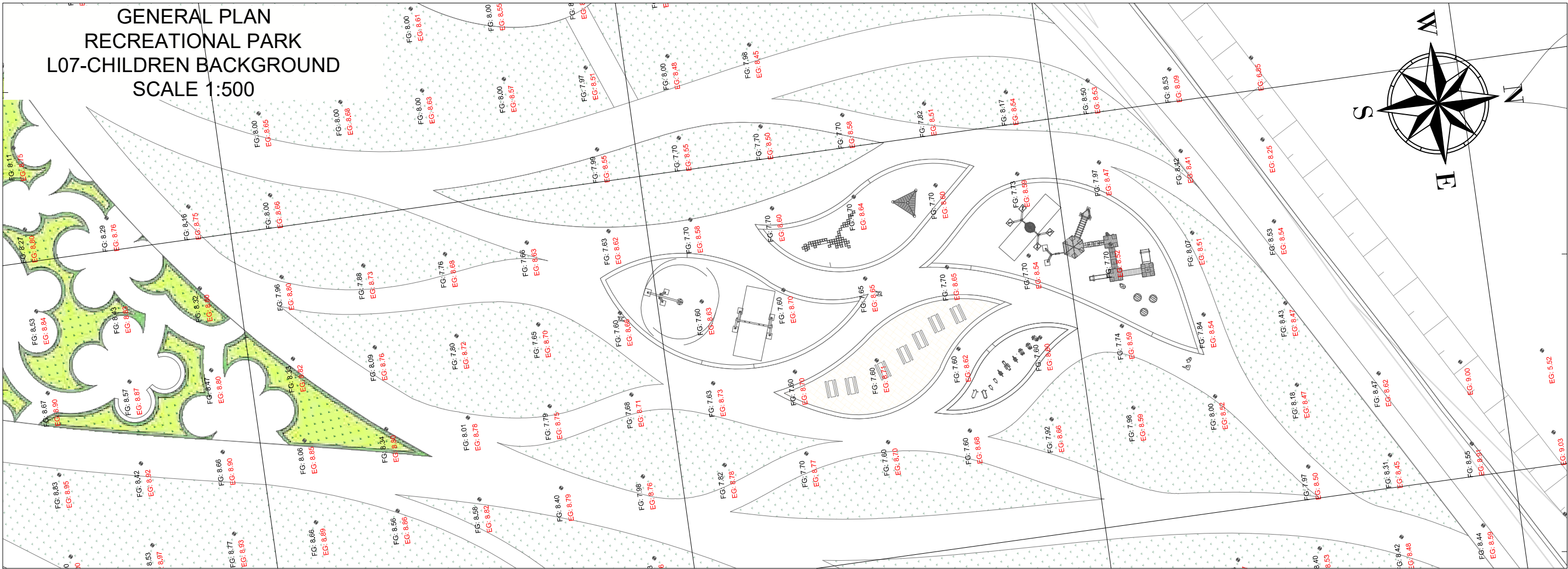
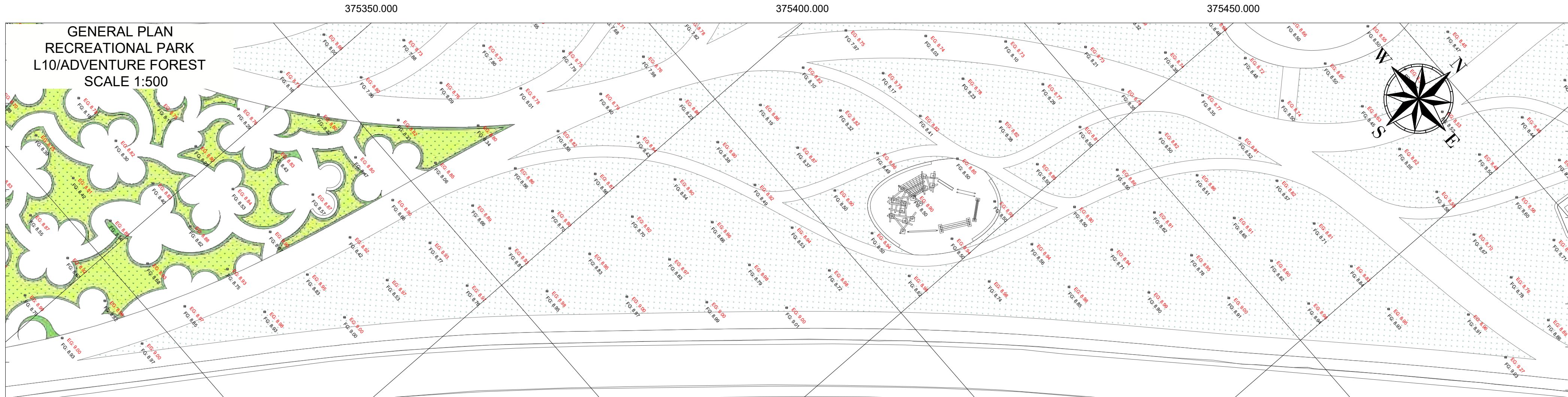

LEGEND	
SYMBOL	DESCRIPTION
EG	Existing Ground Elevation (m)
FG	Final Ground Elevation (m)
	Different Plants
	Sand
	Fine Picked Granite Cobblestone
	Compacted Gray Gravel

CLIENT:
ALBANIAN DEVELOPMENT FUND
Contact person: Emi Dautaj (Menaxhere Kontrates)
Rr. 'Samir Frasheri', Nr. 10, Tirana, Albania
Phone / Fax: 00355 4 234 885
E-mail: edautaj@albanianidf.org

CASANOVA+HERNANDEZ ARCHITECTS
NIPT L82015014E
Contact person: Mr. Jesus Hernandez
Ibrahim Rugova, Pallati 17, H3, Apt. 12, Tirana
tel: +31 (0)10 2409333
contact@casanova-hernandez.com

SRP Albanian Engineering s.h.p.k.
NUIS L81728013G
Contact person: Blerim Kurti
Rruga Tom Piezha, Pallati Kiensi, Shkalla 4, Kall 1, Ap. 2, Yzberisht, Tirane 1051, Albania
Tel: +355 48 272 528
Mobile: +355 68 2020 335
E-mail: blerim.kurti@srp-consult.de

SRP Schneider & Partner, Ingenieur-Consult GmbH
Augustaanlage 50, D-66165 Mannheim, Germany
Handelsregister-Nr.: HRB 2085 Coburg
Contact person: Frank Ehrlicher, Director International Division SRP
Tel: +49 621 400 462 - 11
Mobile: +49 170 916 25 74
E-mail: frank.ehrlicher@srp-consult.de

DD-C-GP--2-01 GENERAL PLAN OF RECREATIONAL PARK			
Drawing number	Description		
Detailed Design	1067 x 594 mm.	1:500	22-09-2022
Phase	Format	Scale	Date
L077	Master Plan of Interventions at the Entrance of Shkodra		
Project number	Project name		

casanova+hernandez architects
SRP Schneider & Partner, Ingenieur-Consult GmbH
SRP Albanian Engineering sh.p.k

Lombardade 24A
3011 AH Rotterdam
T +31 (0)10 240 9333
F +31 (0)10 240 9329
contact@casanova-hernandez.com

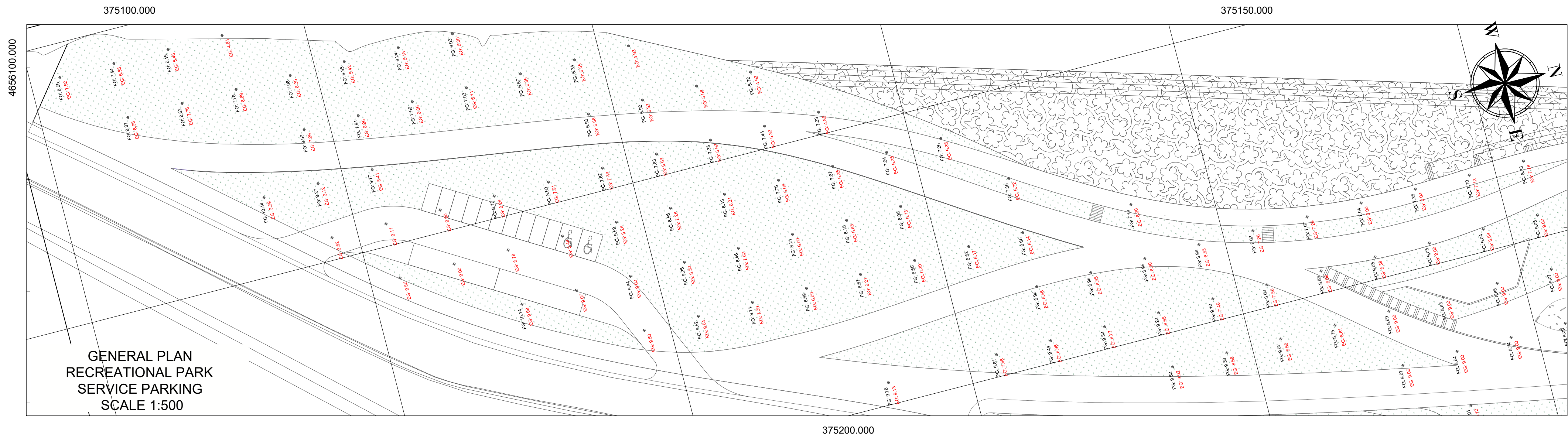
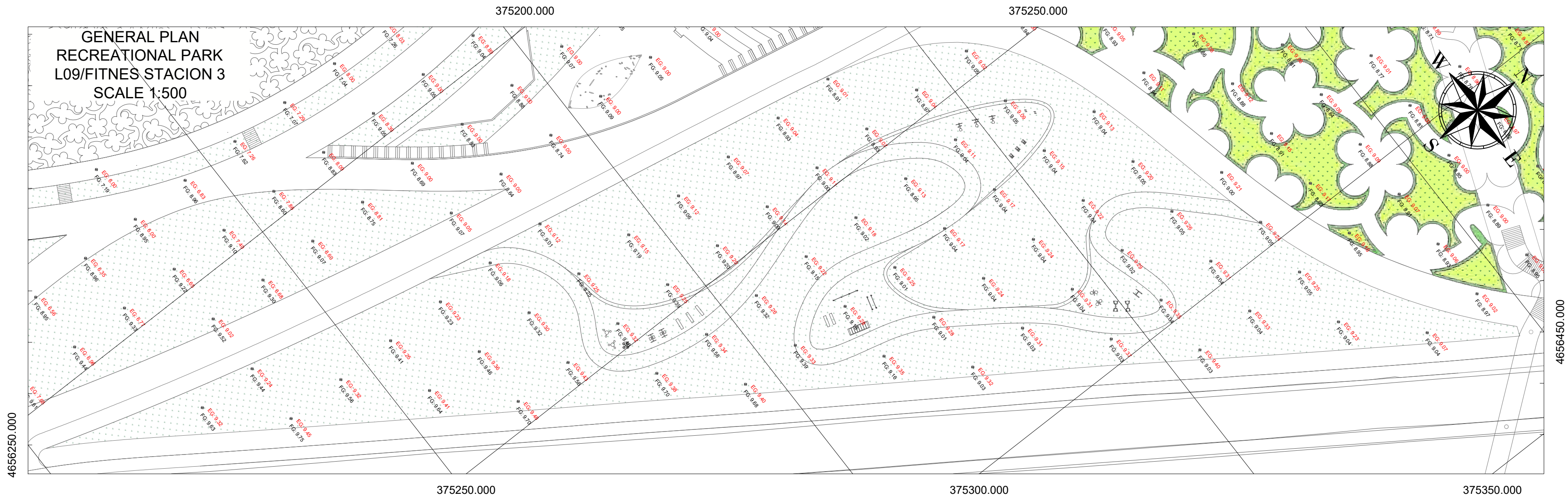
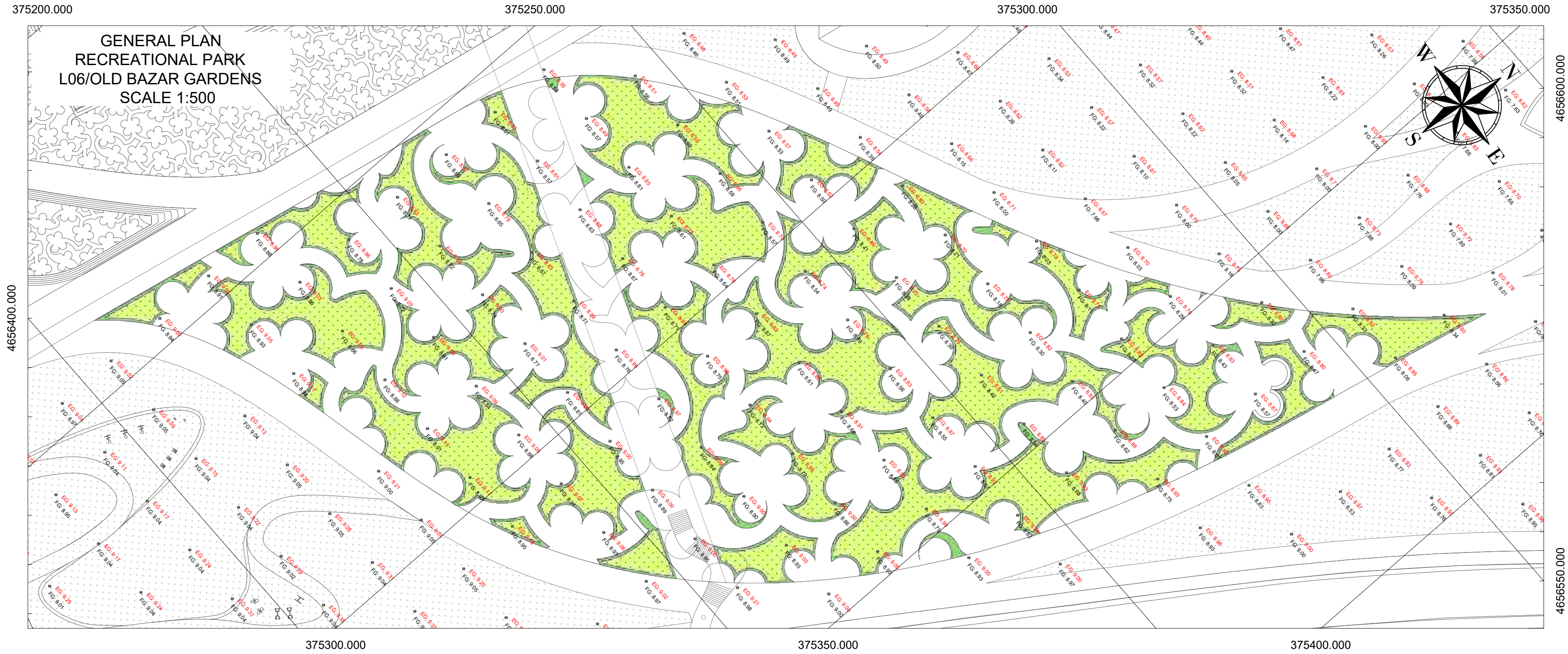

LEGEND	
SYMBOL	DESCRIPTION
EG	Existing Ground Elevation (m)
FG	Final Ground Elevation (m)
	Different Plants
	Sand
	Fine Picked Granite Cobblestone
	Compacted Gray Gravel

CLIENT:
ALBANIAN DEVELOPMENT FUND
Contact person: Emi Dautaj (Menaxhere Kontrates)
Rr. 'Samir Frasheri', Nr. 10, Tirana, Albania
Phone / Fax: 00355 4 234 885
E-mail: edautaj@albanianidf.org

CASANOVA+HERNANDEZ ARCHITECTS
NIPT L82018014E
Contact person: Mr. Jesus Hernandez
Ibrahim Rugova, Pallati Klensi, Shkalla 4, Kall 1, Ap. 2, Yzberisht, Tirane 1051, Albania
Tel: +355 48 272 528
Mobile: +355 68 2020 335
contact@casanova-hernandez.com

SRP Albanian Engineering s.h.p.k.
NUIS L81728013G
Contact person: Blerim Kurti
Rruga Tom Piezha, Pallati Klensi, Shkalla 4, Kall 1, Ap. 2, Yzberisht, Tirane 1051, Albania
Tel: +355 48 272 528
Mobile: +355 68 2020 335
E-mail: blerim.kurti@srp-consult.de

SRP Schneider & Partner, Ingenieur-Consult GmbH
Augustaanlage 50, D-68165 Mannheim, Germany
Handelsregister-Nr.: HRB 2085 Coburg
Contact person: Frank Ehrlicher, Director International Division SRP
Tel: +49 / 621 400 462 - 11
Mobile: +49 / 170 916 25 74
E-mail: frank.ehrlicher@srp-consult.de

DD-C-GP-2-02		GENERAL PLAN OF RECREATIONAL PARK	
Drawing number	Description		
Detailed Design	1067 x 594 mm.	1:500	22-09-2022
Phase	Format	Scale	Date
L077	Master Plan of Interventions at the Entrance of Shkodra		
Project number	Project name		

casanova+hernandez architects
SRP Schneider & Partner, Ingenieur-Consult GmbH
SRP Albanian Engineering sh.p.k

Lombardskade 24A
3011 AH Rotterdam
T +31 (0)10 240 9333
F +31 (0)10 240 9329
contact@casanova-hernandez.com