

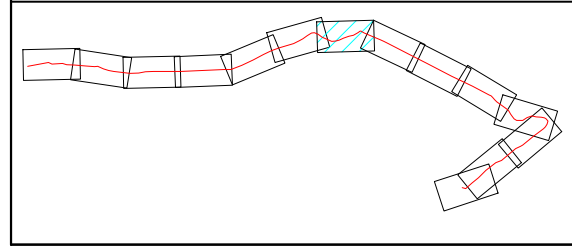

Ura Domje

Tagan

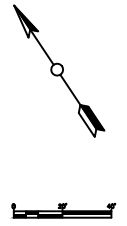
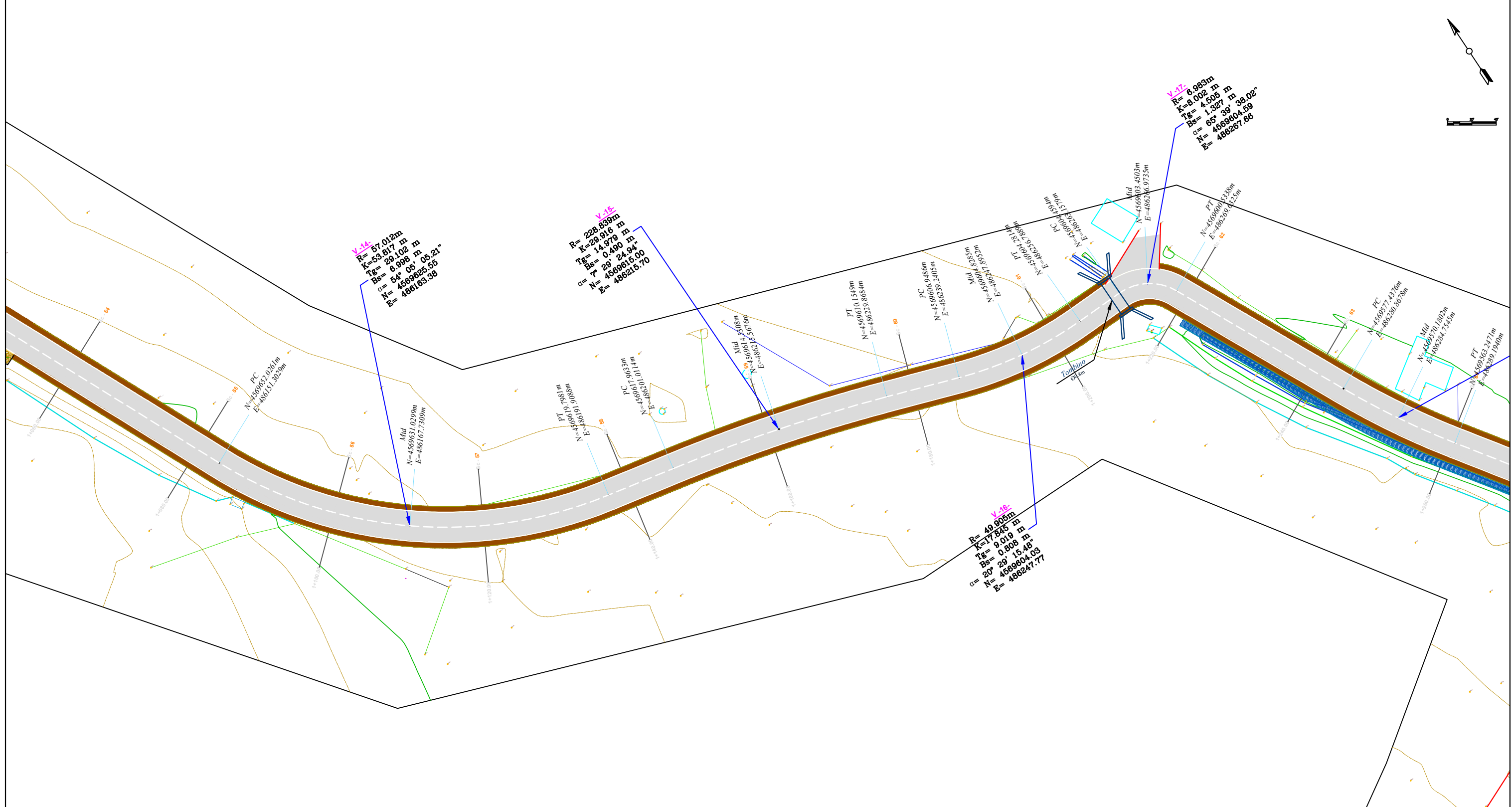

**SHPJEGUES**

× 156.95	Pike detaje
158.0	Izohipse
	Objekt
	Rrugë

Porositi :



**BASHKIA TIRANË**

Projektoi:

**"LENI-ING" sh.p.k**  
Liçens: N.2969

**"INVICTUS" sh.p.k**  
Liçens: N.6708

Adresa: Rr. Uran Pano, Pallati 12 kat, Kati 2  
Mobile: 0682042270  
Email: leni-ing@hotmail.com

Grupi i Projektimit:

Arkitekt	Albert Lleshi	A.1269
Ing. Strukturist	Nikoll Paluca	K.0001
Ing. Strukturist	Maltin Grabovaj	
Ing. Hidroteknik	Andrin Kerpaci	K.1236
Ing. Gjeolog	Ibrahim Milushi	GJ.0621
Ing. Topograf	Mehill Pacuku	T.0043
Ing. Elektrik	Nikoll Pali	E.0157

Objekti: "Ndërtim i Rrugës " Ura Domje –Lagjia Tagan"

Faza: **Projekt - Zbatim**

Emërtimi i Fletës:	Shkalla:	Tiranë 2018
PLANIMETRIA E RRUGES	Sh 1:500	PL- 7

Ura Domje

Tagan

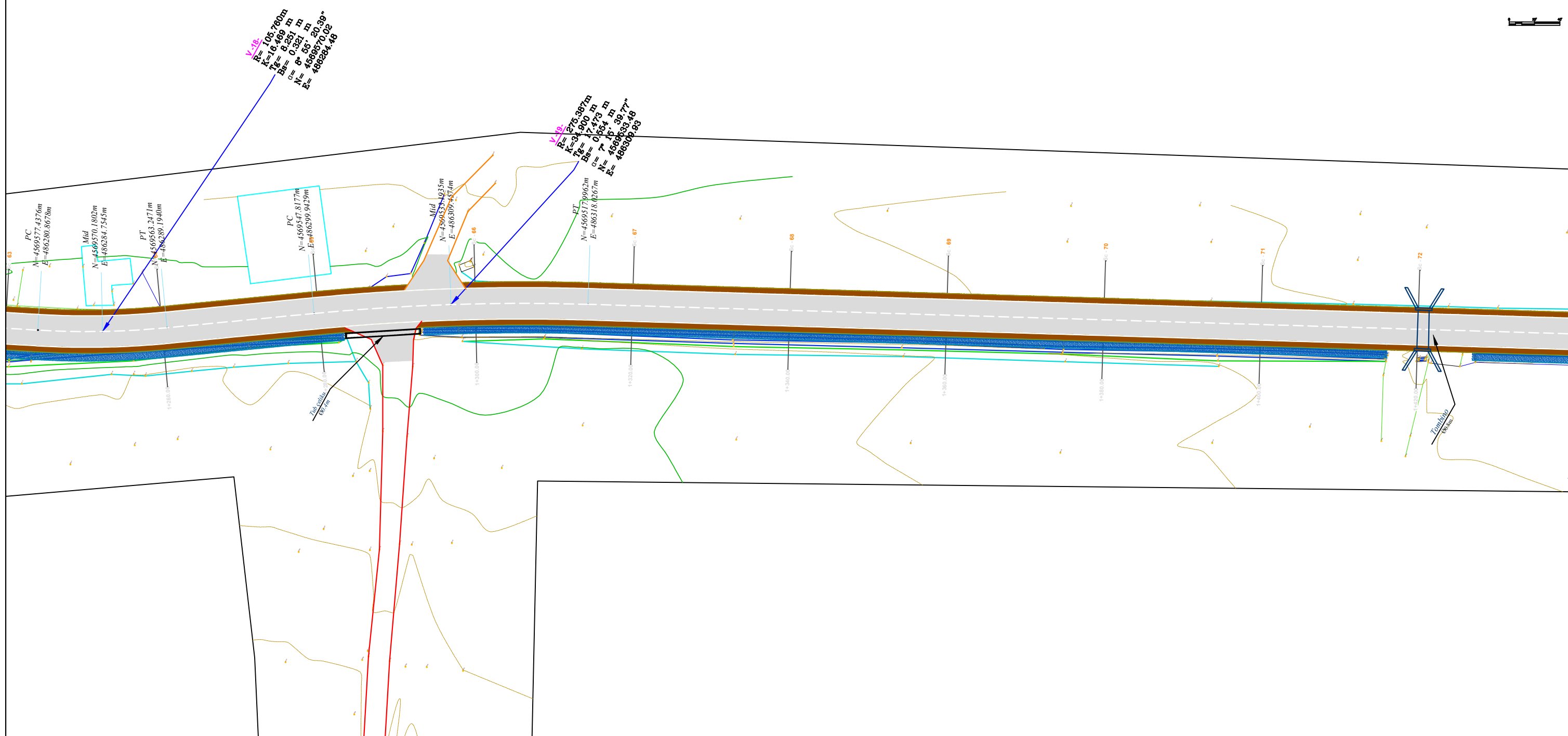
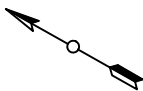

**SHPJEGUES**

	× 156.95	<b>Pike detaje</b>
	158.0	<b>Izohipse</b>
		<b>Objekt</b>
		<b>Rrugë</b>

Porositi :



**BASHKIA  
TIRANË**

Projektoi:

**"LENI-ING" sh.p.k**  
Liçens: N.2969

**"INVICTUS" sh.p.k**  
Liçens: N.6708

Adresa: Rr. Uran Pano, Pallati 12 kat, Kati 2  
Mobile: 0682042270  
Email: leni-ing@hotmail.com

Grupi i Projektimit:

Arkitekt	Albert Lleshi	A.1269
Ing. Strukturist	Nikoll Paluca	K.0001
Ing. Strukturist	Maltin Grabovaj	
Ing. Hidroteknik	Andrin Kerpaci	K.1236
Ing. Gjeolog	Ibrahim Milushi	GJ.0621
Ing. Topograf	Mehill Pacuku	T.0043
Ing. Elektrik	Nikoll Pali	E.0157

Objekti: "Ndërtim i Rrugës " Ura Domje –Lagjia Tagan"		
Faza: <b>Projekt - Zbatim</b>		
Emërtimi i Fletës: PLANIMETRIA E RRUGES	Shkalla: Sh 1:500	Tiranë 2018 PL- 8

Ura Domje

Tagan

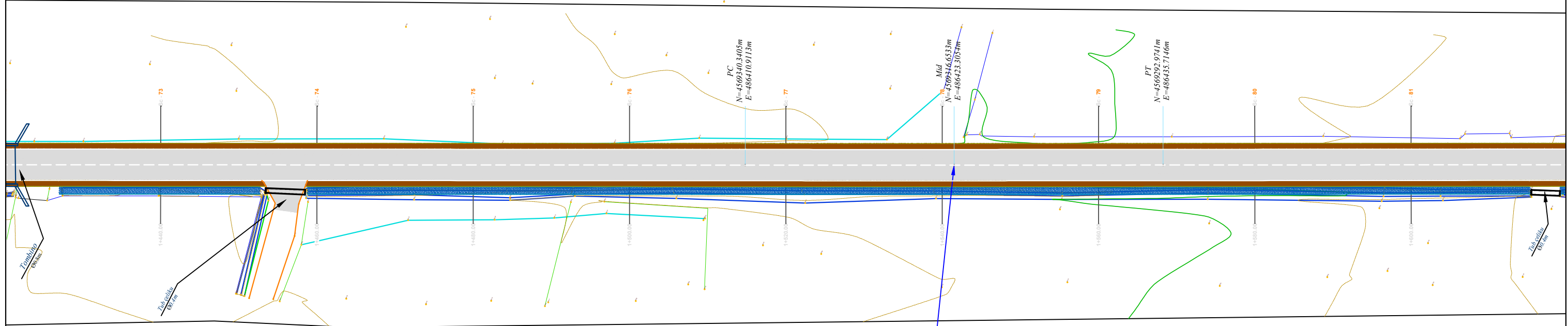
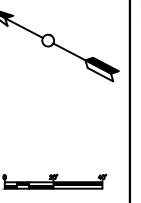

$R= 41949.871m$   
 $K= 33.468m$   
 $Tg= 26.734m$   
 $Bs= 0.009m$   
 $\alpha= 0^\circ 04' 23.80''$   
 $N= 4569316.85$   
 $E= 486423.30$

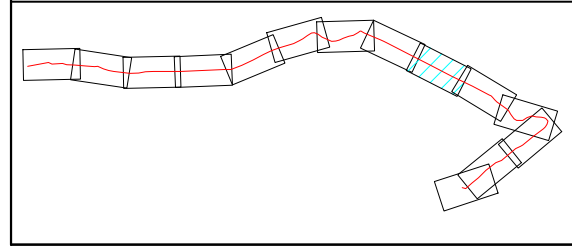

**SHPJEGUES**

$\times 156.95$	<b>Pike detaje</b>
$158.0$	<b>Izohipse</b>
	<b>Objekt</b>
	<b>Rrugë</b>

Porositi :



**BASHKIA TIRANË**

Projektoi:

**"LENI-ING" sh.p.k**  
Liçens: N.2969

**"INVICTUS" sh.p.k**  
Liçens: N.6708

Adresa: Rr. Uran Pano, Pallati 12 kat, Kati 2  
Mobile: 0682042270  
Email: leni-ing@hotmail.com

Grupi i Projektimit:

Arkitekt	Albert Lleshi	A.1269
Ing. Strukturist	Nikoll Paluca	K.0001
Ing. Strukturist	Maltin Grabovaj	
Ing. Hidroteknik	Andrin Kerpaci	K.1236
Ing. Gjeolog	Ibrahim Milushi	GJ.0621
Ing. Topograf	Mehill Pacuku	T.0043
Ing. Elektrik	Nikoll Pali	E.0157

Objekti: "Ndërtim i Rrugës " Ura Domje –Lagjia Tagan"		
Faza: <b>Projekt - Zbatim</b>		
Emërtimi i Fletës:	Shkalla:	Tiranë 2018
PLANIMETRIA E RRUGES	Sh 1:500	PL- 9

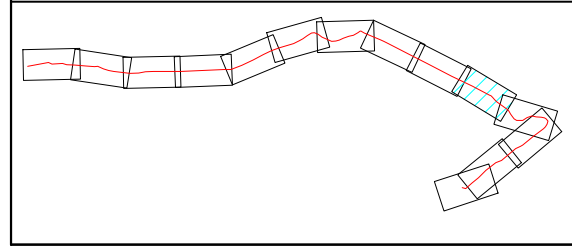
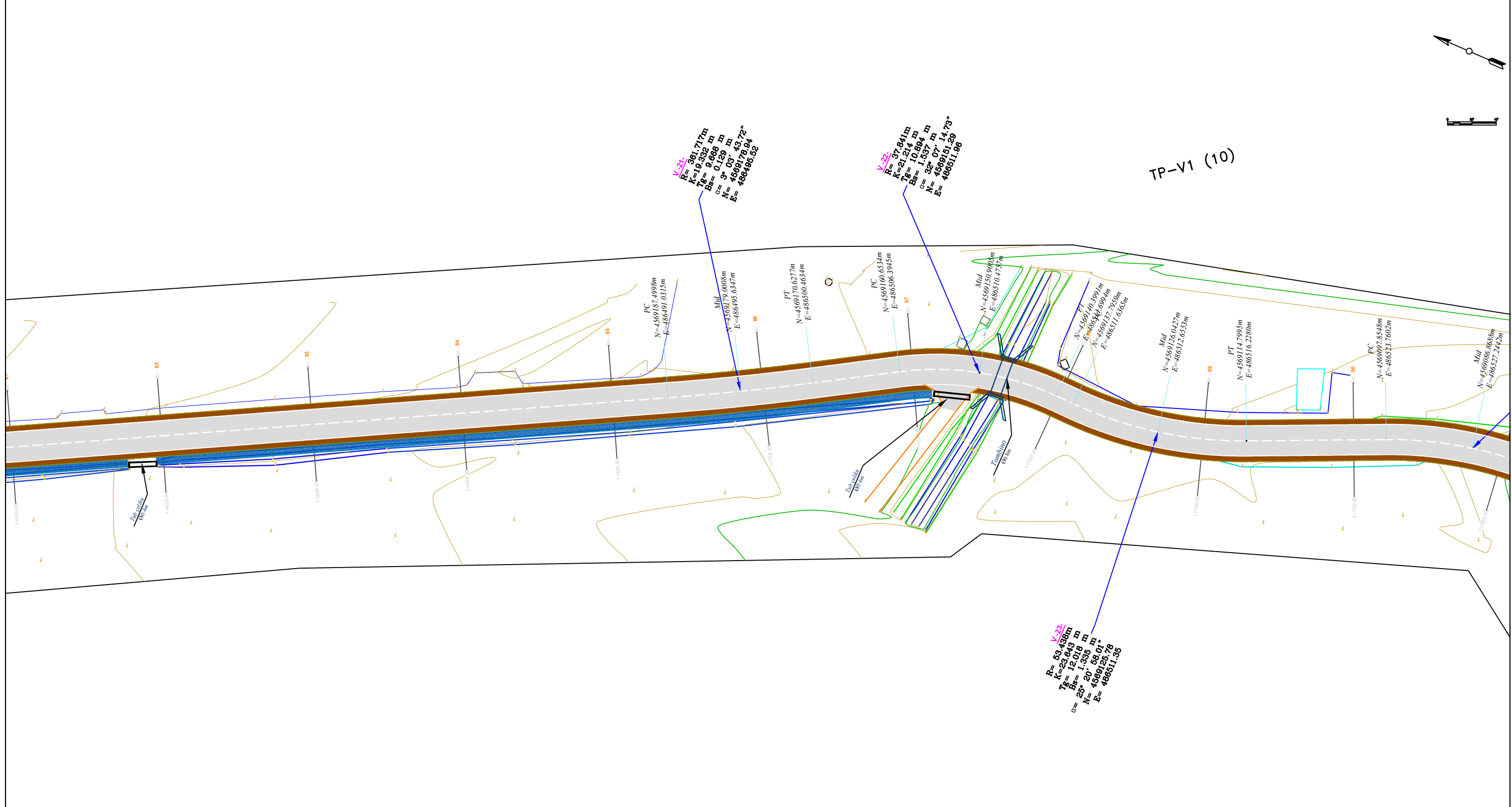
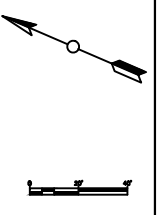

**SHPJEGUES**

- × 156.95 **Pike detaje**
- 158.0 **Izohipse**
- Objekt**
- Rrugë**

Porositi :

**BASHKIA TIRANË**

Projektoi:

**"LENI-ING" sh.p.k**  
 Liçens: N.2969

**"INVICTUS" sh.p.k**  
 Liçens: N.6708

Adresa: Rr. Uran Pano, Pallati 12 kat, Kati 2  
 Mobile: 0682042270  
 Email: leni-ing@hotmail.com

Grupi i Projektimit:

Arkitekt	Albert Lleshi	A.1269
Ing. Strukturist	Nikoll Paluca	K.0001
Ing. Strukturist	Maltin Grabovaj	
Ing. Hidroteknik	Andrin Kerpaci	K.1236
Ing. Gjeolog	Ibrahim Milushi	GJ.0621
Ing. Topograf	Mehill Pacuku	T.0043
Ing. Elektrik	Nikoll Pali	E.0157

Objekti: "Ndërtim i Rrugës " Ura Domje –Lagjia Tagan"		
Faza: <b>Projekt - Zbatim</b>		
Emërtimi i Fletës:	Shkalla:	Tiranë 2018
PLANIMETRIA E RRUGES	Sh 1:500	PL- 10

Ura Domje

Tagan

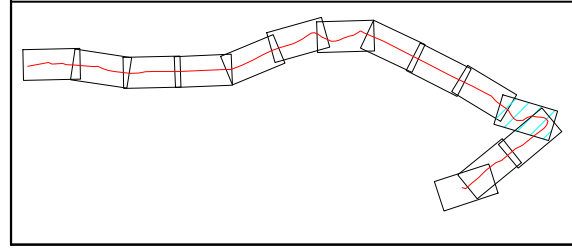
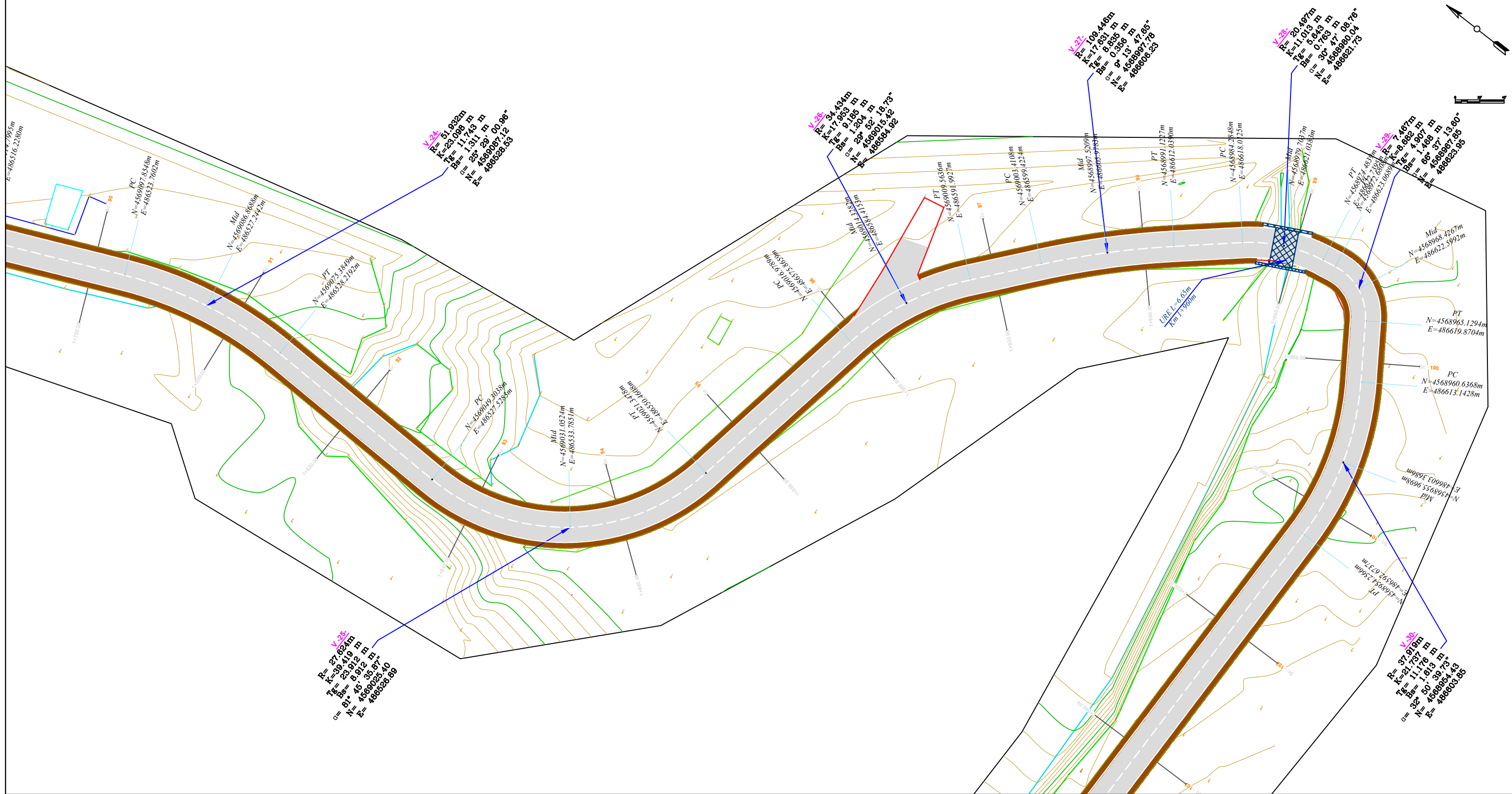

**SHPJEGUES**

- × 156.95 Pike detaje
- 158.0 Izohipse
- Objekt
- Rrugë

Porositi :

**BASHKIA TIRANË**

Projektoi:

**"LENI-ING" sh.p.k**  
Liçens: N.2969

**"INVICTUS" sh.p.k**  
Liçens: N.6708

Adresa: Rr. Uran Pano, Pallati 12 kat, Kati 2  
Mobile: 0682042270  
Email: leni-ing@hotmail.com

Grupi i Projektimit:

Arkitekt	Albert Lleshi	A.1269
Ing. Strukturist	Nikoll Paluca	K.0001
Ing. Strukturist	Maltin Grabovaj	
Ing. Hidroteknik	Andrin Kerpaci	K.1236
Ing. Gjeolog	Ibrahim Milushi	GJ.0621
Ing. Topograf	Mehill Pacuku	T.0043
Ing. Elektrik	Nikoll Pali	E.0157

Objekti: "Ndërtim i Rrugës " Ura Domje –Lagjia Tagan"

Faza: **Projekt - Zbatim**

Emërtimi i Fletës:	Shkalla:	Tiranë 2018
PLANIMETRIA E RRUGES	Sh 1:500	PL- 11

Ura Domje

Tagan

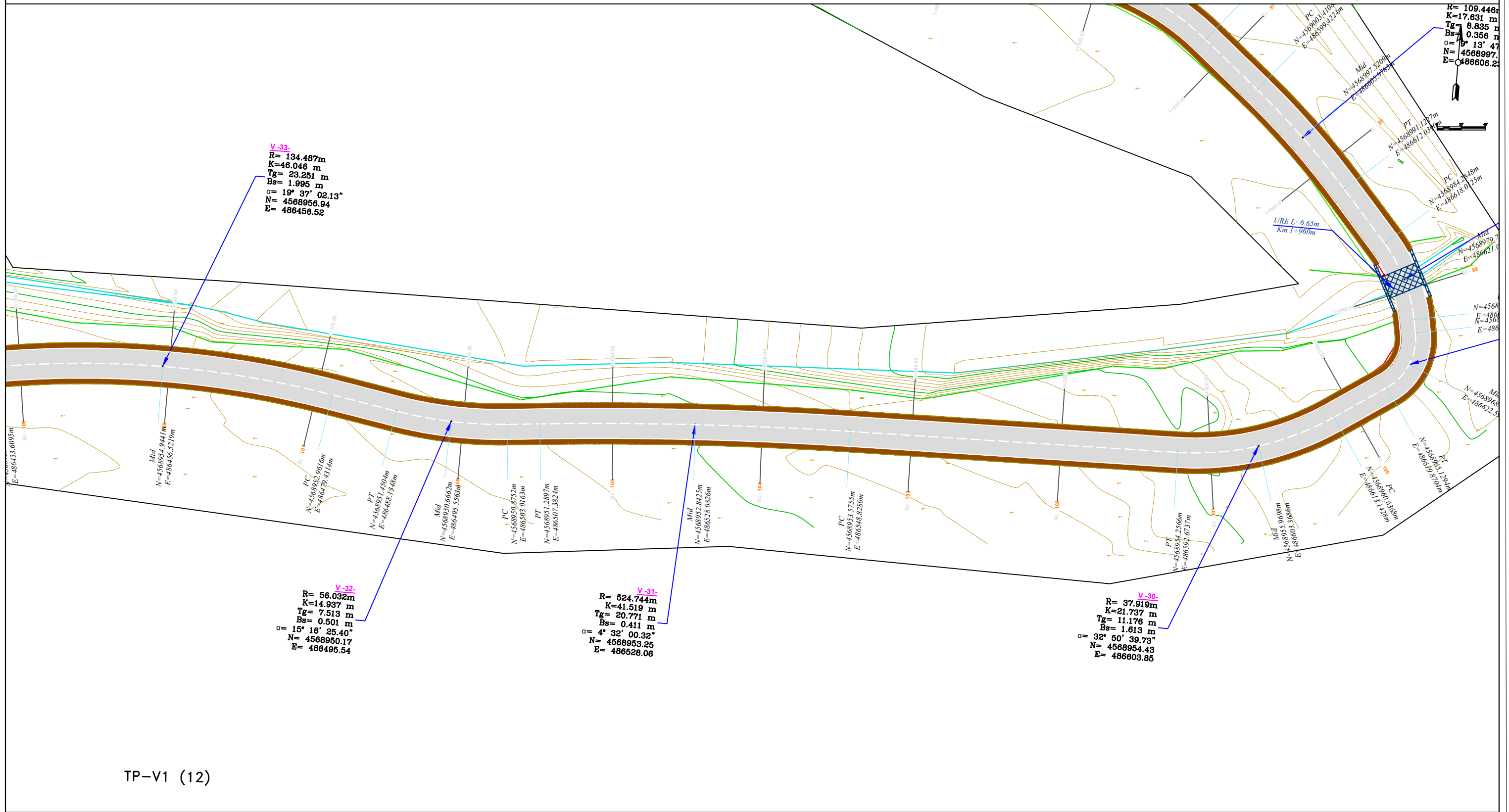

TP-V1 (12)

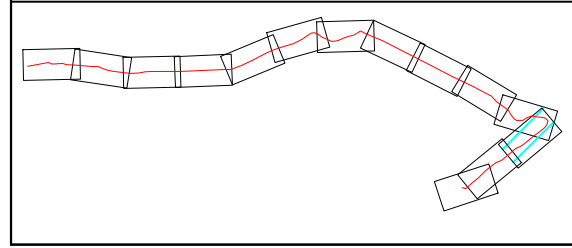

**SHPJEGUES**

	× 156.95	<b>Pike detaje</b>
	158.0	<b>Izohipse</b>
		<b>Objekt</b>
		<b>Rrugë</b>

Porositi :



**BASHKIA  
TIRANË**

Projektoi:

**"LENI-ING" sh.p.k**  
Liçens: N.2969

**"INVICTUS" sh.p.k**  
Liçens: N.6708

Adresa: Rr. Uran Pano, Pallati 12 kat, Kati 2  
Mobile: 0682042270  
Email: leni-ing@hotmail.com

Grupi i Projektimit:

Arkitekt	Albert Lleshi	A.1269
Ing. Strukturist	Nikoll Paluca	K.0001
Ing. Strukturist	Maltin Grabovaj	
Ing. Hidroteknik	Andrin Kerpaci	K.1236
Ing. Gjeolog	Ibrahim Milushi	GJ.0621
Ing. Topograf	Mehill Pacuku	T.0043
Ing. Elektrik	Nikoll Pali	E.0157

Objekti: "Ndërtim i Rrugës " Ura Domje –Lagjia Tagan"

Faza:	<b>Projekt - Zbatim</b>	
Emërtimi i Fletës:	Shkalla:	Tiranë 2018
PLANIMETRIA E RRUGES	Sh 1:500	PL- 12

Ura Domje

Tagan

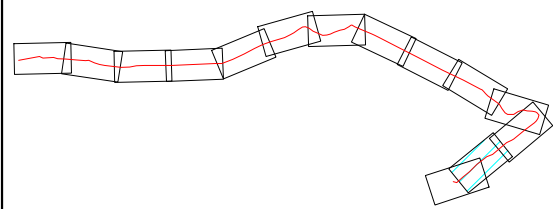
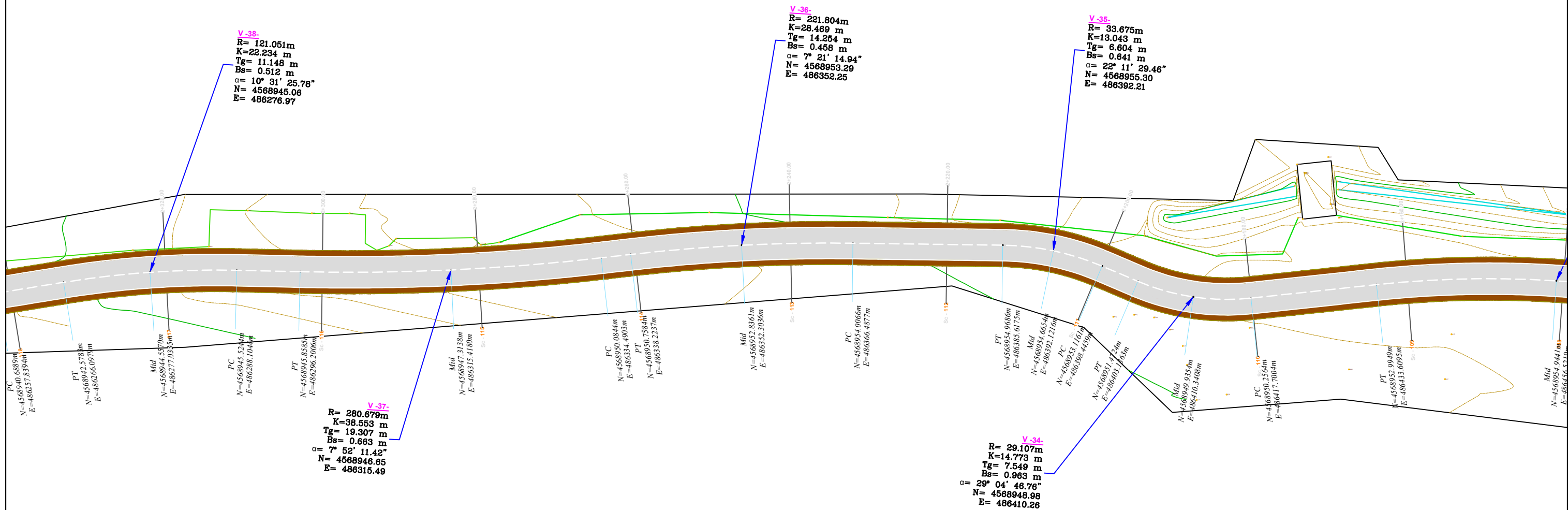
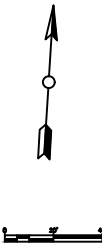

**SHPJEGUES**

- x 156.95 **Pike detaje**
- 158.0 **Izohipse**
- Objekt**
- Rrugë**

Porositi :



Projektoi:

**"LENI-ING" sh.p.k**  
 Liçens: N.2969  
**"INVICTUS" sh.p.k**  
 Liçens: N.6708

Adresa: Rr. Uran Pano, Pallati 12 kat, Kati 2  
 Mobile: 0682042270  
 Email: leni-ing@hotmail.com

Grupi i Projektimit:

Arkitekt	Albert Lleshi	A.1269
Ing. Strukturist	Nikoll Paluca	K.0001
Ing. Strukturist	Maltin Grabovaj	
Ing. Hidroteknik	Andrin Kerpaci	K.1236
Ing. Gjeolog	Ibrahim Milushi	GJ.0621
Ing. Topograf	Mehill Pacuku	T.0043
Ing. Elektrik	Nikoll Pali	E.0157

Objekti: "Ndërtim i Rrugës " Ura Domje –Lagjia Tagan"

Faza: **Projekt - Zbatim**

Emërtimi i Fletës:	Shkalla:	Tiranë 2018
PLANIMETRIA E RRUGES	Sh 1:500	PL- 13



Ura Domje

Tagan

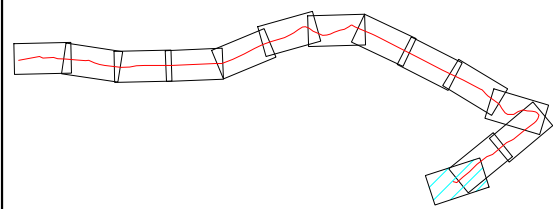
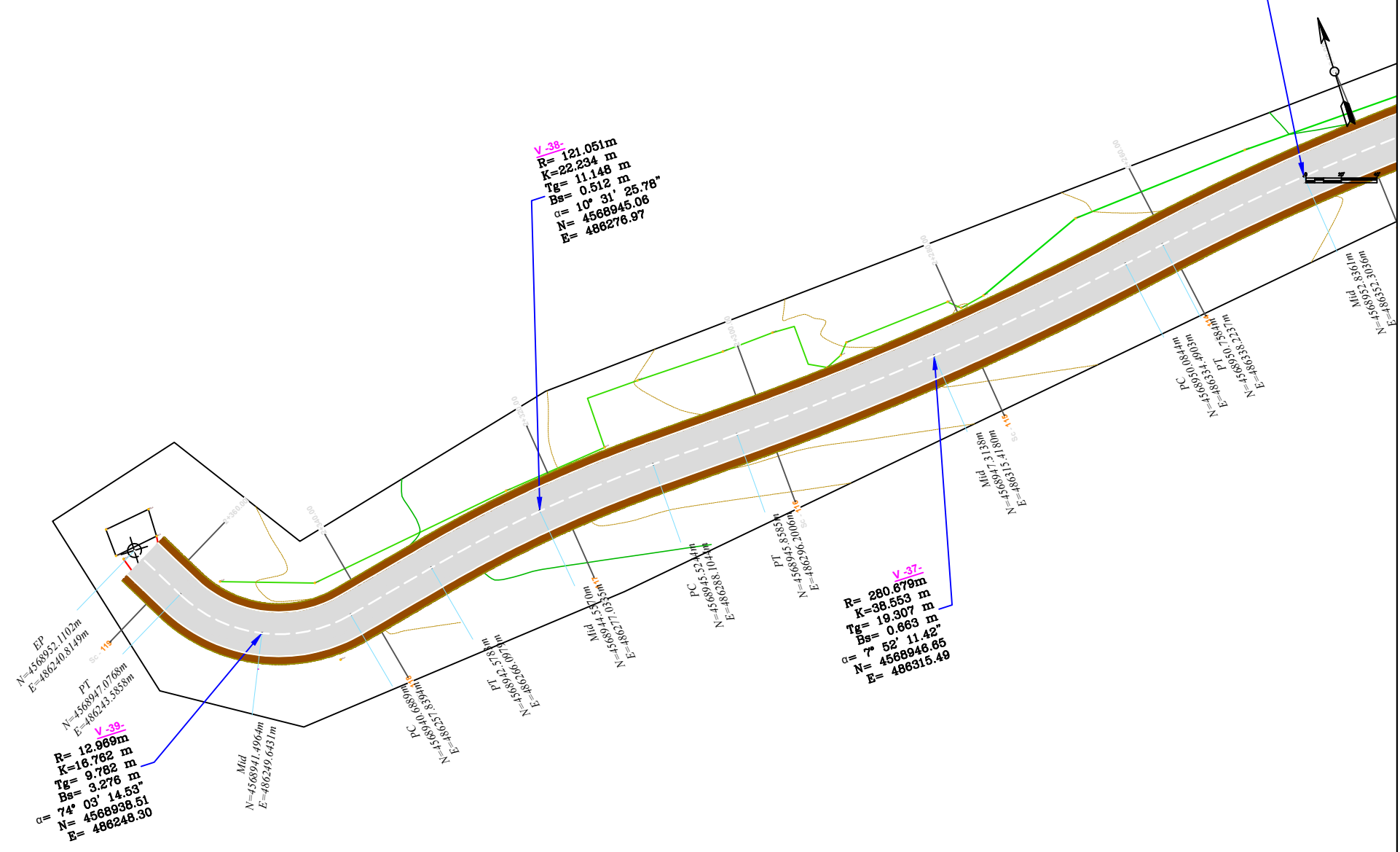

**SHPJEGUES**

	<b>Pike detaje</b>
	<b>Izohipse</b>
	<b>Objekt</b>
	<b>Rrugë</b>

Porositi :



**BASHKIA  
TIRANË**

Projektoi:

**"LENI-ING" sh.p.k**  
 Liçens: N.2969

**"INVICTUS" sh.p.k**  
 Liçens: N.6708

Adresa: Rr. Uran Pano, Pallati 12 kat, Kati 2  
 Mobile: 0682042270  
 Email: leni-ing@hotmail.com

Grupi i Projektimit:

Arkitekt	Albert Lleshi	A.1269
Ing. Strukturist	Nikoll Paluca	K.0001
Ing. Strukturist	Maltin Grabovaj	
Ing. Hidroteknik	Andrin Kerpaci	K.1236
Ing. Gjeolog	Ibrahim Milushi	GJ.0621
Ing. Topograf	Mehill Pacuku	T.0043
Ing. Elektrik	Nikoll Pali	E.0157

Objekti: "Ndërtim i Rrugës " Ura Domje –Lagjia Tagan"		
Faza: <b>Projekt - Zbatim</b>		
Emërtimi i Fletës:	Shkalla:	Tiranë 2018
PLANIMETRIA E RRUGES	Sh 1:500	PL- 14

Ura Domje

Tagan

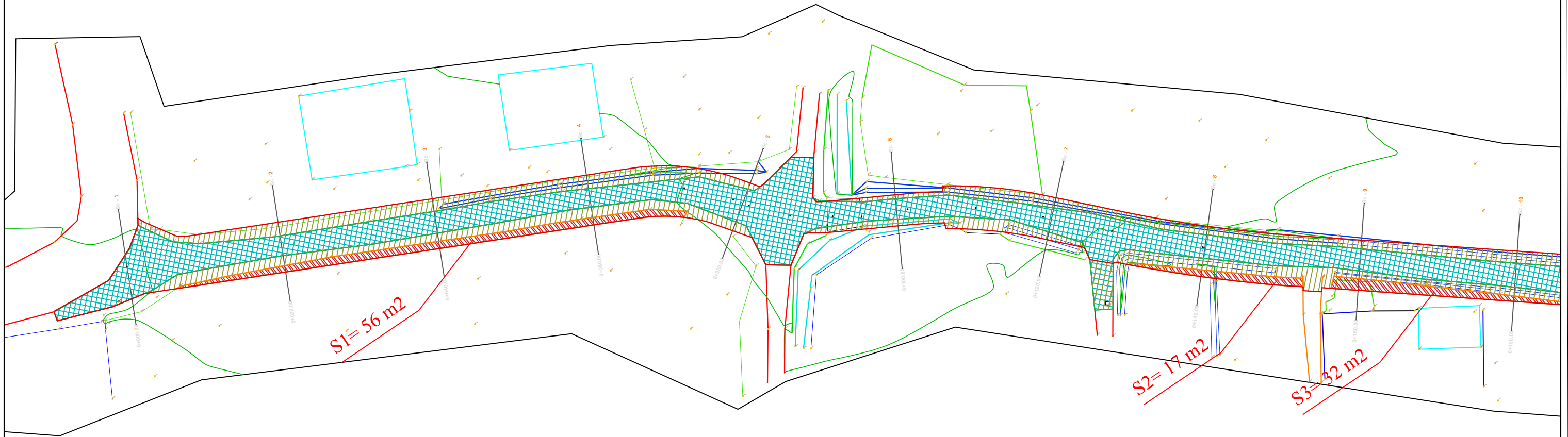
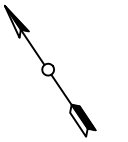

SI= 56 m2

S2= 17 m2

S3= 32 m2

**SHPJEGUES**

-  Siperfaqe e rrugë ekzistuese
-  Siperfaqe se trupit te rruges ekzistues
-  Siperfaqe për shpronësim

Porositi :



Projektoi:

**"LENI-ING" sh.p.k**  
Liçens: N.2969

**"INVICTUS" sh.p.k**  
Liçens: N.6708

Adresa: Rr. Uran Pano, Pallati 12 kat, Kati 2  
Mobile: 0682042270  
Email: leni-ing@hotmail.com

Grupi i Projektimit:

- |                  |                 |         |
|------------------|-----------------|---------|
| Arkitekt         | Albert Lleshi   | A.1269  |
| Ing. Strukturist | Nikoll Paluca   | K.0001  |
| Ing. Strukturist | Maltin Grabovaj |         |
| Ing. Hidroteknik | Andrin Kerpaci  | K.1236  |
| Ing. Gjeolog     | Ibrahim Milushi | GJ.0621 |
| Ing. Topograf    | Mehill Pacuku   | T.0043  |
| Ing. Elektrik    | Nikoll Pali     | E.0157  |

Objekti: "Ndërtim i Rrugës " Ura Domje –Lagjia Tagan"

Faza: **Projekt - Zbatimi**

Emërtimi i Fletës:  
PLANIMETRIA  
E SHPRONESIMEVE

Shkalla:  
**Sh 1:500**

Tiranë 2018

Fleta SI-01

Ura Domje

Tagan

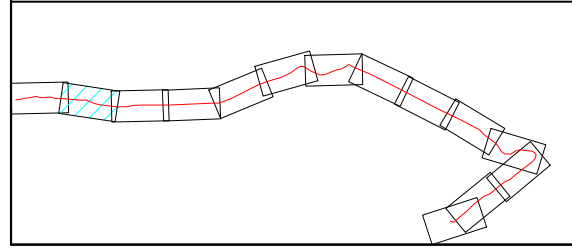
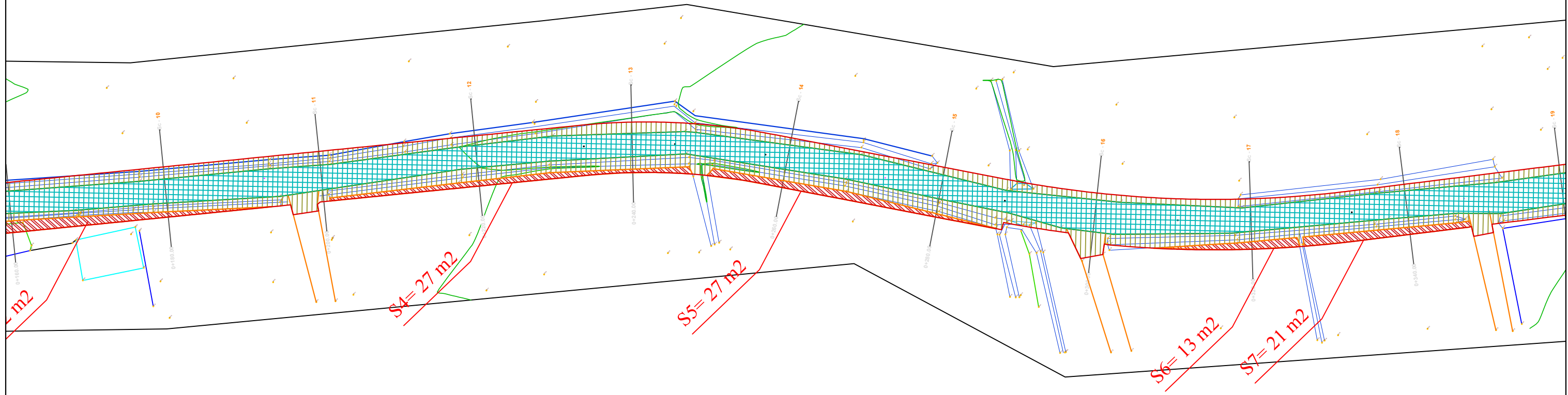
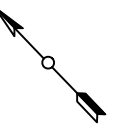

**SHPJEGUES**

	Siperfaqe e rrugë ekzistuese
	Siperfaqe se trupit te rruges ekzistues
	Siperfaqe për shpronësim

Porositi :

**BASHKIA TIRANË**

Projektoi:

**"LENI-ING" sh.p.k**  
Licens: N.2969

**"INVICTUS" sh.p.k**  
Licens: N.6708

Adresa: Rr. Uran Pano, Pallati 12 kat, Kati 2  
Mobile: 0682042270  
Email: leni-ing@hotmail.com

Grupi i Projektimit:

Arkitekt	Albert Lleshi	A.1269
Ing. Strukturist	Nikoll Paluca	K.0001
Ing. Strukturist	Maltin Grabovaj	
Ing. Hidroteknik	Andrin Kerpaci	K.1236
Ing. Gjeolog	Ibrahim Milushi	GJ.0621
Ing. Topograf	Mehill Pacuku	T.0043
Ing. Elektrik	Nikoll Pali	E.0157

Objekti: "Ndërtim i Rrugës " Ura Domje –Lagjia Tagan"		
Faza: <b>Projekt - Zbatimi</b>		
Emërtimi i Fletës: <b>PLANIMETRIA E SHPRONESIMEVE</b>	Shkalla: <b>Sh 1:500</b>	Tiranë 2018 Fleta SI-02

Ura Domje

Tagan

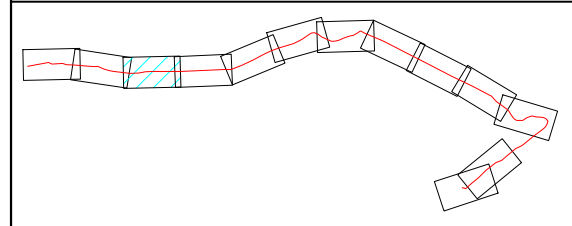
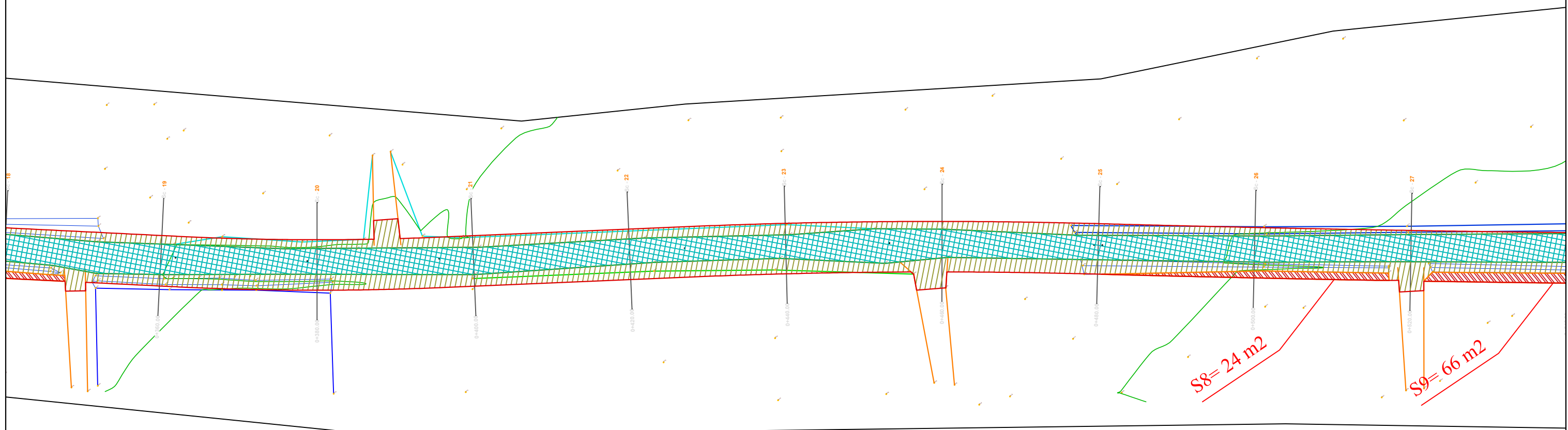
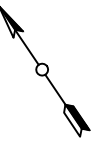

**SHPJEGUES**

	Siperfaqe e rrugë ekzistuese
	Siperfaqe se trupit te rruges ekzistues
	Siperfaqe për shpronësim

Porositi :

**BASHKIA  
TIRANË**

Projektoi:

**"LENI-ING" sh.p.k**  
Liçens: N.2969

**"INVICTUS" sh.p.k**  
Liçens: N.6708

Adresa: Rr. Uran Pano, Pallati 12 kat, Kati 2  
Mobile: 0682042270  
Email: leni-ing@hotmail.com

Grupi i Projektimit:

Arkitekt	Albert Lleshi	A.1269
Ing. Strukturist	Nikoll Paluca	K.0001
Ing. Strukturist	Maltin Grabovaj	
Ing. Hidroteknik	Andrin Kerpaci	K.1236
Ing. Gjeolog	Ibrahim Milushi	GJ.0621
Ing. Topograf	Mehill Pacuku	T.0043
Ing. Elektrik	Nikoll Pali	E.0157

Objekti: "Ndërtim i Rrugës " Ura Domje –Lagjia Tagan"		
Faza: <b>Projekt - Zbatimi</b>		
Emërtimi i Fletës: <b>PLANIMETRIA E SHPRONESIMEVE</b>	Shkalla: <b>Sh 1:500</b>	Tiranë 2018 Fleta SI-03

Ura Domje

Tagan

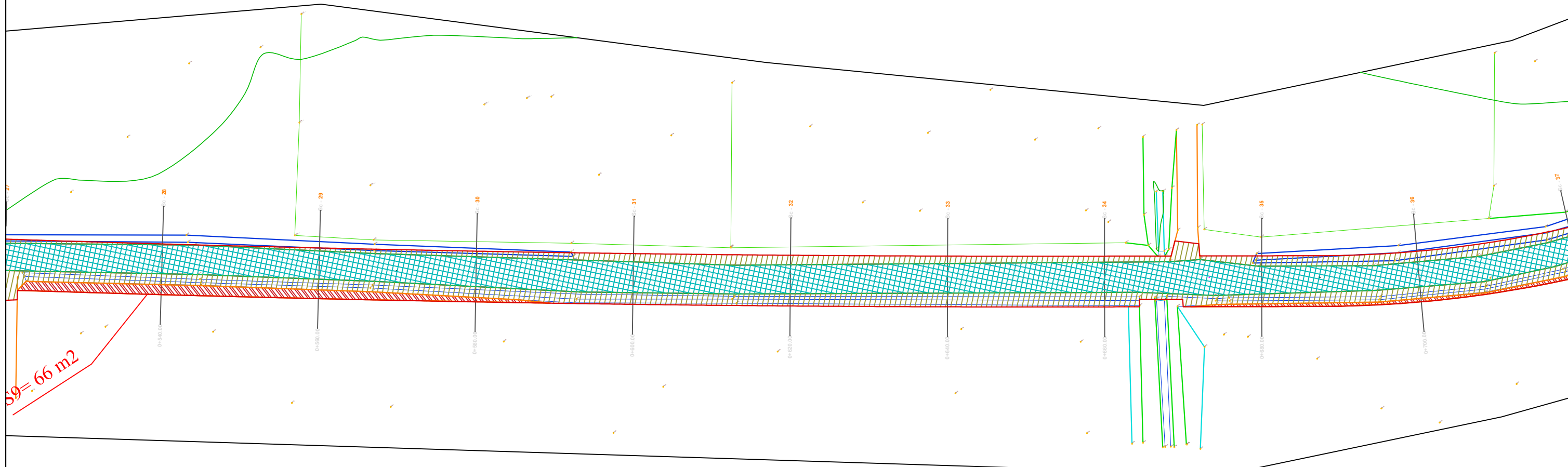
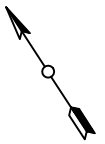

66 m2

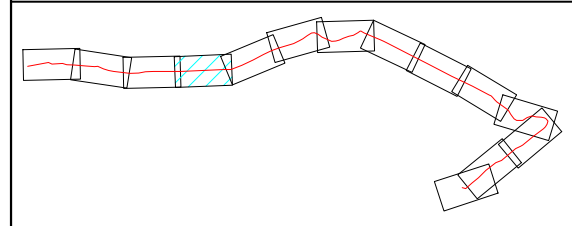

**SHPJEGUES**

	Siperfaqe e rrugë ekzistuese
	Siperfaqe se trupit te rruges ekzistues
	Siperfaqe për shpronësim

Porositi :

**BASHKIA TIRANË**

Projektoi:

**"LENI-ING" sh.p.k**  
Licens: N.2969

**"INVICTUS" sh.p.k**  
Licens: N.6708

Adresa: Rr. Uran Pano, Pallati 12 kat, Kati 2  
Mobile: 0682042270  
Email: leni-ing@hotmail.com

Grupi i Projektimit:

Arkitekt	Albert Lleshi	A.1269
Ing. Strukturist	Nikoll Paluca	K.0001
Ing. Strukturist	Maltin Grabovaj	
Ing. Hidroteknik	Andrin Kerpaci	K.1236
Ing. Gjeolog	Ibrahim Milushi	GJ.0621
Ing. Topograf	Mehill Pacuku	T.0043
Ing. Elektrik	Nikoll Pali	E.0157

Objekti: "Ndërtim i Rrugës " Ura Domje –Lagjia Tagan"		
Faza: <b>Projekt - Zbatimi</b>		
Emërtimi i Fletës: PLANIMETRIA E SHPRONESIMEVE	Shkalla: <b>Sh 1:500</b>	Tiranë 2018 Fleta SI-04

Ura Domje

Tagan

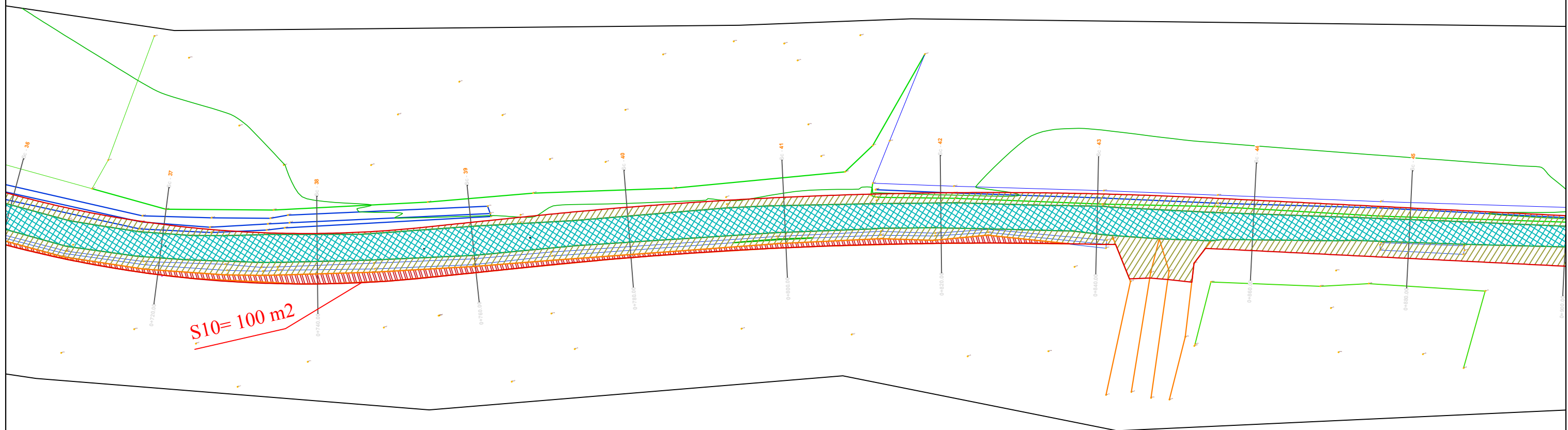
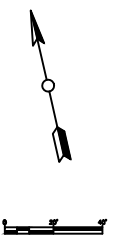

S10= 100 m2

**SHPJEGUES**

	Siperfaqe e rrugë ekzistuese
	Siperfaqe se trupit te rruges ekzistues
	Siperfaqe për shpronësim

Porositi :



**BASHKIA  
TIRANË**

Projektoi:

**"LENI-ING" sh.p.k**  
Liçens: N.2969

**"INVICTUS" sh.p.k**  
Liçens: N.6708

Adresa: Rr. Uran Pano, Pallati 12 kat, Kati 2  
Mobile: 0682042270  
Email: leni-ing@hotmail.com

Grupi i Projektimit:

Arkitekt	Albert Lleshi	A.1269
Ing. Strukturist	Nikoll Paluca	K.0001
Ing. Strukturist	Maltin Grabovaj	
Ing. Hidroteknik	Andrin Kerpaci	K.1236
Ing. Gjeolog	Ibrahim Milushi	GJ.0621
Ing. Topograf	Mehill Pacuku	T.0043
Ing. Elektrik	Nikoll Pali	E.0157

Objekti: "Ndërtim i Rrugës " Ura Domje –Lagjia Tagan"		
Faza: <b>Projekt - Zbatimi</b>		
Emërtimi i Fletës: <b>PLANIMETRIA E SHPRONESIMEVE</b>	Shkalla: <b>Sh 1:500</b>	Tiranë 2018 Fleta SI-05

