

PROFILI GJATESOR SH_V 1:2000, SH_H 1:2000

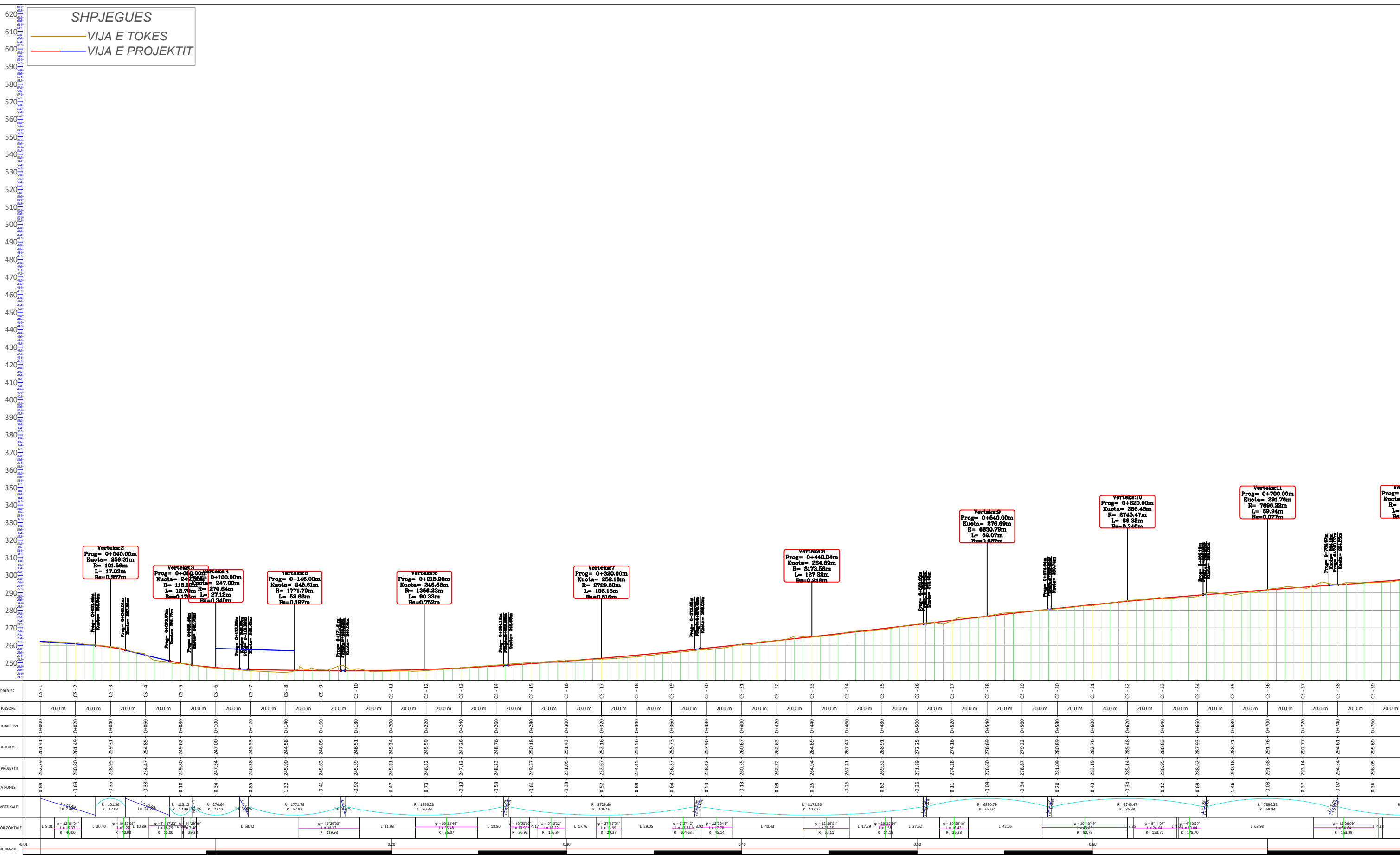

EMERTESA OBJEKTIT: "SISTEMIM ASFALTIM I RRUGES FSHATI SPATHARE" (Loti I), BASHKIA LIBRAZH D

REPUBLIKA E SHQIPERISE

FAZA E PROJEKTIT: PROJEKT ZBATIMI

EMERTESA E FLETES: PROFILI GJATESOR

POROSITESI - BASHKIA LIBRAZH D

GRUPI PROJEKTIMIT (ZENIT & CO)
 Inxh. Hidro. Merita MENGRI
 Inxh. Elekt. Spiro PLEQI
 Inxh. Mek. Arqile PERI
 Inxh. Gjeodet. Lulzim VRAPË

Ruga: Myrteza Topi (Nr 18.zip.code.1007) Mobile phone 069 20 99 065
 E-Mail: zenit06@live.com

TIRANE - ALBANIA

Nr: 01
 SH-1:2000
 Dt: / / 2023
 Shoqëria "ZENIT&CO"

PROFILI GJATESOR SH_V 1:2000, SH_H 1:2000

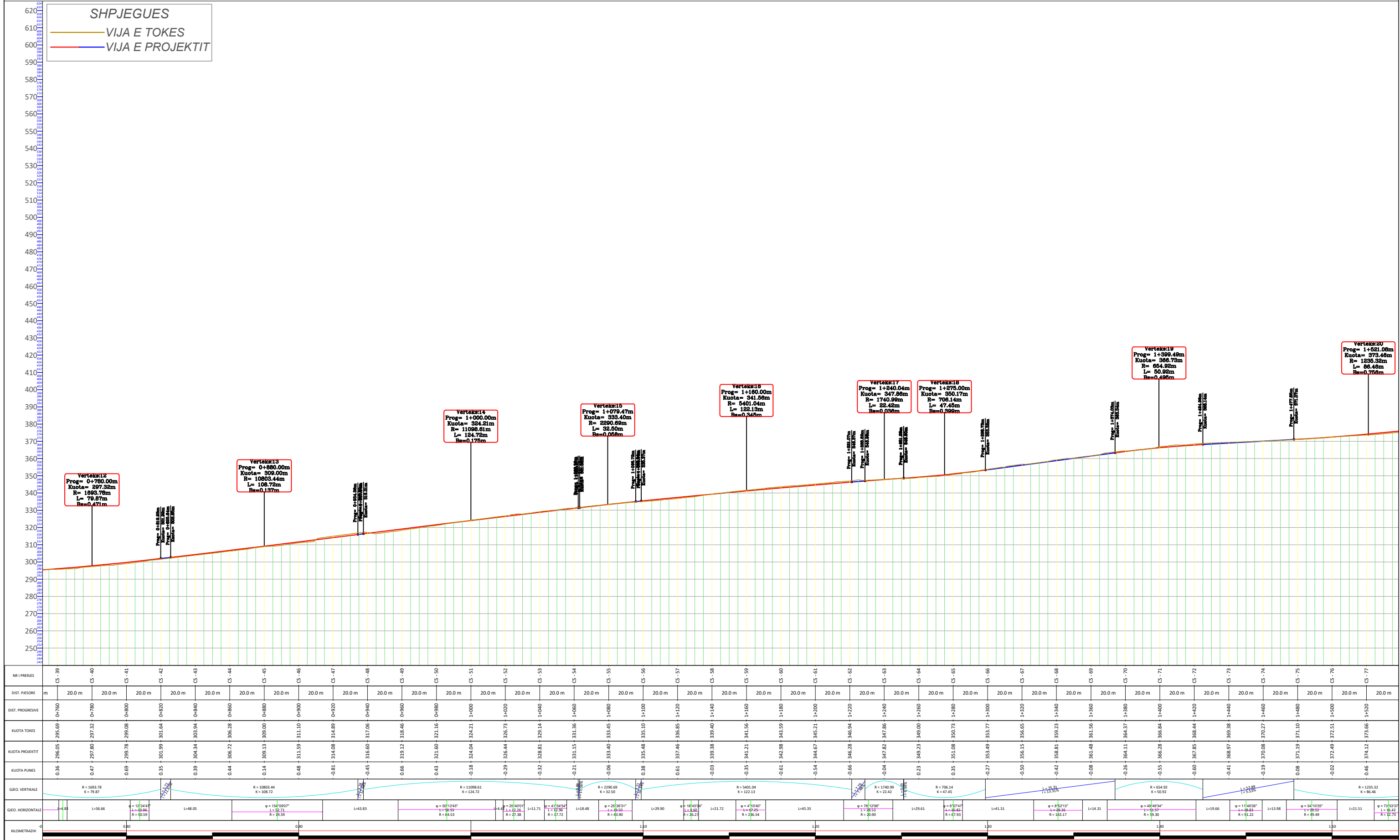

EMERTESA OBJEKTIT: "SISTEMIM ASFALTIM I RRUGES FSHATI SPATHARE" (Loti I), BASHKIA LIBRAZH

FAZA E PROJEKTIT: PROJEKT ZBATIMI Nr: 02

EMERTESA E FLETES: PROFILI GJATESOR SH-1:2000

POROSITESI - BASHKIA LIBRAZH Dt: / / 2023

GRUPI PROJEKTIMIT (ZENIT & CO)
 Inxh.Hidro. Merita MENGRI Inxh.Gjeo.Yzeir MIRAKA
 Inxh.Ndert. Rexhep Tarba Inxh.Mek.Arqile PERI
 Inxh.Elek. Spiro PLEQI Inxh.Gjeodet.Lulzim VRAP
 Ark.Raimonda MYDINLLARI

Rruga: Myrteza Topi (Nr 18.zip.code.1007) Mobile phone 069 20 99 065
 E-Mail: zenit06@live.com TIRANE-ALBANIA

Shoqëria "ZENIT&CO"

PROFILI GJATESOR SH_V 1:2000, SH_H 1:2000

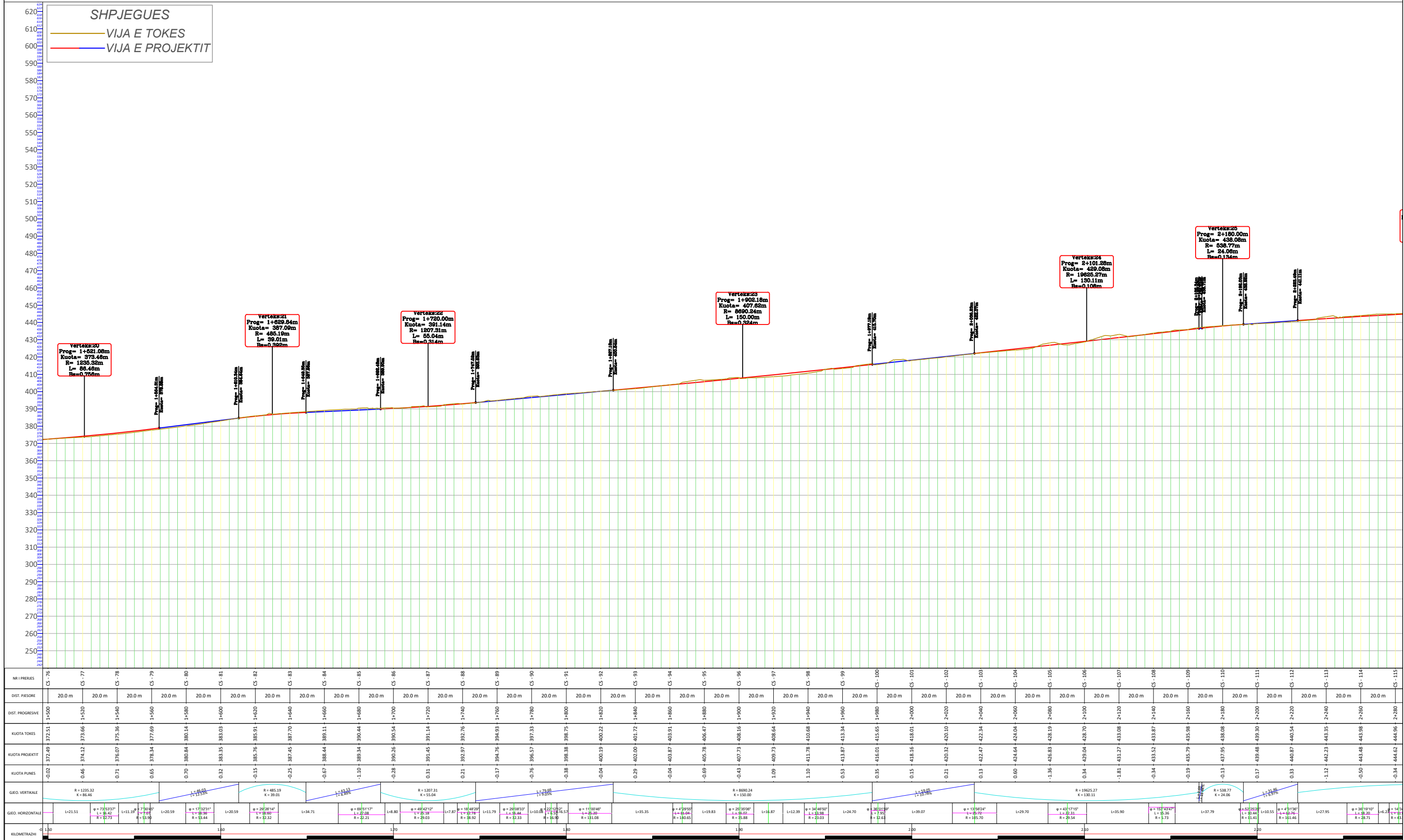

EMERTESA OBJEKTIT: "SISTEMIM ASFALTIM I RRUGES FSHATI SPATHARE" (Loti I), BASHKIA LIBRAZH D

FAZA E PROJEKTIT: PROJEKT ZBATIMI Nr: 03

EMERTESA E FLETES: PROFILI GJATESOR SH-1:2000

POROSITESI - BASHKIA LIBRAZH D Dt: / / 2023

GRUPI PROJEKTIMIT (ZENIT & CO)
 Inxh. Gjeo. Myrteza MERRI Inxh. Gjeo. Yzeir MIRAKA
 Inxh. Nert. Rexhep Tarba Inxh. Mek. Arqile PERI
 Inxh. Elek. Spiro PLEQI Inxh. Gjeodet. Luizim WRAP
 Ark. Raimonda MYDINLLARI

Ruga: Myrteza Topi (Nr 18.zip.code.1007) Mobile phone 069 20 99 065
 E-Mail: zenit06@live.com

TIRANE - ALBANIA

Shoqëria "ZENIT&CO"

PROFILI GJATESOR SH_V 1:2000, SH_H 1:2000

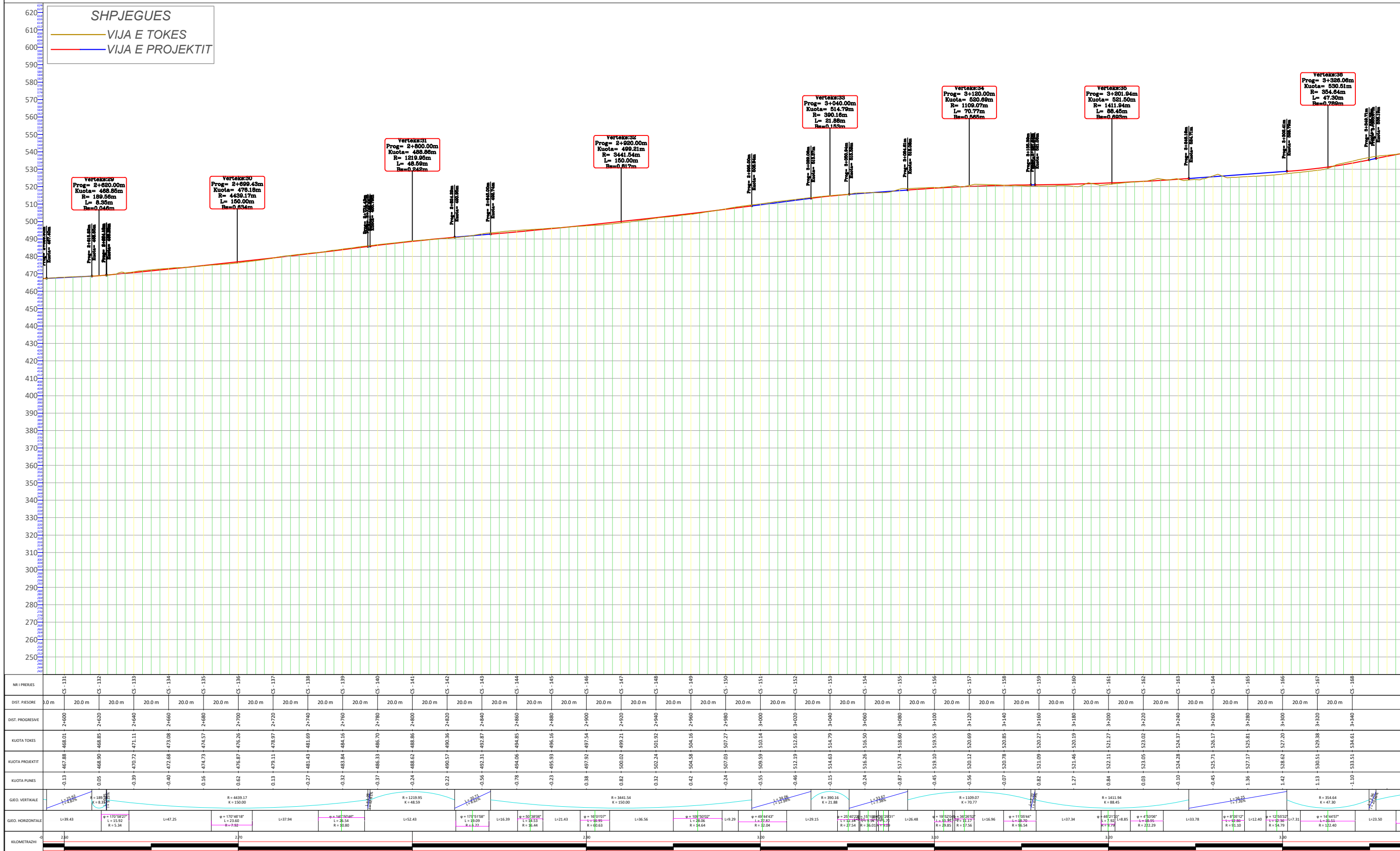

NR I PRERIES	DIST. PISORE	DIST. PROGRESIVE	KUOTA TOKES	KUOTA PROJEKTIT	KUOTA PUNES	GEO. VERTIKALE	GEO. HORIZONTALE	KILOMETRAZH
CS - 131	0.0m	2+400	468.01	467.88	-0.13	R = 4839.17 K = 150.00	L=39.43	2.90
CS - 132	20.0m	2+420	468.85	468.85	0.05	R = 4839.17 K = 150.00	L=47.25	2.90
CS - 133	40.0m	2+440	471.11	470.72	-0.39	R = 4839.17 K = 150.00	L=37.94	2.90
CS - 134	60.0m	2+460	473.08	472.68	-0.40	R = 4839.17 K = 150.00	L=37.94	2.90
CS - 135	80.0m	2+480	474.57	474.57	0.16	R = 4839.17 K = 150.00	L=37.94	2.90
CS - 136	100.0m	2+500	476.26	476.26	0.62	R = 4839.17 K = 150.00	L=37.94	2.90
CS - 137	120.0m	2+520	478.97	478.97	0.13	R = 4839.17 K = 150.00	L=37.94	2.90
CS - 138	140.0m	2+540	481.69	481.69	-0.27	R = 4839.17 K = 150.00	L=37.94	2.90
CS - 139	160.0m	2+560	484.16	484.16	-0.32	R = 4839.17 K = 150.00	L=37.94	2.90
CS - 140	180.0m	2+580	486.70	486.70	-0.37	R = 4839.17 K = 150.00	L=37.94	2.90
CS - 141	200.0m	2+600	488.86	488.86	-0.24	R = 4839.17 K = 150.00	L=37.94	2.90
CS - 142	220.0m	2+620	490.36	490.36	0.22	R = 4839.17 K = 150.00	L=37.94	2.90
CS - 143	240.0m	2+640	492.87	492.87	-0.56	R = 4839.17 K = 150.00	L=37.94	2.90
CS - 144	260.0m	2+660	494.85	494.85	-0.78	R = 4839.17 K = 150.00	L=37.94	2.90
CS - 145	280.0m	2+680	496.16	496.16	-0.23	R = 4839.17 K = 150.00	L=37.94	2.90
CS - 146	300.0m	2+700	497.54	497.54	0.38	R = 4839.17 K = 150.00	L=37.94	2.90
CS - 147	320.0m	2+720	499.21	499.21	0.82	R = 4839.17 K = 150.00	L=37.94	2.90
CS - 148	340.0m	2+740	501.92	501.92	0.32	R = 4839.17 K = 150.00	L=37.94	2.90
CS - 149	360.0m	2+760	504.16	504.16	0.42	R = 4839.17 K = 150.00	L=37.94	2.90
CS - 150	380.0m	2+780	507.27	507.27	-0.24	R = 4839.17 K = 150.00	L=37.94	2.90
CS - 151	400.0m	2+800	510.14	510.14	-0.55	R = 4839.17 K = 150.00	L=37.94	2.90
CS - 152	420.0m	2+820	512.65	512.65	-0.46	R = 4839.17 K = 150.00	L=37.94	2.90
CS - 153	440.0m	2+840	514.79	514.79	-0.15	R = 4839.17 K = 150.00	L=37.94	2.90
CS - 154	460.0m	2+860	516.50	516.50	-0.24	R = 4839.17 K = 150.00	L=37.94	2.90
CS - 155	480.0m	2+880	518.60	518.60	-0.87	R = 4839.17 K = 150.00	L=37.94	2.90
CS - 156	500.0m	2+900	519.55	519.55	-0.45	R = 4839.17 K = 150.00	L=37.94	2.90
CS - 157	520.0m	2+920	520.69	520.69	-0.56	R = 4839.17 K = 150.00	L=37.94	2.90
CS - 158	540.0m	2+940	520.85	520.85	-0.07	R = 4839.17 K = 150.00	L=37.94	2.90
CS - 159	560.0m	2+960	520.27	520.27	0.82	R = 4839.17 K = 150.00	L=37.94	2.90
CS - 160	580.0m	2+980	520.19	520.19	1.27	R = 4839.17 K = 150.00	L=37.94	2.90
CS - 161	600.0m	3+000	521.27	521.27	0.84	R = 4839.17 K = 150.00	L=37.94	2.90
CS - 162	620.0m	3+020	523.02	523.02	0.09	R = 4839.17 K = 150.00	L=37.94	2.90
CS - 163	640.0m	3+040	524.37	524.37	-0.10	R = 4839.17 K = 150.00	L=37.94	2.90
CS - 164	660.0m	3+060	526.17	526.17	-0.45	R = 4839.17 K = 150.00	L=37.94	2.90
CS - 165	680.0m	3+080	525.81	525.81	1.36	R = 4839.17 K = 150.00	L=37.94	2.90
CS - 166	700.0m	3+100	527.20	527.20	1.42	R = 4839.17 K = 150.00	L=37.94	2.90
CS - 167	720.0m	3+120	529.38	529.38	1.13	R = 4839.17 K = 150.00	L=37.94	2.90
CS - 168	740.0m	3+140	534.61	534.61	-1.10	R = 4839.17 K = 150.00	L=37.94	2.90

EMERTESA OBJEKTIT: "SISTEMIM ASFALTIM I RRUGES FSHATI SPATHARE" (Loti I), BASHKIA LIBRAZH D

FAZA E PROJEKTIT: PROJEKT ZBATIMI	Nr: 05
EMERTESA E FLETES: PROFILI GJATESOR	SH-1:2000
POROSITESI - BASHKIA LIBRAZH D	Dt: / / 2023
RUGA: MYRTEZA TOPI (NR 18.ZIP.CODE.1007) MOBILE PHONE: 069 20 99 065 E-MAIL: zenit06@live.com TIRANE, ALBANIA	GRUPI PROJEKTIMIT (ZENIT & CO) INXH. HIDRO. MERITA MENGRI INXH. GJEO. YZEIR MIRAKA INXH. NDERT. REXHEP TARBA INXH. MEK. ARRIJE PERI INXH. ELEK. SPIRO PLEQI INXH. GJEODET. LULZIM VRAPJ ARK. RAIMONDA MYDINLLARI