



MIRATOHET
KRYETARI I BASHKISË
Z. TONIN MARINAJ

BASHKIA MALESI E MADHE
PROJEKT ZBATIMI

Sistemim Asfaltim rruga e Sterkuj

- 1– Hoorografia
- 2– Topografia e rruges
- 3– Planimetria e rruges
- 4– Profili gjatësor
- 5– Profilat tërthore
- 6– Profili tërthore tip

PROJEKTOI:
"LENI-ING" SH.P.K

TIRANË 2023

FILLIMI I RRUGES

V -1-
 R= 445.000m
 K=70.995 m
 Tg= 35.573 m
 Bs= 1.420 m
 $\alpha = 9^{\circ} 05' 27.26''$
 N= 4683605.82
 E= 4377374.51

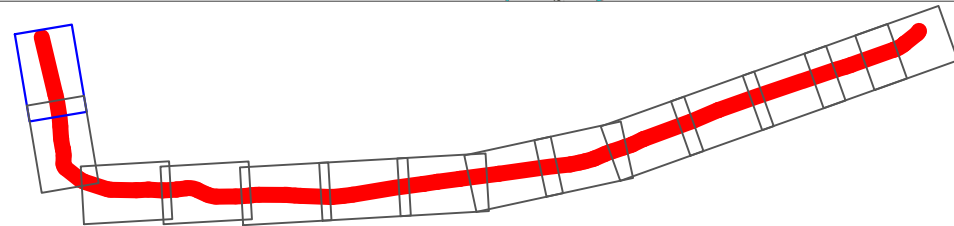
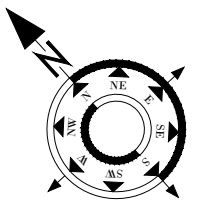
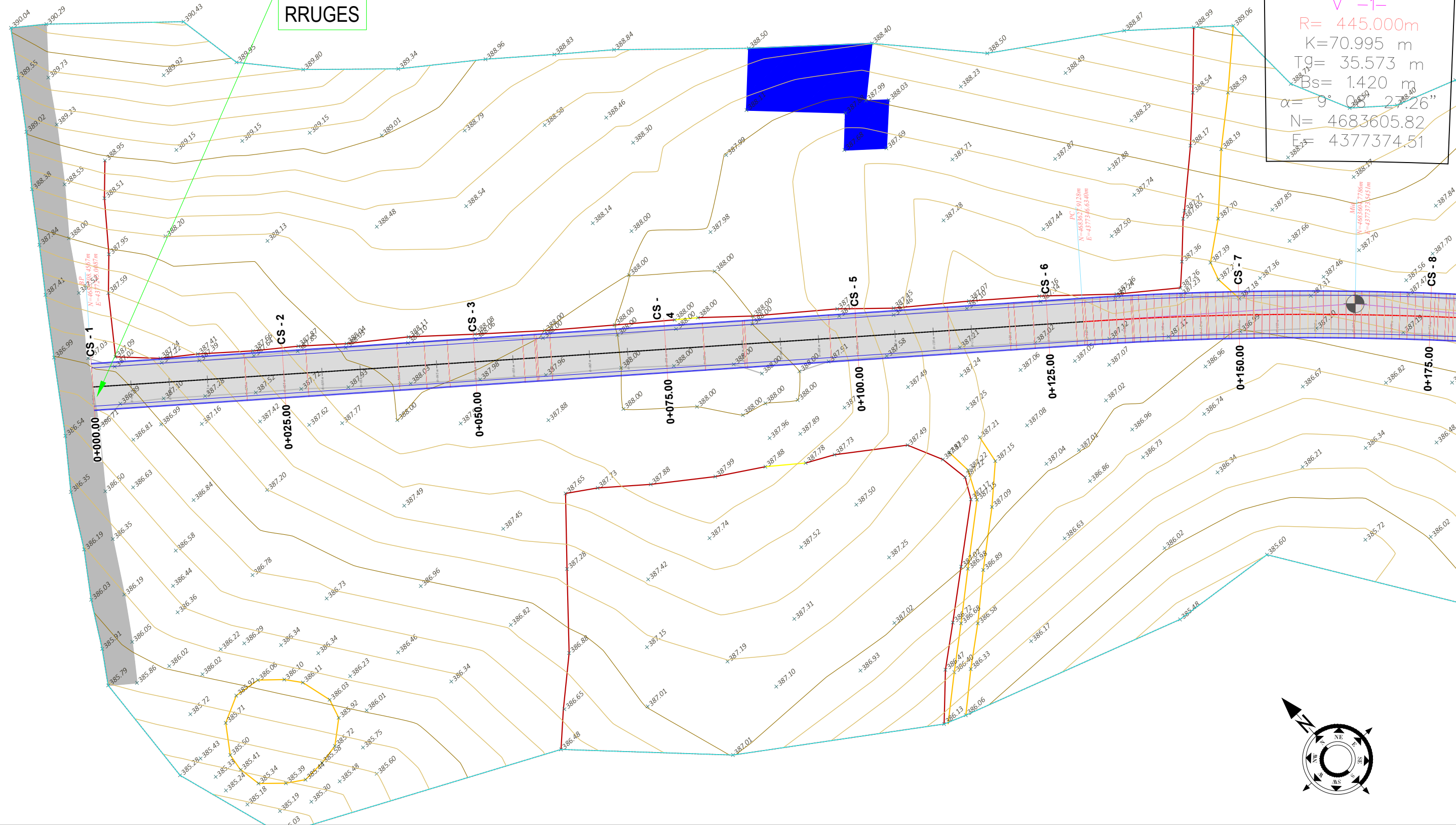

SHPJEGUES

- 156.95 Pike detaje
- 158.0 Izohipse
- Objekt
- Kanal Natyral
- Rrethim
- Mur Rrethues

Porositi :
 BASHKIA
 MALESI E
 MADHE

Projektoi:
 "LENI-ING" sh.p.k
 Liçense: N.2969
 ADMINISTRATOR Nikoll PALUCA
 Adresa: Rr. Uran Pano, Pallati 12 kat, Kati 2
 Mobile: 0682042270
 Email: leni-ing@hotmail.com

| | | |
|--|----------|------------------|
| Objekti: Sistemim Asfaltim rruga e Sterkuj | | |
| Faza: | | Projekt - Zbatim |
| Emërtimi i Fletës: | Shkalla: | Tiranë 2023 |
| PLANIMETRIA E RRUGES | Sh 1:500 | PL |

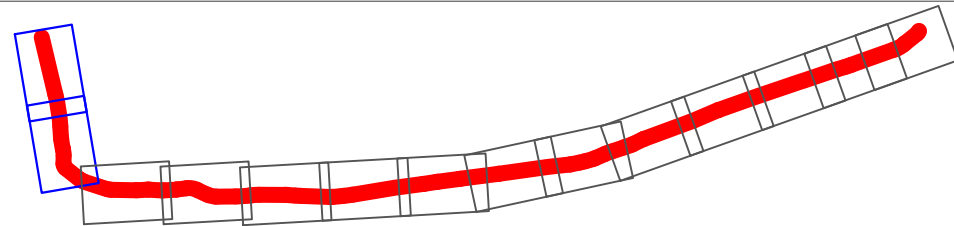
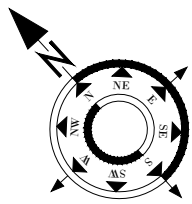
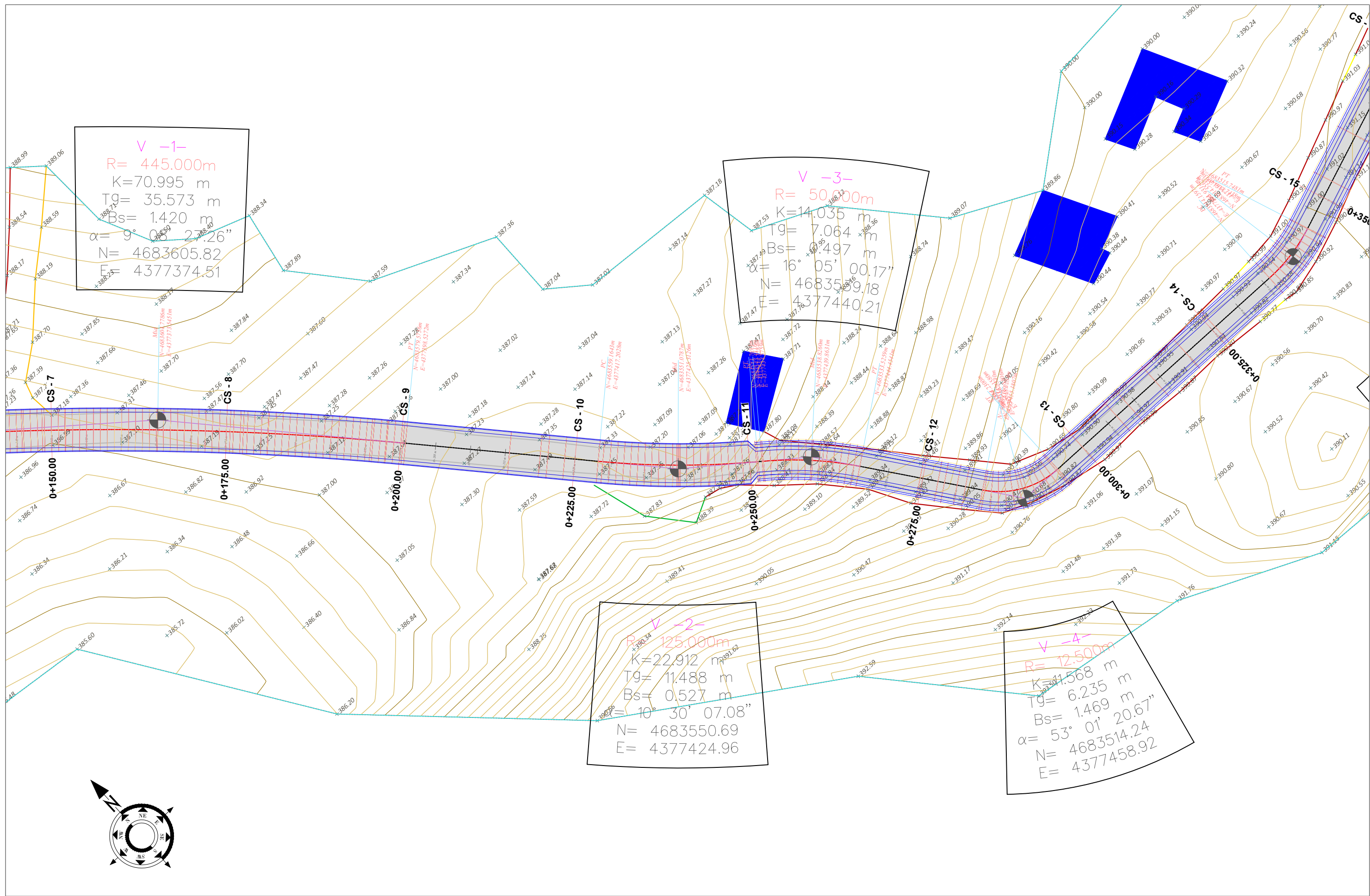

SHPJEGUES

- 156.95 Pike detaje
- 158.0 Izohipse
- Objekt
- Kanal Natyral
- Rrethim
- Mur Rrethues

Porositi :
 BASHKIA
 MALESI E
 MADHE

Projektoi:
 "LENI-ING" sh.p.k
 Liçense: N.2969
 ADMINISTRATOR Nikoll PALUCA
 Adresa: Rr. Uran Pano, Pallati 12 kat, Kati 2
 Mobile: 0682042270
 Email: leni-ing@hotmail.com

| | | |
|---|----------------------|--------------------------|
| Objekti: Sistemim Asfaltim rruga e Sterkuj | | |
| Faza: Projekt – Zbatim | | |
| Emërtimi i Fletës: PLANIMETRIA E RRUGES | Shkalla: Sh 1:500 | Tiranë 2023 PL (2) |

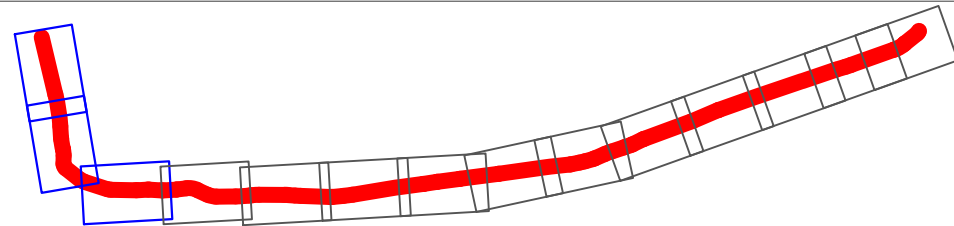
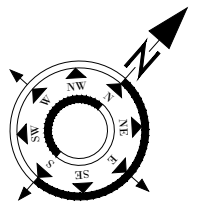
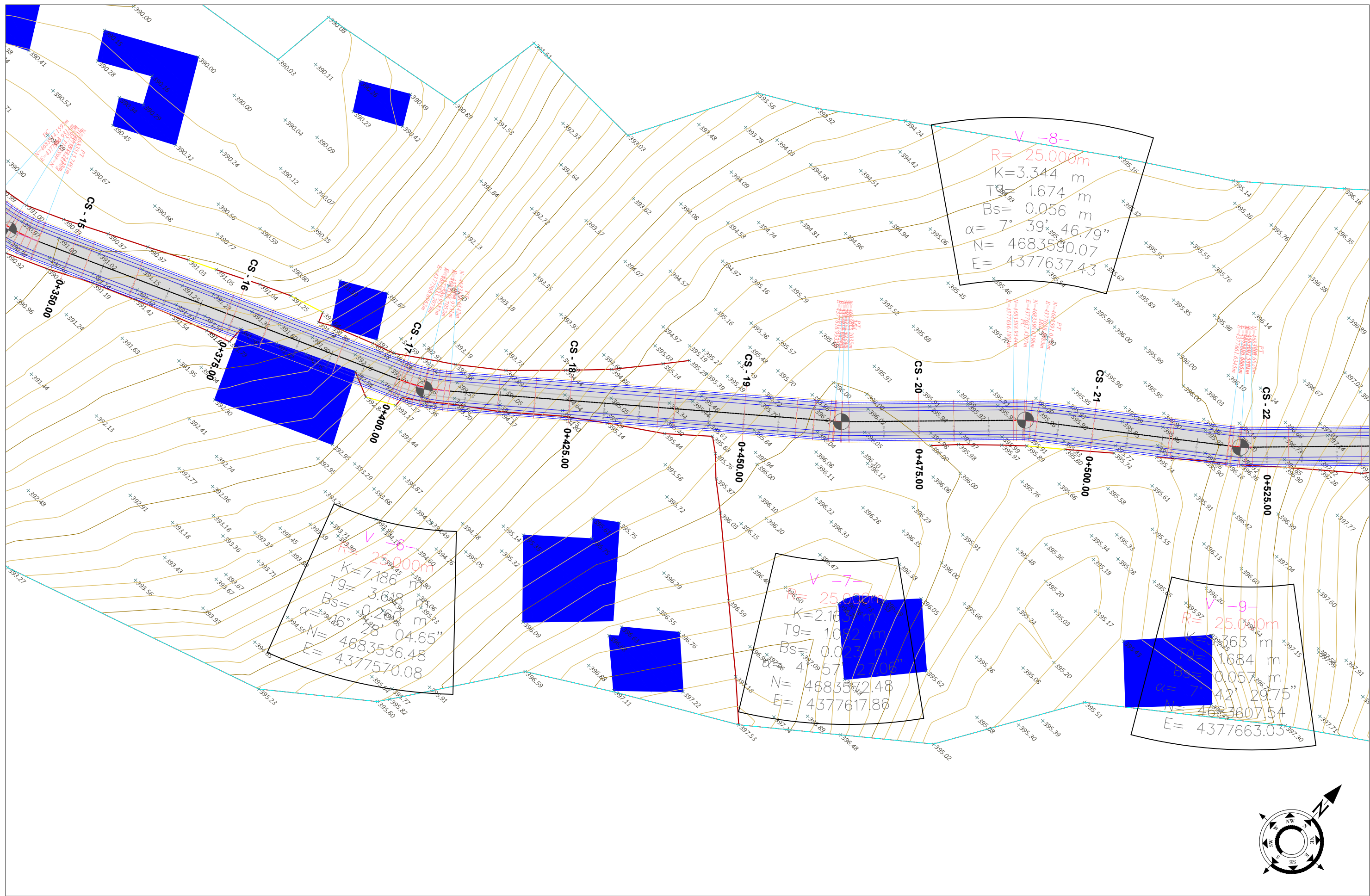

SHPJEGUES

- 156.95 Pike detaje
- 158.0 Izohipse
- Objekt
- Kanal Natyral
- Rrethim
- Mur Rrethues

Porositi :
 BASHKIA
 MALESI E
 MADHE

Projektoi:
 "LENI-ING" sh.p.k
 Liçense: N.2969
 ADMINISTRATOR Nikoll PALUCA
 Adresa: Rr. Uran Pano, Pallati 12 kat, Kati 2
 Mobile: 0682042270
 Email: leni-ing@hotmail.com

| | | |
|---|----------------------|--------------------------|
| Objekti: Sistemim Asfaltim rruga e Sterkuj | | |
| Faza: Projekt - Zbatim | | |
| Emërtimi i Fletës: PLANIMETRIA E RRUGES | Shkalla: Sh 1:500 | Tiranë 2023 PL (3) |

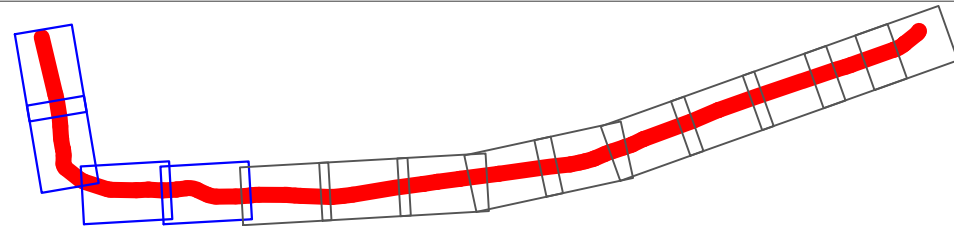
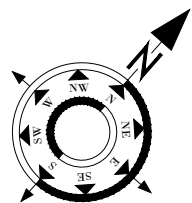
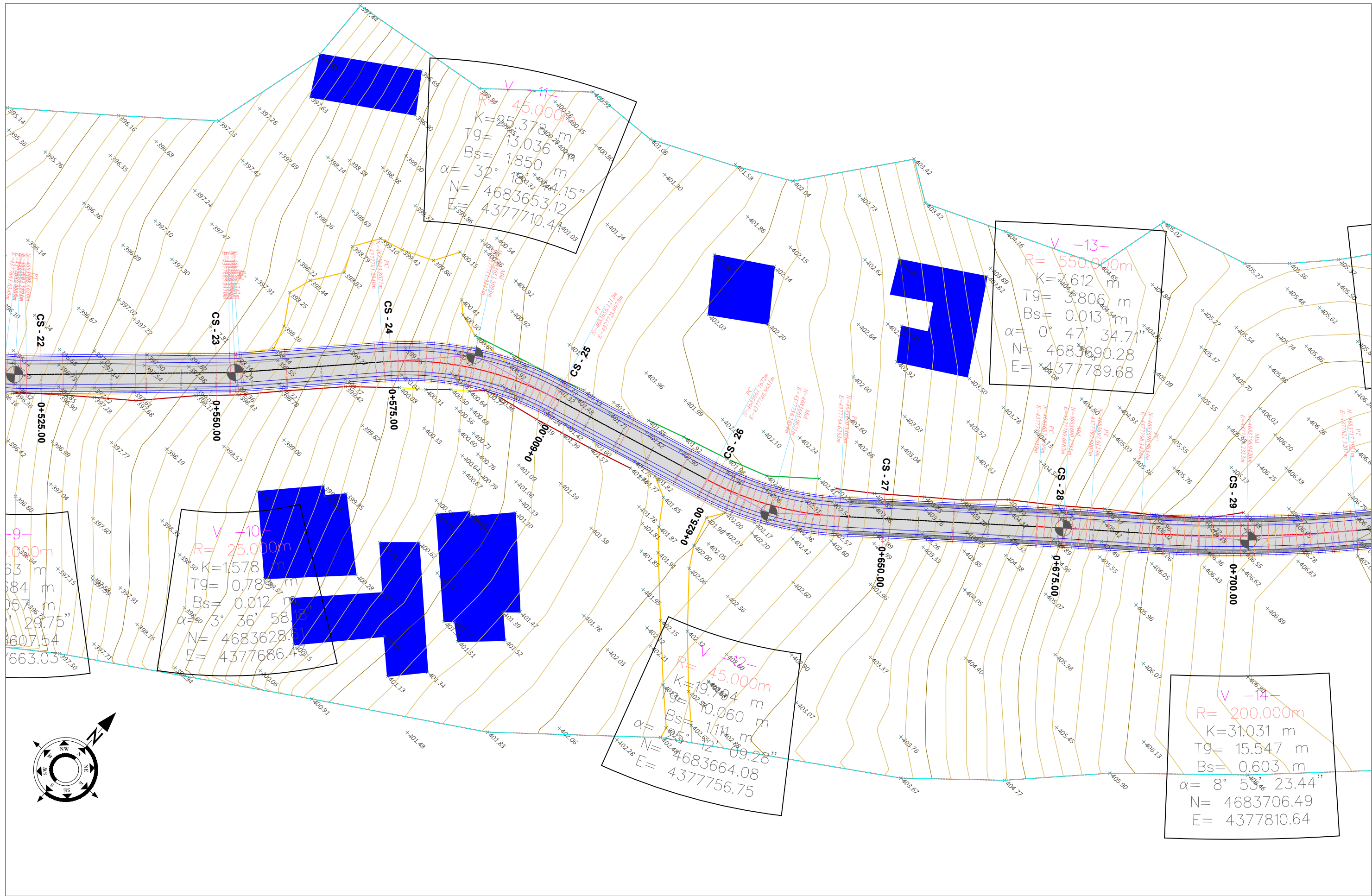

- SHPJEGUES**
- 156.95 Pike detaje
 - 158.0 Izohipse
 - Objekt
 - Kanal Natyral
 - Rrethim
 - Mur Rrethues

Porositi :
 BASHKIA
 MALESI E
 MADHE

Projektoi:
 "LENI-ING" sh.p.k
 Liçense: N.2969
 ADMINISTRATOR Nikoll PALUCA
 Adresa: Rr. Uran Pano, Pallati 12 kat, Kati 2
 Mobile: 0682042270
 Email: leni-ing@hotmail.com

| | | |
|---|----------------------|--------------------------|
| Objekti: Sistemim Asfaltim rruga e Sterkuj | | |
| Faza: Projekt - Zbatim | | |
| Emërtimi i Fletës: PLANIMETRIA E RRUGES | Shkalla: Sh 1:500 | Tiranë 2023 PL (4) |

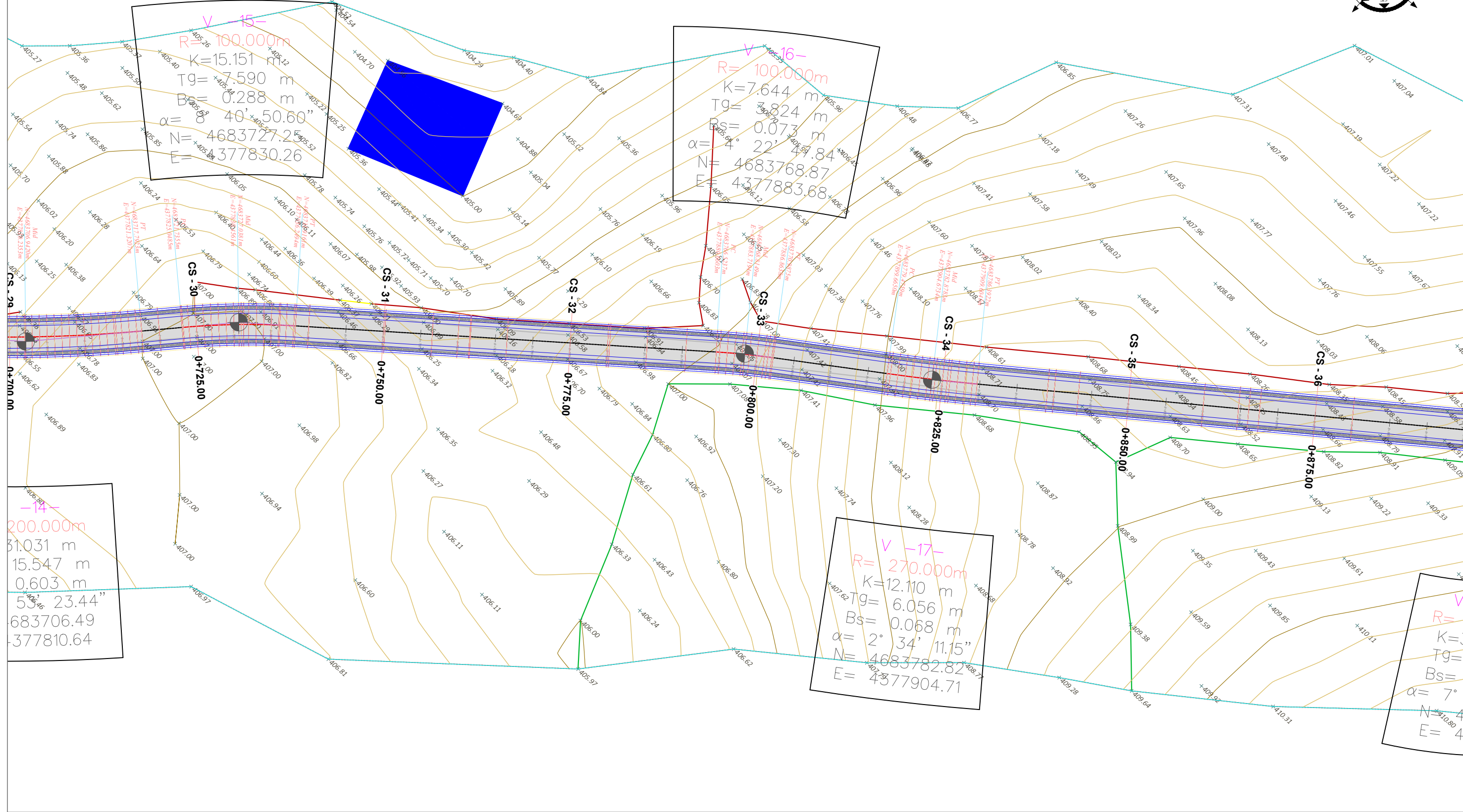
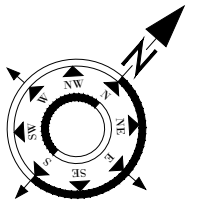

V-15-
 $R = 100.000\text{m}$
 $K = 15.151\text{ m}$
 $Tg = 7.590\text{ m}$
 $Bs = 0.288\text{ m}$
 $\alpha = 40^\circ 50.60''$
 $N = 4683727.2$
 $E = 377830.26$

V-16-
 $R = 100.000\text{m}$
 $K = 7.644\text{ m}$
 $Tg = 4.824\text{ m}$
 $Bs = 0.073\text{ m}$
 $\alpha = 24^\circ 22' 44.84''$
 $N = 4683768.87$
 $E = 4377883.68$

V-17-
 $R = 270.000\text{m}$
 $K = 12.110\text{ m}$
 $Tg = 6.056\text{ m}$
 $Bs = 0.068\text{ m}$
 $\alpha = 2^\circ 34' 11.15''$
 $N = 4683782.82$
 $E = 4377904.71$

V-14-
 $R = 200.000\text{m}$
 $K = 31.031\text{ m}$
 $Tg = 15.547\text{ m}$
 $Bs = 0.603\text{ m}$
 $\alpha = 53^\circ 23.44''$
 $N = 683706.49$
 $E = 377810.64$

V
 $R = 3$
 $Tg =$
 $Bs =$
 $\alpha = 7^\circ$
 $N = 4$
 $E = 4$

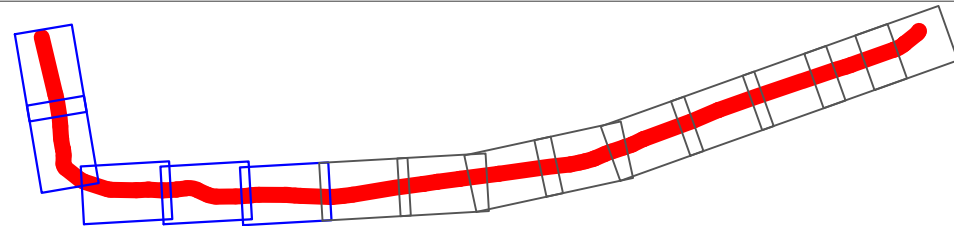

- SHPJEGUES**
- 156.95 Pike detaje
 - 158.0 Izohipse
 - Objekt
 - Kanal Natyral
 - Rrethim
 - Mur Rrethues

Porositi :
 BASHKIA
 MALESI E
 MADHE

Projektoi:
 "LENI-ING" sh.p.k
 Liçense: N.2969
 ADMINISTRATOR Nikoll PALUCA
 Adresa: Rr. Uran Pano, Pallati 12 kat, Kati 2
 Mobile: 0682042270
 Email: leni-ing@hotmail.com

| | | |
|--|-------------|---|
| Objekti: Sistemim Asfaltim rruga e Sterkuj | | |
| Faza: Projekt - Zbatim | | Emërtimi i Fletës: PLANIMETRIA E RRUGES |
| Shkalla: Sh 1:500 | Tiranë 2023 | PL (5) |

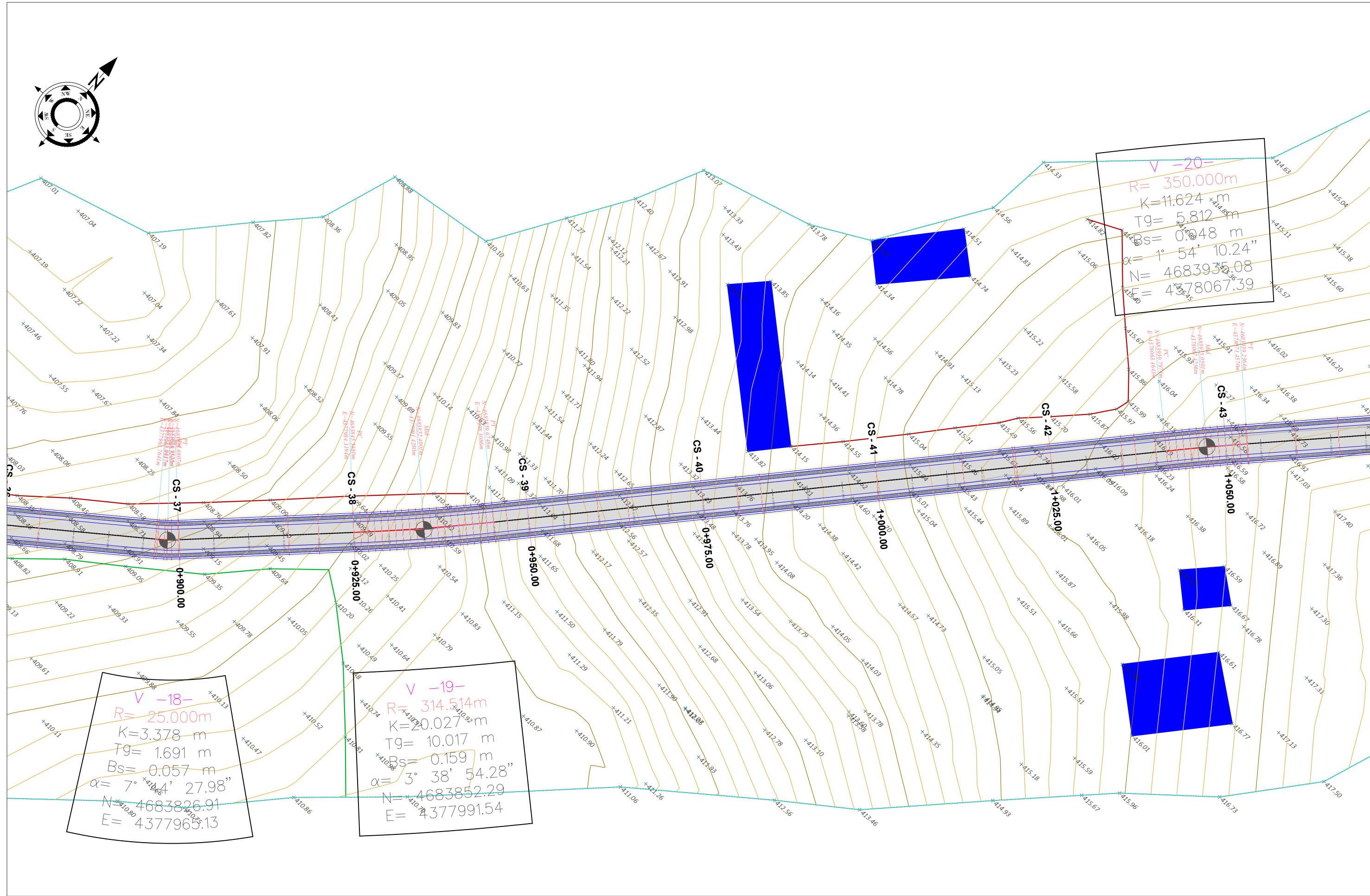
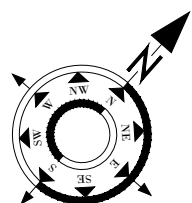

V -20-

R= 350.000m

K=11.624 m

Tg= 5.812 m

Bs= 0.048 m

$\alpha = 1^\circ 54' 10.24''$

N= 4683935.08

E= 4378067.39

V -18-

R= 25.000m

K=3.378 m

Tg= 1.691 m

Bs= 0.057 m

$\alpha = 7^\circ 4' 27.98''$

N= 4683826.91

E= 4377965.13

V -19-

R= 314.514m

K=2.027 m

Tg= 10.017 m

Bs= 0.159 m

$\alpha = 3^\circ 38' 54.28''$

N= 4683852.29

E= 4377991.54

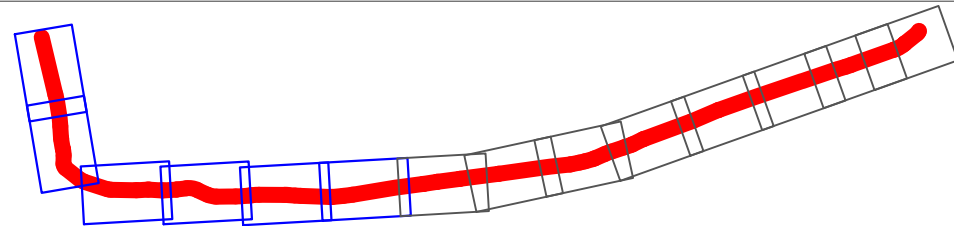

SHPJEGUES

- 156.95 Pike detaje
- 158.0 Izohipse
- Objekt
- Kanal Natyral
- Rrethim
- Mur Rrethues

Porositi :
BASHKIA
MALESI E
MADHE

Projektoi:
"LENI-ING" sh.p.k
Liçense: N.2969
ADMINISTRATOR Nikoll PALUCA
Adresa: Rr. Uran Pano, Pallati 12 kat, Kati 2
Mobile: 0682042270
Email: leni-ing@hotmail.com

| | | |
|---|----------------------|--------------------------|
| Objekti: Sistemim Asfaltim rruga e Sterkuj | | |
| Faza: Projekt - Zbatim | | |
| Emërtimi i Fletës: PLANIMETRIA E RRUGES | Shkalla: Sh 1:500 | Tiranë 2023 PL (6) |

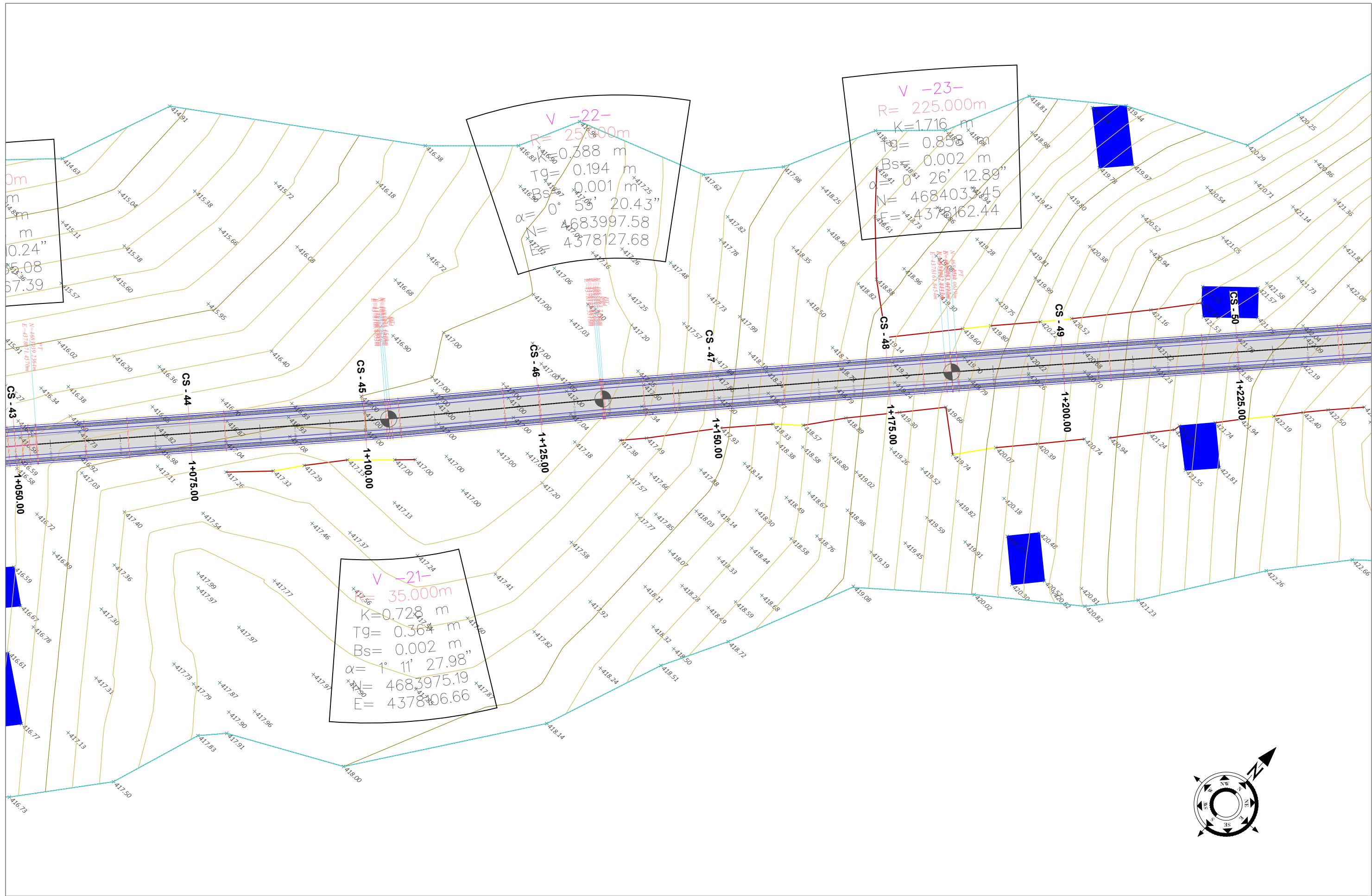

0.24"
5.08
57.39

V -22-
R= 25.000m
K=0.388 m
Tg= 0.194 m
Bs= 0.001 m
 $\alpha = 1^{\circ} 55' 20.43''$
L= 683997.58
E= 4378127.68

V -23-
R= 225.000m
K=1.716 m
Tg= 0.859 m
Bs= 0.002 m
 $\alpha = 2^{\circ} 26' 12.89''$
L= 468403.45
E= 4378162.44

V -21-
R= 35.000m
K=0.728 m
Tg= 0.364 m
Bs= 0.002 m
 $\alpha = 1^{\circ} 11' 27.98''$
L= 4683975.19
E= 4378006.66

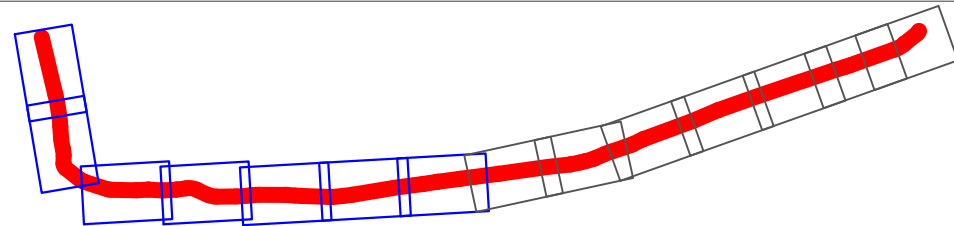
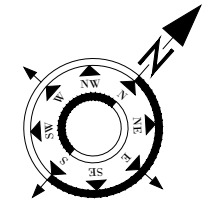

- SHPJEGUES**
- 156.95 Pike detaje
 - 158.0 Izohipse
 - Objekt
 - Kanal Natyral
 - Rrethim
 - Mur Rrethues

Porositi :
BASHKIA
MALESI E
MADHE

Projektoi:
"LENI-ING" sh.p.k
Liqense: N.2969
ADMINISTRATOR Nikoll PALUCA
Adresa: Rr. Uran Pano, Pallati 12 kat, Kati 2
Mobile: 0682042270
Email: leni-ing@hotmail.com

| | | |
|---|----------------------|--------------------------|
| Objekti: Sistemim Asfaltim rruga e Sterkuj | | |
| Faza: Projekt - Zbatim | | |
| Emërtimi i Fletës: PLANIMETRIA E RRUGES | Shkalla: Sh 1:500 | Tiranë 2023 PL (7) |

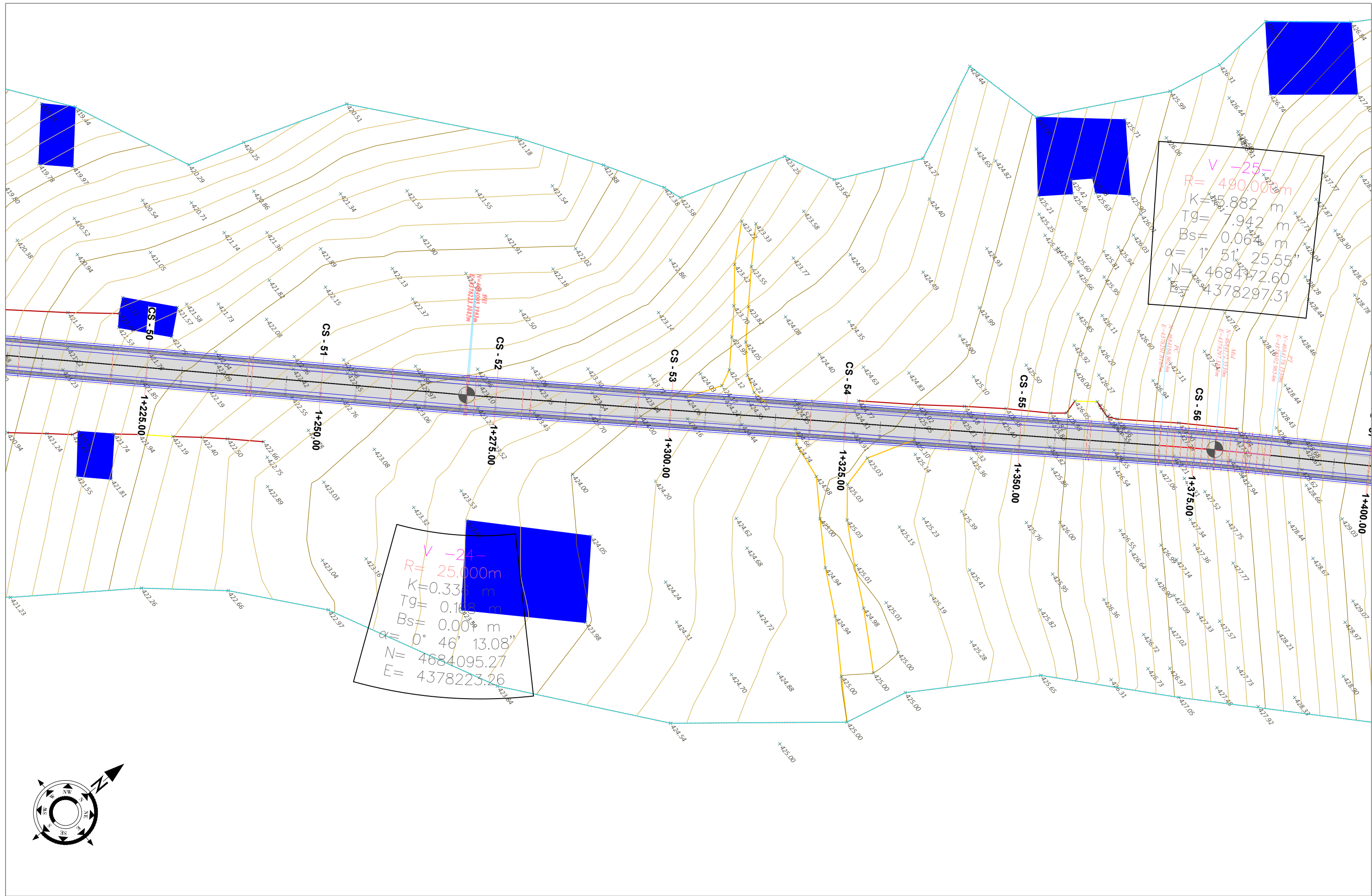

$v = -25$
 $R = 490.000\text{m}$
 $K = 5.882\text{ m}$
 $Tg = 1.942\text{ m}$
 $Bs = 0.06\text{ m}$
 $\alpha = 5^\circ 25' 55''$
 $N = 468472.60$
 $E = 437829.73$

$v = -24$
 $R = 25.000\text{m}$
 $K = 0.33\text{ m}$
 $Tg = 0.163\text{ m}$
 $Bs = 0.00\text{ m}$
 $\alpha = 0^\circ 46' 13.08''$
 $N = 4684095.27$
 $E = 4378223.26$

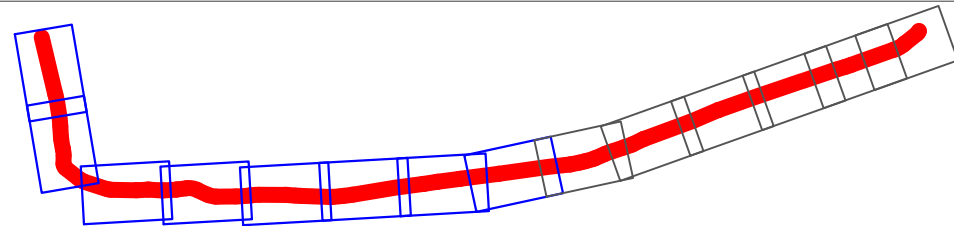
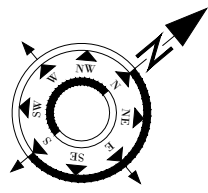

- SHPJEGUES**
- 156.95 Pike detaje
 - 158.0 Izohipse
 - Objekt
 - Kanal Natyral
 - Rrethim
 - Mur Rrethues

Porositi :
 BASHKIA
 MALESI E
 MADHE

Projektoi:
 "LENI-ING" sh.p.k
 Liçense: N.2969
 ADMINISTRATOR Nikoll PALUCA
 Adresa: Rr. Uran Pano, Pallati 12 kat, Kati 2
 Mobile: 0682042270
 Email: leni-ing@hotmail.com

| | | |
|--|----------|------------------|
| Objekti: Sistemim Asfaltim rruga e Sterkuj | | |
| Faza: | | Projekt – Zbatim |
| Emërtimi i Fletës: | Shkalla: | Tiranë 2023 |
| PLANIMETRIA E RRUGES | Sh 1:500 | PL (8) |

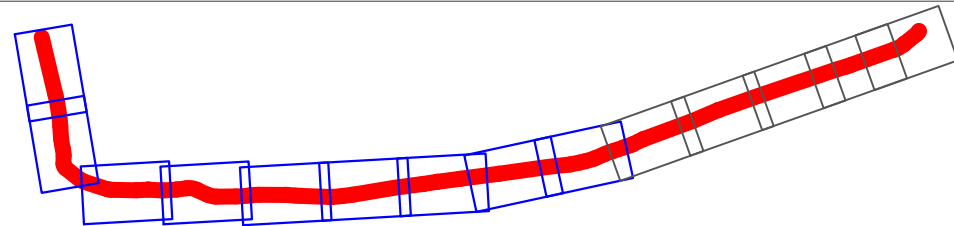
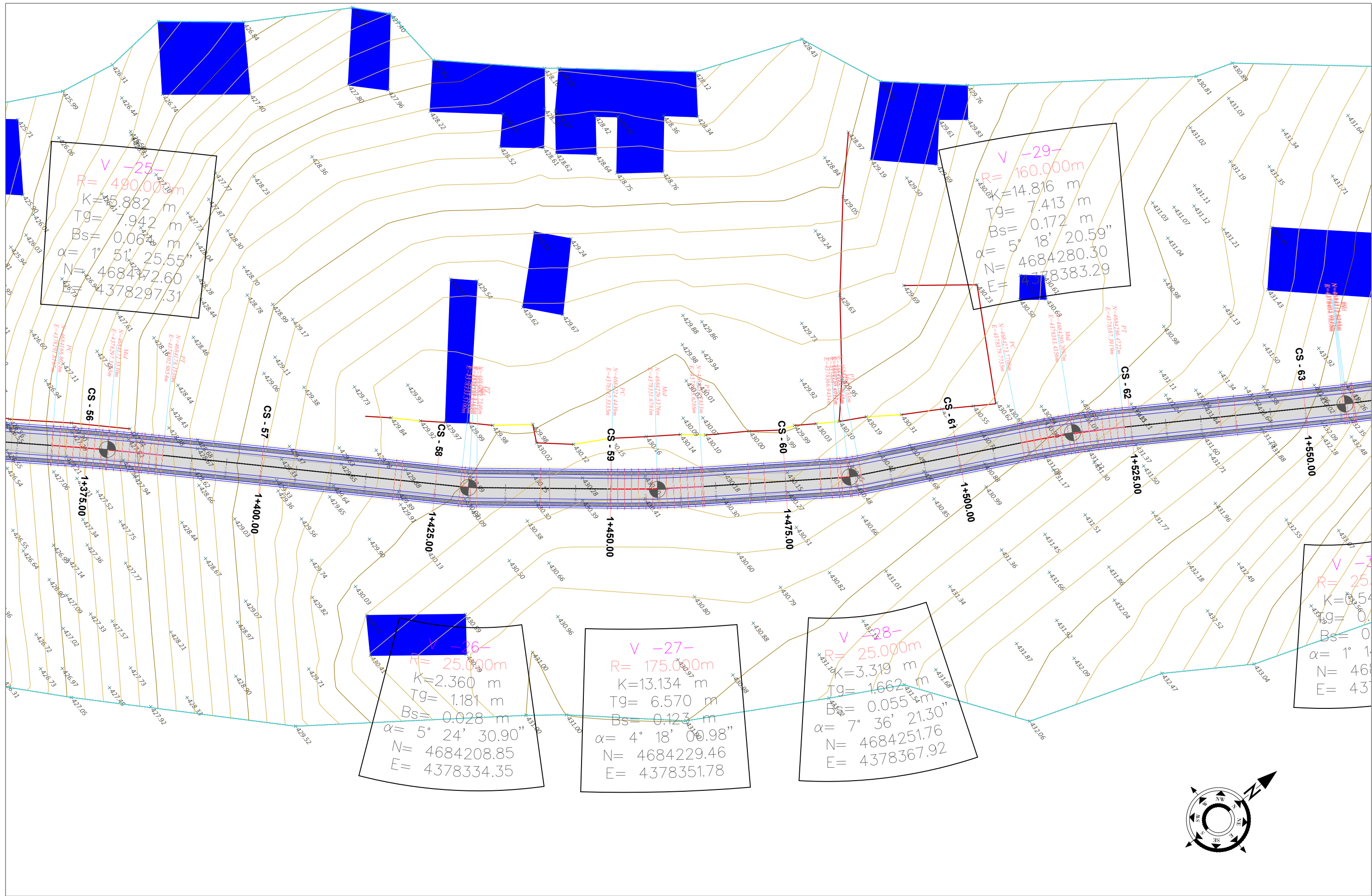

- SHPJEGUES**
- 156.95 Pike detaje
 - 158.00 Izohipse
 - Objekt
 - Kanal Natyral
 - Rrethim
 - Mur Rrethues

Porositi :
 BASHKIA
 MALESI E
 MADHE

Projektoi:
 "LENI-ING" sh.p.k
 Liçense: N.2969
 ADMINISTRATOR Nikoll PALUCA
 Adresa: Rr. Uran Pano, Pallati 12 kat, Kati 2
 Mobile: 0682042270
 Email: leni-ing@hotmail.com

| | | |
|---|----------------------|--------------------------|
| Objekti: Sistemim Asfaltim rruga e Sterkuj | | |
| Faza: Projekt – Zbatim | | |
| Emërtimi i Fletës: PLANIMETRIA E RRUGES | Shkalla: Sh 1:500 | Tiranë 2023 PL (9) |

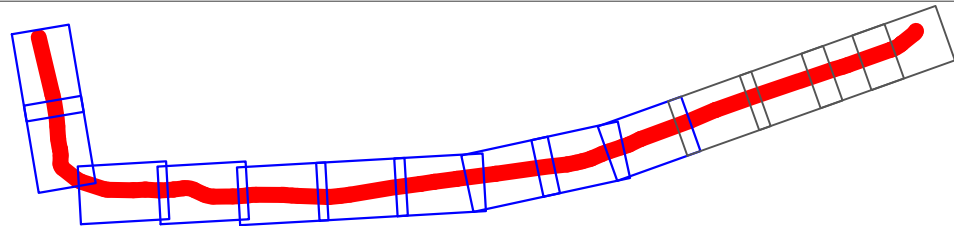
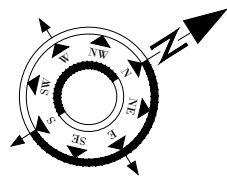
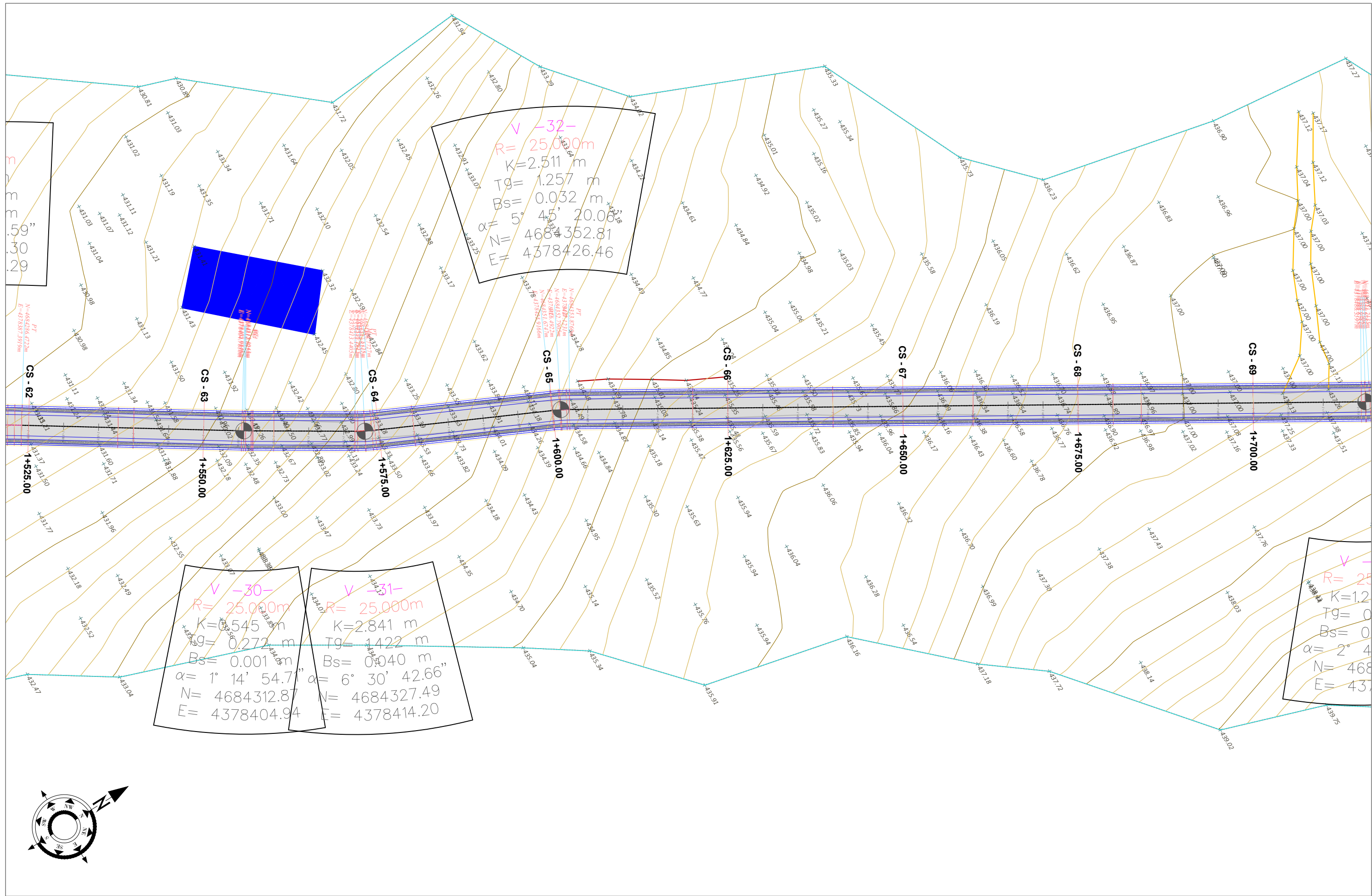

SHPJEGUES

- $\cdot 156.95$
- $\cdot 158.0$
- Izohipse
- Objekt
- Kanal Natyral
- Rrethim
- Mur Rrethues

Porositi :
BASHKIA
MALESI E
MADHE

Projektoi:
"LENI-ING" sh.p.k
Liqense: N.2969
ADMINISTRATOR Nikoll PALUCA
Adresa: Rr. Uran Pano, Pallati 12 kat, Kati 2
Mobile: 0682042270
Email: leni-ing@hotmail.com

Objekti: Sistemim Asfaltim rruga e Sterkuj
Faza: Projekt - Zbatim
Emërtimi i Fletës: PLANIMETRIA E RRUGES
Shkalla: Sh 1:500
Tiranë 2023
PL (10)

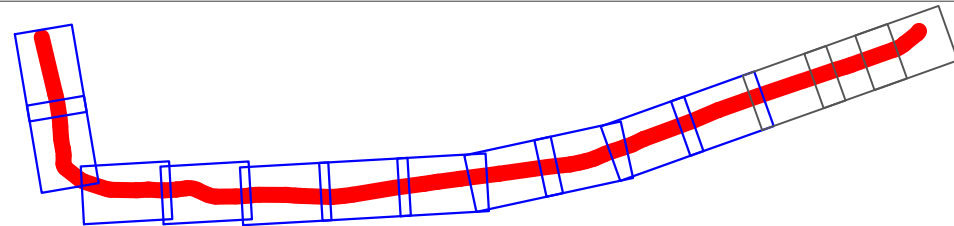
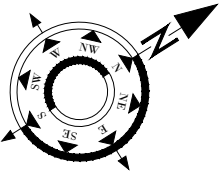
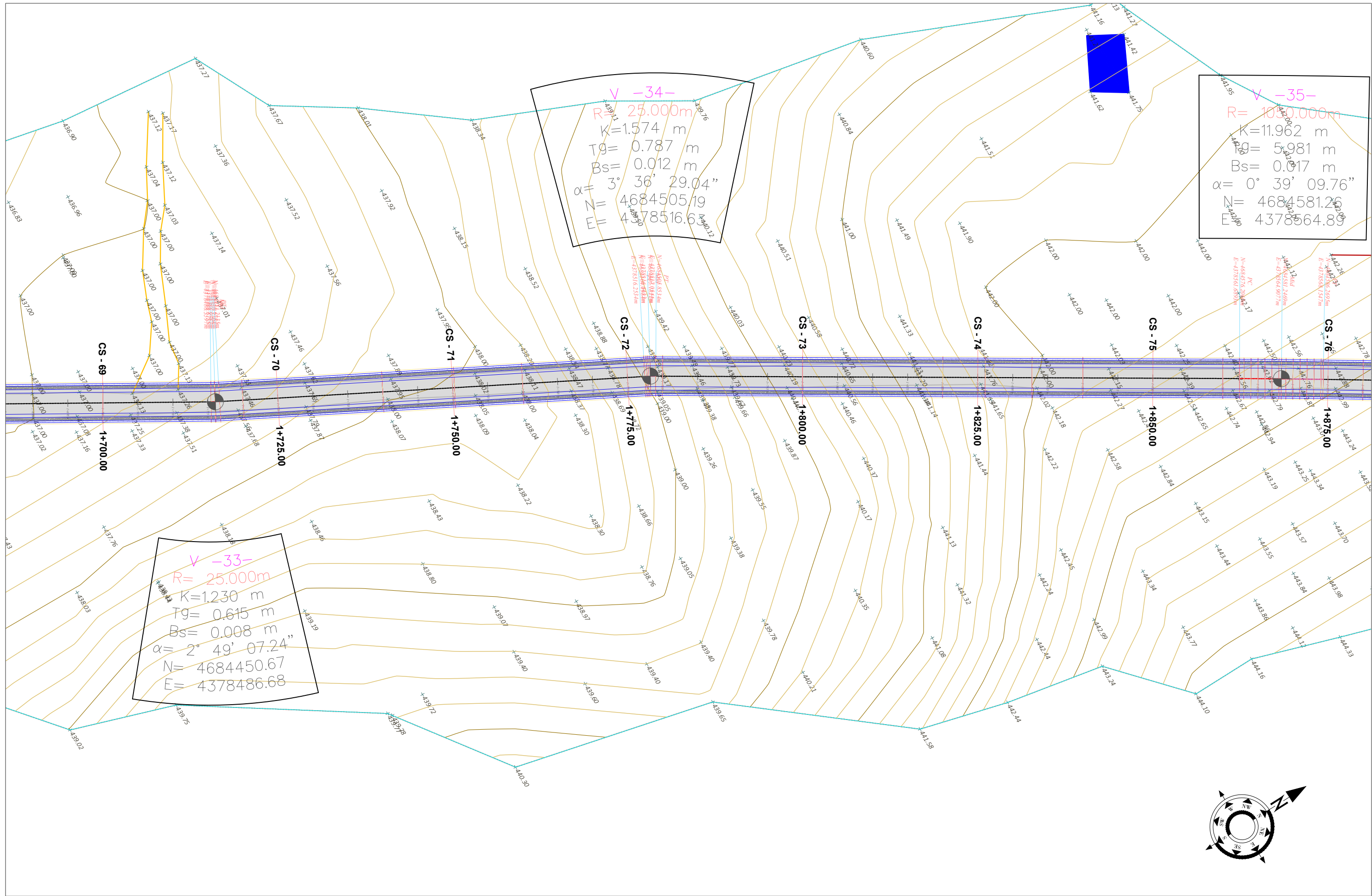

- SHPJEGUES**
- 156.95 Pike detaje
 - 158.0 Izohipse
 - Objekt
 - Kanal Natyral
 - Rrethim
 - Mur Rrethues

Porositi :
 BASHKIA
 MALESI E
 MADHE

Projektoi:
 "LENI-ING" sh.p.k
 Liçense: N.2969
 ADMINISTRATOR Nikoll PALUCA
 Adresa: Rr. Uran Pano, Pallati 12 kat, Kati 2
 Mobile: 0682042270
 Email: leni-ing@hotmail.com

| | | |
|---|----------------------|---------------------------|
| Objekti: Sistemim Asfaltim rruga e Sterkuj | | |
| Faza: Projekt - Zbatim | | |
| Emërtimi i Fletës: PLANIMETRIA E RRUGES | Shkalla: Sh 1:500 | Tiranë 2023 PL (11) |

V -35-
 R= 1000.000m
 K=11.962 m
 Tg= 5.981 m
 Bs= 0.017 m
 $\alpha = 0^\circ 39' 09.76''$
 N= 4684581.26
 E= 4378564.89

V -36-
 R= 3500.000m
 K=2.888 m
 Tg= 1.444 m
 Bs= 0.000 m
 $\alpha = 0^\circ 02' 50.21''$
 N= 4684669.34
 E= 4378622.19

V
 R=
 K=
 Tg=
 Bs=
 $\alpha = 1^\circ$
 N= 4
 E= 4

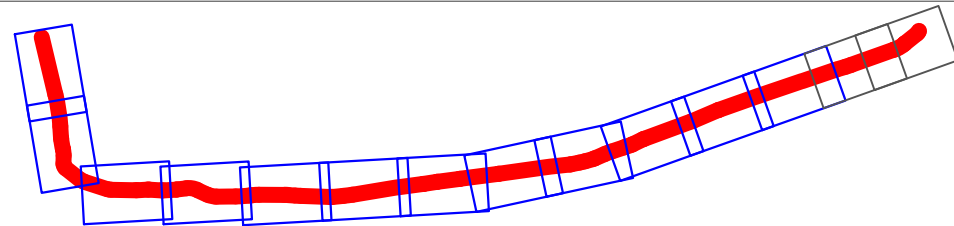
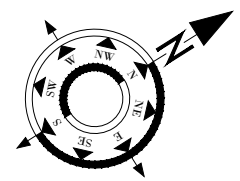
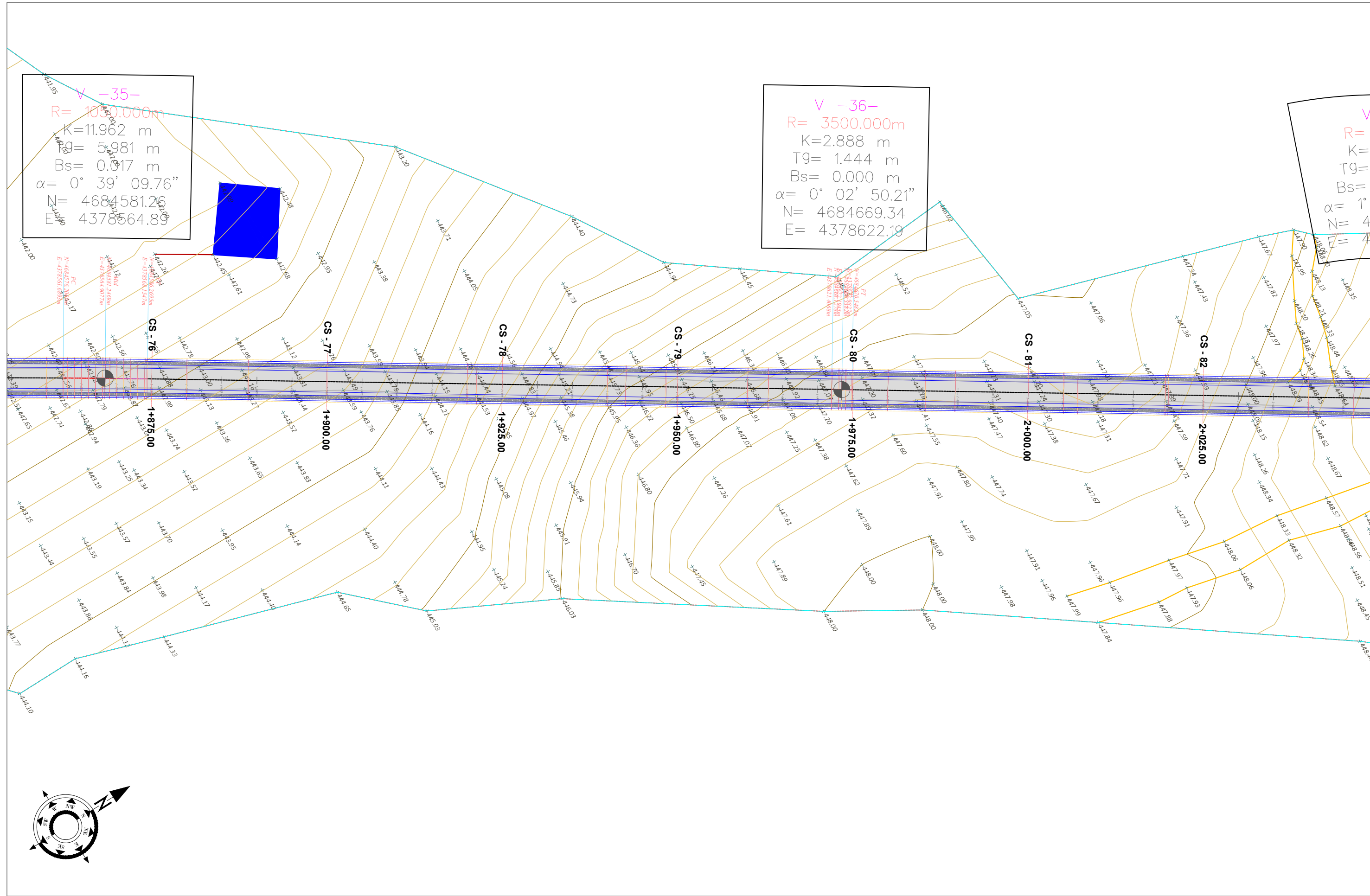

- SHPJEGUES**
- 156.95
 - 158.0
 - **Pike detaje**
 - **Izohipse**
 - **Objekt**
 - **Kanal Natyral**
 - **Rrethim**
 - **Mur Rrethues**

Porositi :
 BASHKIA
 MALESI E
 MADHE

Projekto:
 "LENI-ING" sh.p.k
 Liçense: N.2969
 ADMINISTRATOR Nikoll PALUCA
 Adresa: Rr. Uran Pano, Pallati 12 kat, Kati 2
 Mobile: 0682042270
 Email: leni-ing@hotmail.com

| | | |
|---|-----------------------------|-----------------------------------|
| Objekti: Sistemim Asfaltim rruga e Sterkuj | | |
| Faza: Projekt – Zbatim | | |
| Emërtimi i Fletës: PLANIMETRIA E RRUGES | Shkalla: Sh 1:500 | Tiranë 2023 PL (12) |

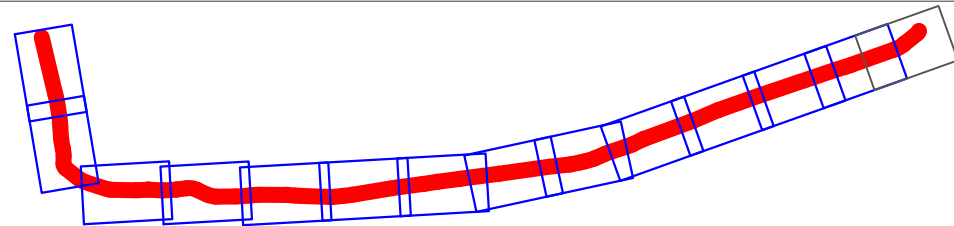
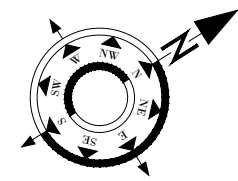
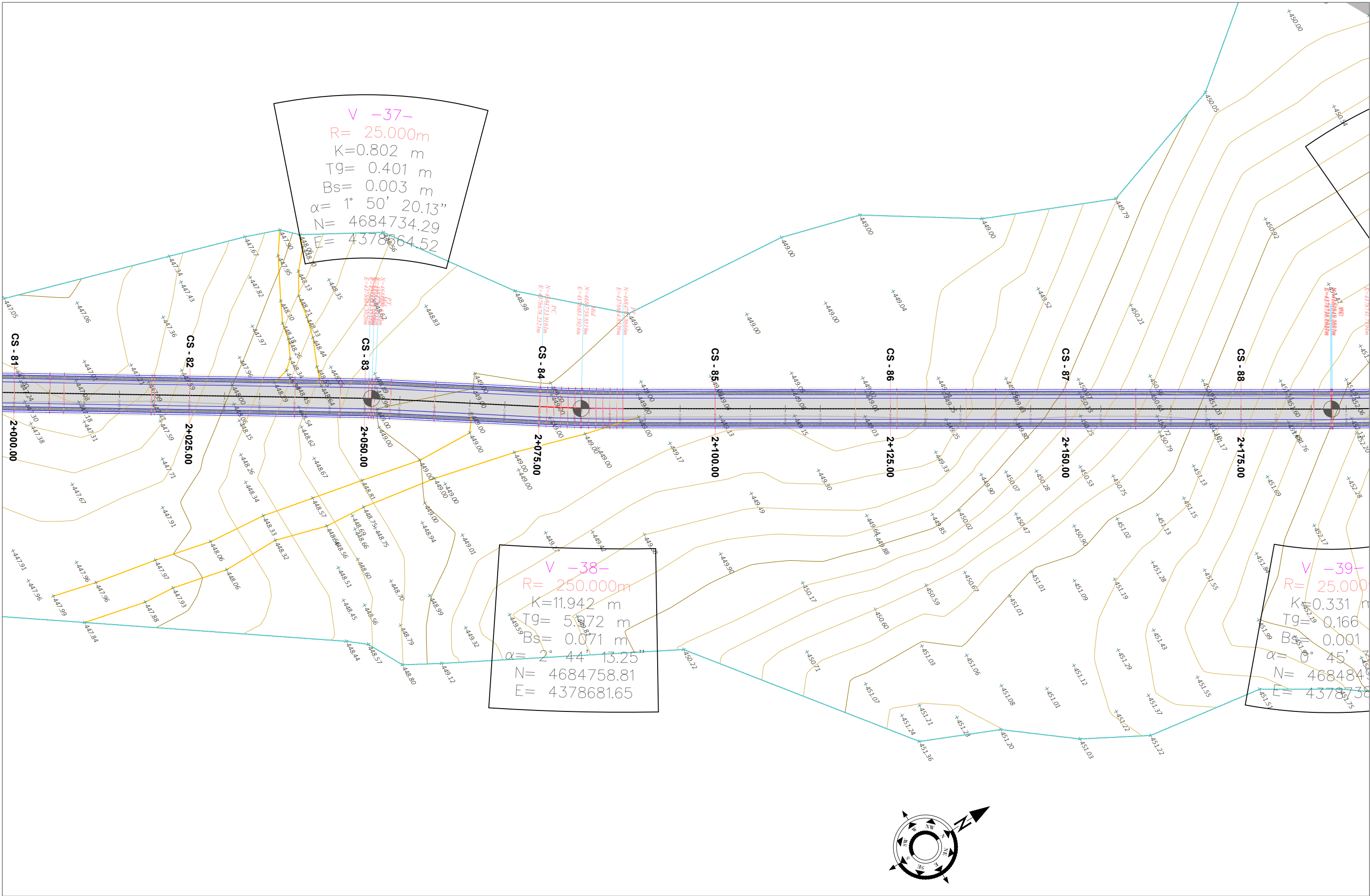

SHPJEGUES

- 156.95 Pike detaje
- 158.0 Izohipse
- Objekt
- Kanal Natyral
- Rrethim
- Mur Rrethues

Porositi :
 BASHKIA
 MALESI E
 MADHE

Projektoi:
 "LENI-ING" sh.p.k
 Liçense: N.2969
 ADMINISTRATOR Nikoll PALUCA
 Adresa: Rr. Uran Pano, Pallati 12 kat, Kati 2
 Mobile: 0682042270
 Email: leni-ing@hotmail.com

| | | |
|---|----------------------|---------------------------|
| Objekti: Sistemim Asfaltim rruga e Sterkuj | | |
| Faza: Projekt - Zbatim | | |
| Emërtimi i Fletës: PLANIMETRIA E RRUGES | Shkalla: Sh 1:500 | Tiranë 2023 PL (13) |

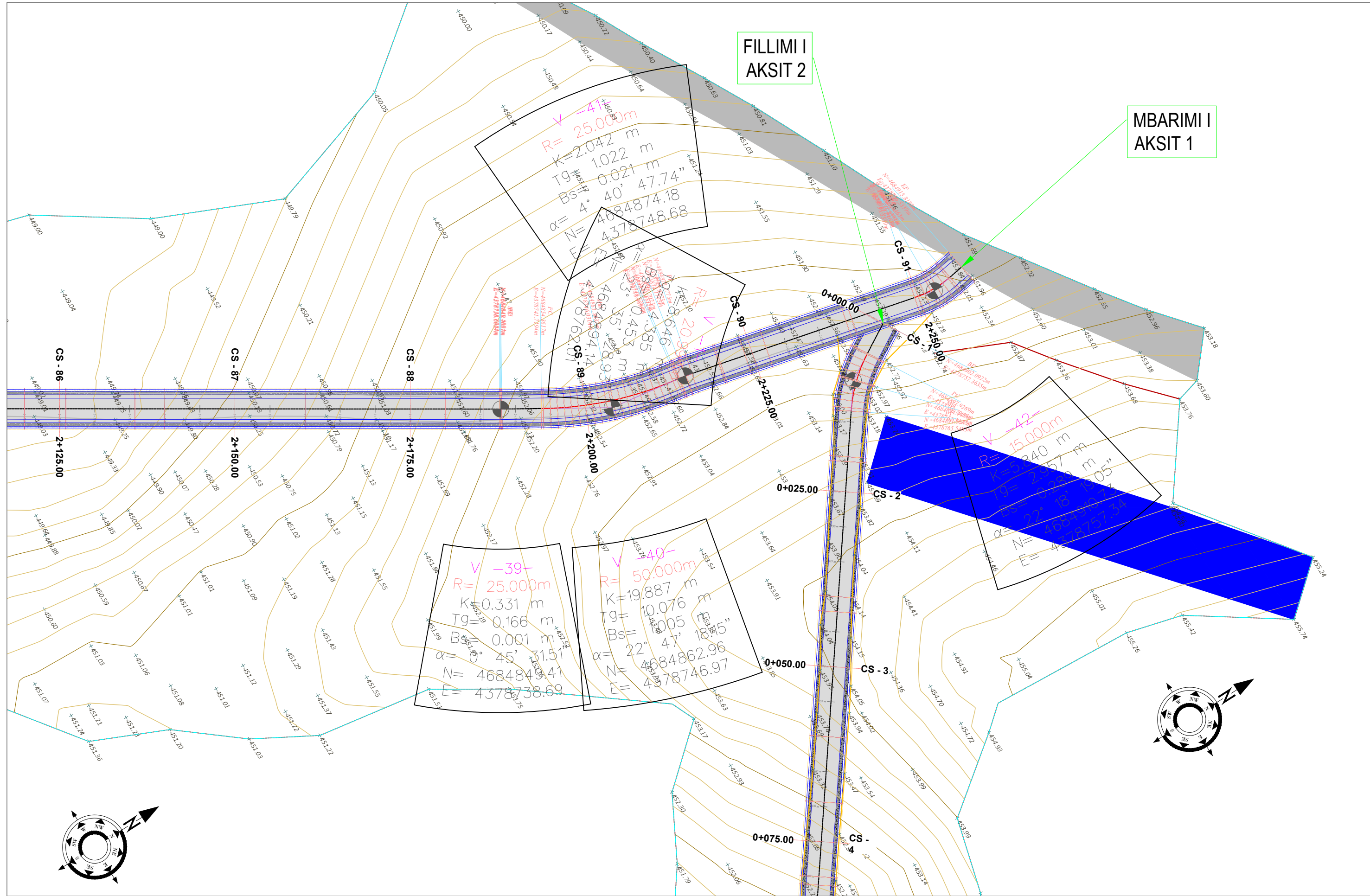

FILLIMI I
AKSIT 2

MBARIMI I
AKSIT 1

$V = -41$
 $R = 25.000\text{m}$
 $K = 2.042\text{ m}$
 $Tg = 1.022\text{ m}$
 $Bs = 0.021\text{ m}$
 $\alpha = 40' 47.74''$
 $N = 4684874.18$
 $E = 4378748.68$

$R = 200$
 $K = 8.046\text{ m}$
 $Tg = 0.453\text{ m}$
 $Bs = 0.385\text{ m}$
 $\alpha = 35' 4.385''$
 $N = 4684894.14$
 $E = 4378762.01$

$V = -42$
 $R = 15.000\text{m}$
 $K = 3.240\text{ m}$
 $Tg = 1.620\text{ m}$
 $Bs = 0.005\text{ m}$
 $\alpha = 22' 16.805''$
 $N = 4684875.54$
 $E = 4378757.54$

$V = -39$
 $R = 25.000\text{m}$
 $K = 0.331\text{ m}$
 $Tg = 0.166\text{ m}$
 $Bs = 0.001\text{ m}$
 $\alpha = 45' 11.51''$
 $N = 4684849.41$
 $E = 4378738.69$

$V = -40$
 $R = 50.000\text{m}$
 $K = 19.887\text{ m}$
 $Tg = 10.076\text{ m}$
 $Bs = 0.005\text{ m}$
 $\alpha = 22' 47' 10.05''$
 $N = 4684862.96$
 $E = 4378746.97$

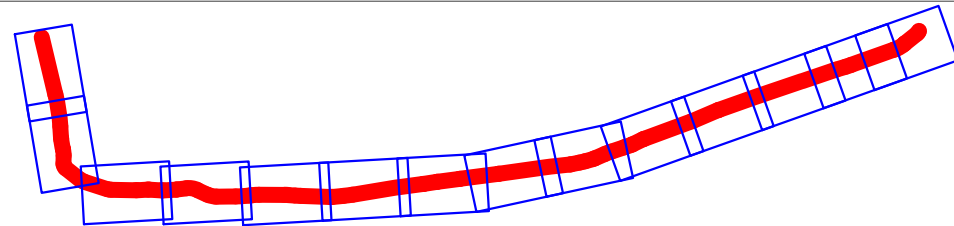
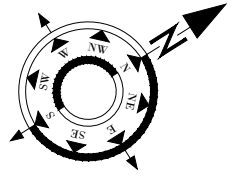
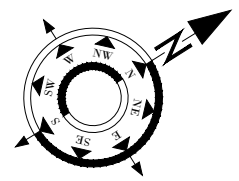

SHPJEGUES

- 156.95 Pike detaje
- 158.0 Izohipse
- Objekt
- Kanal Natyral
- Rrethim
- Mur Rrethues

Porositi :
 BASHKIA
 MALESI E
 MADHE

Projektoi:
 "LENI-ING" sh.p.k
 Liçense: N.2969
 ADMINISTRATOR Nikoll PALUCA
 Adresa: Rr. Uran Pano, Pallati 12 kat, Kati 2
 Mobile: 0682042270
 Email: leni-ing@hotmail.com

| | | |
|---|----------------------|---------------------------|
| Objekti: Sistemim Asfaltim rruga e Sterkuj | | |
| Faza: Projekt – Zbatim | | |
| Emërtimi i Fletës: PLANIMETRIA E RRUGES | Shkalla: Sh 1:500 | Tiranë 2023 PL (14) |

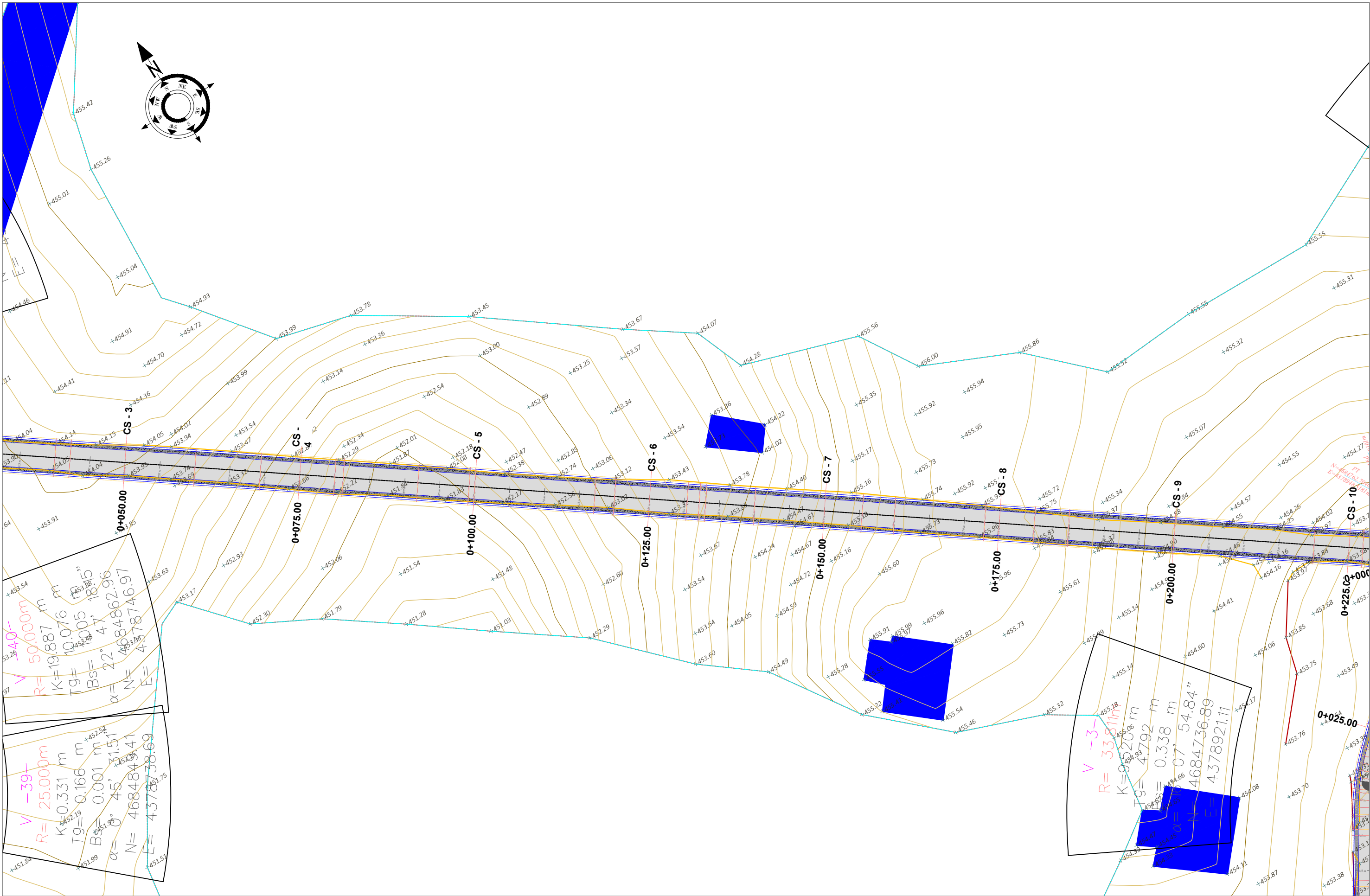

$R = 50.000\text{m}$
 $K = 19.887\text{ m}$
 $Tg = 10.076\text{ m}$
 $Bs = 10.05\text{ m}$
 $\alpha = 22^\circ 47' 18.5''$
 $N = 4684862.96$
 $E = 4378746.97$

$V - 39$
 $R = 25.000\text{m}$
 $K = 0.331\text{ m}$
 $Tg = 0.166\text{ m}$
 $Bs = 0.001\text{ m}$
 $\alpha = 45^\circ 31' 15.1''$
 $N = 4684849.41$
 $E = 4378738.69$

$V - 3$
 $R = 33.000\text{m}$
 $K = 0.520\text{ m}$
 $Tg = 4.792\text{ m}$
 $Bs = 0.338\text{ m}$
 $\alpha = 16^\circ 07' 54.84''$
 $N = 4684736.89$
 $E = 4378921.11$

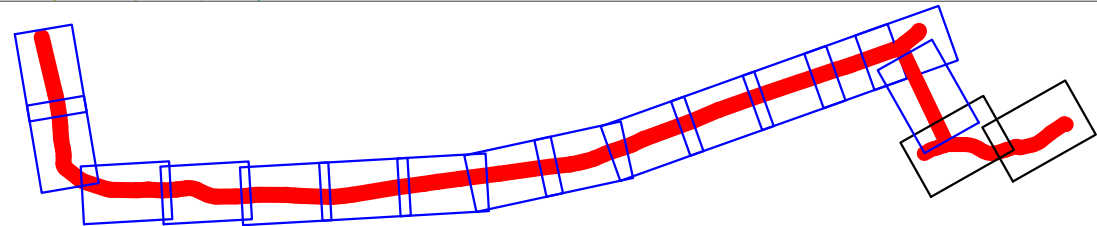

- SHPJEGUES**
- 156.95 Pike detaje
 - 158.00 Izohipse
 - Objekt
 - Kanal Natyral
 - Rrethim
 - Mur Rrethues

Porositi :
 BASHKIA
 MALESI E
 MADHE

Projektoi:
 "LENI-ING" sh.p.k
 Liçense: N.2969
 ADMINISTRATOR Nikoll PALUCA
 Adresa: Rr. Uran Pano, Pallati 12 kat, Kati 2
 Mobile: 0682042270
 Email: leni-ing@hotmail.com

| | | |
|--|----------|------------------|
| Objekti: Sistemim Asfaltim rruga e Sterkuj | | |
| Faza: | | Projekt – Zbatim |
| Emërtimi i Fletës: | Shkalla: | Tiranë 2023 |
| PLANIMETRIA E RRUGES | Sh 1:500 | PL (15) |

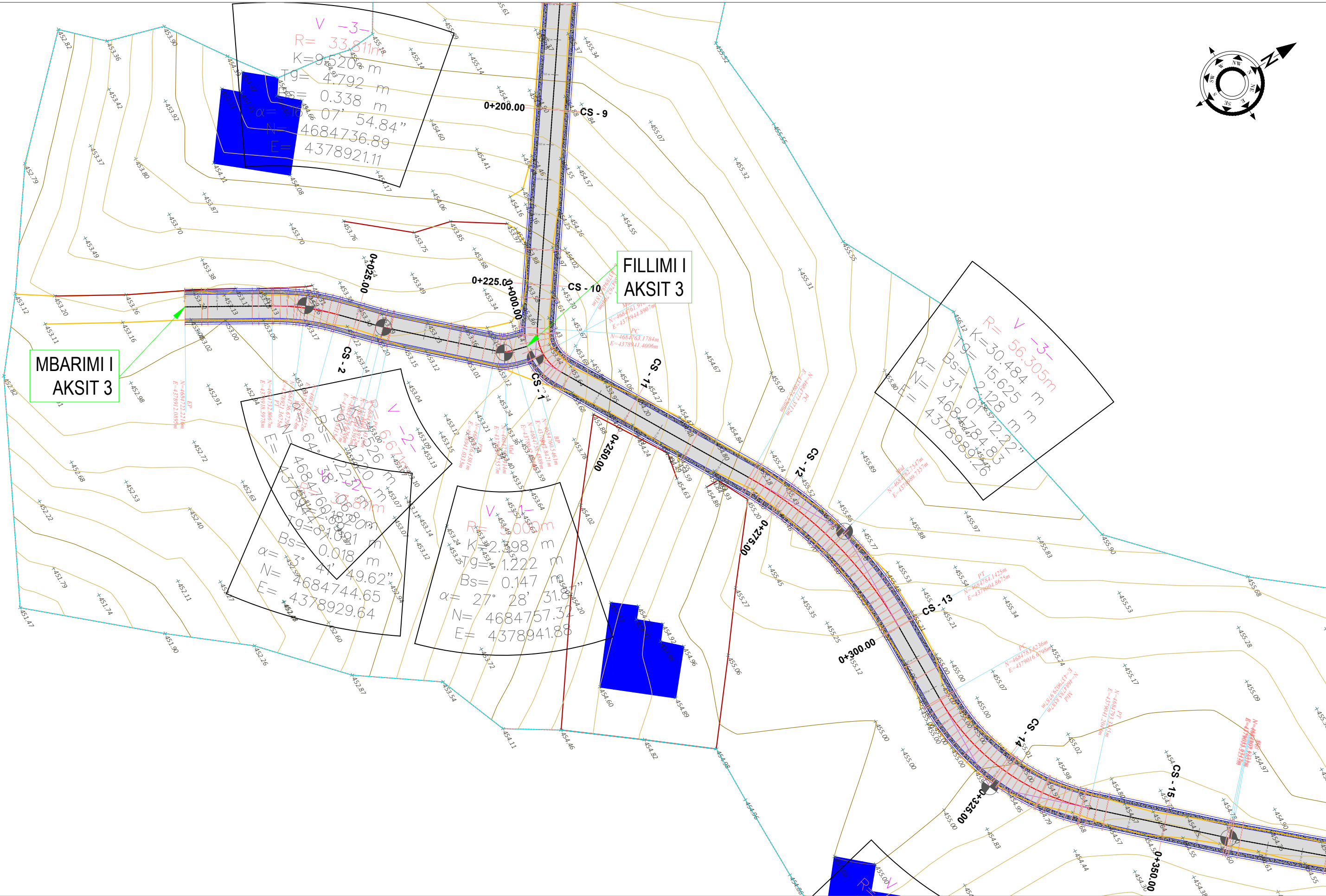
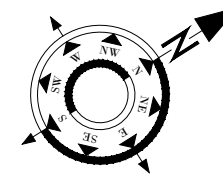

MBARIMI I
AKSIT 3

FILLIMI I
AKSIT 3

$R = 33.811m$
 $Tg = 4.792 m$
 $Bs = 0.338 m$
 $\alpha = 07^{\circ} 54.84''$
 $N = 4684736.89$
 $E = 4378921.11$

$R = 56.305m$
 $Tg = 30.484 m$
 $Bs = 15.625 m$
 $\alpha = 31^{\circ} 07' 12.22''$
 $N = 4684784.853$
 $E = 4378989.26$

$R = 2.98m$
 $Tg = 1.222 m$
 $Bs = 0.147 m$
 $\alpha = 27^{\circ} 28' 31''$
 $N = 4684757.37$
 $E = 4378941.88$

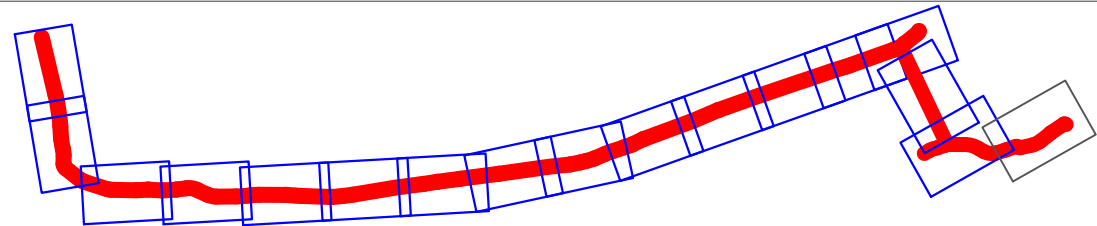

- SHPJEGUES**
- 156.95 Pike detaje
 - 158.00 Izohipse
 - Objekt
 - Kanal Natyral
 - Rrethim
 - Mur Rrethues

Porositi :
 BASHKIA
 MALESI E
 MADHE

Projektoi:
 "LENI-ING" sh.p.k
 Liçense: N.2969
 ADMINISTRATOR Nikoll PALUCA
 Adresa: Rr. Uran Pano, Pallati 12 kat, Kati 2
 Mobile: 0682042270
 Email: leni-ing@hotmail.com

| | | |
|---|----------------------|---------------------------|
| Objekti: Sistemim Asfaltim rruga e Sterkuj | | |
| Faza: Projekt - Zbatim | | |
| Emërtimi i Fletës: TOPOGRAFIJA E RRUGES | Shkalla: Sh 1:500 | Tiranë 2023 PL (16) |

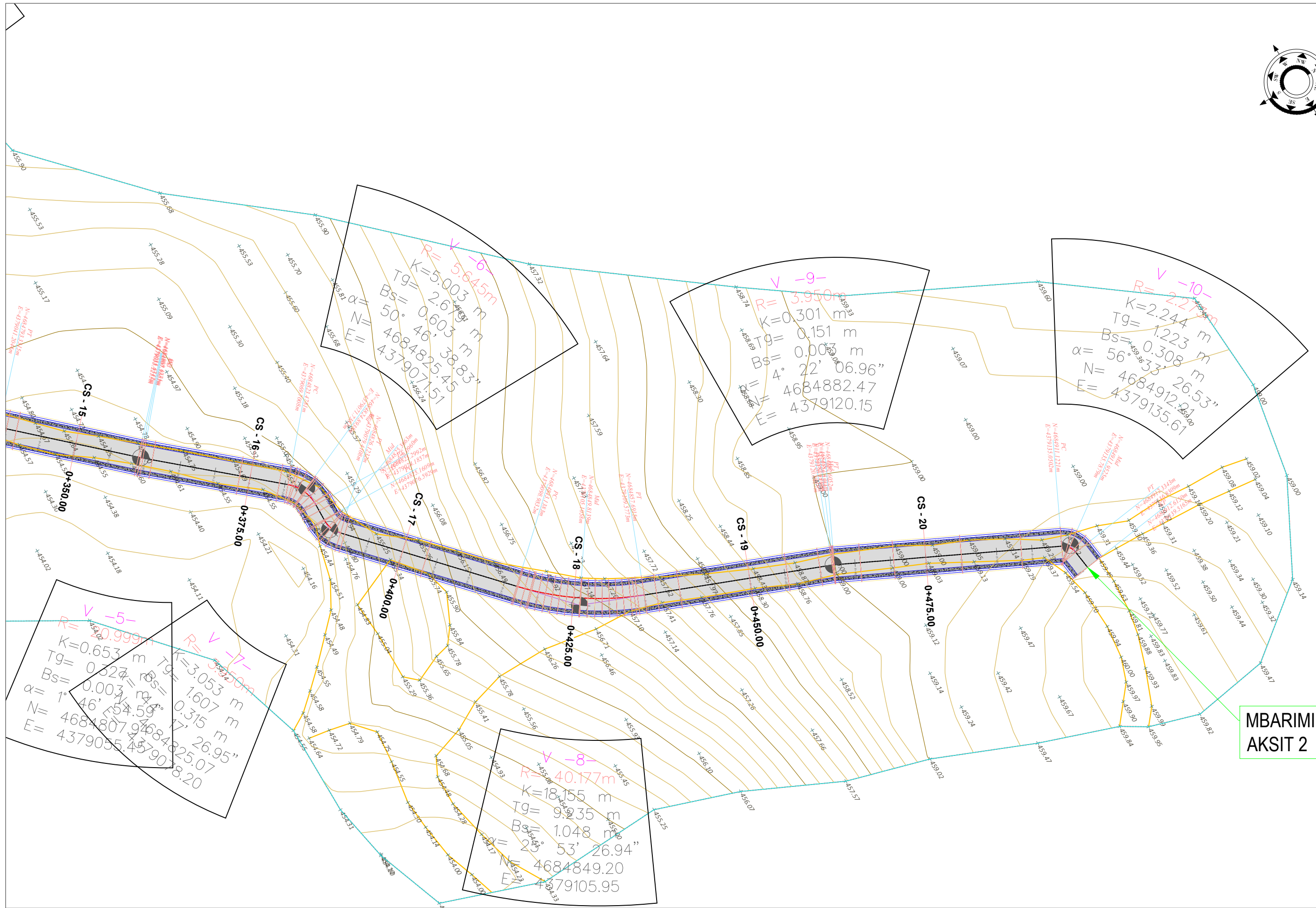
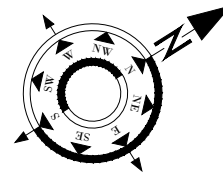

MBARIMI I AKSIT 2

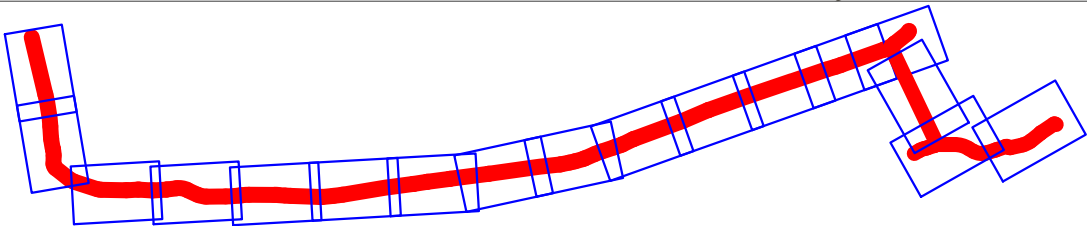

- SHPJEGUES**
- 156.95 Pike detaje
 - 158.0 Izohipse
 - Objekt
 - Kanal Natyral
 - Rrethim
 - Mur Rrethues

Porositi :
BASHKIA MALESI E MADHE

Projektoi:
"LENI-ING" sh.p.k
Liçense: N.2969
ADMINISTRATOR Nikoll PALUCA
Adresa: Rr. Uran Pano, Pallati 12 kat, Kati 2
Mobile: 0682042270
Email: leni-ing@hotmail.com

| | | |
|---|-----------------------------|-------------------------------|
| Objekti: Sistemim Asfaltim rruga e Sterkuj | | |
| Faza: Projekt – Zbatim | | |
| Emërtimi i Fletës: TOPOGRAFIJA E RRUGES | Shkalla: Sh 1:500 | Tiranë 2023 PL (17) |