

PROJEKTI NGROHJES

OBJEKTI: "RIKONSTRUKSIONI I KONVIKTIT TE SHKOLLES MESME BUJQESORE "MIHAL SHAHINI " QYTETI CERRIK"

FINANCUES: Ministria e Financave Tirane

PERFITUES: Bashkia Cerrik

PROJEKTUES: ZENIT&CO sh.p.k

Tiranë 2024

NGROHJA / KATI PERDHE

POROSITESI / CLIENT



REPUBLIKA E SHQIPERISE
MINISTRIA E FINANCAVE DHE EKONOMISE



BASHKIA CERRIK

KONSULENT / CONSULTANT



"ZENIT&CO"
architectural design
urban planning

Rr.Myrteza Topi (Nr 18.zip.code.1007)
E-Mail: zenit06@live.com

address:

SHENIME TEKNIKE / TECHNICAL NOTES

PROJEKTI / PROJECT NAME

"RIKONSTRUKSIONI I KONVIKTIT
TE SHKOLLES MESME
BUJQESORE "MIHAL SHAHINI"
QYTETI CERRIK"

ZONA / LOCATION

BASHKIA CERRIK

FAZA E PROJEKTTIT / PROJECT PHASE

PROJEKT ZBATIMI
IMPLEMENTATION DESIGN

PROJEKTI ARKITEKTONIK / ARCHITECTURAL DESIGN

Ark.Rajmonda MYDINLLARI
Nr.Lic.A.0216/2
Ark.Enea MANOKU Nr.Lic.A.1714/1

PROJEKTI KONSTRUKTIV / STRUCTURAL DESIGN

Ing.Flutura DURO
Nr.Lic.K.2438/1

EKSPERT PER MATERIALET / MATERIAL EXPERT

Ing.Arjola Mazari
Nr.Lic.K.1775/1

PROJEKTI HIDROSANITAR / MUNICIPAL DESIGN

Ing.Merita MEGRI
Nr.Lic.H/T.0142/5

PROJEKTI ELEKTRIK / ELECTRICAL DESIGN

Ing.Kristaq ZHUPA
Nr.Lic.E.0848/2

EMERTIMI I FLETES / TITLE OF DESIGN

NGROHJA / KATI PERDHE

SHKALLA:
SCALE: 1:200

NR.FLETES / DRAWING No.

Shtator 2024
September 2024

M-01

VULA / STAMP

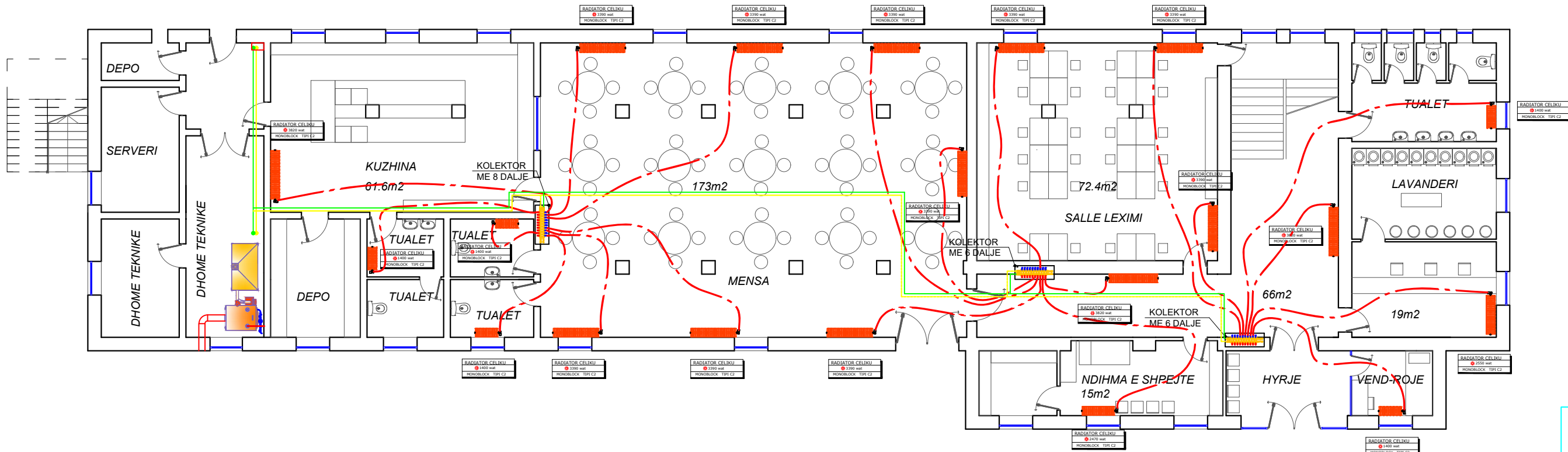

TUB MULTISTRAT

LEGJENDA	
SIMBOLI	PERSHKRIMI
	KOLEKTOR SHPERNDARES
	RADIATOR ME ELEMNTE AL
	FILTER UJI I TIPIT "Y"
	VALVOL 3-RRUGESHE E MOTORIZUAR
	XHUNTO ANTIVIBRUESE
	VALVOL KONTROLLI
	KUNDRVALVOL
	MANOMETER ME MINISARCINESKE
	ENE ZGJERIMI
	POMPE QRKULLIMI IN LINE
	VALVOL SIGURIE 4.5 BAR

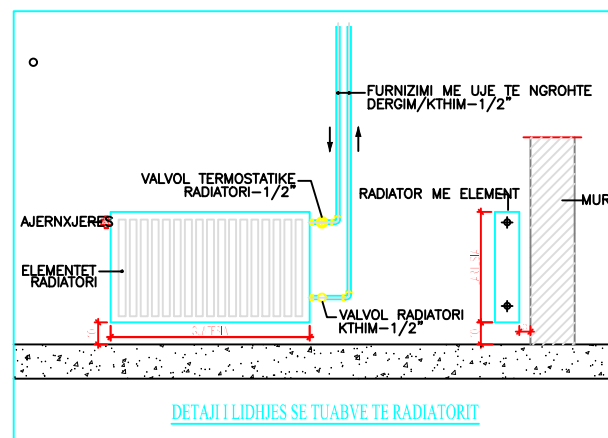

NGROHJA / KATI PARE

POROSITESI / CLIENT



REPUBLIKA E SHQIPERISE
MINISTRIA E FINANCAVE DHE EKONOMISE



BASHKIA CERRIK

KONSULENT / CONSULTANT



"ZENIT&CO"
architectural design
urban planning

Rr.Myrteza Topi (Nr 18.zip.code.1007)
E-Mail: zenit06@live.com

address:

SHENIME TEKNIKE / TECHNICAL NOTES

PROJEKTI / PROJECT NAME

"RIKONSTRUKSIONI I KONVIKTIT
TE SHKOLLES MESME
BUJQESORE "MIHAL SHAHINI"
QYTETI CERRIK"

ZONA / LOCATION

BASHKIA CERRIK

FAZA E PROJEKTTIT / PROJECT PHASE

PROJEKT ZBATIMI
IMPLEMENTATION DESIGN

PROJEKTI ARKITEKTONIK / ARCHITECTURAL DESIGN

Ark.Rajmonda MYDINLLARI
Nr.Lic.A.0216/2
Ark.Enea MANOKU Nr.Lic.A.1714/1

PROJEKTI KONSTRUKTIV / STRUCTURAL DESIGN

Ing.Flutura DURO
Nr.Lic.K.2438/1

EKSPERT PER MATERIALET / MATERIAL EXPERT

Ing.Arjola Mazari
Nr.Lic.K.1775/1

PROJEKTI HIDROSANITAR / MUNICIPAL DESIGN

Ing.Merita MEGRI
Nr.Lic.H/T.0142/5

PROJEKTI ELEKTRIK / ELECTRICAL DESIGN

Ing.Kristaq ZHUPA
Nr.Lic.E.0848/2

EMERTIMI I FLETES / TITLE OF DESIGN

NGROHJA / KATI I PARE

SHKALLA:
SCALE: 1:200

NR.FLETES / DRAWING No.

Shtator 2024
September 2024

M-02

VULA / STAMP

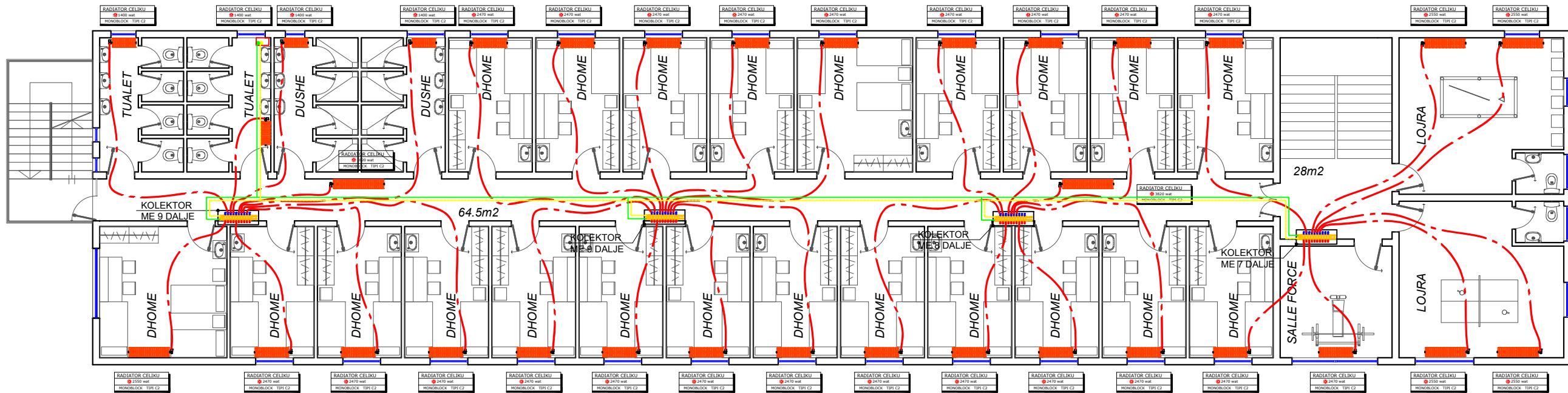

TUB MULTISTRAT

LEGJENDA	
SIMBOLI	PERSHKRIMI
	KOLEKTOR SHPERNDARES
	RADIATOR ME ELEMNTE AL
	FILTER UJI I TIPIT "Y"
	VALVOL 3-RRUGESHE E MOTORIZUAR
	XHUNTO ANTIVIBRUESE
	VALVOL KONTROLLI
	KUNDRVALVOL
	MANOMETER ME MINISARCINESKE
	ENE ZGJERIMI
	POMPE QRKULLIMI IN LINE
	VALVOL SIGURIE 4.5 BAR

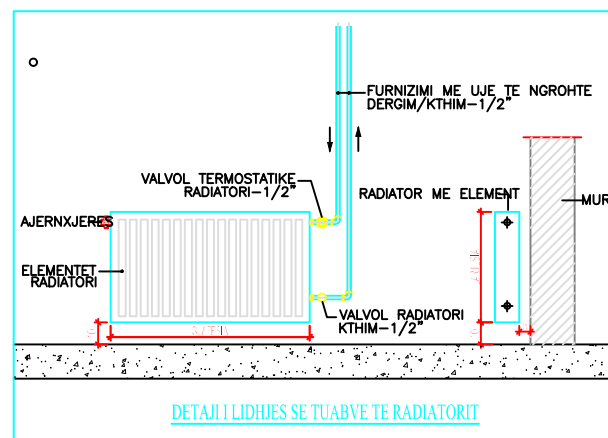

DETAJI I LIDHJES SE TUABVE TE RADIATORIT

NGROHJA / KATI I DYTE

POROSITESI / CLIENT



REPUBLIKA E SHQIPERISE
MINISTRIA E FINANCAVE DHE EKONOMISE



BASHKIA CERRIK

KONSULENT / CONSULTANT



"ZENIT&CO"
architectural design
urban planning

Rr. Myrteza Topi (Nr 18.zip.code.1007)
E-Mail: zenit06@live.com

address:

SHENIME TEKNIKE / TECHNICAL NOTES

PROJEKTI / PROJECT NAME

"RIKONSTRUKSIONI I KONVIKTIT
TE SHKOLLES MESME
BUJQESORE "MIHAL SHAHINI"
QYTETI CERRIK"

ZONA / LOCATION

BASHKIA CERRIK

FAZA E PROJEKTTIT / PROJECT PHASE

PROJEKT ZBATIMI
IMPLEMENTATION DESIGN

PROJEKTI ARKITEKTONIK / ARCHITECTURAL DESIGN

Ark.Rajmonda MYDINLLARI
Nr.Lic.A.0216/2
Ark.Enea MANOKU Nr.Lic.A.1714/1

PROJEKTI KONSTRUKTIV / STRUCTURAL DESIGN

Ing.Flutura DURO
Nr.Lic.K.2438/1

EKSPERT PER MATERIALET / MATERIAL EXPERT

Ing.Arjola Mazari
Nr.Lic.K.1775/1

PROJEKTI HIDROSANITAR / MUNICIPAL DESIGN

Ing.Merita MEGRI
Nr.Lic.H/T.0142/5

PROJEKTI ELEKTRIK / ELECTRICAL DESIGN

Ing.Kristaq ZHUPA
Nr.Lic.E.0848/2

EMERTIMI I FLETES / TITLE OF DESIGN

NGROHJA / KATI I DYTE

SHKALLA:
SCALE: 1:200

NR.FLETES / DRAWING No.

Shtator 2024
September 2024

M-03

VULA / STAMP

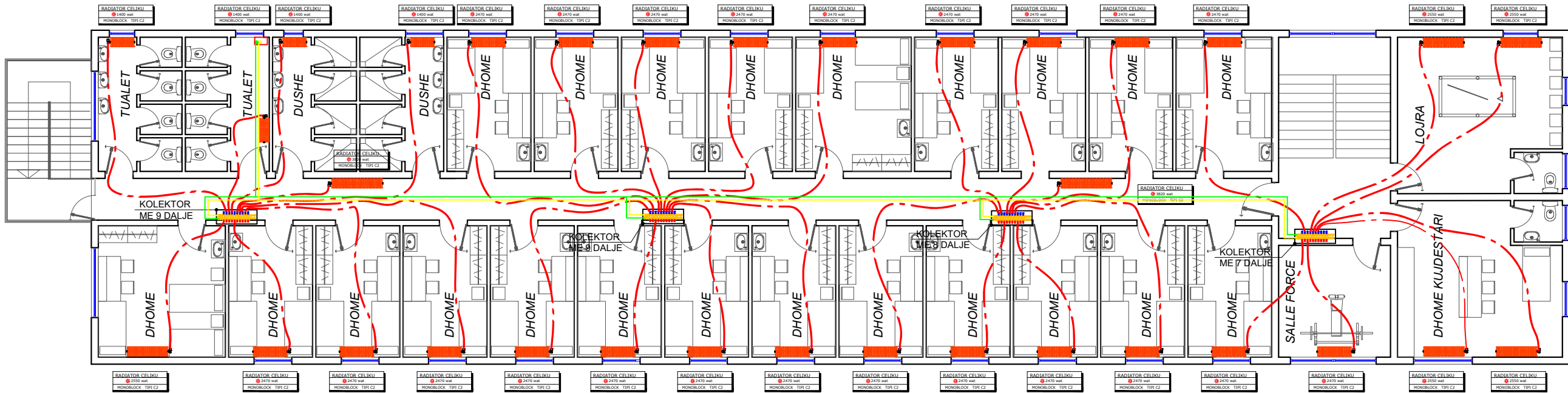

TUB MULTISTRAT

LEGJENDA	
SIMBOLI	PERSHKRIMI
	KOLEKTOR SHPERNDARES
	RADIATOR ME ELEMNTE AL
	FILTER UJI I TIPIT "Y"
	VALVOL 3-RRUGESHE E MOTORIZUAR
	XHUNTO ANTIVIBRUESE
	VALVOL KONTROLLI
	KUNDRVALVOL
	MANOMETER ME MINISARCINESKE
	ENE ZGJERIMI
	POMPE QRKULLIMI IN LINE
	VALVOL SIGURIE 4.5 BAR

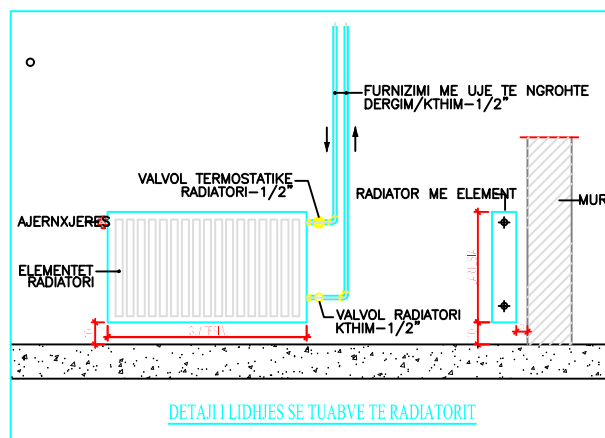

SKEMA E NGROHJES

POROSITESI / CLIENT



REPUBLIKA E SHQIPERISE
MINISTRIA E FINANCAVE DHE EKONOMISE



BASHKIA CERRIK

KONSULENTI / CONSULTANT



"ZENIT&CO"
architectural design
urban planning

Rr. Myrteza Topi (Nr 18.zip.code.1007)
E-Mail: zenit06@live.com

address:

SHENIME TEKNIKE / TECHNICAL NOTES

PROJEKTI / PROJECT NAME

"RIKONSTRUKSIONI I KONVIKTIT
TE SHKOLLES MESME
BUJQESORE "MIHAL SHAHINI"
QYTETI CERRIK"

ZONA / LOCATION

BASHKIA CERRIK

FAZA E PROJEKTTIT / PROJECT PHASE

PROJEKT ZBATIMI
IMPLEMENTATION DESIGN

PROJEKTI ARKITEKTONIK / ARCHITECTURAL DESIGN

Ark.Rajmonda MYDINLLARI
Nr.Lic.A.0216/2
Ark.Enea MANOKU Nr.Lic.A.1714/1

PROJEKTI KONSTRUKTIV / STRUCTURAL DESIGN

Ing.Flutura DURO
Nr.Lic.K.2438/1

EKSPERT PER MATERIALET / MATERIAL EXPERT

Ing.Arjola Mazari
Nr.Lic.K.1775/1

PROJEKTI HIDROSANITAR / MUNICIPAL DESIGN

Ing.Merita MEGRI
Nr.Lic.H/T.0142/5

PROJEKTI ELEKTRIK / ELECTRICAL DESIGN

Ing.Kristaq ZHUPA
Nr.Lic.E.0848/2

EMERTIMI I FLETES / TITLE OF DESIGN

SKEMA E NGROHJES

SHKALLA:
SCALE: 1:200

Shtator 2024
September 2024

NR.FLETES / DRAWING No.

M-04

VULA / STAMP

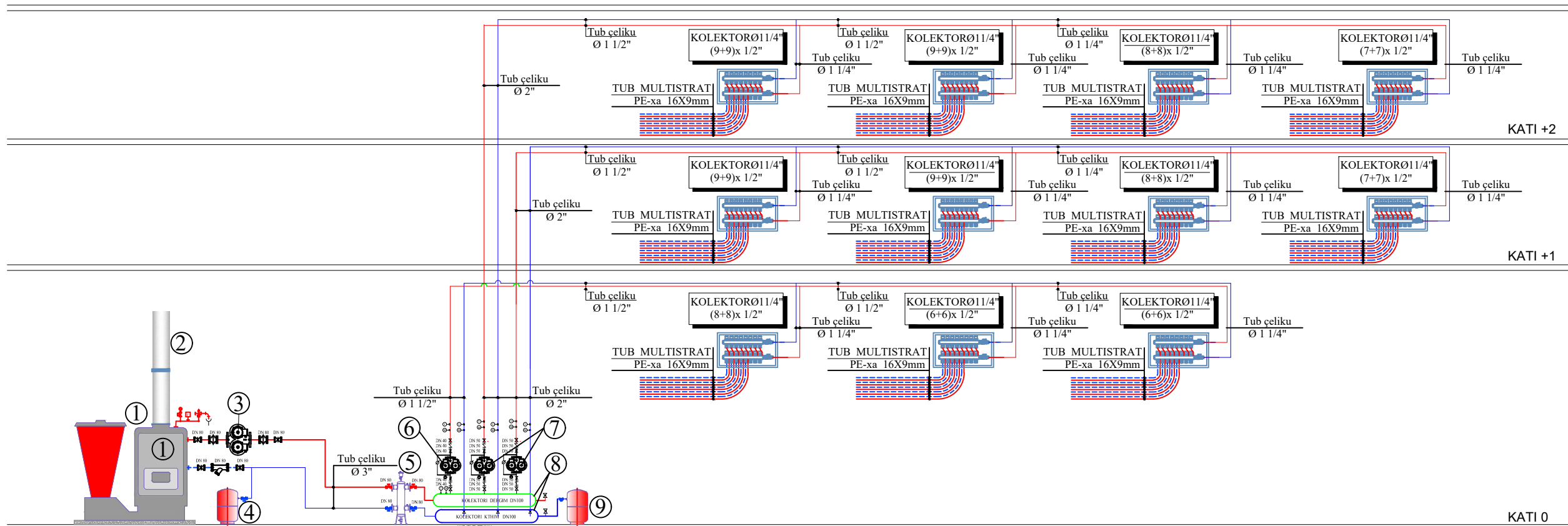

1	Kaldaje me lende djegese PELET
Fuqija nominale:	300 kW
PN Rendimenti me "Palles"	92.7%
Kapaciteti i ujit:	800 litra
Lidhjet hidraulike:	DN 65
Presioni i punes:	3.5 bar
Dipazoni i temperatures:	65÷90°C
Temp. maximale ne dergim	90°C
Temp. minmale ne rikthim 50°	
Fuqija elektrike:	7800 Wat
Lidhjet elektrike:	1x230V/50Hz/13A

3	Pompe Binjake Primare e kaldajes:
Q=33 m³/h, H=5m	
Lidhja hidraulike DN65, PN 10.	
Lidhja elektrike: 3~400 V, 50 Hz	
W = 2x2.8KW, P=2x2.5A	

2	Oxhaku i kaldajes
Diameter Ø250-300mm	
Inox dopio paret	

7	Pompa Binjake Kati 1&Kati2:
Q=9 m³/h, H=12m	
Lidhja hidraulike DN50, PN 10.	
Lidhja elektrike: 3~400 V, 50 Hz	
W = 2x0.1.5KW, P=2x2A	

6	Pompa Binjake Kati Perdhe:
Q=6.5 m³/h, H=8m	
Lidhja hidraulike DN32, PN 10.	
Lidhja elektrike: 1~220 V, 50 Hz	
W = 2x0.87KW, P=2x1A	

4	Ene zgjerimi me kapacitet:
V=35 lit, PN 10	
Lidhja Hidraulike	
DN 20	

5	Ndare Hidraulik:
Q=50 m³/h	
V=50 litra	
Lidhjet Ø3"	

8	Kolektor Kryesor DERGIM/KTHIM:
Diametri: Ø 8" (DN 200)	
Gjatesia: L= 200 cm	

9	Ene zgjerimi me kapacitet:
V=100 lit, PN 10	
Lidhja Hidraulike	
DN 25	