

ARMIMI I SHPATULLES NE AKSIN "1" (Majtas)

SH 1:75

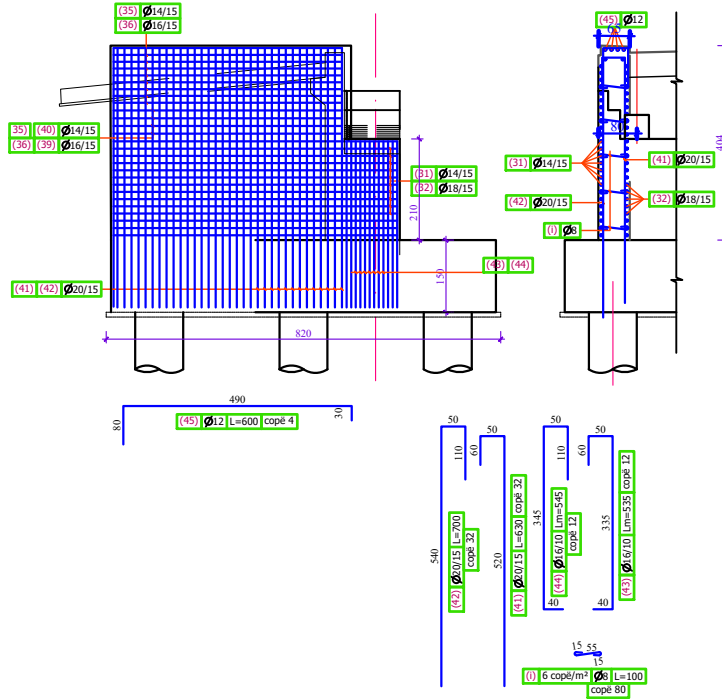

TABELA E SPECIFIKIMIT TE REKURIT PER UREN (BALLINA NE AKSIN "1" MAJTAS)							
POSICIONI	DIA MBRETE Ø (mm)	GJATESIA L (mm)	COPE	GJATESIA A Ltotal (m)	TOTAL		
					DIA MBRETE Ø (mm)	Ltotal (m)	Peshat Pesh (kg)
THEMBELU copë							
1	20	608	166	970.3			
2	20	570	95	898.4	8	150.8	0.398
3	20	1030	55	1750.0	10	2,492.1	0.617
4	20	1030	55	620.0	12	1,272.8	0.888
5	20	400	120	480.0	14	746.2	1.210
6	20	165	19	19.0	16	1,267.5	1.580
7	20	1020	14	140.0	18	931.4	2.000
8	20	520	28	520.0	20	1,109.1	2.470
9	20	333	13	40.0	22	2,233.0	1.980
10	16	400	248	288.0	25	1,865.7	3.850
11	20	400	216	864.0			
12	18	1151	20	230.6			
13	18	225	20	40.0			
14	18	225	20	40.0			
15	18	510	108	558.0			
16	12	175	71	124.3			
17	18	360	162	511.2			
18	14	1110	26	370.1			
19	12	810	8	64.8			
20	12	195	24	46.8			
21	12	240	8	24.0			
22	12	210	71	149.1			
23	12	400	13	48.0			
24	12	350	12	42.0			
25	20	350	12	42.0			
26	12	400	12	48.0			
27	20	350	12	42.0			
28	12	240	43	100.8			
29	14	677	28	195.2			
30	12	677	28	189.6			
31	14	590	13	77.0			
32	14	590	13	77.0			
33	14	590	13	77.0			
34	14	590	13	77.0			
35	14	590	13	77.0			
36	14	590	13	77.0			
37	14	590	13	77.0			
38	14	590	13	77.0			
39	14	590	13	77.0			
40	14	590	13	77.0			
41	20	670	30	201.4			
42	20	700	30	210.0			
43	16	555	12	66.2			
44	16	545	12	65.4			
45	12	600	4	24.0			
46	20	700	12	84.0			
47	20	700	12	84.0			
48	20	700	12	84.0			
49	12	400	4	16.0			
50	12	240	13	28.8			
51	20	200	54	108.0			
52	10	150	40	60.0			
53	8	140	32	44.8			
54	8	100	80	80.0			
55	8	100	35	35.0			
TOTAL (kopë) 1 BALLE							24,863.40
TOTAL (kopë) 2 BALLE							48,127.20
BALLENJA copë							
16	12	175	71	124.3		betur den Ø 10mm	3,201.62
17	18	360	162	511.2		betur nbi Ø 10mm	44,925.50
18	14	1110	26	370.1			
19	12	810	8	64.8			
20	12	195	24	46.8			
21	12	240	8	24.0			
22	12	210	71	149.1			
23	12	400	13	48.0			
24	12	350	12	42.0			
25	20	350	12	42.0			
26	12	400	12	48.0			
27	20	350	12	42.0			
28	12	240	43	100.8			
29	14	677	28	195.2			
30	12	677	28	189.6			
31	14	590	13	77.0			
32	14	590	13	77.0			
33	14	590	13	77.0			
34	14	590	13	77.0			
35	14	590	13	77.0			
36	14	590	13	77.0			
37	14	590	13	77.0			
38	14	590	13	77.0			
39	14	590	13	77.0			
40	14	590	13	77.0			
41	20	670	30	201.4			
42	20	700	30	210.0			
43	16	555	12	66.2			
44	16	545	12	65.4			
45	12	600	4	24.0			
46	20	700	12	84.0			
47	20	700	12	84.0			
48	20	700	12	84.0			
49	12	400	4	16.0			
50	12	240	13	28.8			
51	20	200	54	108.0			
52	10	150	40	60.0			
53	8	140	32	44.8			
54	8	100	80	80.0			
55	8	100	35	35.0			

TABELA E VOLUMIT TE BETONIT PER BALLIN E URES						
NR	BETON	ELEMENTI	SIPERFAQJA	SASIA	GJATESIA (Spes ort)	VOLUMI (total)
	Klasa		m ²	Cope	m	m ³
1	C30/37	Themeli i balhes	75.04	1	1.50	112.6
2		Muri i balhes	16.7	1	2.1	35.1
3		Shpatulla	10.4	1	0.65	6.8
4		Detaj sismik ne anesore	0.61	2	1.15	1.4
5		Shkelqimi	0.47	1	1.15	0.5
6		Dhembt i mbshtretjes se sol.	0.14	1	12.25	1.7
7		Detajat sismike	0.52	3	0.3	0.5
8		Detajat e mbshtretjes	0.03	7	0.5	0.1
Paret i mbshtretjes nbi ball			4.292	1	2.1	9.0
TOTAL C30/37 / 1 BALLE						167.6
TOTAL C30/37 / PER 2 BALLINA						335.3
1	C7/10	Postre themeli te ball	79.8	1	0.1	7.98
TOTAL C7/10 / 1 BALLE						7.98
TOTAL C7/10 / PER 2 BALLINA						15.96