

# KATI -1

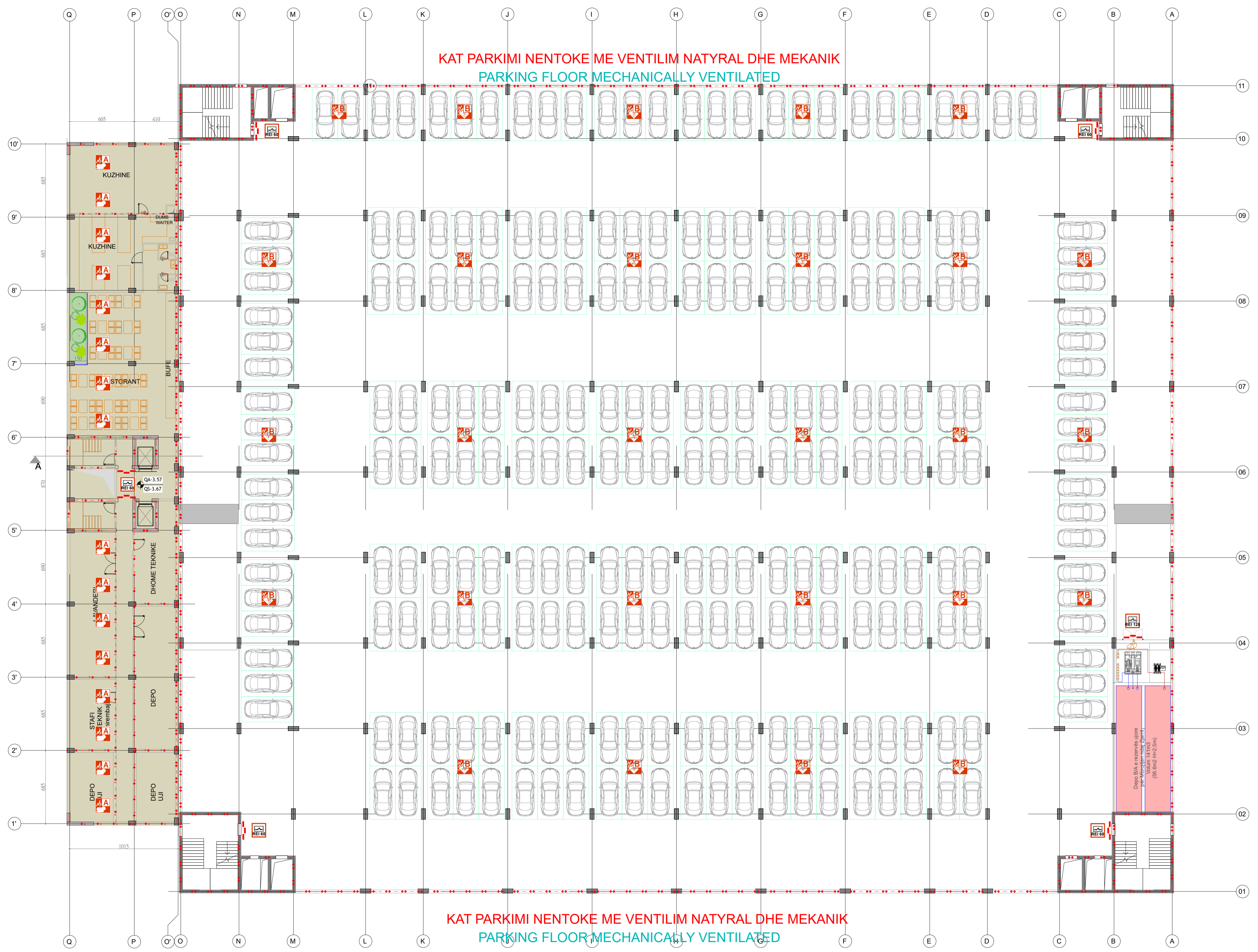

|  |   |  |  |
|--|---|--|--|
|  | DREJTIM EVAKUMIMI<br>EVACUATION DIRECTION   |  | PIKE GRUMBULLIMI<br>ASSEMBLY POINT   |
|  | DREJTIM DALJE EMERJENCE<br>EMERGENCY OUTLET DIRECTION   |  | DREJTIM ZBRITJE / EMERJENCE<br>DIRECTION FOR DESCENDING / ASCENDING EMERGENCY STAIRS                                 |
|  | FIKES ZJARRI ME UJE DN45<br>WATER FIRE EXTINGUISHER DN45  |  | FIKES ZJARRI ME PULUR<br>DRY POWDER FIRE EXTINGUISHER  |
|  | KLASA A DERRASE LETER, PLASTIKE, TEKSTILE<br>CLASS A WOOD, PAPER, PLASTIC, TEXTILE                    |  | KLASA B MATERIALE TE LINGSHEM<br>CLASS B: FLAMMABLE LIQUID MATERIALS   |
|  | PULSANT I ALARHIT TE ZJARRIT<br>FIRE ALARM BUTTON   |  | DISTANCA BERE DALJEN ME TE AFERT<br>- 20 m -<br>DISTANCE TO THE NEAREST EXIT   |
|  | NDALOHEJ PERDORIMI I UJIT PER FIKE TE ZJARRIT<br>IT IS PROHIBITED TO USE WATER TO EXTINGUISH THE FIRE |  | NDALOHEJ PERDORIMI I ASHENSORIT NE RAST ZJARRI<br>THE USE OF ELEVATORS IS PROHIBITED IN THE EVENT OF A FIRE          |
|  | REZIKU NGA TENSIONI<br>DANGER FROM ELECTRICAL VOLTAGE   |  | KULDES!<br>ATTENTION!  |
|  | DERE KUNDER ME QENDRUESHMERI KUNDER ZJARRIT<br>FIRE-RESISTANT DOOR                                    |  | STRUKTURA ME QENDRUESHMERI NE RAST ZJARRI<br>STRUCTURAL INTEGRITY WITH RESISTANCE IN CASE OF FIRE (60/90/120 MINUTE) |

JO PER ZBATIM  
NOT FOR CONSTRUCTION

| 00  |                    | Shator 2024                         |   | Projekt Leje / Permitting Design |                            |                    |           |                          |                 |                     |              |        |  |                                      |             |          |  |                                      |           |          |  |                                   |               |  |  |                                   |               |  |  |                                   |              |  |  |                                 |               |        |  |                                 |           |  |  |                                |              |          |  |                                |              |          |  |  |                    |          |  |                                      |                |          |  |                                 |                |          |  |                                    |              |          |  |
|---|--------------------|-------------------------------------|---|----------------------------------|----------------------------|--------------------|-----------|--------------------------|-----------------|---------------------|--------------|--------|--|--------------------------------------|-------------|----------|--|--------------------------------------|-----------|----------|--|-----------------------------------|---------------|--|--|-----------------------------------|---------------|--|--|-----------------------------------|--------------|--|--|---------------------------------|---------------|--------|--|---------------------------------|-----------|--|--|--------------------------------|--------------|----------|--|--------------------------------|--------------|----------|--|--|--------------------|----------|--|--------------------------------------|----------------|----------|--|---------------------------------|----------------|----------|--|------------------------------------|--------------|----------|--|
| RISH NR. REV. NO.   | DATA               | QELIMI I DOREZIMIT PURPOSE OF ISSUE | SHENIM / PERSHKRIM REMARK / DESCRIPTION |                                  |                            |                    |           |                          |                 |                     |              |        |  |                                      |             |          |  |                                      |           |          |  |                                   |               |  |  |                                   |               |  |  |                                   |              |  |  |                                 |               |        |  |                                 |           |  |  |                                |              |          |  |                                |              |          |  |  |                    |          |  |                                      |                |          |  |                                 |                |          |  |                                    |              |          |  |
| INVESTITORI CONTRACTING AUTHORITY   |                    |                                     |   |                                  |                            |                    |           |                          |                 |                     |              |        |  |                                      |             |          |  |                                      |           |          |  |                                   |               |  |  |                                   |               |  |  |                                   |              |  |  |                                 |               |        |  |                                 |           |  |  |                                |              |          |  |                                |              |          |  |  |                    |          |  |                                      |                |          |  |                                 |                |          |  |                                    |              |          |  |
| KONSULENTI INZHINIERIK ENGINEERING CONSULTANT   |                    |                                     |   |                                  |                            |                    |           |                          |                 |                     |              |        |  |                                      |             |          |  |                                      |           |          |  |                                   |               |  |  |                                   |               |  |  |                                   |              |  |  |                                 |               |        |  |                                 |           |  |  |                                |              |          |  |                                |              |          |  |  |                    |          |  |                                      |                |          |  |                                 |                |          |  |                                    |              |          |  |
| Nr. Licenses: Licence No:   |                    | N.5221/16                           |   |                                  |                            |                    |           |                          |                 |                     |              |        |  |                                      |             |          |  |                                      |           |          |  |                                   |               |  |  |                                   |               |  |  |                                   |              |  |  |                                 |               |        |  |                                 |           |  |  |                                |              |          |  |                                |              |          |  |  |                    |          |  |                                      |                |          |  |                                 |                |          |  |                                    |              |          |  |
| <table border="1"> <thead> <tr> <th>Pozicioni/Position</th> <th>Emri/Name</th> <th>Nr. Licenses/Licence No.</th> <th>Firma/Signature</th> </tr> </thead> <tbody> <tr> <td>Arktekt / Architect</td> <td>Bledi Saraci</td> <td>A.2173</td> <td></td> </tr> <tr> <td>Ing. Strukturalist / Structural Eng.</td> <td>Anila SPAHI</td> <td>K.1068/4</td> <td></td> </tr> <tr> <td>Ing. Strukturalist / Structural Eng.</td> <td>Aida VOKA</td> <td>K.1340/2</td> <td></td> </tr> <tr> <td>Ing. Hidroteknik / Hydraulic Eng.</td> <td>Artjola ZOTAJ</td> <td></td> <td></td> </tr> <tr> <td>Ing. Hidroteknik / Hydraulic Eng.</td> <td>Silvia GJONAJ</td> <td></td> <td></td> </tr> <tr> <td>Ing. Hidroteknik / Hydraulic Eng.</td> <td>Anxhela BICI</td> <td></td> <td></td> </tr> <tr> <td>Ing. Elektrik / Electrical Eng.</td> <td>Enis HAVERIKU</td> <td>E.1450</td> <td></td> </tr> <tr> <td>Ing. Elektrik / Electrical Eng.</td> <td>Ibër PUCI</td> <td></td> <td></td> </tr> <tr> <td>Ing. Mekanik / Mechanical Eng.</td> <td>Marsel PYLLA</td> <td>M.1288/1</td> <td></td> </tr> <tr> <td>Ing. Mekanik / Mechanical Eng.</td> <td>Besnik KARAJ</td> <td>M.0256/2</td> <td></td> </tr> <tr> <td>Koordinator Projekti / Project Coordinator</td> <td>Abdurrahman SPAHIU</td> <td>K.1571/5</td> <td></td> </tr> <tr> <td>Ing. Strukturalist / Structural Eng.</td> <td>Talant KARRIÇI</td> <td>K.1547/6</td> <td></td> </tr> <tr> <td>Ing. Elektrik / Electrical Eng.</td> <td>Ermeta BERISHA</td> <td>E.0550/4</td> <td></td> </tr> <tr> <td>Drejtes Prigjati / Project Manager</td> <td>Olset HAXHIU</td> <td>K.1619/5</td> <td></td> </tr> </tbody> </table> |                    |                                     |   |                                  |                            | Pozicioni/Position | Emri/Name | Nr. Licenses/Licence No. | Firma/Signature | Arktekt / Architect | Bledi Saraci | A.2173 |  | Ing. Strukturalist / Structural Eng. | Anila SPAHI | K.1068/4 |  | Ing. Strukturalist / Structural Eng. | Aida VOKA | K.1340/2 |  | Ing. Hidroteknik / Hydraulic Eng. | Artjola ZOTAJ |  |  | Ing. Hidroteknik / Hydraulic Eng. | Silvia GJONAJ |  |  | Ing. Hidroteknik / Hydraulic Eng. | Anxhela BICI |  |  | Ing. Elektrik / Electrical Eng. | Enis HAVERIKU | E.1450 |  | Ing. Elektrik / Electrical Eng. | Ibër PUCI |  |  | Ing. Mekanik / Mechanical Eng. | Marsel PYLLA | M.1288/1 |  | Ing. Mekanik / Mechanical Eng. | Besnik KARAJ | M.0256/2 |  | Koordinator Projekti / Project Coordinator | Abdurrahman SPAHIU | K.1571/5 |  | Ing. Strukturalist / Structural Eng. | Talant KARRIÇI | K.1547/6 |  | Ing. Elektrik / Electrical Eng. | Ermeta BERISHA | E.0550/4 |  | Drejtes Prigjati / Project Manager | Olset HAXHIU | K.1619/5 |  |
| Pozicioni/Position  | Emri/Name          | Nr. Licenses/Licence No.            | Firma/Signature                         |                                  |                            |                    |           |                          |                 |                     |              |        |  |                                      |             |          |  |                                      |           |          |  |                                   |               |  |  |                                   |               |  |  |                                   |              |  |  |                                 |               |        |  |                                 |           |  |  |                                |              |          |  |                                |              |          |  |  |                    |          |  |                                      |                |          |  |                                 |                |          |  |                                    |              |          |  |
| Arktekt / Architect   | Bledi Saraci       | A.2173                              |   |                                  |                            |                    |           |                          |                 |                     |              |        |  |                                      |             |          |  |                                      |           |          |  |                                   |               |  |  |                                   |               |  |  |                                   |              |  |  |                                 |               |        |  |                                 |           |  |  |                                |              |          |  |                                |              |          |  |  |                    |          |  |                                      |                |          |  |                                 |                |          |  |                                    |              |          |  |
| Ing. Strukturalist / Structural Eng.  | Anila SPAHI        | K.1068/4                            |   |                                  |                            |                    |           |                          |                 |                     |              |        |  |                                      |             |          |  |                                      |           |          |  |                                   |               |  |  |                                   |               |  |  |                                   |              |  |  |                                 |               |        |  |                                 |           |  |  |                                |              |          |  |                                |              |          |  |  |                    |          |  |                                      |                |          |  |                                 |                |          |  |                                    |              |          |  |
| Ing. Strukturalist / Structural Eng.  | Aida VOKA          | K.1340/2                            |   |                                  |                            |                    |           |                          |                 |                     |              |        |  |                                      |             |          |  |                                      |           |          |  |                                   |               |  |  |                                   |               |  |  |                                   |              |  |  |                                 |               |        |  |                                 |           |  |  |                                |              |          |  |                                |              |          |  |  |                    |          |  |                                      |                |          |  |                                 |                |          |  |                                    |              |          |  |
| Ing. Hidroteknik / Hydraulic Eng.   | Artjola ZOTAJ      |                                     |   |                                  |                            |                    |           |                          |                 |                     |              |        |  |                                      |             |          |  |                                      |           |          |  |                                   |               |  |  |                                   |               |  |  |                                   |              |  |  |                                 |               |        |  |                                 |           |  |  |                                |              |          |  |                                |              |          |  |  |                    |          |  |                                      |                |          |  |                                 |                |          |  |                                    |              |          |  |
| Ing. Hidroteknik / Hydraulic Eng.   | Silvia GJONAJ      |                                     |   |                                  |                            |                    |           |                          |                 |                     |              |        |  |                                      |             |          |  |                                      |           |          |  |                                   |               |  |  |                                   |               |  |  |                                   |              |  |  |                                 |               |        |  |                                 |           |  |  |                                |              |          |  |                                |              |          |  |  |                    |          |  |                                      |                |          |  |                                 |                |          |  |                                    |              |          |  |
| Ing. Hidroteknik / Hydraulic Eng.   | Anxhela BICI       |                                     |   |                                  |                            |                    |           |                          |                 |                     |              |        |  |                                      |             |          |  |                                      |           |          |  |                                   |               |  |  |                                   |               |  |  |                                   |              |  |  |                                 |               |        |  |                                 |           |  |  |                                |              |          |  |                                |              |          |  |  |                    |          |  |                                      |                |          |  |                                 |                |          |  |                                    |              |          |  |
| Ing. Elektrik / Electrical Eng.   | Enis HAVERIKU      | E.1450                              |   |                                  |                            |                    |           |                          |                 |                     |              |        |  |                                      |             |          |  |                                      |           |          |  |                                   |               |  |  |                                   |               |  |  |                                   |              |  |  |                                 |               |        |  |                                 |           |  |  |                                |              |          |  |                                |              |          |  |  |                    |          |  |                                      |                |          |  |                                 |                |          |  |                                    |              |          |  |
| Ing. Elektrik / Electrical Eng.   | Ibër PUCI          |                                     |   |                                  |                            |                    |           |                          |                 |                     |              |        |  |                                      |             |          |  |                                      |           |          |  |                                   |               |  |  |                                   |               |  |  |                                   |              |  |  |                                 |               |        |  |                                 |           |  |  |                                |              |          |  |                                |              |          |  |  |                    |          |  |                                      |                |          |  |                                 |                |          |  |                                    |              |          |  |
| Ing. Mekanik / Mechanical Eng.  | Marsel PYLLA       | M.1288/1                            |   |                                  |                            |                    |           |                          |                 |                     |              |        |  |                                      |             |          |  |                                      |           |          |  |                                   |               |  |  |                                   |               |  |  |                                   |              |  |  |                                 |               |        |  |                                 |           |  |  |                                |              |          |  |                                |              |          |  |  |                    |          |  |                                      |                |          |  |                                 |                |          |  |                                    |              |          |  |
| Ing. Mekanik / Mechanical Eng.  | Besnik KARAJ       | M.0256/2                            |   |                                  |                            |                    |           |                          |                 |                     |              |        |  |                                      |             |          |  |                                      |           |          |  |                                   |               |  |  |                                   |               |  |  |                                   |              |  |  |                                 |               |        |  |                                 |           |  |  |                                |              |          |  |                                |              |          |  |  |                    |          |  |                                      |                |          |  |                                 |                |          |  |                                    |              |          |  |
| Koordinator Projekti / Project Coordinator  | Abdurrahman SPAHIU | K.1571/5                            |   |                                  |                            |                    |           |                          |                 |                     |              |        |  |                                      |             |          |  |                                      |           |          |  |                                   |               |  |  |                                   |               |  |  |                                   |              |  |  |                                 |               |        |  |                                 |           |  |  |                                |              |          |  |                                |              |          |  |  |                    |          |  |                                      |                |          |  |                                 |                |          |  |                                    |              |          |  |
| Ing. Strukturalist / Structural Eng.  | Talant KARRIÇI     | K.1547/6                            |   |                                  |                            |                    |           |                          |                 |                     |              |        |  |                                      |             |          |  |                                      |           |          |  |                                   |               |  |  |                                   |               |  |  |                                   |              |  |  |                                 |               |        |  |                                 |           |  |  |                                |              |          |  |                                |              |          |  |  |                    |          |  |                                      |                |          |  |                                 |                |          |  |                                    |              |          |  |
| Ing. Elektrik / Electrical Eng.   | Ermeta BERISHA     | E.0550/4                            |   |                                  |                            |                    |           |                          |                 |                     |              |        |  |                                      |             |          |  |                                      |           |          |  |                                   |               |  |  |                                   |               |  |  |                                   |              |  |  |                                 |               |        |  |                                 |           |  |  |                                |              |          |  |                                |              |          |  |  |                    |          |  |                                      |                |          |  |                                 |                |          |  |                                    |              |          |  |
| Drejtes Prigjati / Project Manager  | Olset HAXHIU       | K.1619/5                            |   |                                  |                            |                    |           |                          |                 |                     |              |        |  |                                      |             |          |  |                                      |           |          |  |                                   |               |  |  |                                   |               |  |  |                                   |              |  |  |                                 |               |        |  |                                 |           |  |  |                                |              |          |  |                                |              |          |  |  |                    |          |  |                                      |                |          |  |                                 |                |          |  |                                    |              |          |  |
| TITULLI I PROJEKTTIT PROJECT TITLE  |                    |                                     |   |                                  |                            |                    |           |                          |                 |                     |              |        |  |                                      |             |          |  |                                      |           |          |  |                                   |               |  |  |                                   |               |  |  |                                   |              |  |  |                                 |               |        |  |                                 |           |  |  |                                |              |          |  |                                |              |          |  |  |                    |          |  |                                      |                |          |  |                                 |                |          |  |                                    |              |          |  |
| <p>NDERTIMI I GODINES SE PARKIMIT MULTIFUNKSIONAL ME SHUMË NIVELE NË QENDREN SPITALORE UNIVERSITARE "NËNË TEREZA" TIRANË (QSUT)<br/>CONSTRUCTION OF THE MULTI-LEVEL MULTI-FUNCTIONAL PARKING BUILDING AT THE UNIVERSITY HOSPITAL CENTER "MOTHER TERESA" TIRANA (QSUT)</p>   |                    |                                     |   |                                  |                            |                    |           |                          |                 |                     |              |        |  |                                      |             |          |  |                                      |           |          |  |                                   |               |  |  |                                   |               |  |  |                                   |              |  |  |                                 |               |        |  |                                 |           |  |  |                                |              |          |  |                                |              |          |  |  |                    |          |  |                                      |                |          |  |                                 |                |          |  |                                    |              |          |  |
| EMRI I DOKUMENTIT DOCUMENT TITLE  |                    |                                     |   |                                  |                            |                    |           |                          |                 |                     |              |        |  |                                      |             |          |  |                                      |           |          |  |                                   |               |  |  |                                   |               |  |  |                                   |              |  |  |                                 |               |        |  |                                 |           |  |  |                                |              |          |  |                                |              |          |  |  |                    |          |  |                                      |                |          |  |                                 |                |          |  |                                    |              |          |  |
| <p>PLANI I PLANI I MBROJTJES PASIVE<br/>PLANI I KATIT -1</p>  |                    |                                     |   |                                  |                            |                    |           |                          |                 |                     |              |        |  |                                      |             |          |  |                                      |           |          |  |                                   |               |  |  |                                   |               |  |  |                                   |              |  |  |                                 |               |        |  |                                 |           |  |  |                                |              |          |  |                                |              |          |  |  |                    |          |  |                                      |                |          |  |                                 |                |          |  |                                    |              |          |  |
| FAZA E PROJEKTTIT PROJECT PHASE   |                    | Nr. i Dokumentit Document No.       | Shkalla Scale                           | Rishikimi Review                 | Përmasa e fletës Page Size |                    |           |                          |                 |                     |              |        |  |                                      |             |          |  |                                      |           |          |  |                                   |               |  |  |                                   |               |  |  |                                   |              |  |  |                                 |               |        |  |                                 |           |  |  |                                |              |          |  |                                |              |          |  |  |                    |          |  |                                      |                |          |  |                                 |                |          |  |                                    |              |          |  |
| PROJEKT LEJE / PERMITTING DESIGN  |                    |                                     | 1:200                                   | 00                               | A1 (841x594mm)             |                    |           |                          |                 |                     |              |        |  |                                      |             |          |  |                                      |           |          |  |                                   |               |  |  |                                   |               |  |  |                                   |              |  |  |                                 |               |        |  |                                 |           |  |  |                                |              |          |  |                                |              |          |  |  |                    |          |  |                                      |                |          |  |                                 |                |          |  |                                    |              |          |  |
|   |                    |                                     |   |                                  | Fleta Page No.             |                    |           |                          |                 |                     |              |        |  |                                      |             |          |  |                                      |           |          |  |                                   |               |  |  |                                   |               |  |  |                                   |              |  |  |                                 |               |        |  |                                 |           |  |  |                                |              |          |  |                                |              |          |  |  |                    |          |  |                                      |                |          |  |                                 |                |          |  |                                    |              |          |  |
|   |                    |                                     |   |                                  | M.3.1                      |                    |           |                          |                 |                     |              |        |  |                                      |             |          |  |                                      |           |          |  |                                   |               |  |  |                                   |               |  |  |                                   |              |  |  |                                 |               |        |  |                                 |           |  |  |                                |              |          |  |                                |              |          |  |  |                    |          |  |                                      |                |          |  |                                 |                |          |  |                                    |              |          |  |

# KATI +0

KAT PARKIMI PERIMETRALISHT I HAPUR ME VENTILIM NATYRAL  
PARKING FLOOR NATURALLY VENTILATED IN PERIMETER

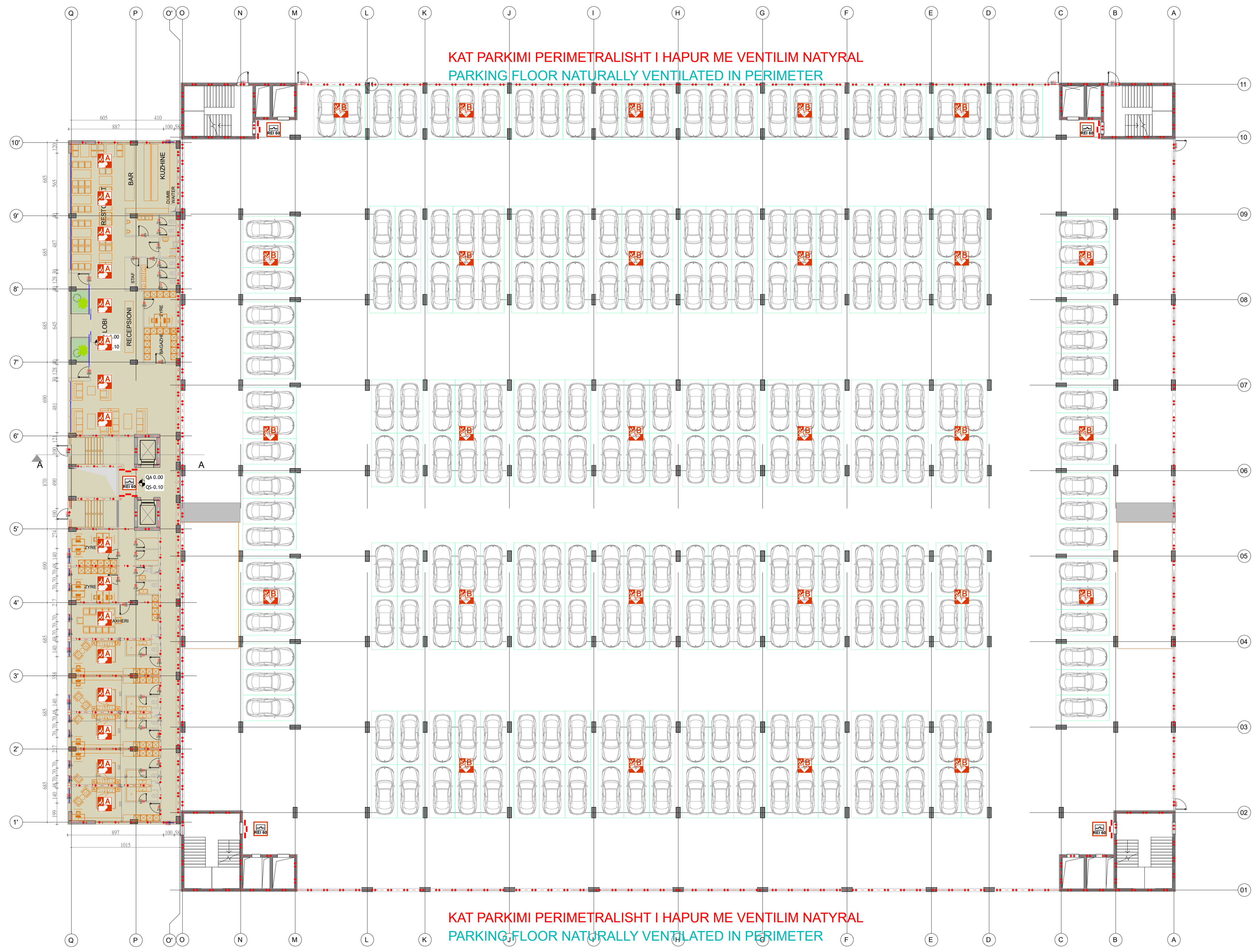

KAT PARKIMI PERIMETRALISHT I HAPUR ME VENTILIM NATYRAL  
PARKING FLOOR NATURALLY VENTILATED IN PERIMETER

|  |  |  |   |
|--|--|--|---|
|  | DREJTIM EVAKUIMI<br>EVACUATION DIRECTION   |  | PIKE GRUMBULLIMI<br>ASSEMBLY POINT  |
|  | DREJTIM DALIE EMERJENCE<br>EMERGENCY OUTLET DIRECTION  |  | DREJTIM ZBRITJE / EMERJENCE<br>DIRECTION FOR DESCENDING / ASCENDING EMERGENCY STAIRS  |
|  | FIKES ZJARRI ME UJE DN45<br>WATER FIRE EXTINGUISHER DN45   |  | FIKES ZJARRI ME PULHUR<br>DRY POWDER FIRE EXTINGUISHER  |
|  | KLASA A DERRASE LETER, PLASTIE, TEKSTILE<br>CLASS A WOOD, PAPER, PLASTIC, TEXTILE                      |  | KLASA B MATERIALE TE LINGJESH<br>CLASS B: FLAMMABLE LIQUID MATERIALS  |
|  | PULSANT I ALARHIT TE ZJARRIT<br>FIRE ALARM BUTTON  |  | DISTANCA DERI DALJEN ME TE AFERT<br>- 20 m -<br>DISTANCE TO THE NEAREST EXIT  |
|  | NDALOHET PERDORIMI I UJIT PER FIKJE TE ZJARRIT<br>IT IS PROHIBITED TO USE WATER TO EXTINGUISH THE FIRE |  | NDALOHET PERDORIMI I ASHENSORIT NE RAST ZJARRI<br>THE USE OF ELEVATORS IS PROHIBITED IN THE EVENT OF A FIRE                 |
|  | REZIK NGA TENSIONI<br>DANGER FROM ELECTRICAL VOLTAGE   |  | KUDES!<br>ATTENTION!  |
|  | DERE KUNDER ME QENDRUESHMERI KUNDER ZJARRIT<br>FIRE-RESISTANT DOOR                                     |  | STRUKTURA ME QENDRUESHMERI NE RAST ZJARRI<br>STRUCTURAL INTEGRITY WITH RESISTANCE IN THE EVENT OF A FIRE (60/90/120 MINUTE) |

JO PER ZBATIM  
NOT FOR CONSTRUCTION

|   |                                  |   |   |                               |                   |
|---|----------------------------------|---|---|-------------------------------|-------------------|
| 00  | Shator 2024                      | Projekt Leje / Permitting Design  |   |                               |                   |
| RISH NR. REV. NO.   | DATA                             | QELIMI I DOREZIMIT<br>PURPOSE OF ISSUE  | SHENIMI / PERSHKRIM<br>REMARK / DESCRIPTION |                               |                   |
| INVESTITORI<br>CONTRACTING AUTHORITY  |                                  | <p>FONDI SHQIPTAR I ZHVILLIMIT</p>  |   |                               |                   |
| KONSULENTI INZHINIERIK<br>ENGINEERING CONSULTANT  |                                  | <p>ILLYRIAN CONSULTING ENGINEERS<br/>Address: Rr. "Sami Frasheri", Pallat "Bora", Kat. II, Tirane, SHQIPËRI<br/>Tel: +355 4 200 772, Email: info@ice.al</p> |   |                               |                   |
| Përgatit / Prepared by:   |                                  | Arktekt / Architect   | Bledi Saraci                                | A.2173                        |                   |
|   |                                  | Ing. Strukturalist / Structural Eng.  | Anila SPAHUI                                | K.1068/4                      |                   |
|   |                                  | Ing. Strukturalist / Structural Eng.  | Aida VOKA                                   | K.1340/2                      |                   |
|   |                                  | Ing. Hidroteknik / Hydraulic Eng.   | Artjola ZOTAJ                               |                               |                   |
|   |                                  | Ing. Hidroteknik / Hydraulic Eng.   | Silvia GJONAJ                               |                               |                   |
|   |                                  | Ing. Hidroteknik / Hydraulic Eng.   | Anxhela BICI                                |                               |                   |
|   |                                  | Ing. Elektrik / Electrical Eng.   | Enis HAVERIKU                               | E.1450                        |                   |
|   |                                  | Ing. Elektrik / Electrical Eng.   | Ibër PUCI                                   |                               |                   |
|   |                                  | Ing. Mekanik / Mechanical Eng.  | Marsel PYLLA                                | M.1288/1                      |                   |
| Kontrollor / Checked by:  |                                  | Ing. Mekanik / Mechanical Eng.  | Besnik KARAJ                                | M.0256/2                      |                   |
|   |                                  | Koordinator Projekti<br>Project Coordinator   | Abdurrahman SPAHUI                          | K.1571/5                      |                   |
|   |                                  | Ing. Strukturalist / Structural Eng.  | Taulant KARRIÇI                             | K.1547/6                      |                   |
|   |                                  | Ing. Elektrik / Electrical Eng.   | Emira BERISHA                               | E.0550/4                      |                   |
| Miratohet / Approved by:  |                                  | Drejtes Projekt<br>Project Manager  | Olset HAXHIU                                | K.1619/5                      |                   |
| TITULLI I PROJEKTTIT<br>PROJECT TITLE   |                                  |   |   |                               |                   |
| <p>NDERTIMI I GODINËS SË PARKIMIT MULTIFUNKSIONAL ME SHUMË NIVELE NË QENDRËN SPITALORE UNIVERSITARE "NËNË TEREZA" TIRANË (QSUT)<br/>CONSTRUCTION OF THE MULTI-LEVEL MULTI-FUNCTIONAL PARKING BUILDING AT THE UNIVERSITY HOSPITAL CENTER "MOTHER TERESA" TIRANA (QSUT)</p> |                                  |   |   |                               |                   |
| EMRI I DOKUMENTIT<br>DOCUMENT TITLE   |                                  |   |   |                               |                   |
| <p>PLANI I PLANI I MBROJTJES PASIVE<br/>PLAN I KATTIT +0</p>  |                                  |   |   |                               |                   |
| FAZA E PROJEKTTIT<br>PROJECT PHASE  | Nr. i Dokumentit<br>Document No. | Shkalla<br>Scale  | Rishikimi<br>Review                         | Përmasa e fletës<br>Page Size | Fleta<br>Page No. |
| PROJEKT LEJE / PERMITTING DESIGN  |                                  | 1:200   | 00  | A1<br>(841x594mm)             | M.3.2             |

# KATI +1

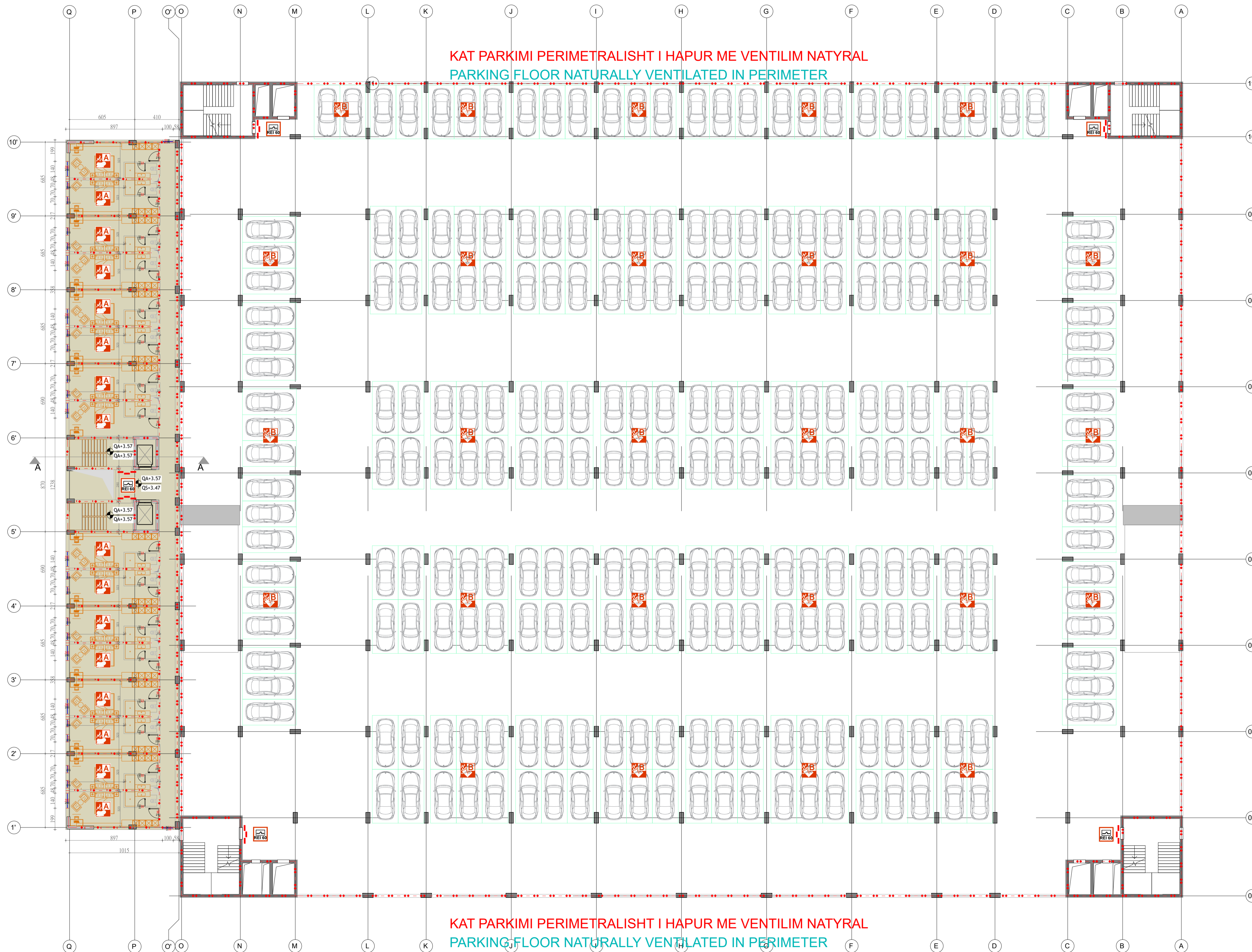

|  |   |  |  |
|--|---|--|--|
|  | DREJTIM EVAKUMIMI<br>EVACUATION DIRECTION   |  | PIKE GRUMBULLIMI<br>ASSEMBLY POINT   |
|  | DREJTIM DALJE EMERGENCY<br>EMERGENCY OUTLET DIRECTION   |  | DREJTIM ZBRITJE / EMERGENCY<br>DIRECTION FOR DESCENDING / ASCENDING EMERGENCY STAIRS                               |
|  | FIKESË ZJARRI ME UJË DN45<br>WATER FIRE EXTINGUISHER DN45   |  | FIKESË ZJARRI ME PULHUR<br>DRY POWDER FIRE EXTINGUISHER  |
|  | KLASA A DERRASE LETËR, PLASTIKE, TEKSTILE<br>CLASS A WOOD, PAPER, PLASTIC, TEXTILE                      |  | KLASA B MATERIALE TE LINGSHËM<br>CLASS B: FLAMMABLE LIQUID MATERIALS   |
|  | PULSANT I ALARHIT TE ZJARRIT<br>FIRE ALARM BUTTON   |  | DISTANCA DERI DALJEN ME TE AFERT<br>- 20 m -<br>DISTANCE TO THE NEAREST EXIT                                       |
|  | NDALOHET PERDORIMI I UJIT PER FIKEJE TE ZJARRIT<br>IT IS PROHIBITED TO USE WATER TO EXTINGUISH THE FIRE |  | NDALOHET PERDORIMI I ASHENSORIT NE RAST ZJARRI<br>THE USE OF ELEVATORS IS PROHIBITED IN THE EVENT OF A FIRE        |
|  | REZIKU INGA TENSIONI<br>DANGER FROM ELECTRICAL VOLTAGE  |  | KLUDES!<br>ATTENTION!  |
|  | DERE KUNDER ME GENDRUESHMERI KUNDER ZJARRIT<br>FIRE-RESISTANT DOOR                                      |  | STRUKTURA KONSTRUKTIVE ME GENDRUESHMERI 60/90/120 MIN<br>STRUCTURAL INTEGRITY WITH RESISTANCE (R) 60/90/120 MINUTE |

JO PER ZBATIM  
NOT FOR CONSTRUCTION

|   |                                  |  |  |
|---|----------------------------------|--|--|
| 00  | Shator 2024                      | Projekt Leje / Permitting Design   |  |
| RISH NR. REV. NO.   | DATA                             | QËLLIMI I DORËZIMIT<br>PURPOSE OF ISSUE  | SHËNIM / PËRSHKRIM<br>REMARK / DESCRIPTION |
| INVESTITORI<br>CONTRACTING AUTHORITY  |                                  | <p>FONDI SHQIPTAR I ZHVILLIMIT</p>   |  |
| KONSULENTI INXHINIERIK<br>ENGINEERING CONSULTANT  |                                  | <p>ILLYRIAN CONSULTING ENGINEERS<br/>Adresa B: "Sami Frasheri", Pallati "Bjor", Kat 11, Tirane, SHQIPËRI<br/>Tel: +355 4 200 772, Email: info@ice.al</p> |  |
| Përgatit / Prepared by:   |                                  | Arktekt / Architect  | Bledi Saraci<br>A.2173                     |
| Ing. Strukturalist / Structural Eng.  |                                  | Anila SPAHIU   | K.1068/4                                   |
| Ing. Hidroteknik / Hydraulic Eng.   |                                  | Aida VOKA  | K.1340/2                                   |
| Ing. Hidroteknik / Hydraulic Eng.   |                                  | Artjola ZOTAJ  |  |
| Ing. Hidroteknik / Hydraulic Eng.   |                                  | Silvia GJONAJ  |  |
| Ing. Hidroteknik / Hydraulic Eng.   |                                  | Anxhela BICI   |  |
| Ing. Elektrik / Electrical Eng.   |                                  | Enis HAVERIKU  | E.1450                                     |
| Ing. Elektrik / Electrical Eng.   |                                  | Ibër PUCI  |  |
| Ing. Mekanik / Mechanical Eng.  |                                  | Marsel PYLLA   | M.1288/1                                   |
| Ing. Mekanik / Mechanical Eng.  |                                  | Besnik KARRAJ  | M.0256/2                                   |
| Kontrollor / Checked by:  |                                  | Koordinator Projekti / Project Coordinator   | Abdurrahman SPAHIU<br>K.1571/5             |
| Ing. Strukturalist / Structural Eng.  |                                  | Taulant KARRIQI  | K.1547/6                                   |
| Ing. Elektrik / Electrical Eng.   |                                  | Ermira BERISHA   | E.0550/4                                   |
| Miratohet / Approved by:  |                                  | Drejtesha Projekti / Project Manager   | Olset HAXHIU<br>K.1619/5                   |
| TITULLI I PROJEKTIT<br>PROJECT TITLE  |                                  |  |  |
| <p>NDËRTIMI I GODINËS SË PARKIMIT MULTIFUNKSIONAL ME SHUMË NIVELE NË QENDRËN SPITALORE UNIVERSITARE "NËNË TEREZA" TIRANË (QSUT)<br/>CONSTRUCTION OF THE MULTI-LEVEL MULTI-FUNCTIONAL PARKING BUILDING AT THE UNIVERSITY HOSPITAL CENTER "MOTHER TERESA" TIRANA (QSUT)</p> |                                  |  |  |
| EMRI I DOKUMENTIT<br>DOCUMENT TITLE   |                                  |  |  |
| <p>PLANI I PLANI I MBROJTJES PASIVE<br/>PLAN I KATIT +1</p>   |                                  |  |  |
| FAZA E PROJEKTIT<br>PROJECT PHASE   | Nr. i Dokumentit<br>Document No. | Shkalla<br>Scale   | Rishikimi<br>Review                        |
| PROJEKT LEJE / PERMITTING DESIGN  |                                  | 1:200  | 00   |
|   | Përmasa e fletës<br>Page Size    | Fleta<br>Page No.  |  |
|   | A1<br>(841x594mm)                | M.3.3  |  |

# KATI +2

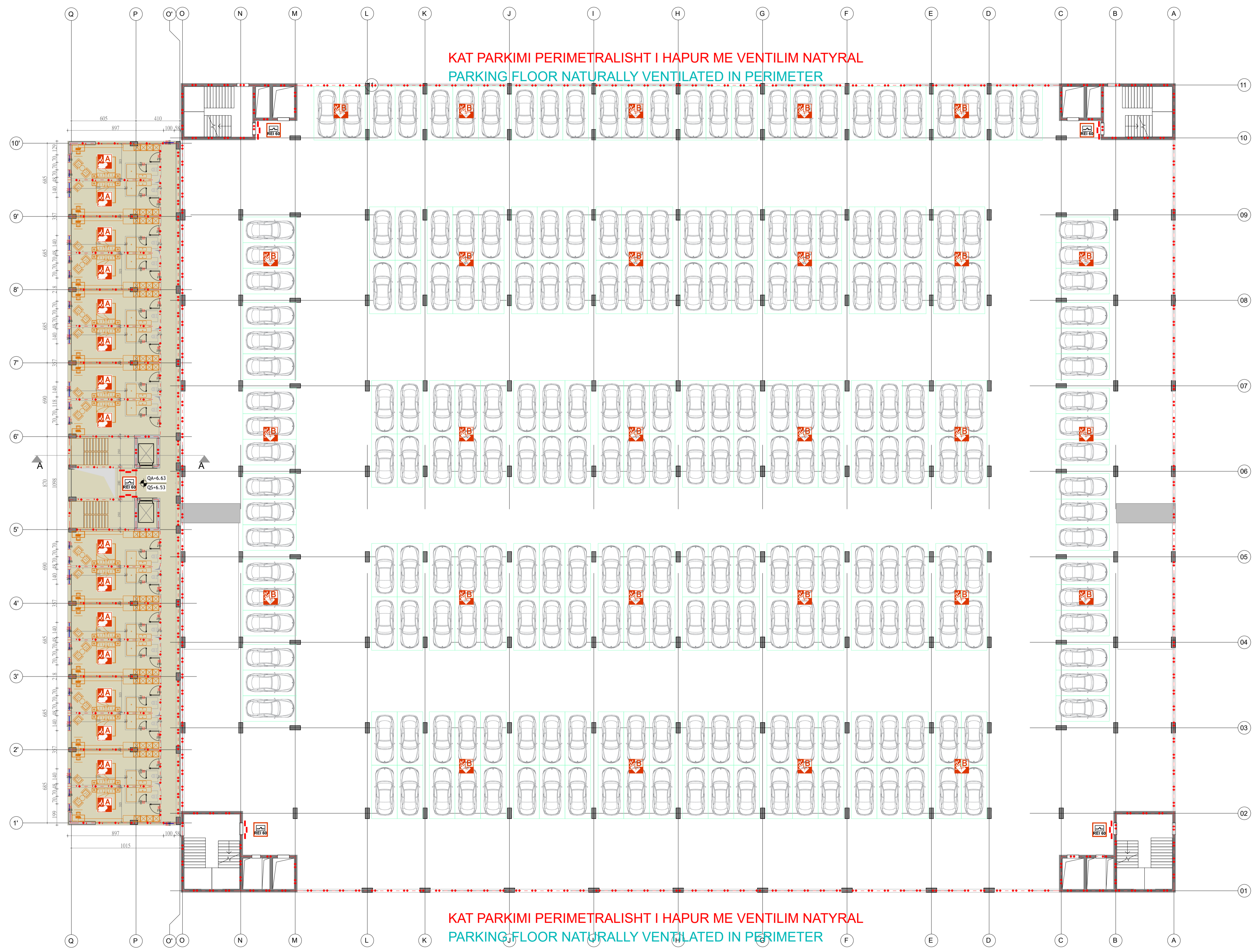

|  |   |  |   |
|--|---|--|---|
|  | DREJTIM EVAKUIMI<br>EVACUATION DIRECTION  |  | PIKE GRUMBULLIMI<br>ASSEMBLY POINT  |
|  | DREJTIM DALJE EMERJENCE<br>EMERGENCY OUTLET DIRECTION   |  | DREJTIM ZBRITJE / EMERJENCE<br>DIRECTION FOR DESCENDING / ASCENDING EMERGENCY STAIRS                                  |
|  | FIKESË ZJARRI ME UJË DN45<br>WATER FIRE EXTINGUISHER DN45   |  | FIKESË ZJARRI ME PULHUR<br>DRY POWDER FIRE EXTINGUISHER   |
|  | KLASA A DERRASE LETËR, PLASTIKE, TEKSTILE<br>CLASS A WOOD, PAPER, PLASTIC, TEXTILE                      |  | KLASA B MATERIALE TE LËNGSHMË<br>CLASS B: FLAMMABLE LIQUID MATERIALS  |
|  | PULSANT I ALARHIT TE ZJARRIT<br>FIRE ALARM BUTTON   |  | DISTANCA DERI DALJEN ME TE AFERT<br>- 20 m -<br>DISTANCE TO THE NEAREST EXIT  |
|  | NDALOHEJT PERDORIMI I UJIT PER FIKJE TE ZJARRIT<br>IT IS PROHIBITED TO USE WATER TO EXTINGUISH THE FIRE |  | NDALOHEJT PERDORIMI I ASHENSORIT NE RAST ZJARRI<br>THE USE OF ELEVATORS IS PROHIBITED IN THE EVENT OF A FIRE          |
|  | REZIKU I TENSIONIT<br>DANGER FROM ELECTRICAL VOLTAGE  |  | KUJDES!<br>ATTENTION!   |
|  | DERE KUNDER ME QENDRUESHMERI KUNDER ZJARRIT<br>FIRE-RESISTANT DOOR                                      |  | STRUKTURA KONSERVATIVE ME QENDRUESHMERI 60/90/120 MIN<br>STRUCTURAL INTEGRITY WITH RESISTANCE (R-EI) 60/90/120 MINUTE |

JO PER ZBATIM  
NOT FOR CONSTRUCTION

|   |                                       |  |  |
|---|---------------------------------------|--|--|
| 00 Shator 2024  |                                       | Projekt Leje / Permitting Design   |  |
| RISH NR. NO.  | DATA                                  | QËLLIMI I DORËZIMIT<br>PURPOSE OF ISSUE  | SHËNIM / PERSHKRIM<br>REMARK / DESCRIPTION |
| INVESTITORI<br>CONTRACTING AUTHORITY  |                                       | <p>FONDI SHQIPTAR I ZHVILLIMIT</p>   |  |
| KONSULENTI INXHINIERIK<br>ENGINEERING CONSULTANT  |                                       | <p>ILLYRIAN CONSULTING ENGINEERS<br/>Address: "Sami Frasheri", Pallati "Bora", Kat. II, Tirane, SHQIPËRI<br/>Tel: +355 4 200 772, Email: info@ice.al</p> |  |
| Përgatit / Prepared by:   |                                       | Firma/Signature  |  |
| Arktekt / Architect   | Bledi Saraci                          | A.2173   |  |
| Ing. Strukturalist / Structural Eng.  | Anila SPAHIU                          | K.1068/4   |  |
| Ing. Strukturalist / Structural Eng.  | Aida VOKA                             | K.1340/2   |  |
| Ing. Hidroteknik / Hydraulic Eng.   | Artjola ZOTAJ                         |  |  |
| Ing. Hidroteknik / Hydraulic Eng.   | Silvia GJONAJ                         |  |  |
| Ing. Hidroteknik / Hydraulic Eng.   | Anxhela BICI                          |  |  |
| Ing. Elektrik / Electrical Eng.   | Enis HAVERIKU                         | E.1450   |  |
| Ing. Elektrik / Electrical Eng.   | Ibër PUCI                             |  |  |
| Ing. Mekanik / Mechanical Eng.  | Marsel PYLLA                          | M.1288/1   |  |
| Kontrollor / Checked by:  | Ing. Mekanik / Mechanical Eng.        | Besnik KARAJ   | M.0256/2                                   |
| Koordinator Projekti<br>Project Coordinator   | Abdurrahman SPAHIU                    | K.1571/5   |  |
| Ing. Strukturalist / Structural Eng.  | Taulant KARRIQI                       | K.1547/6   |  |
| Ing. Elektrik / Electrical Eng.   | Ermira BERISHA                        | E.0550/4   |  |
| Miratohet / Approved by:  | Drejtesha Projekti<br>Project Manager | Olset HAXHIU   | K.1619/5                                   |
| TITULLI I PROJEKTTIT<br>PROJECT TITLE   |                                       |  |  |
| <p>NDËRTIMI I GODINËS SË PARKIMIT MULTIFUNKSIONAL ME SHUMË NIVELE NË QENDRËN SPITALORE UNIVERSITARE "NËNË TEREZA" TIRANË (QSUT)<br/>CONSTRUCTION OF THE MULTI-LEVEL MULTI-FUNCTIONAL PARKING BUILDING AT THE UNIVERSITY HOSPITAL CENTER "MOTHER TERESA" TIRANA (QSUT)</p> |                                       |  |  |
| EMRI I DOKUMENTIT<br>DOCUMENT TITLE   |                                       |  |  |
| <p>PLANI I PLANI I MBROJTJES PASIVE<br/>PLAN I KATIT +2</p>   |                                       |  |  |
| FAZA E PROJEKTTIT<br>PROJECT PHASE  | Nr. i Dokumentit<br>Document No.      | Shkalla<br>Scale   | Rishikimi<br>Review                        |
| PROJEKT LEJE / PERMITTING DESIGN  |                                       | 1:200  | 00   |
|   | Përmasa e fletës<br>Page Size         | Fleta<br>Page No.  |  |
|   | A1<br>(841x594mm)                     | M.3.4  |  |