



**BENJA
DESTINACION
NDERKOMBETAR
TURISTIK**

PLANIMETRIA E FIBRES OPTIKE

BENJA DESTINACION NDERKOMBETAR TURISTIK

Shënim

Projektoi

Arktekt	E. BEJLERI
Arktekt	I. BEJLERI
Arktekt	K. DEMAJ
Arktekt	A. SPAHIU
Konstruktore	S. COLLAKU
Ing. Elektrik	V. HOXHA
Ing. Hidroteknik	E. CANO
Ing. Mekanik	D. BUZI



SHKALLA

F 00



**FONDI SHQIPTAR
I ZHVILLIMIT**



SON

PLANIMETRIA E FIBRES OPTIKE

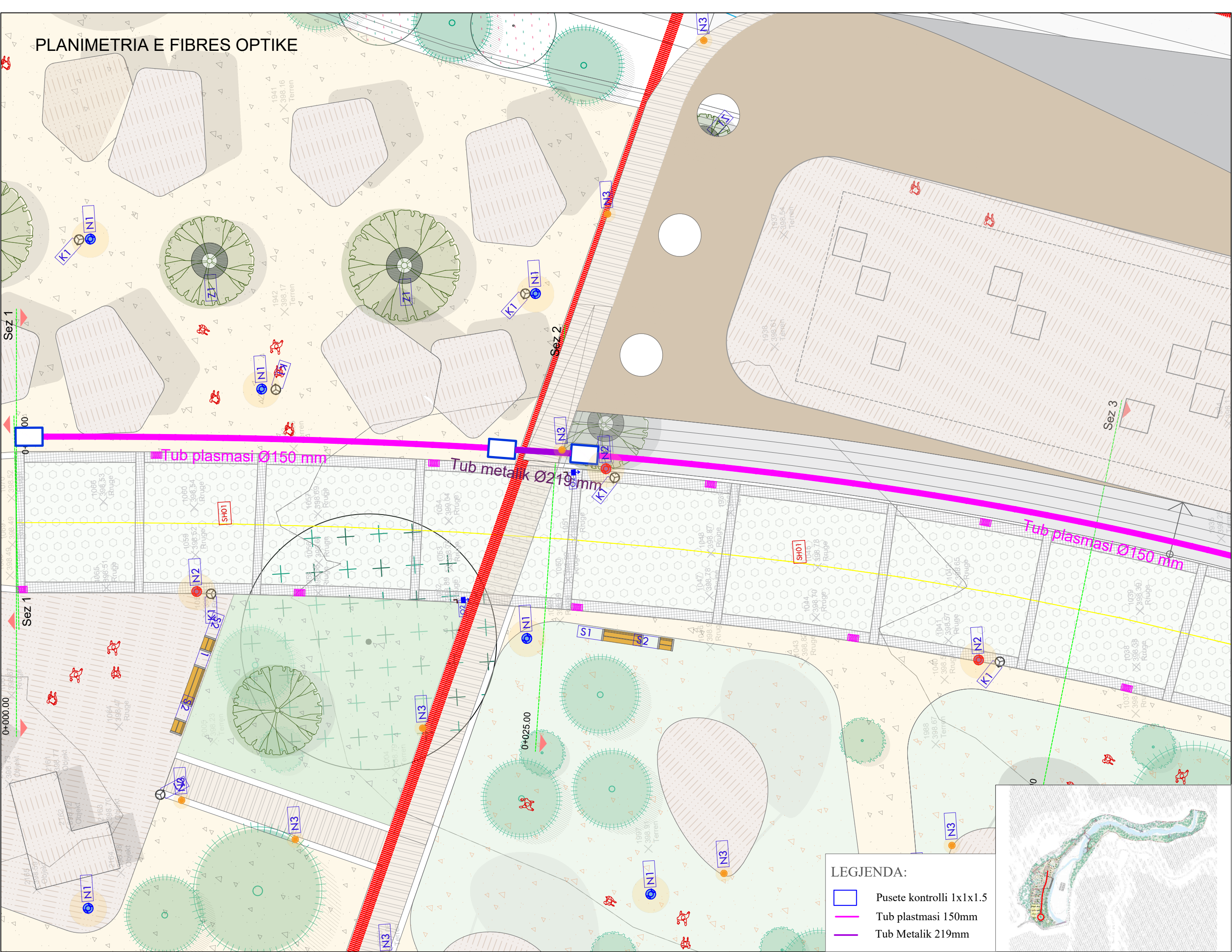

LEGJENDA:

- Pusete kontrolli 1x1x1.5
- Tub plastmasi 150mm
- Tub Metalik 219mm

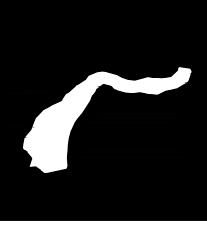
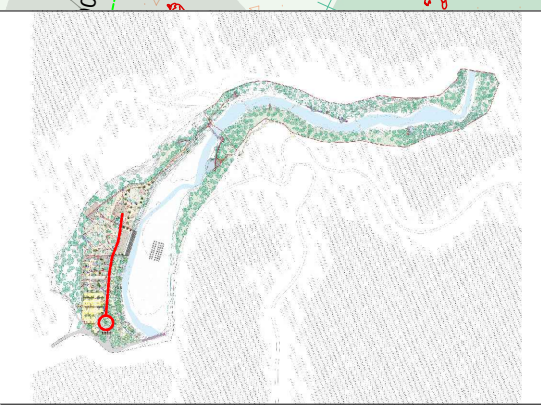

**BENJA
DESTINACION
NDERKOMBETAR
TURISTIK**

Shënim

Projektori	E. BEJLERI
Arkiteksi	I. BEJLERI
Arkiteksi	K. DEMAJ
Arkiteksi	A. SPAHIU
Konstruktori	S. COLLAKU
Ing. Elektrik	V. HOXHA
Ing. Hidroteknik	E. CANO
Ing. Mekanik	D. BUZI

SHKALLA 1 : 150	F 01
--------------------	-------------

**FONDI SHQIPTAR
I ZHVILLIMIT**

A&E ENGINEERING

SON

PLANIMETRIA E FIBRES OPTIKE

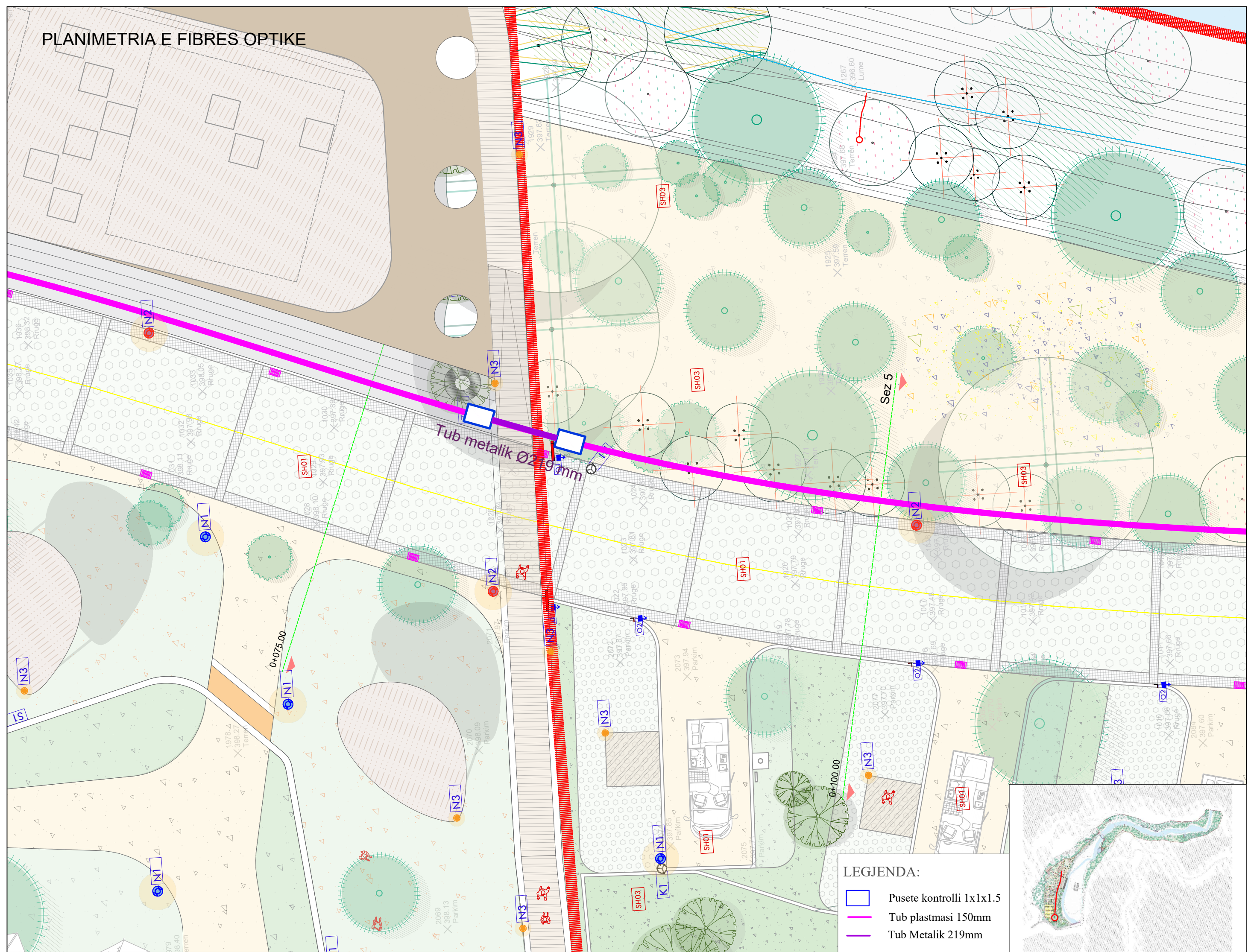

LEGJENDA:

- Pusete kontrolli 1x1x1.5
- Tub plastmasi 150mm
- Tub Metalik 219mm

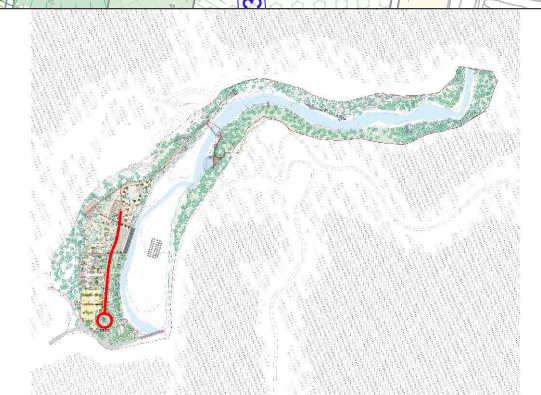

BJNA
DESTINACION
NDERKOMBETAR
TURISTIK

Projektori	E. BEJLERI
Arktekt	I. BEJLERI
Arktekt	K. DEMAJ
Arktekt	A. SPAHIU
Konstruktor	S. COLLAKU
Ing. Elektrik	V. HOXHA
Ing. Hidroteknik	E. CANO
Ing. Mekanik	D. BUZI

SHKALLA
1 : 150

F 02



PLANIMETRIA E FIBRES OPTIKE

BENJA
DESTINACION
NDERKOMBETAR
TURISTIK

Shkëmb

Projektet	E. BEJLERI
Arktekt	I. BEJLERI
Arktekt	K. DEMAJ
Arktekt	A. SPAHIU
Konstruktor	S. COLLAKU
Ing. Elektrik	V. HOXHA
Ing. Hidroteknik	E. CANO
Ing. Mekanik	D. BUZI

F 03
SHKALLA
1 : 150

**FONDI SHQIPTAR
I ZHVILLIMIT**

**A&E ENGINEERING
SON**

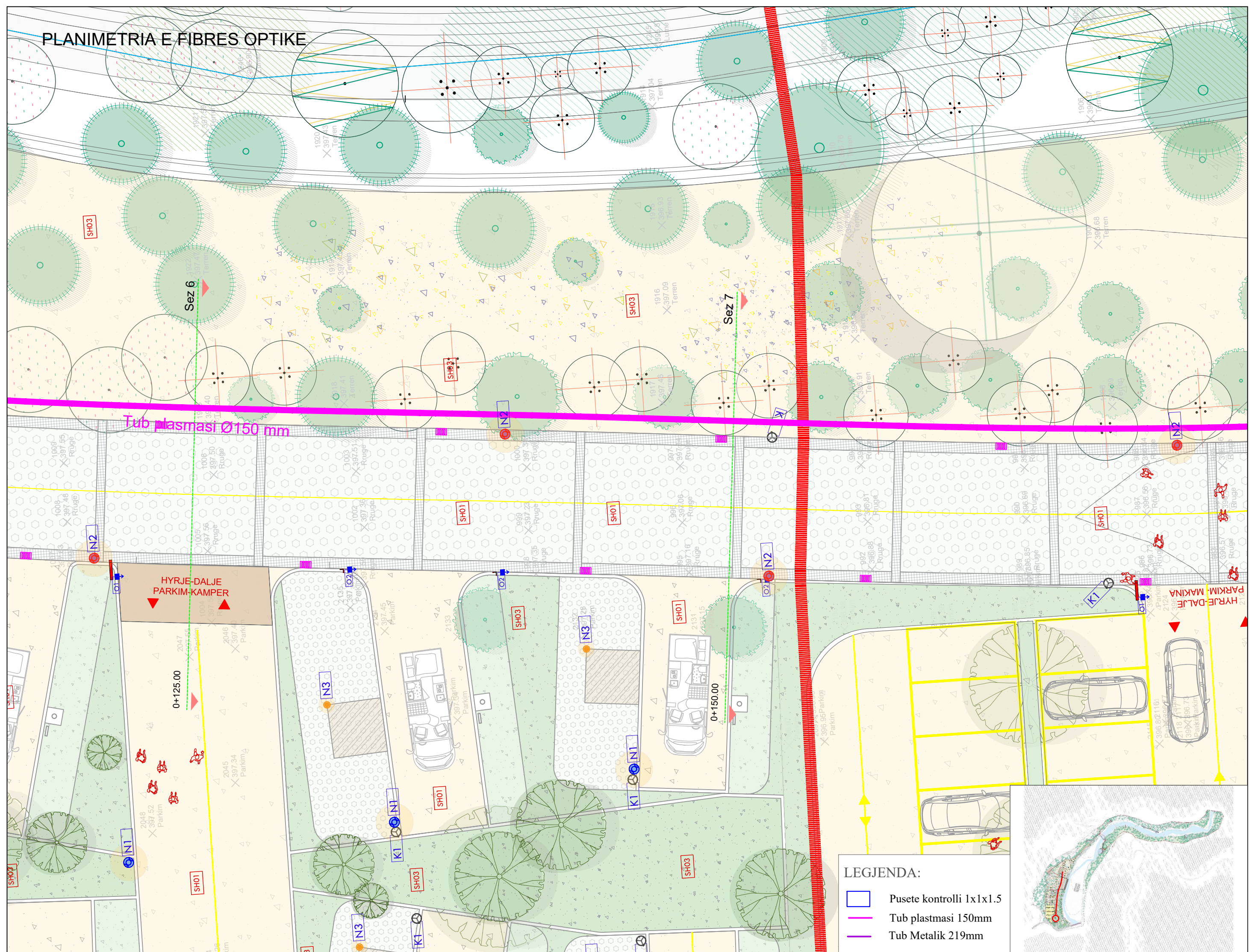

LEGJENDA:

- Pusete kontrolli 1x1x1.5
- Tub plastmasi 150mm
- Tub Metalik 219mm



PLANIMETRIA E FIBRES OPTIKE

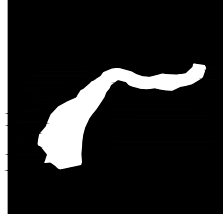

BENJA
DESTINACION
NDERKOMBETAR
TURISTIK

Shkëmbim

Projektor	E. BEJLERI
Arkitekt	I. BEJLERI
Arkitekt	K. DEMAJ
Arkitekt	A. SPAHIU
Konstruktor	S. COLLAKU
Ing. Elektrik	V. HOXHA
Ing. Hidroteknik	E. CANO
Ing. Mekanik	D. BUZI

SHKALLA	F 04
1 : 150	

FONDI SHQIPTAR I ZHVILLIMIT

A&E ENGINEERING

SON

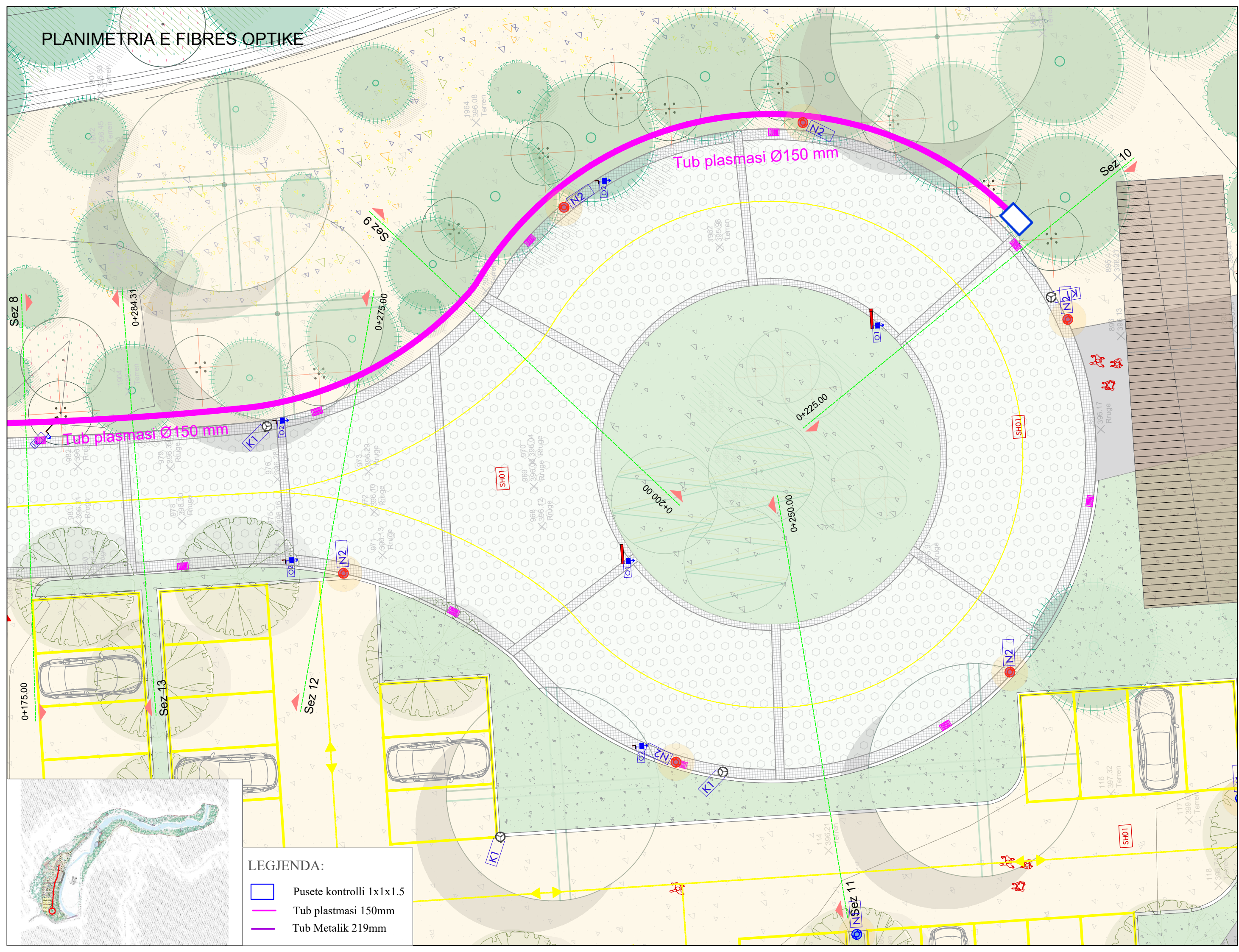

LEGJENDA:

- Pusete kontrolli 1x1x1.5
- Tub plastmasi 150mm
- Tub Metalik 219mm

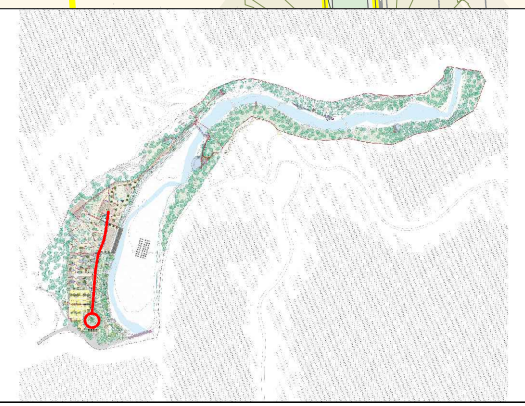



**BENJA
DESTINACION
NDERKOMBETAR
TURISTIK**

PLANIMETRIA E FIBRES OPTIKE

BENJA DESTINACION NDERKOMBETAR TURISTIK

Shënim

Projektoi

Arktekt	E. BEJLERI
Arktekt	I. BEJLERI
Arktekt	K. DEMAJ
Arktekt	A. SPAHIU
Konstraktor	S. COLLAKU
Ing. Elektrik	V. HOXHA
Ing. Hidroteknik	E. CANO
Ing. Mekanik	D. BUZI



SHKALLA

F 00



**FONDI SHQIPTAR
I ZHVILLIMIT**



SON

PLANIMETRIA E FIBRES OPTIKE

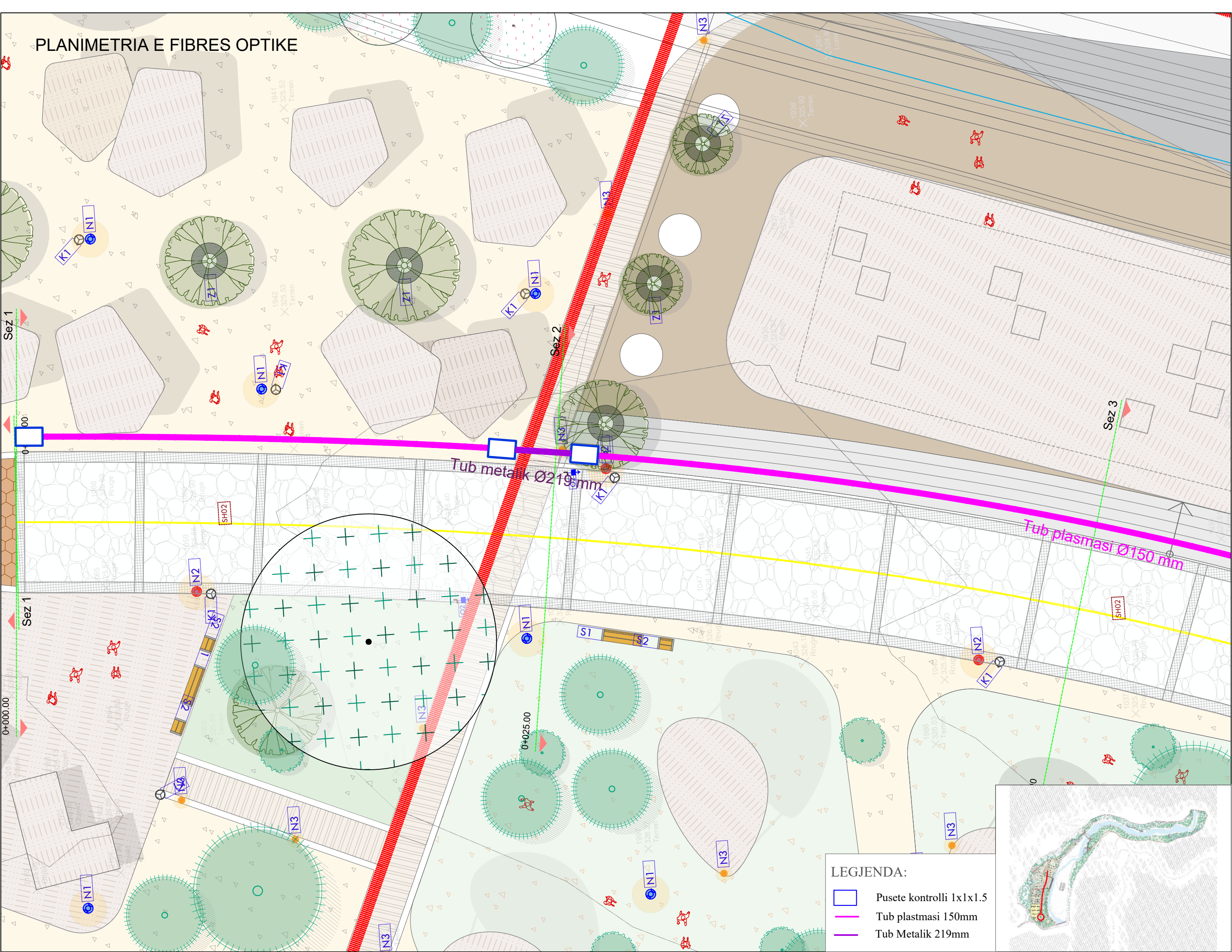

LEGJENDA:

- Pusete kontrolli 1x1x1.5
- Tub plastmasi 150mm
- Tub Metalik 219mm

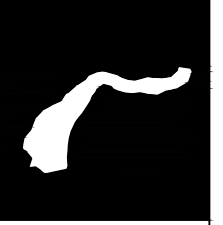
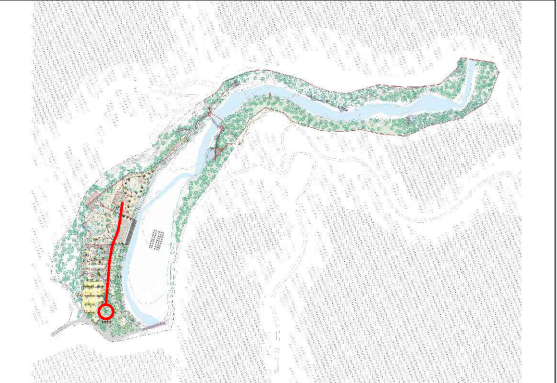

**BENJA
DESTINACION
NDERKOMBETAR
TURISTIK**

Shënime	
Projektori	E. BEJLERI
Arkiteksi	I. BEJLERI
Arkiteksi	K. DEMAJ
Arkiteksi	A. SPAHIU
Konstruktori	S. COLLAKU
Ing. Elektrik	V. HOXHA
Ing. Hidroteknik	E. CANO
Ing. Mekanik	D. BUZI

Projektori	E. BEJLERI
Arkiteksi	I. BEJLERI
Arkiteksi	K. DEMAJ
Arkiteksi	A. SPAHIU
Konstruktori	S. COLLAKU
Ing. Elektrik	V. HOXHA
Ing. Hidroteknik	E. CANO
Ing. Mekanik	D. BUZI

SHKALLA
1 : 150

F 01

**FONDI SHQIPTAR
I ZHVILLIMIT**

**A&E
ENGINEERING**

SON

PLANIMETRIA E FIBRES OPTIKE

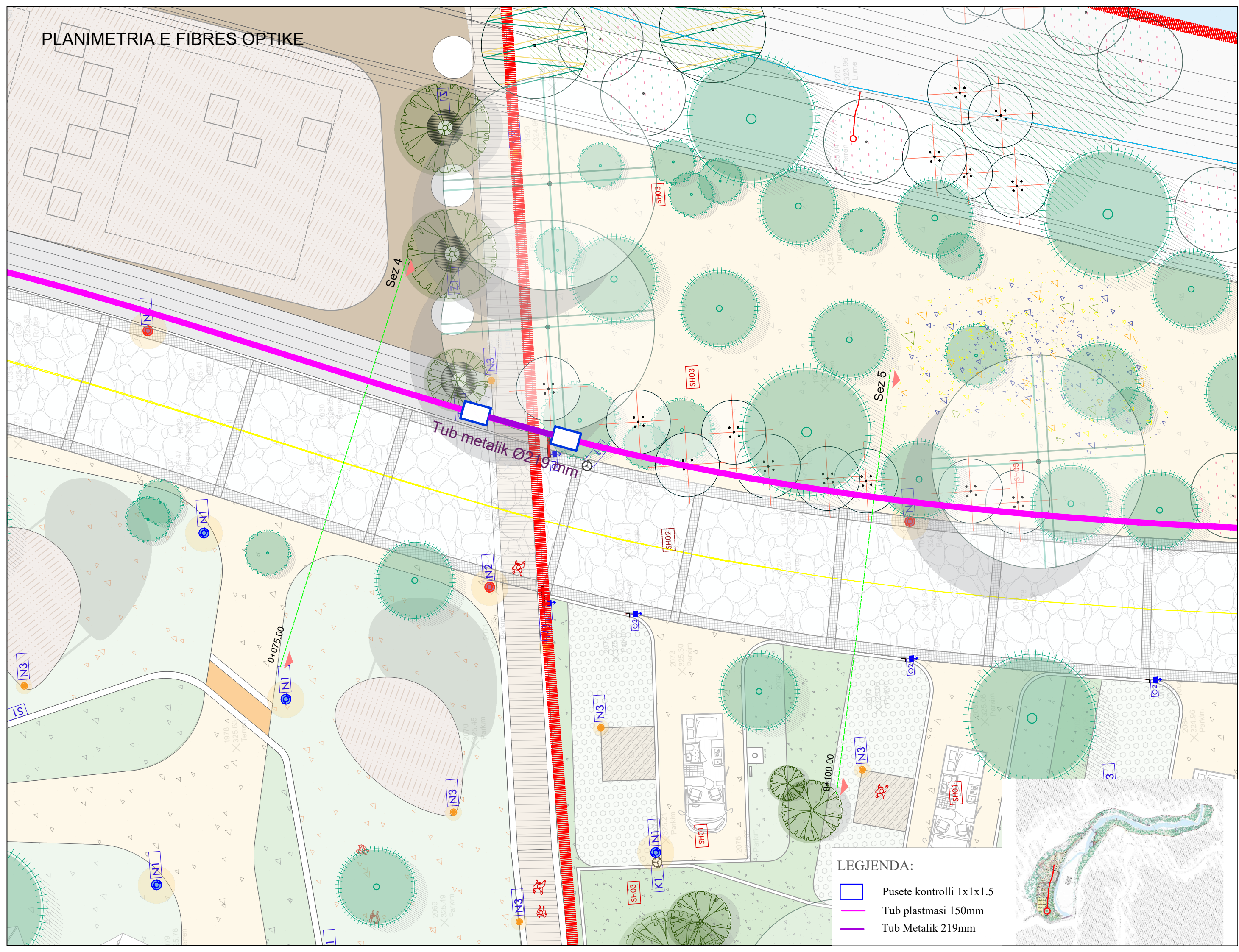

LEGJENDA:

	Pusete kontrolli 1x1x1.5
	Tub plastmasi 150mm
	Tub Metalik 219mm

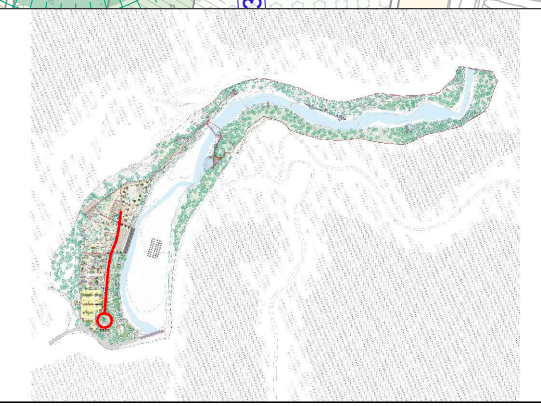

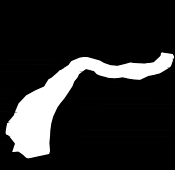



BENJA
DESTINACION
NDERKOMBETAR
TURISTIK

Shkëlqim

Projektor	E. BEJLERI
Arkitekt	I. BEJLERI
Arkitekt	K. DEMAJ
Arkitekt	A. SPAHIU
Konstruktor	S. COLLAKU
Ing. Elektrik	V. HOXHA
Ing. Hidroteknik	E. CANO
Ing. Mekanik	D. BUZI

 SHKALLA 1 : 150	F 02
---	------



**FONDI SHQIPTAR
I ZHVILLIMIT**



SON

PLANIMETRIA E FIBRES OPTIKE

BENJA
DESTINACION
NDERKOMBETAR
TURISTIK

Shkëmb

Projektor	E. BEJLERI
Arktekt	I. BEJLERI
Arktekt	K. DEMAJ
Arktekt	A. SPAHIU
Konstruktor	S. COLLAKU
Ing. Elektrik	V. HOXHA
Ing. Hidroteknik	E. CANO
Ing. Mekanik	D. BUZI

F 03
SHKALLA
1 : 150

**FONDI SHQIPTAR
I ZHVILLIMIT**

**A&E
ENGINEERING
SON**

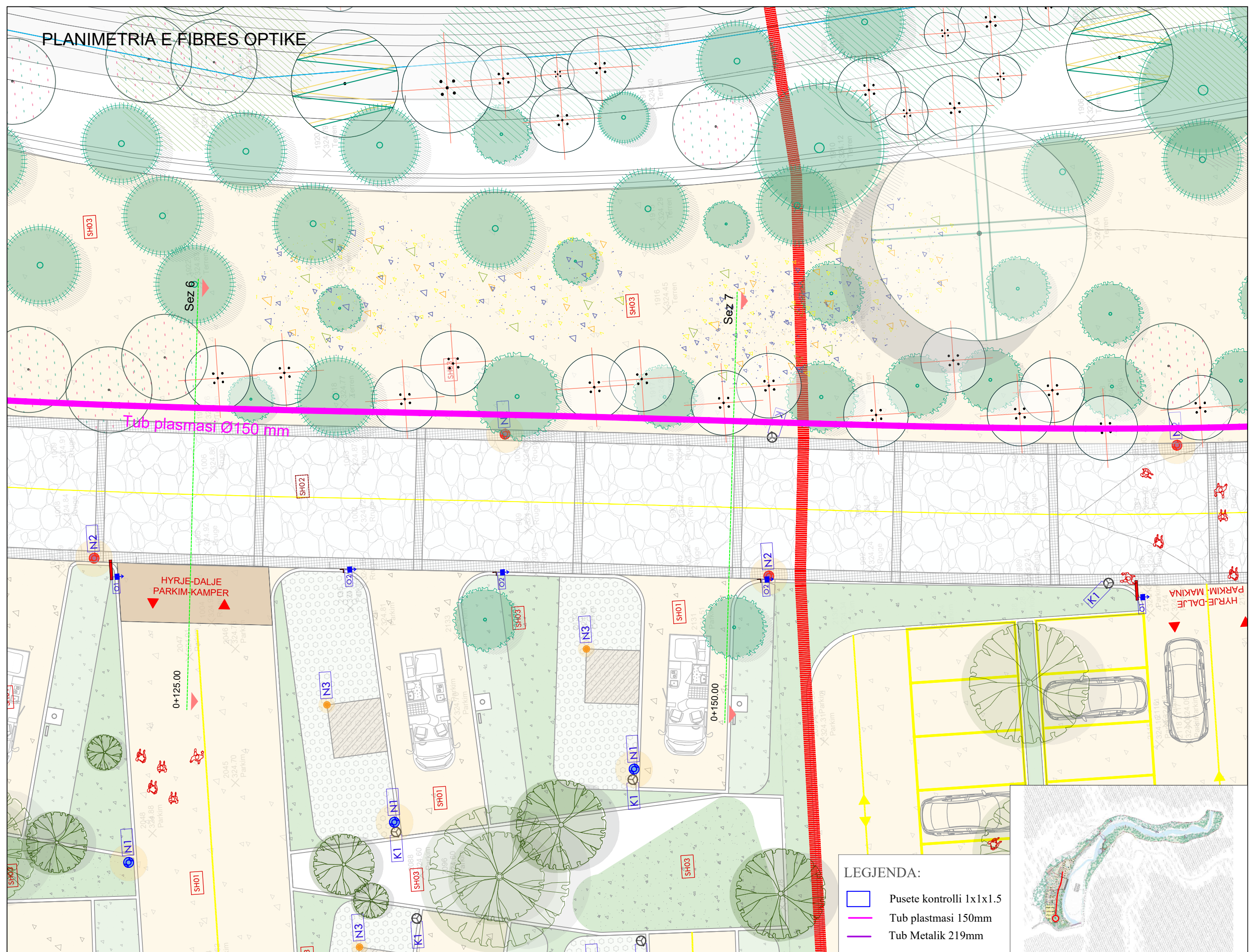

- LEGJENDA:**
- Pusete kontrolli 1x1x1.5
 - Tub plastmasi 150mm
 - Tub Metalik 219mm

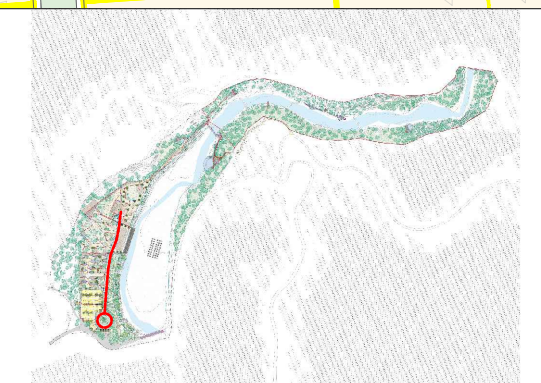

PLANIMETRIA E FIBRES OPTIKE

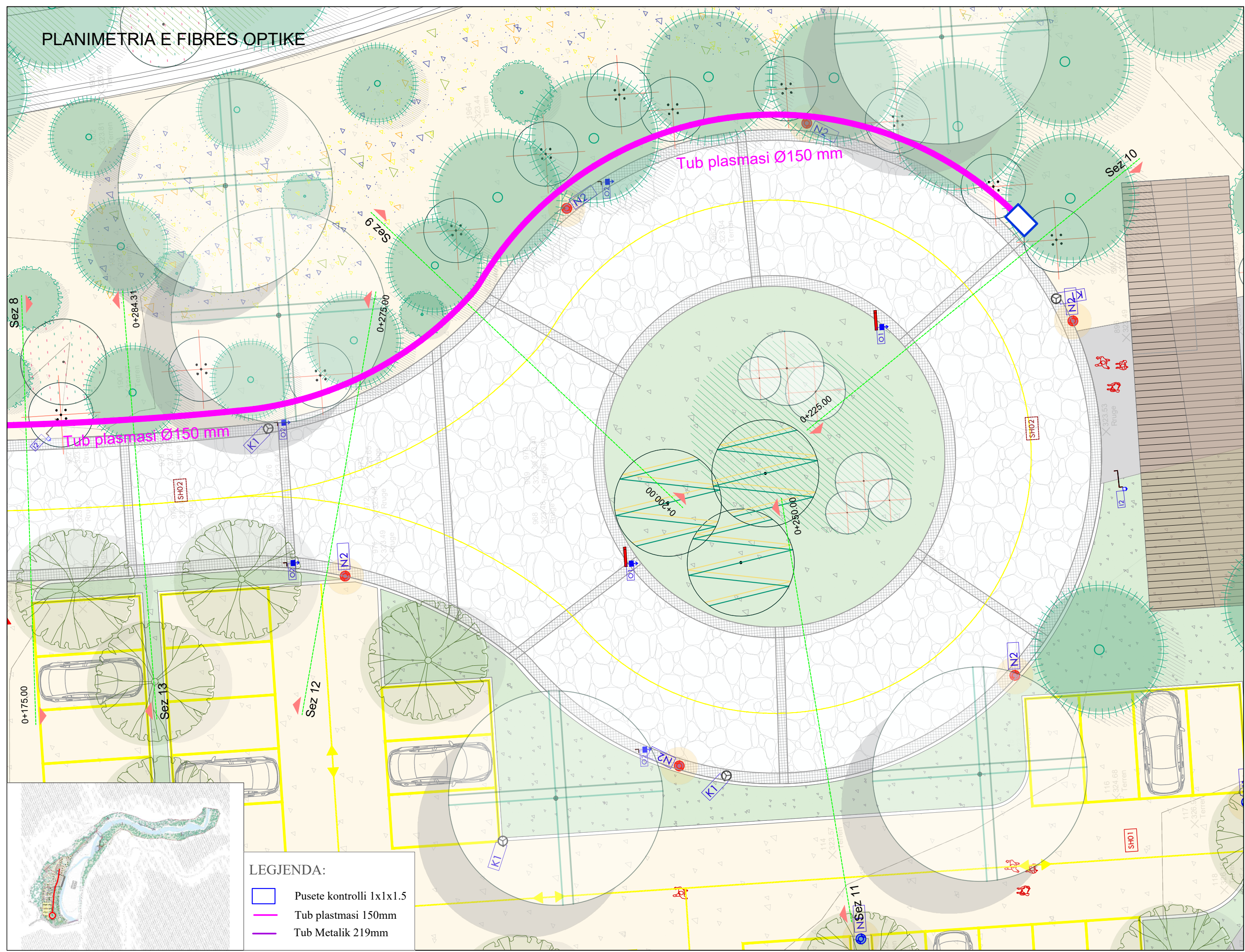



Shkeme

Projektori	
Arktekt	E. BEJLERI
Arktekt	I. BEJLERI
Arktekt	K. DEMAJ
Arktekt	A. SPAHIU
Konstruktor	S. COLLAKU
Ing. Elektrik	V. HOXHA
Ing. Hidroteknik	E. CANO
Ing. Mekanik	D. BUZI

SHKALLA	F 04
1 : 150	

LEGJENDA:

	Pusete kontrolli 1x1x1.5
	Tub plastmasi 150mm
	Tub Metalik 219mm

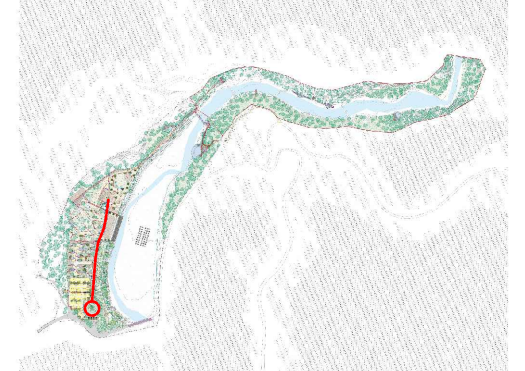



**BENJA
DESTINACION
NDERKOMBETAR
TURISTIK**

SEKSION TIP I FIBRES OPTIKE

BENJA DESTINACION NDERKOMBETAR TURISTIK

Shkëmbim

Projektoi

Arktekt	E. BEJLERI
Arktekt	I. BEJLERI
Arktekt	K. DEMAJ
Arktekt	A. SPAHIU
Konstruktore	S. COLLAKU
Ing. Elektrik	V. HOXHA
Ing. Hidroteknik	E. CANO
Ing. Mekanik	D. BUZI



SHKALLA

F 00



**FONDI SHQIPTAR
I ZHVILLIMIT**



SON

SEKSION TIP I FIBRES OPTIKE

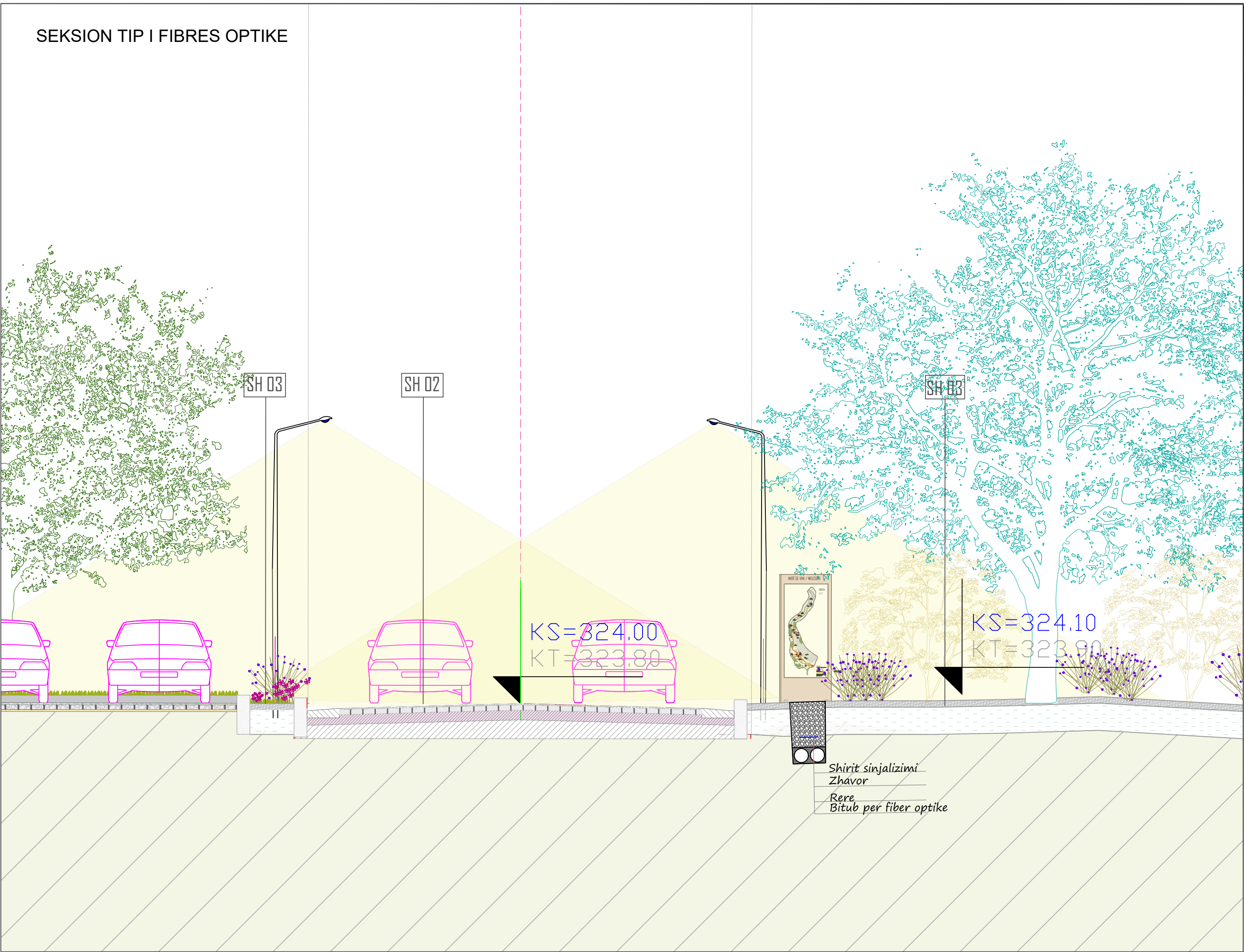

BENJA
DESTINACION
NDERKOMBETAR
TURISTIK

Shënime

Projektor	E. BEJLERI
Arkitekt	I. BEJLERI
Arkitekt	K. DEMAJ
Arkitekt	A. SPAHIU
Konstruktore	S. COLLAKU
Ing. Elektrik	V. HOXHA
Ing. Hidroteknik	E. CANO
Ing. Mekanik	D. BUZI

SHKALLA
 1 : 50

F 01





BENJA
DESTINACION
NDERKOMBETAR
TURISTIK

DETAJE ELEKTRIKE DHE FIBRA OPTIKE

BENJA DESTINACION NDERKOMBETAR TURISTIK

Shënime

Projektoi

Arkitekt	E. BEJLERI
Arkitekt	I. BEJLERI
Arkitekt	K. DEMAJ
Arkitekt	A. HALILAJ
Konstruktor	S. COLLAKU
Ing. Elektrik	V. HOXHA
Ing. Hidroteknik	E. CANO
Ing. Mekanik	D. BUZI



SHKALLA

E 00



FONDI SHQIPTAR
I ZHVILLIMIT



SON

DETAJE ELEKTRIKE



BENJA
DESTINACION
NDERKOMBETAR
TURISTIK

Shënime

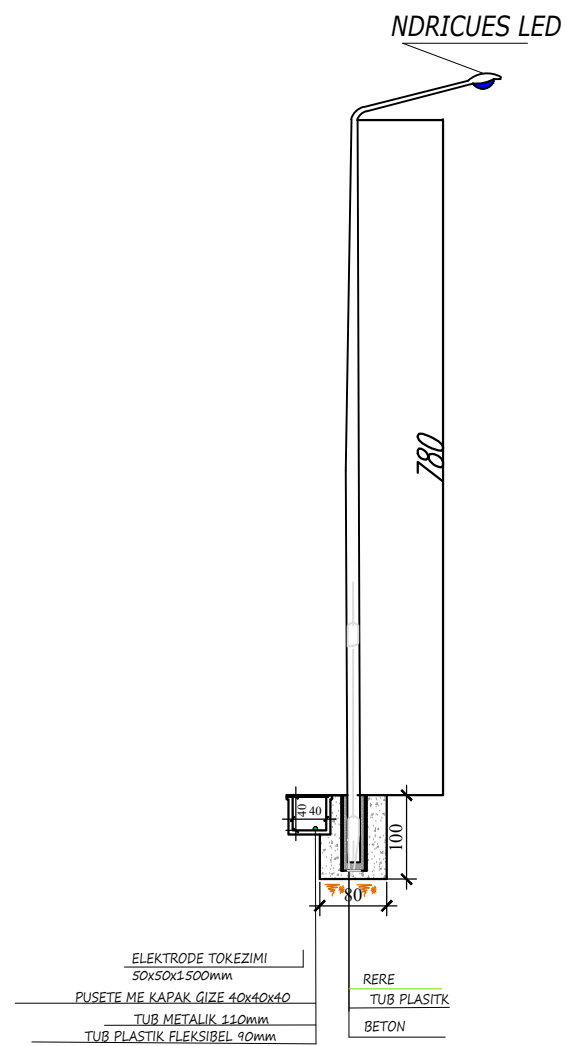

NDRICUES LED

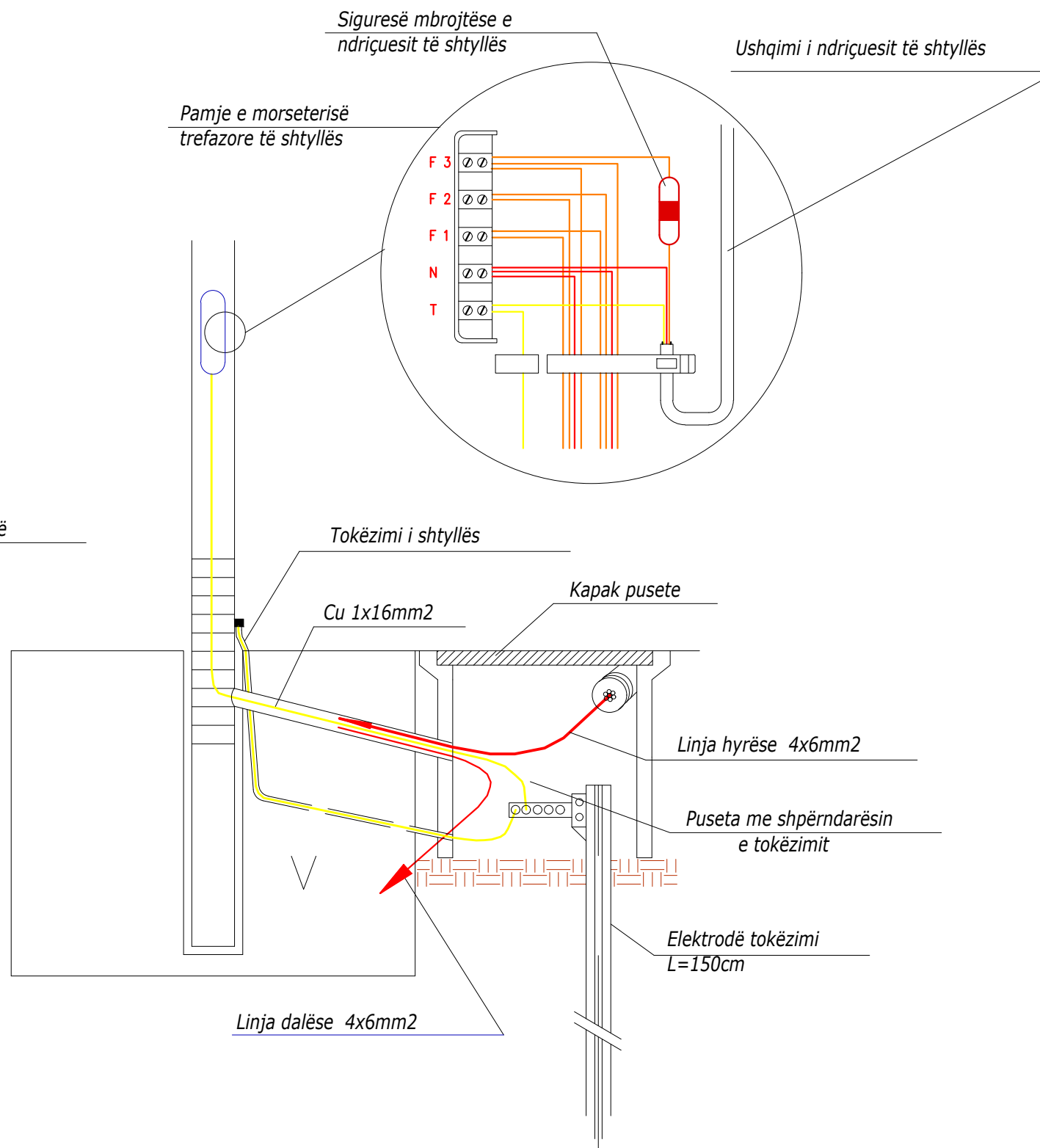
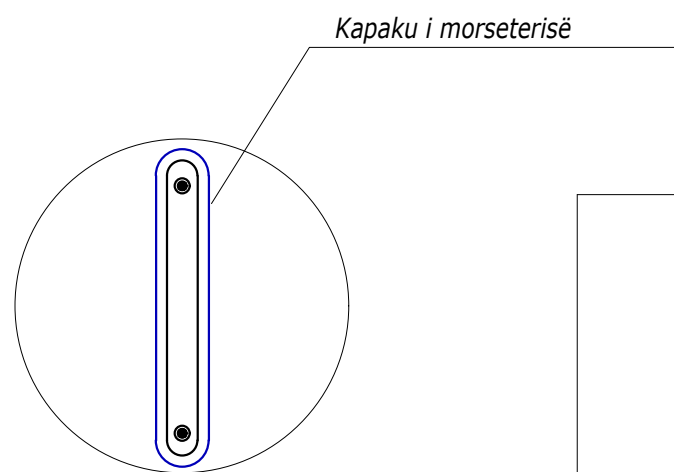

Projektol	E. BEJLERI
Arkitekt	I. BEJLERI
Arkitekt	K. DEMAJ
Arkitekt	A. HALILAJ
Konstruktore	S. COLLAKU
Ing. Elektrik	V. HOXHA
Ing. Hidroteknik	E. CANO
Ing. Mekanik	D. BUZI

SHKALLA	E 01
---------	------

DETAJE ELEKTRIKE

Detaj i tokëzimit të shtyllës së ndriçimit

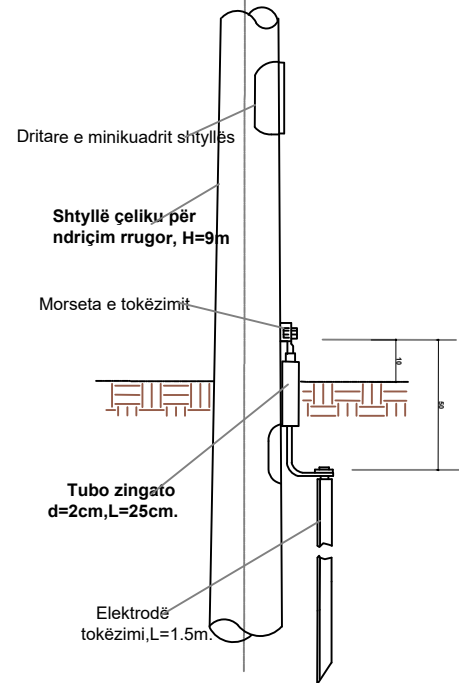

Konstruksioni morseterisë

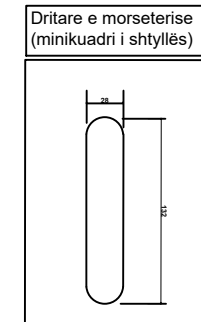
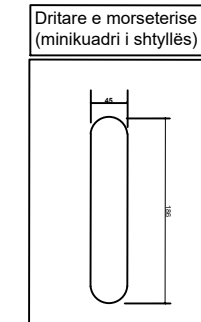
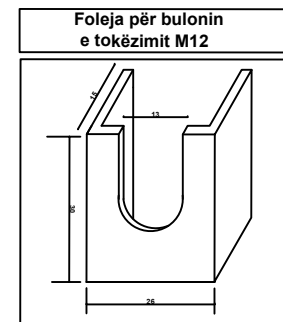
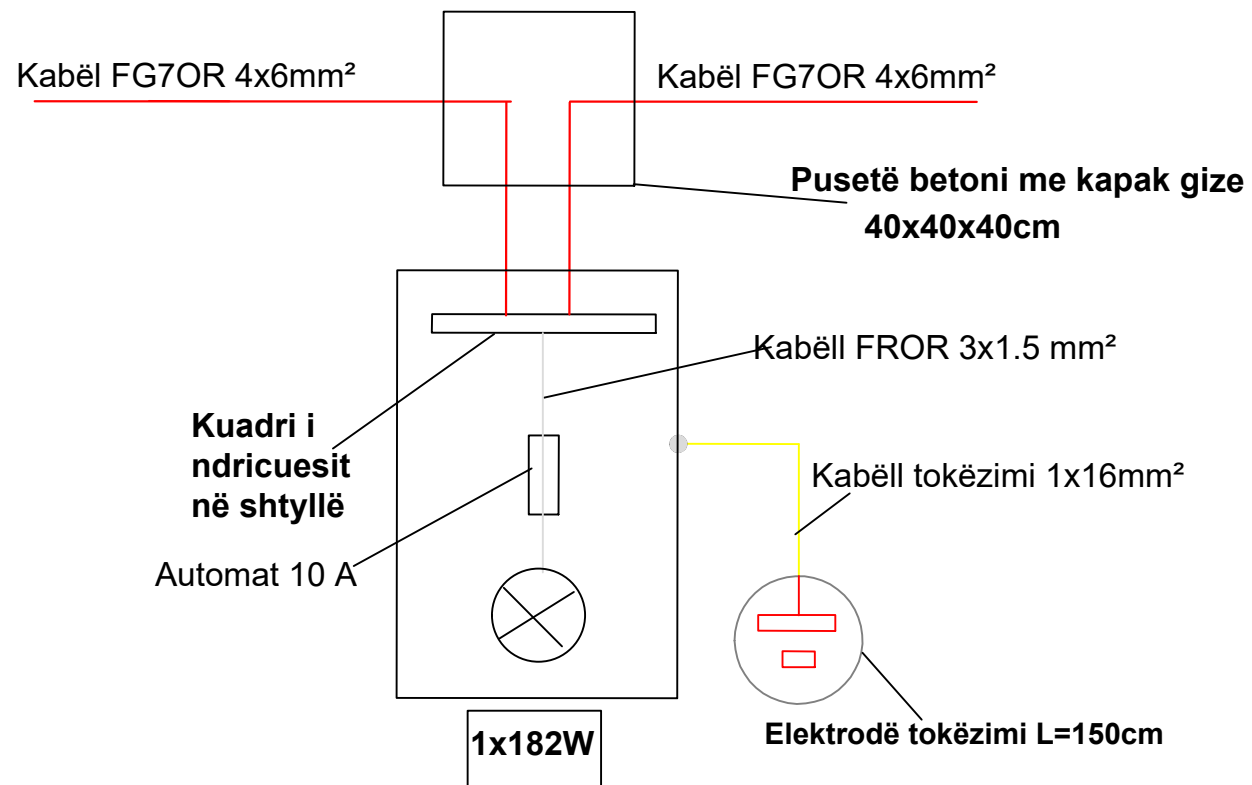
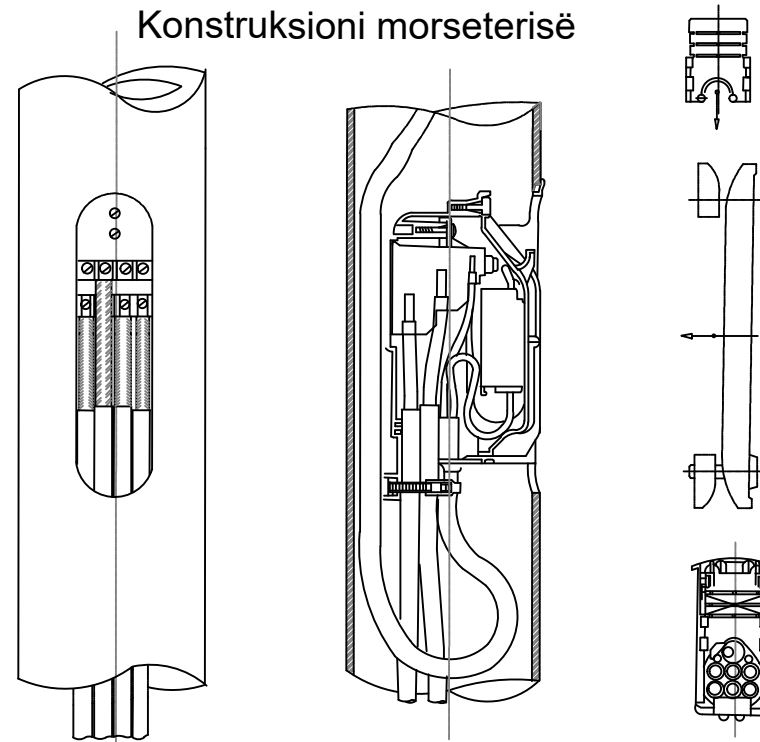

BENJA
DESTINACION
NDERKOMBETAR
TURISTIK

Shënime

Projektor	E. BEJLERI
Arkitekt	I. BEJLERI
Arkitekt	K. DEMAJ
Arkitekt	A. HALILAJ
Konstruktor	S. COLLAKU
Ing. Elektrik	V. HOXHA
Ing. Hidroteknik	E. CANO
Ing. Mekanik	D. BUZI

SHKALLA E 01



DETAJE ELEKTRIKE

Hollësi e inkastrimit të kolonës së ndriçuesit me lartësi H=7.8m

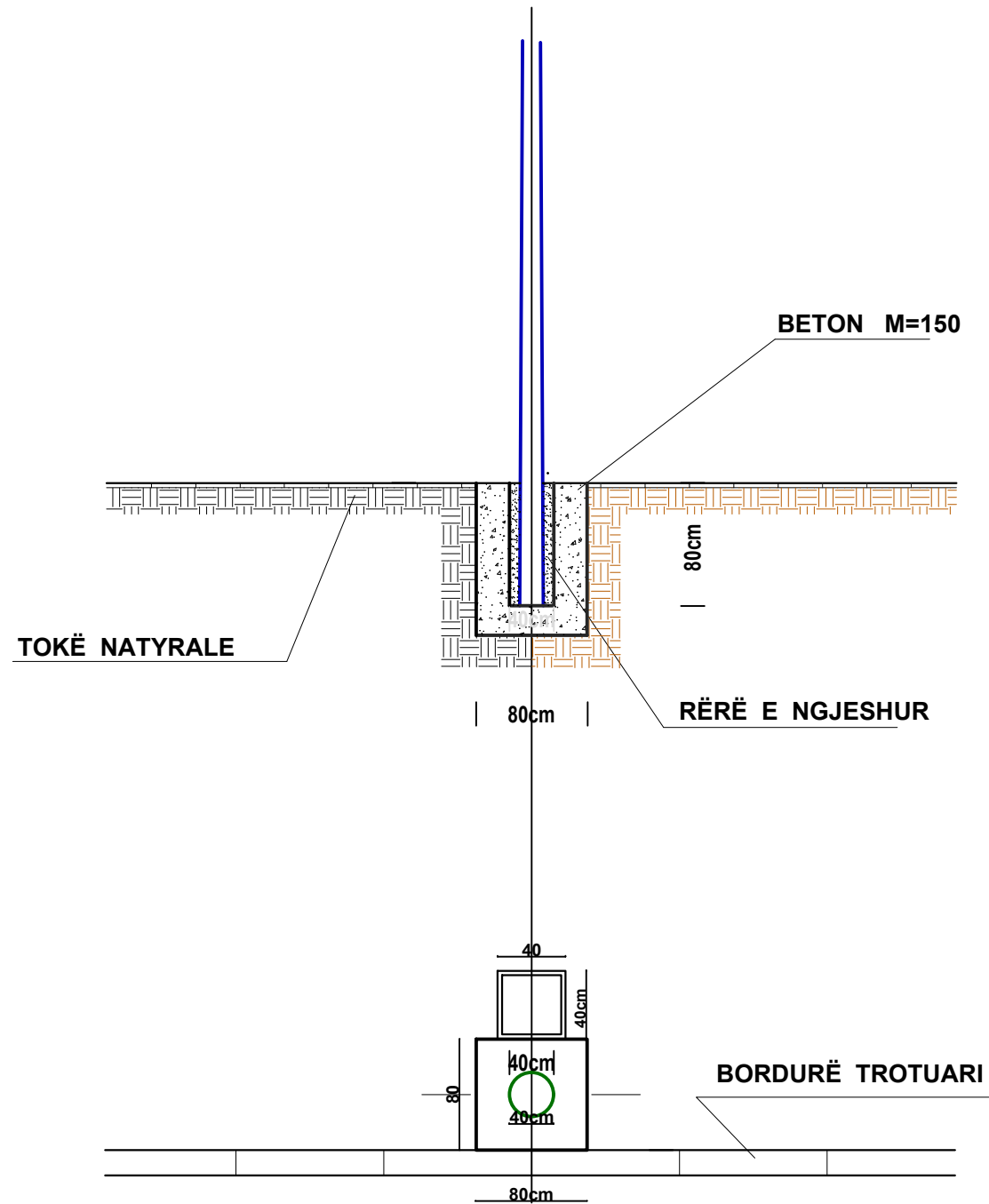

Hollësi e vendosjes së pusetës për Tub fleksibel 90mm

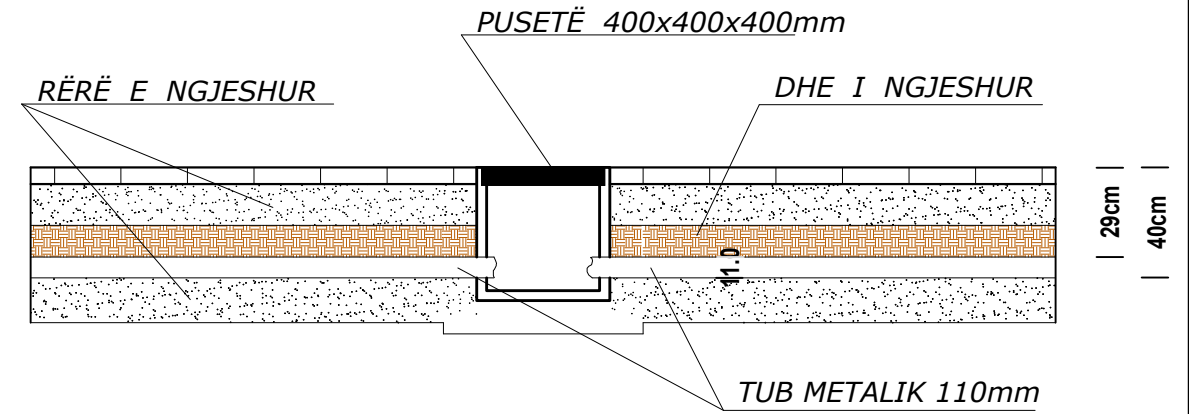

Hollësi e vendosjes së pusetës për Tub metalik 110mm

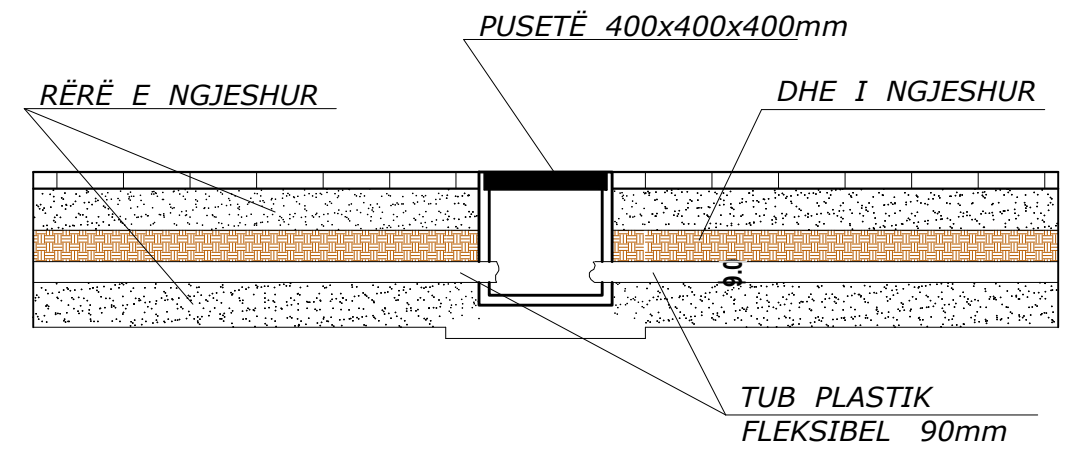

BENJA
DESTINACION
NDERKOMBËTAR
TURISTIK

Shënime

Projektor	E. BEJLERI
Arkitekt	I. BEJLERI
Arkitekt	K. DEMAJ
Arkitekt	A. HALILAJ
Konstruktor	S. COLLAKU
Ing. Elektrik	V. HOXHA
Ing. Hidroteknik	E. CANO
Ing. Mekanik	D. BUZI

SHKALLA E 01

DETAJE ELEKTRIKE

Planimetria e instalimit të rrjetit kabllor të ndriçimit,

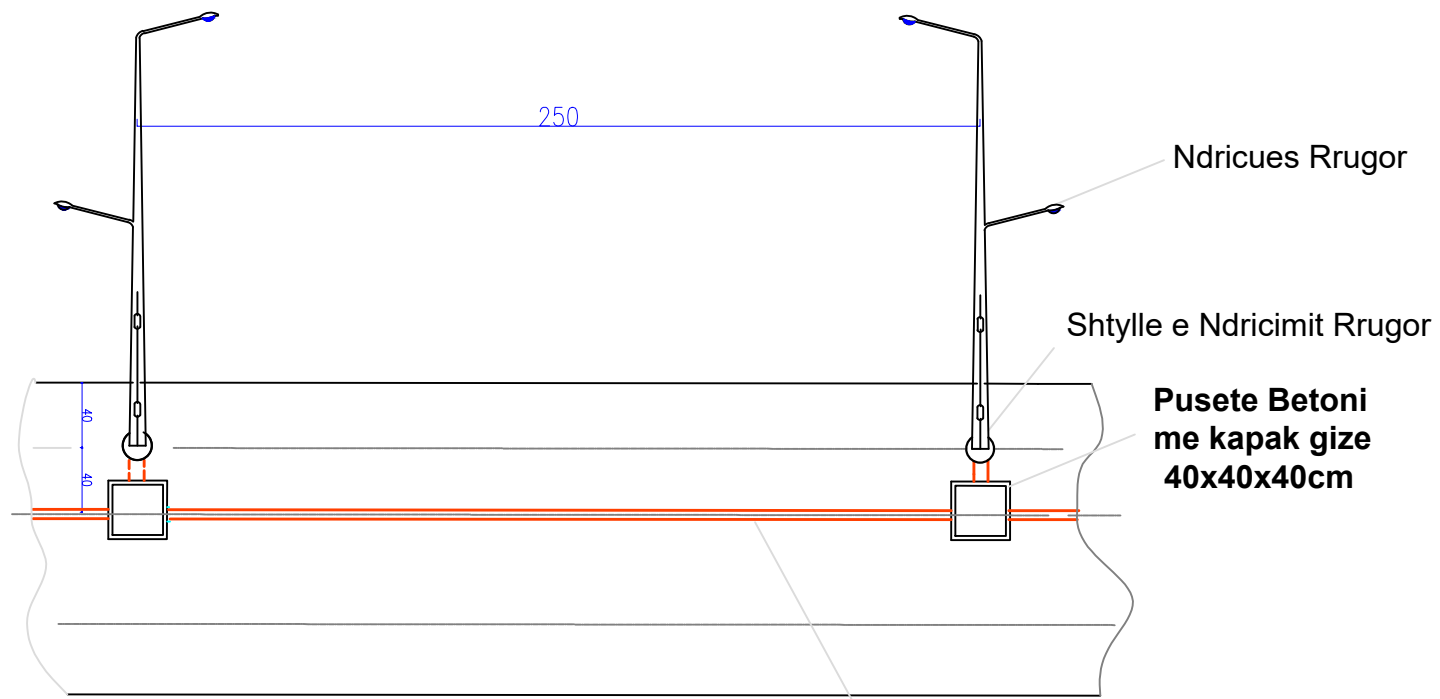

TuB Metalik d=110mm

Detaj i montimit te pusetes dhe tokezimit te shtylles

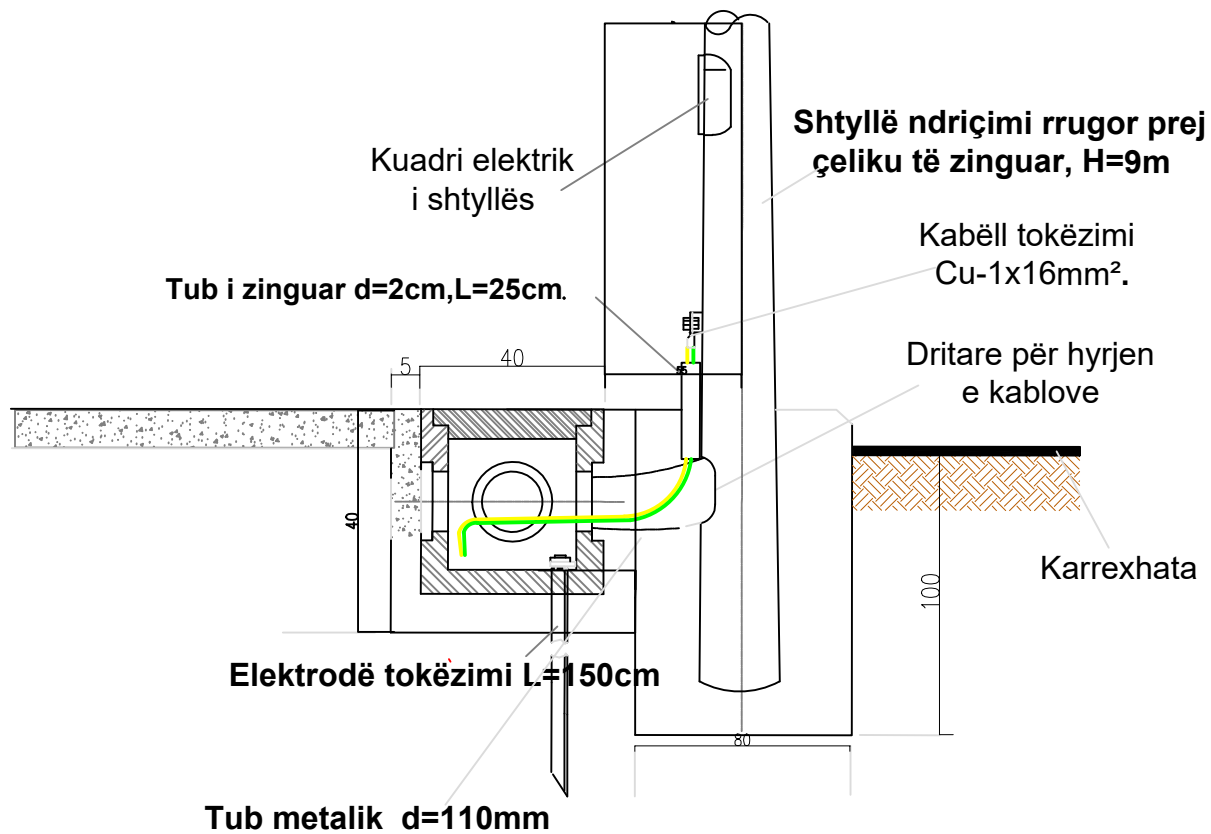

Shtrimi i kabllave te TU ne trasversimin e rrugeve

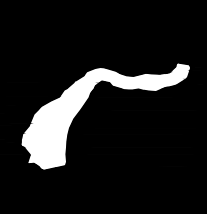
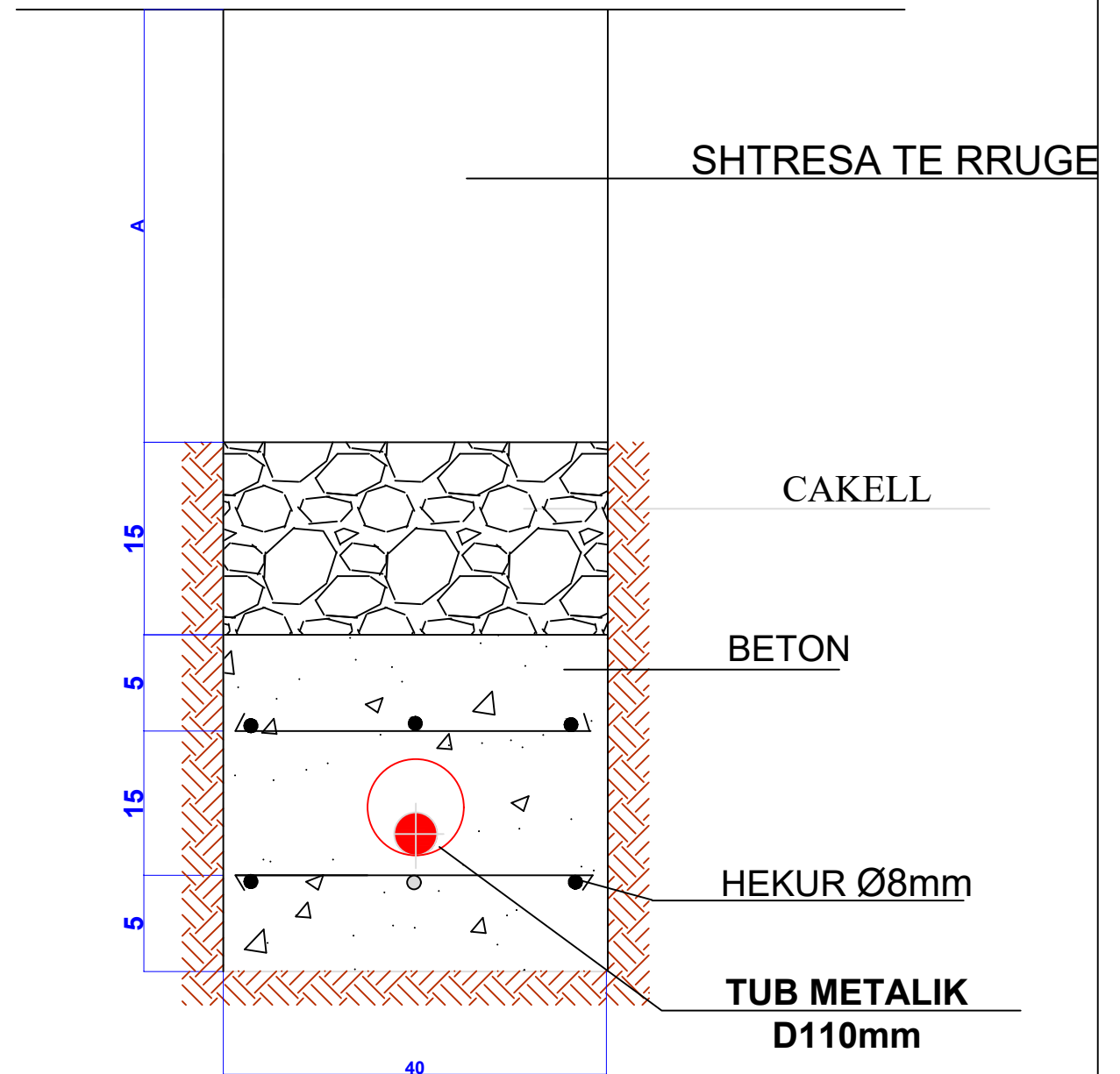

BENJA
DESTINACION
NDERKOMBETAR
TURISTIK

Shënime

Projektor	E. BEJLERI
Arkitekt	I. BEJLERI
Arkitekt	K. DEMAJ
Arkitekt	A. HALILAJ
Konstruktor	S. COLLAKU
Ing. Elektrik	V. HOXHA
Ing. Hidroteknik	E. CANO
Ing. Mekanik	D. BUZI
SHKALLA	E 04



DETAJE ELEKTRIKE

Planimetria e instalimit të rrjetit kabllor të ndriçimit,

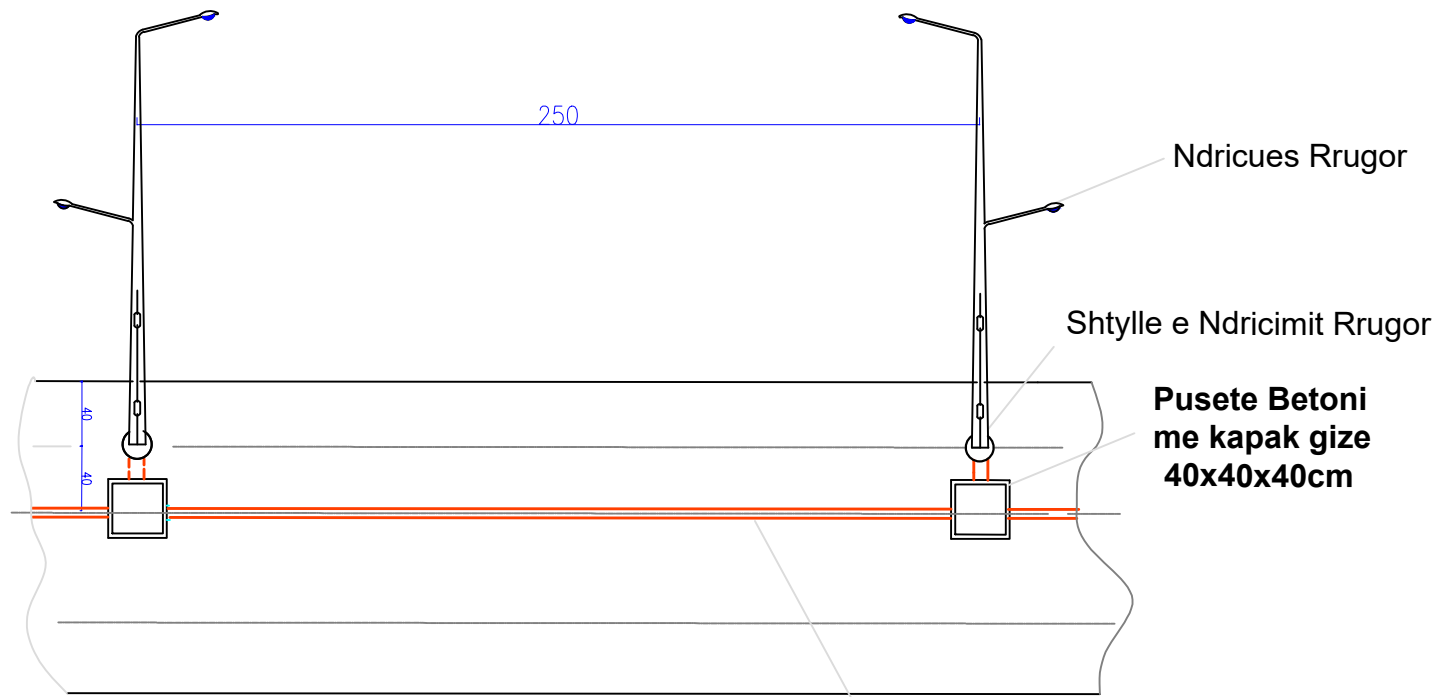

TuB Plastik fleksibel d=90mm

Detaj i montimit të pusetes dhe tokëzimit të shtyllës

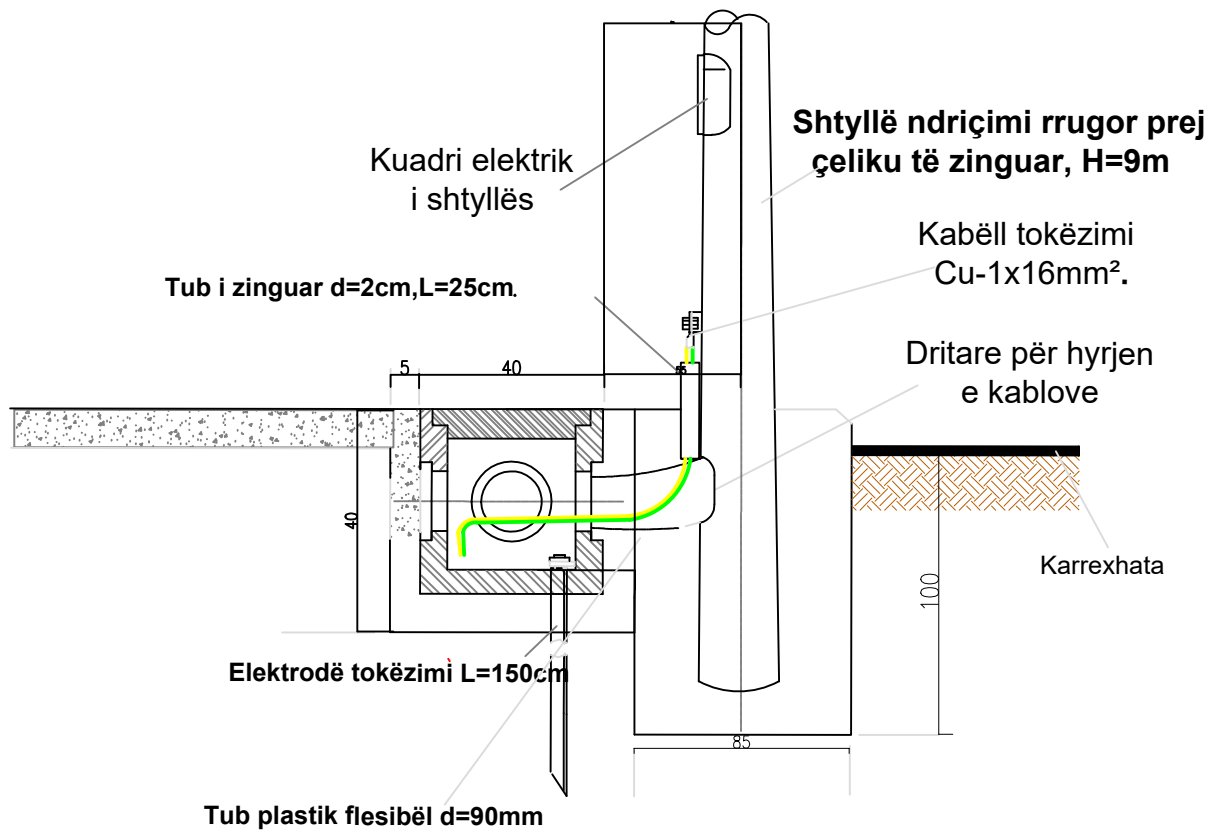

Shtrimi i kabllave të TU
ne TP.direkt ne toke

MATERIAL I NXJERE NGA
TRANSHEJA

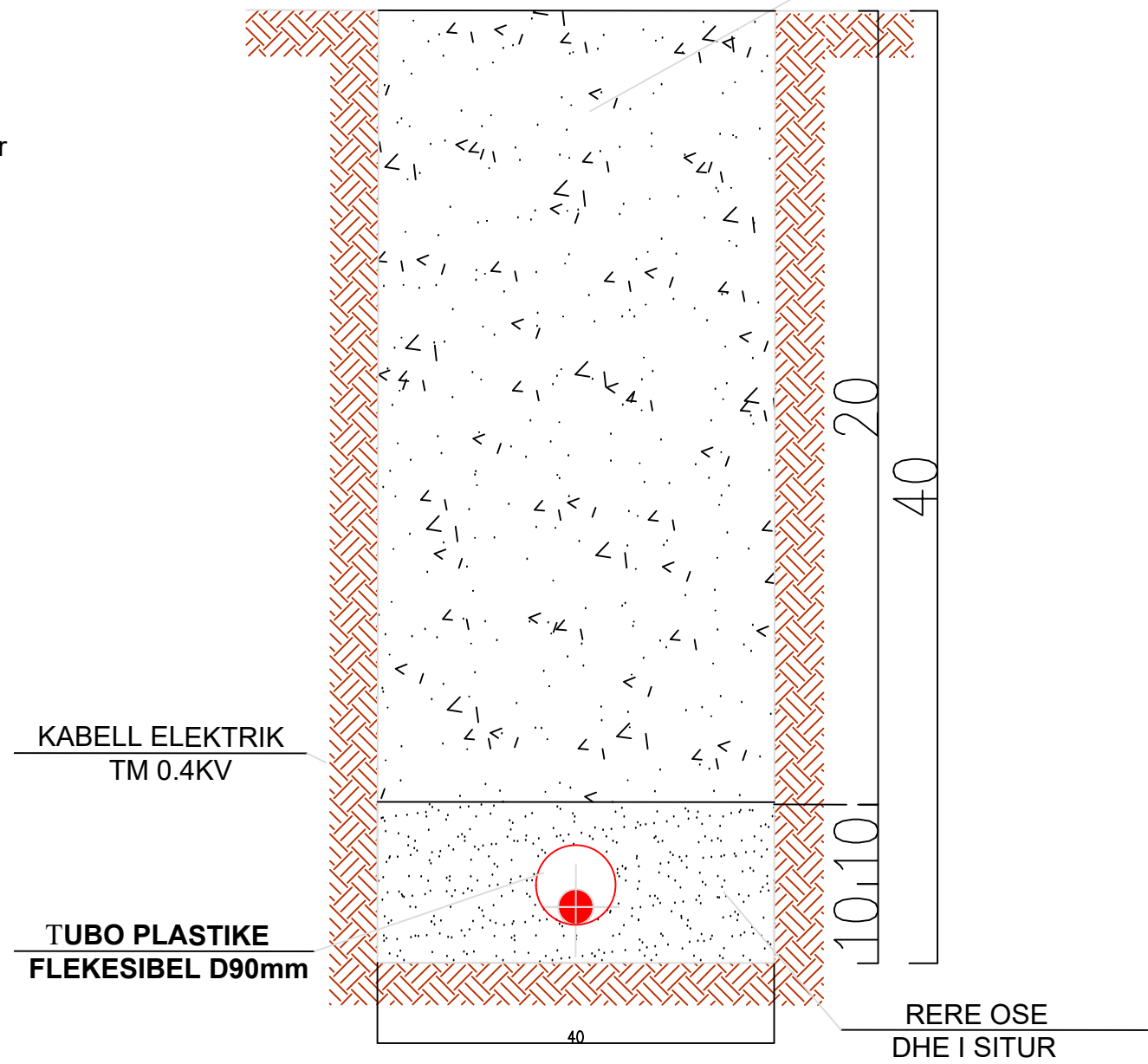

KABELL ELEKTRIK
TM 0.4KV

TUBO PLASTIKE
FLEKESIBEL D90mm

RERE OSE
DHE I SITUR

BENJA
DESTINACION
NDERKOMBETAR
TURISTIK

Shënime

Projektor	E. BEJLERI
Arkitekt	I. BEJLERI
Arkitekt	K. DEMAJ
Arkitekt	A. HALILAJ
Konstruktor	S. COLLAKU
Ing. Elektrik	V. HOXHA
Ing. Hidroteknik	E. CANO
Ing. Mekanik	D. BUZI

SHKALLA	E 05
---------	------

DETAJE TE FIBRES OPTIKE



BENJA
DESTINACION
NDERKOMBETAR
TURISTIK

Shënime

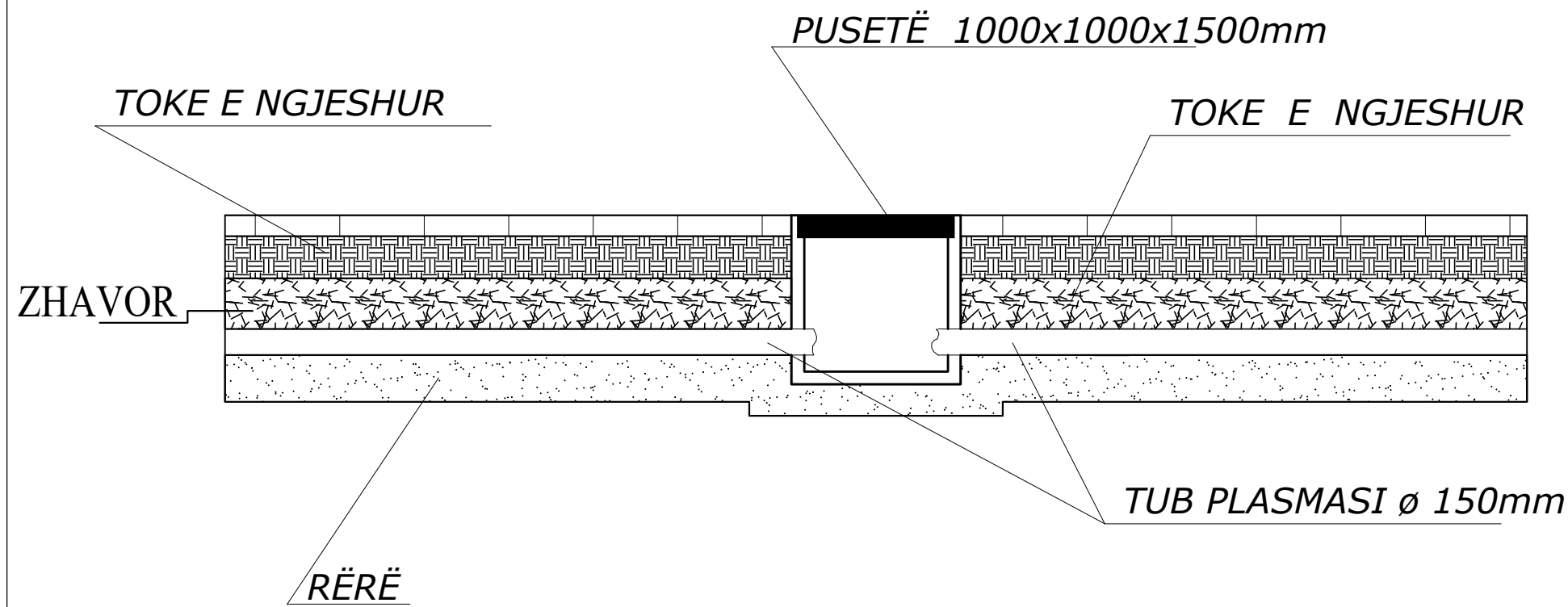
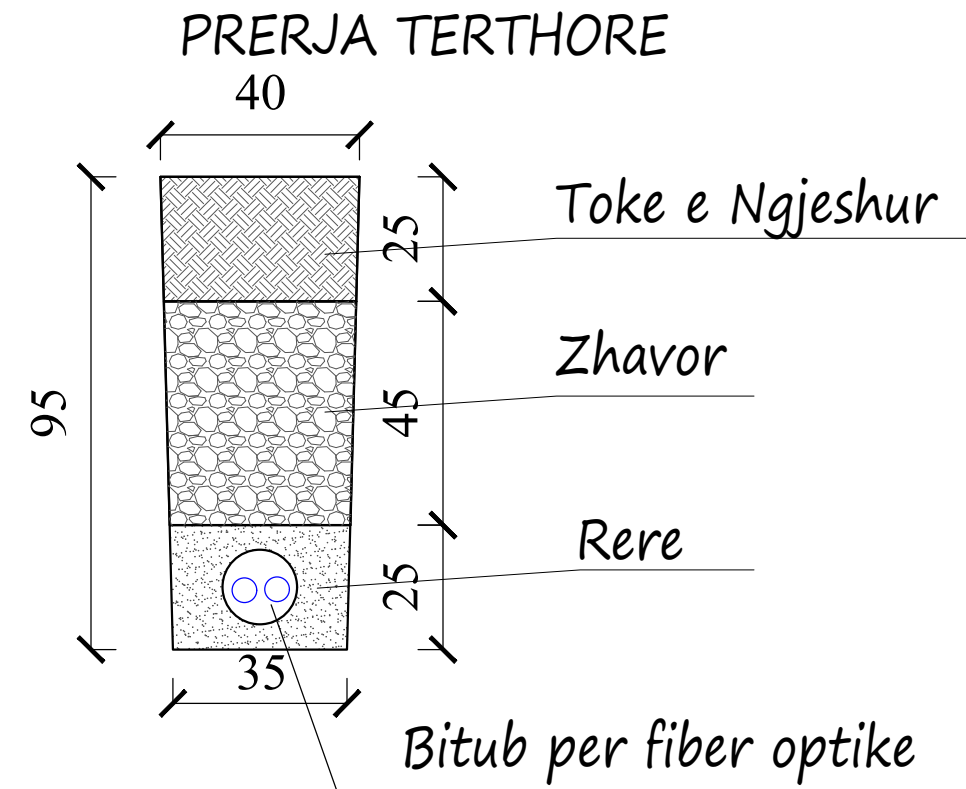
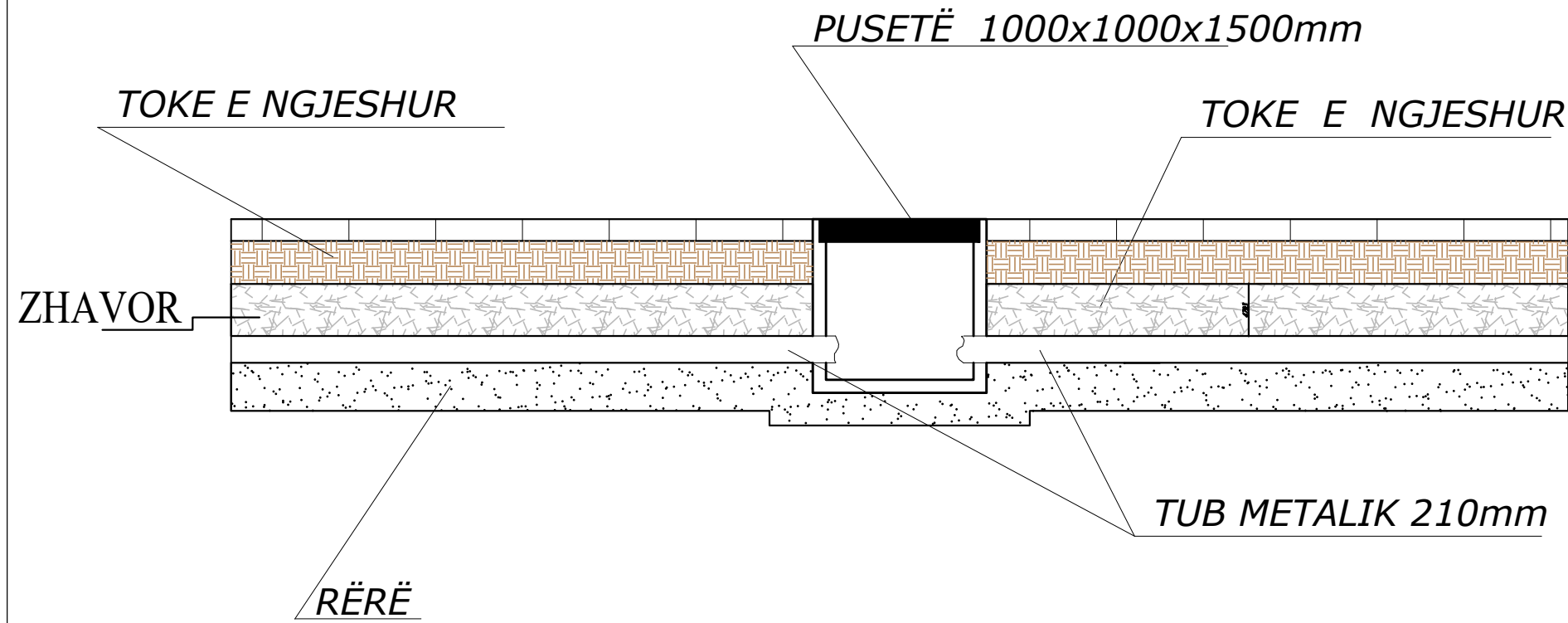

SHËNIME :

- Gjatë realizimit të intersektimeve kuota e vendosjes së pusetave mund të ndryshojë sipas rastit
- Tubi mund të vendoset me një pjerrësi të lehtë sipas nevojës , por gjithnjë thellësia minimale e vendosjes duhet të jetë 70cm nga sip. e asfaltit.

Projektor	E. BEJLERI
Arkitekt	I. BEJLERI
Arkitekt	K. DEMAJ
Arkitekt	A. HALILAJ
Konstruktor	S. COLLAKU
Ing. Elektrik	V. HOXHA
Ing. Hidroteknik	E. CANO
Ing. Mekanik	D. BUZI
SHKALLA	E 06



DETAJE TE FIBRES OPTIKE

Prerje e kapakut prej gize

Prerje e vendosjes së pusetave

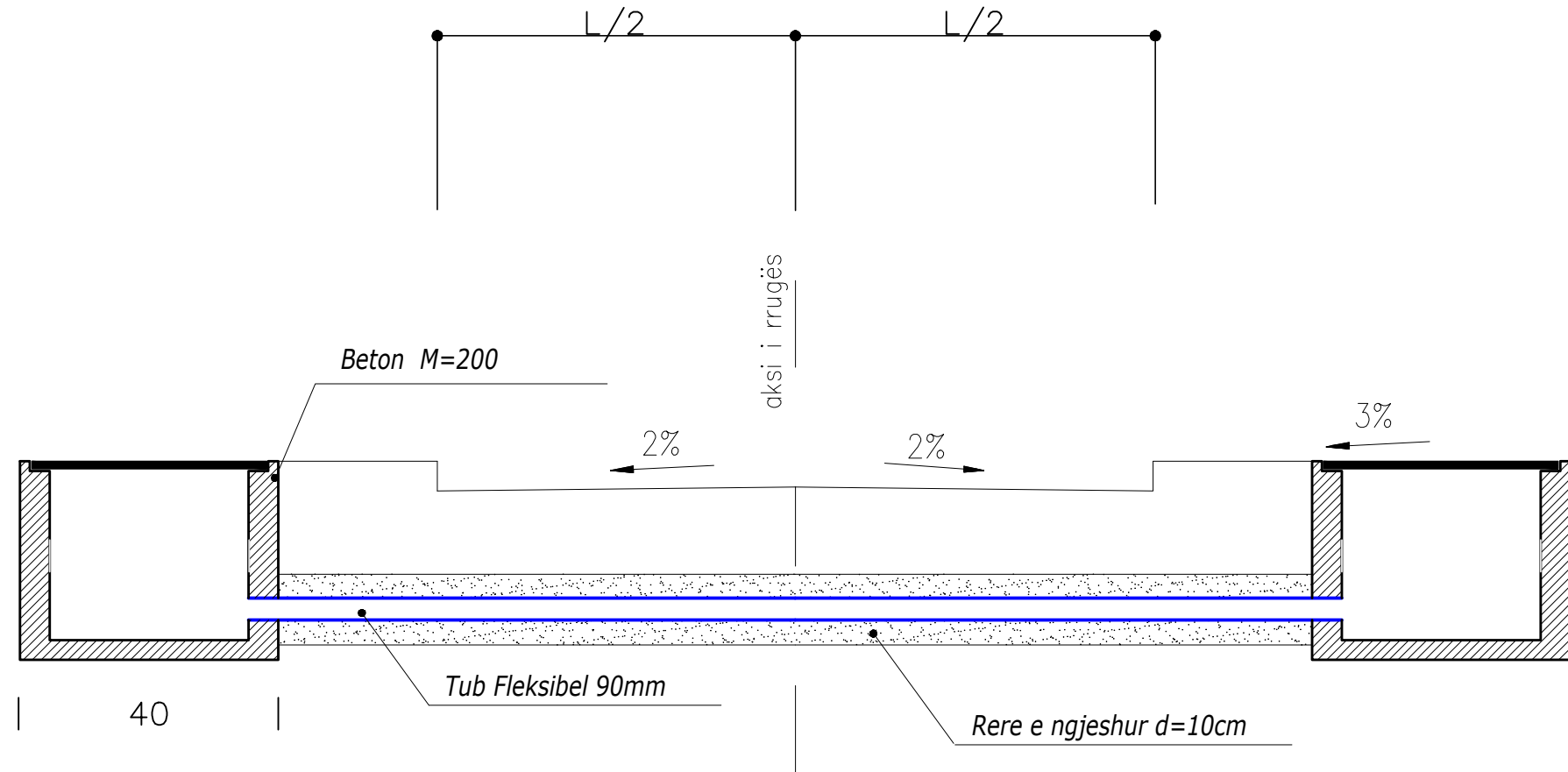
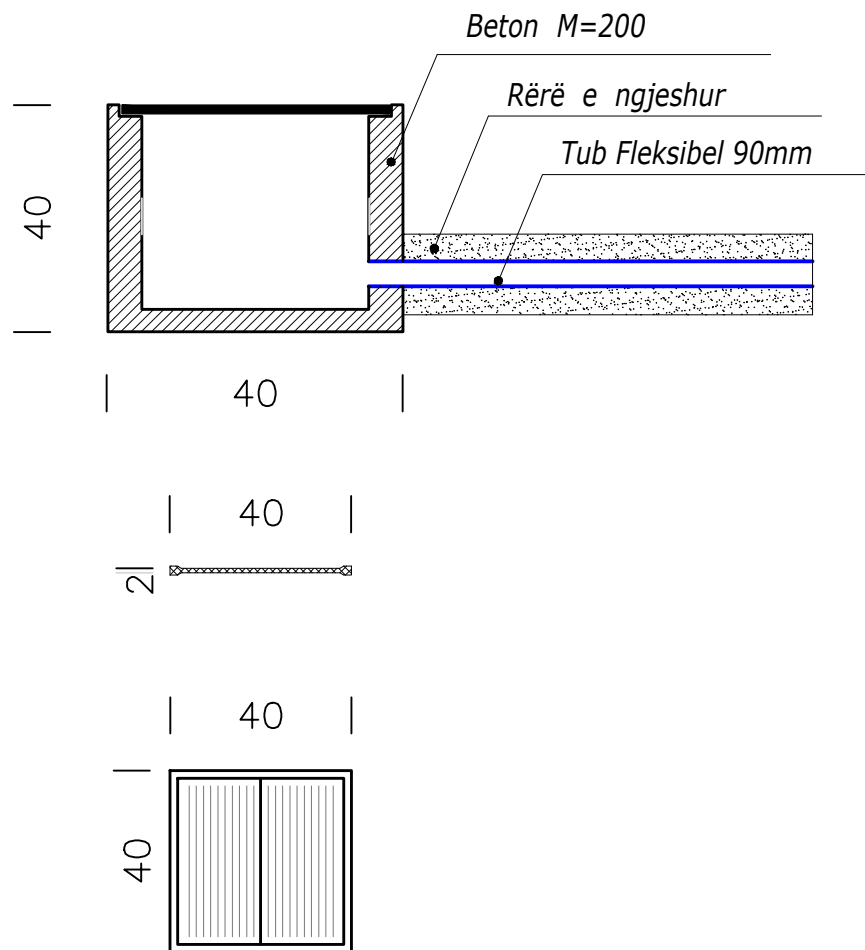

Kapaku i pusetës prej gize

Shënime

Projektoi	
Arkitekt	E. BEJLERI
Arkitekt	I. BEJLERI
Arkitekt	K. DEMAJ
Arkitekt	A. HALILAJ
Konstruktor	S. COLLAKU
Ing. Elektrik	V. HOXHA
Ing. Hidroteknik	E. CANO
Ing. Mekanik	D. BUZI
SHKALLA	E 07