

# Site Preparation drawings

## Table of contents

Sheet	Type	Subject
<b>General</b>		
1	C-1	Cover sheet. Table of contents
2	A-1	Site layout
3	AD-1	Schematic cross section(s)
<b>Building works</b>		
4	X-1	Floor provisions (all disciplines)
5	X-3	Wall provisions (all disciplines)
6	X-4	Wall provisions (all disciplines)
<b>Technical details</b>		
7	XD-1	Details 1 (all disciplines)

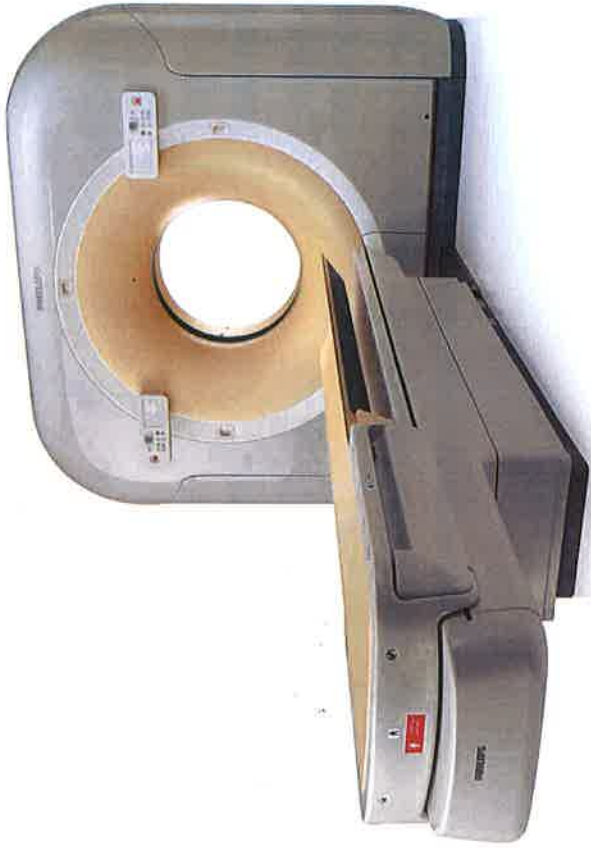

Typical configuration shown (not site specific)

### Revision history

Rev.	Date	Drawn	Checked	Project phase	Description
H					
G					
F					
E					
D					
C					
B	19-12-2022	MEL	GFU	Site preparation	
A	14-12-2022	GFU	ARA	Proposal	
0					

### Important notes

The information in this package is provided as a customer convenience, and is not intended to be used as architectural drawings or construction documents.

Philips assumes no liability nor offers any warranty for the fitness or accuracy of the premises or the utilities available at the premises in which the equipment is to be installed, used or stored.

Philips contact  
Mr. A. Laurant, andrlaurant@philips.com

**Philips Healthcare**  
A business of Royal Philips N.V.  
Philips Medical Systems Nederland B.V. Business Center ENKA  
Venloopus 4-6, 5696 PC, Best, The Netherlands

Sheet Subject  
Cover sheet  
Table of contents

Project  
Ingenuity Flex 32  
SPTALL BASHKIAK KAVAJE  
KAVAJE, Albania  
CT Room

Drawing  
AL-22-00005  
Order No  
A3  
mm  
C-1  
Sheet  
1 / 7



## Ingenuity Flex - 32 CT

Resp No	Description	Mass [kg]	Heat [W]	Noise [dB(A)]
<b>Examination area</b>				
A 1.1	Scanner Gantry (Ingenuity)	1950	5270	69
A 1.2	Patient table standard	389	=0	-
A 1.3	ECG monitor	-	-	-
A 1.4	Rate responsive CV tool kit	-	-	-
A 1.5	Cart mounted monitor (CCT)	27	40	-
A 1.6	Dual head injector	69.4	-	-
<b>Control area</b>				
A 2.1	Host tower computer	16	425	55
A 2.2	Server tower computer	21	1300	55
A 2.3	Wiring cabinet (wall mounted)	23	=0	55
A 2.4	Operating station (with desk)	46	290	-
A 2.5	Injector control	2	-	-
<b>Technical area</b>				
A 3.1	Transformer (Teal Isocran Line Match)	274	650	50
B 3.2	AT On Pro UPS 160 KVA	70	249	55
<b>General</b>				
B 4.1	Mains switch	-	-	-
B 4.2	Lead glass window	-	-	-
B 4.3	Emergency power OFF switch	-	-	-
B 4.4	X-ray ON warning light	-	-	-

### Responsibilities

- A Delivered and installed by Philips
- B Delivered and installed by customer/contractor
- C (Pre) Delivered by Philips, installed by customer
- D (Pre) Delivered by customer and installed by Philips
- E Existing

### Site requirements

- Mains power**
- Supply configuration with Isocran: 3 phase delta, 3 wire (U1, V1, W1, PE) into PDU.
  - 3 phase wire: 4 wire (L1, V2, W2, PE2, PE3 - electrode ground) output to CT gantry.
  - Nominal Line Voltage with Isocran: 200, 208, 240, 380V, 400, 415, 440, 480, 500 VAC delta
  - Input to PDU -480 VAC wye output to CT gantry.
  - Minimum emergency power required: 110 KVA
  - Mains resistance: 160 mOhm line to line max. 80KV scan at 480 VAC
- Remote service diagnostics**
- To establish this feature, a RJ45 type Ethernet connector must be installed with access to the customer's network (100/1000 Mbps)
- Environmental requirements**
- Examination room:**
- Operating temperature range is 18°C-24°C
  - at 35%-70% relative humidity (non-condensing)
  - Temperature change should not exceed 4.1°C per hour.
- Control room:**
- Operating temperature range is 15°C-24°C
  - at 35%-70% relative humidity (non-condensing)
  - Temperature change should not exceed 5°C per hour.
- Technical room:**
- Operating temperature range is 15°C-28°C
  - at 20%-80% relative humidity (non-condensing)
  - Temperature change should not exceed 5°C per hour.

### Project notes

- The feasibility of this project is based on site information (like drawings) provided to Philips. Philips cannot assume any liability for the accuracy of this information and the consequences.
- The equipment proposed in this room layout produces X-ray radiation. It is the customer's responsibility to comply with the local regulation. Normally X-ray shielding has to be applied to avoid hazards to patients, visitors and staff. Consult the Philips contact for details and support.

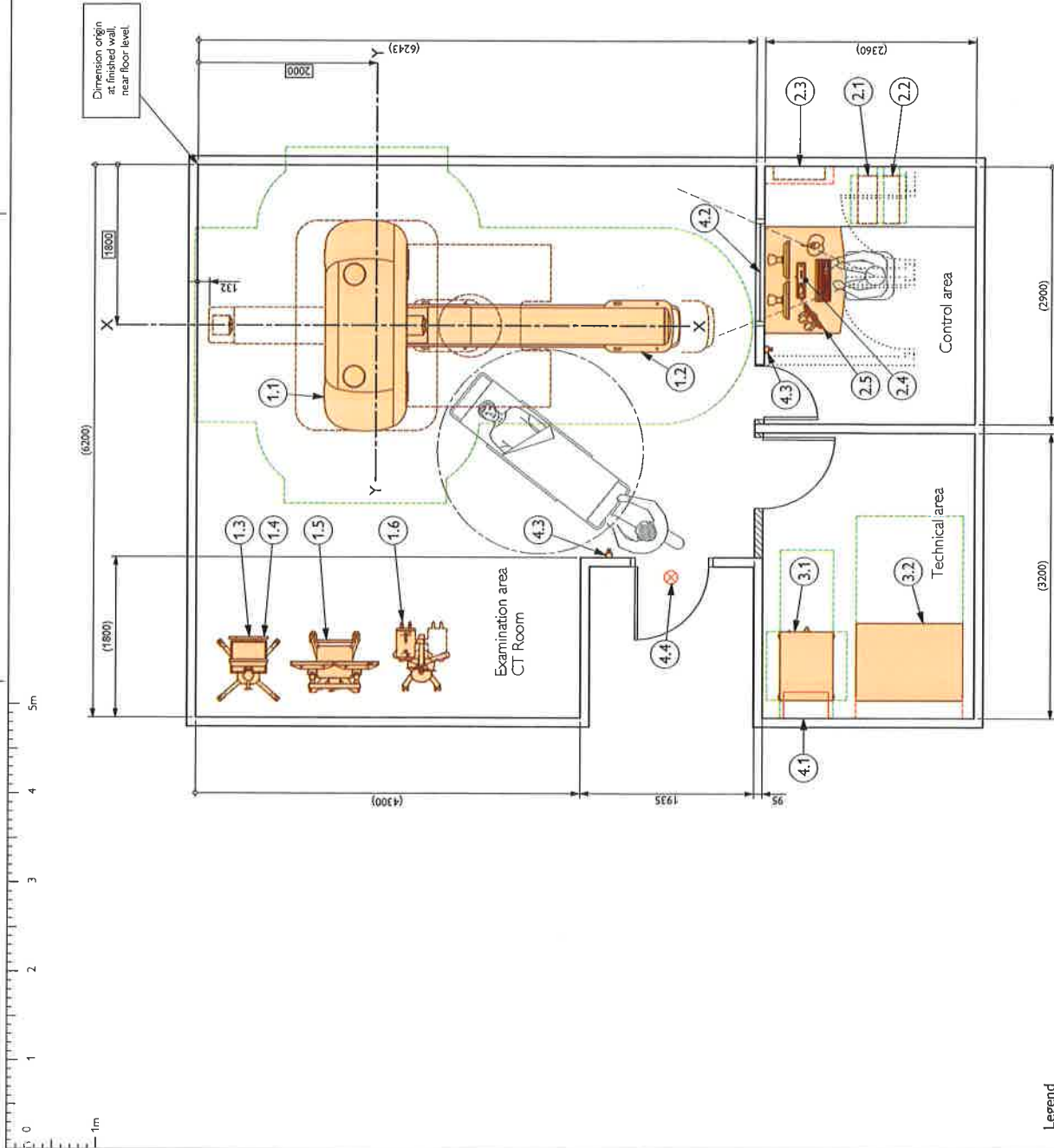

### Dimensioning legend

- System position dimension (ISO-centre)
- Architectural dimension to be checked on site
- Dimension from origin

### Legend

- Walls
- New walls
- Existing doors/walls to be removed
- Beams or other building construction elements
- Columns (materials and strength unknown)
- Preferred service area

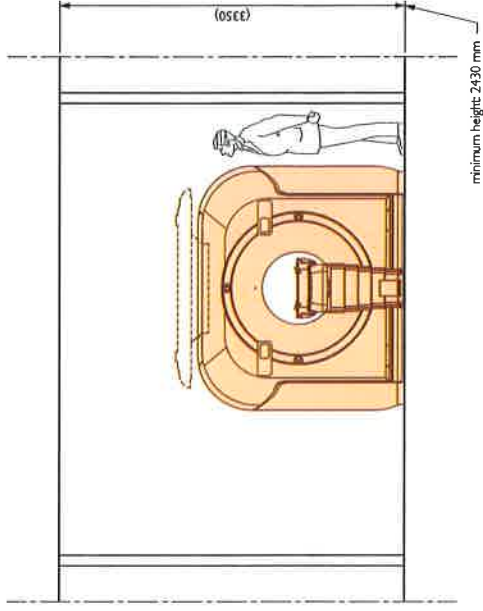

Schematic cross section B-B

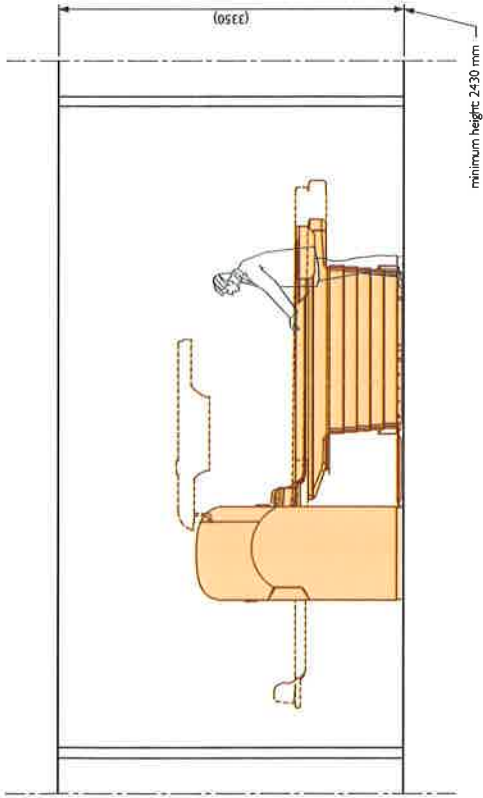

Schematic cross section A-A

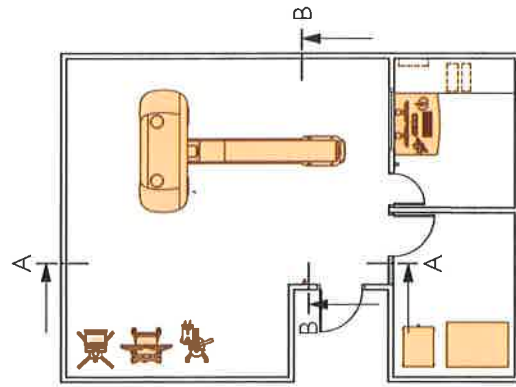

Situation (scale 1:100)



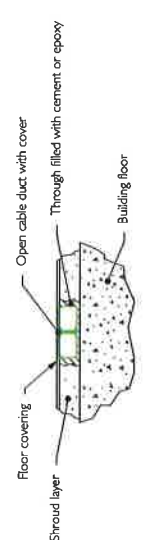
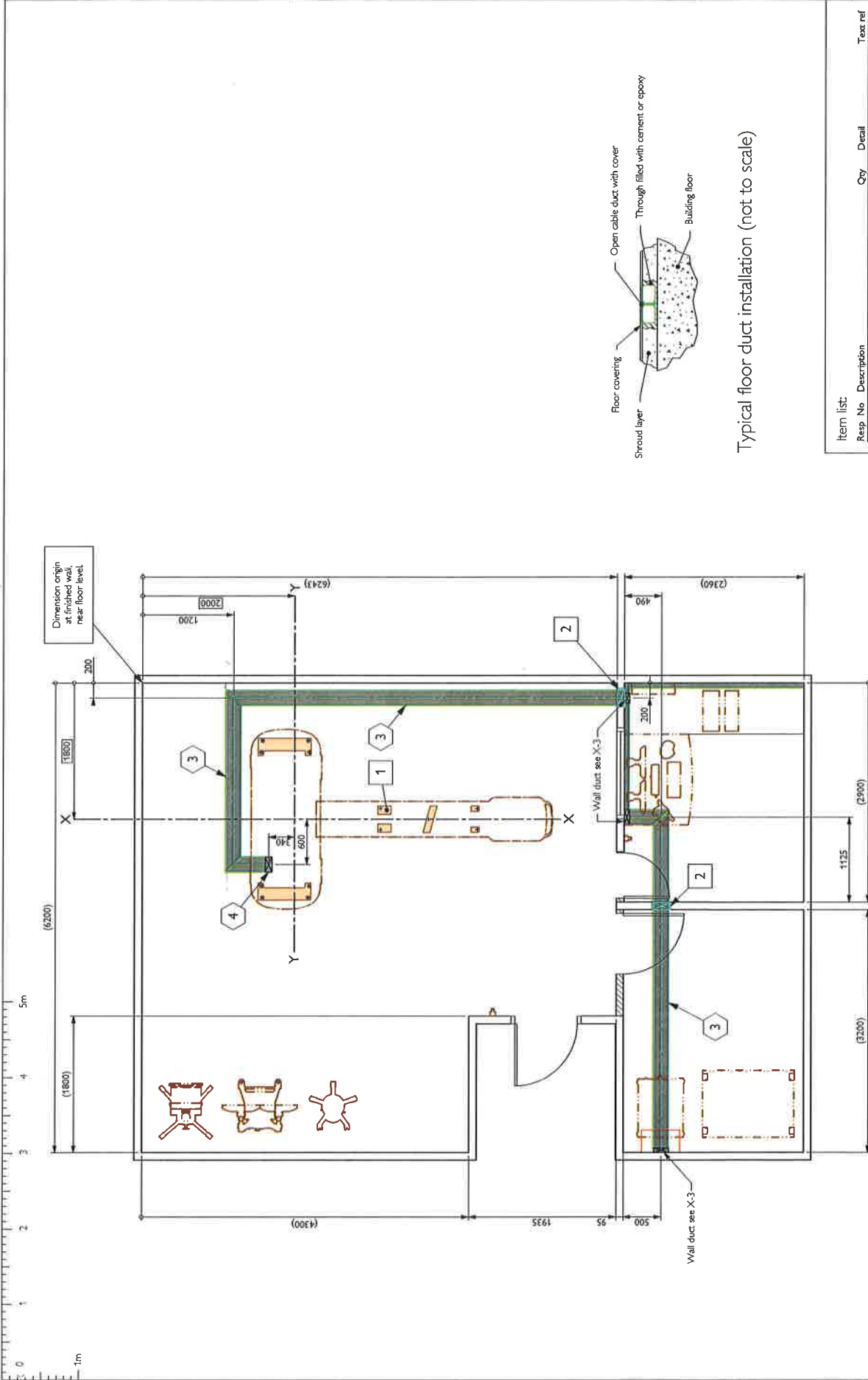

Typical floor duct installation (not to scale)

Item list:

Resp. No	Description	Qty	Detail	Text ref
B 1	Base plate provision for CT	1	XD-1	§ 2.2
B 2	Wall opening	2		§ 2.3
B 3	200 x 60 Floor duct flush mounted	1		§ 2.3
B 4	200 x 90 Cable outlet	1		§ 2.3

Responsibilities:

- A Delivered and installed by Philips
- B Delivered and installed by customer
- C Delivered by Philips and installed by customer
- D Delivered by customer and installed by Philips
- E Existing

Works symbology

- Construction works
- Electrical works
- ◇ Mechanical works
- Equipment works

### Legend

- Walls
- New walls
- Existing doors/walls to be removed
- Beams or other building construction elements
- Columns (materials and strength unknown)
- Preferred service area

### Dimensioning legend

- System position dimension (ISO-centre)
- Architectural dimension to be checked on site
- Dimension from origin



1m

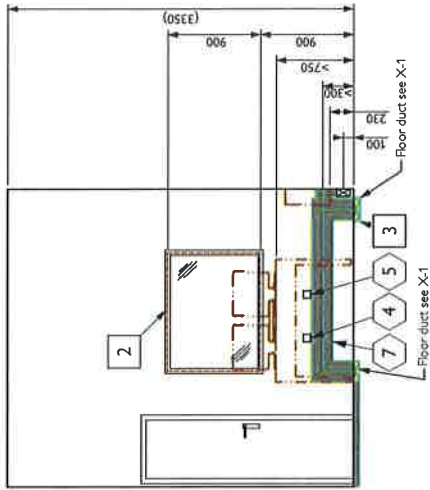

Elevation A

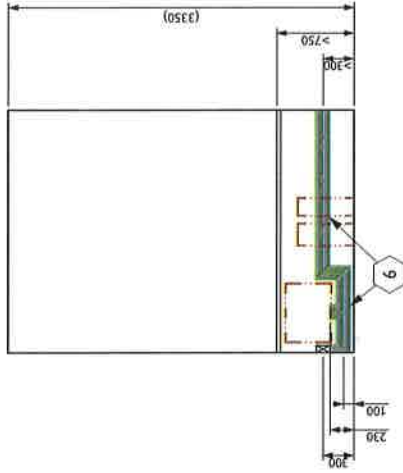

Elevation B

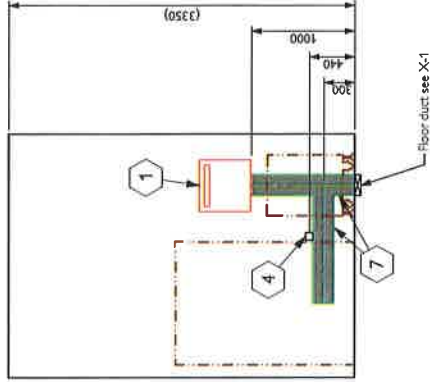

Elevation C

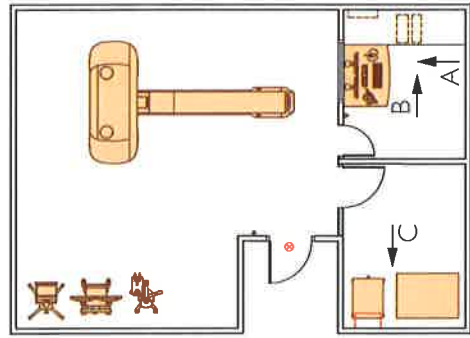

Situation (scale 1:100)

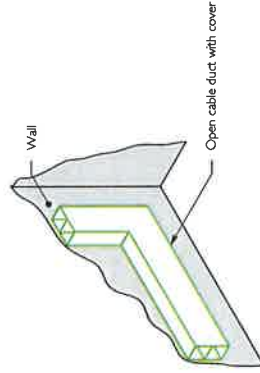

Typical wall duct installation (not to scale)

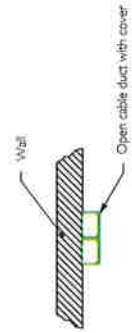

Typical wall duct installation (not to scale)

Item list	Resp No	Description	Qty	Detail	Text ref
B	1	Mains switch	1	-	§ 3.2
B	2	Lead glass window	1	-	§ 1.6
B	3	Wall opening	1	-	-
B	4	Power outlet (Philips dedicated)	2	-	§ 3.2
B	5	Network connection 1Gbps, RJ45	1	-	§ 3.4
B	6	130 x 70 Wall duct	-	-	§ 3.3
B	7	200 x 70 Wall duct	-	-	§ 3.3

- Responsibilities:
- A Delivered and installed by Philips
  - B Delivered and installed by customer
  - C Delivered by Philips and installed by customer
  - D Delivered by customer and installed by Philips
  - E Existing
- Works symbology
- Construction works
  - Electrical works
  - Mechanical works
  - Equipment works

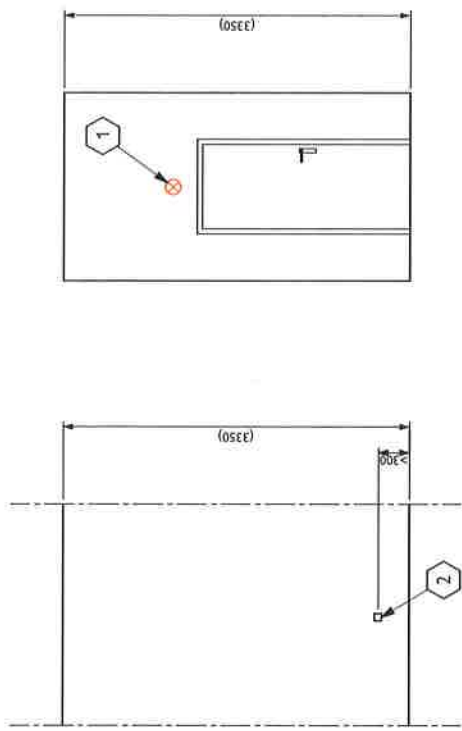

Elevation E

Elevation D

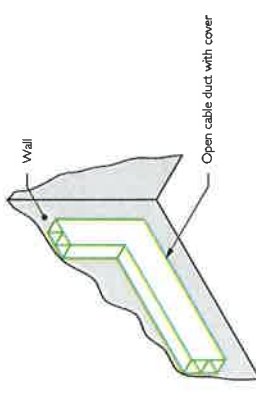

Typical wall duct installation (not to scale)

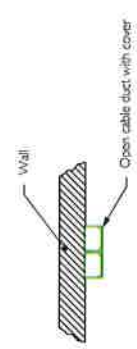

Typical wall duct installation (not to scale)

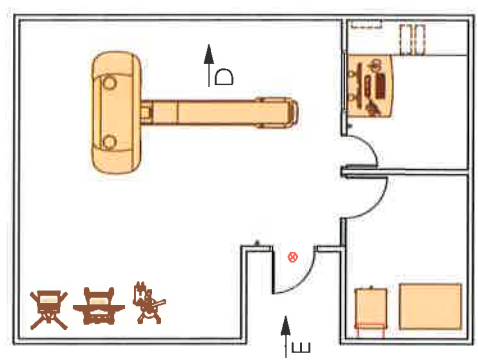

Situation (scale 1:100)

Item list	Resp No	Description	Qty	Detail	Text ref
	B	X-ray ON warning light	1	1	§ 3.2
	B	Power outlet (Philips dedicated)	1	1	§ 3.2

**Responsibilities:**

- A Delivered and installed by Philips
- B Delivered and installed by customer
- C Delivered by Philips and installed by customer
- D Delivered by customer and installed by Philips
- E Existing

**Works symbols:**

- Construction works
- Electrical works
- ◇ Mechanical works
- ◇ Equipment works

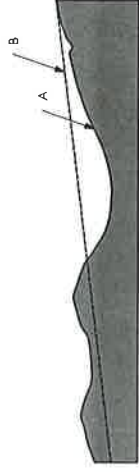
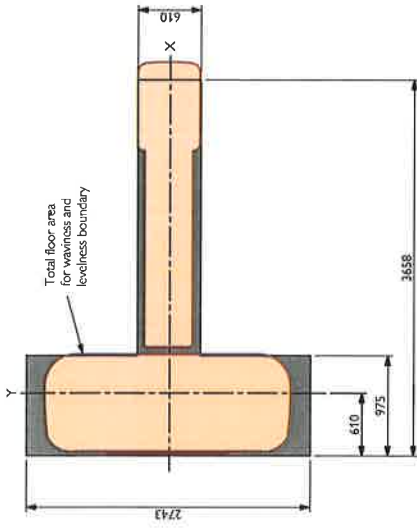

Notes:  
See note 1 for max. waviness span  
See note 2 for max. levelness span

1. Floor waviness (A) of exam room shall not exceed 6.3 mm when measured within 300 mm from any point within the shaded area on layout.
2. Floor levelness (B) of exam room shall not exceed 6.3 mm when measured between any two boundary points across the shaded area on layout.
3. Apply self leveling grout material as required to meet specifications.

### Detail - Floor levelness and waviness (not to scale)

Item No	Description	Qty	Detail	Test ref
A	① Expansion anchor M12	13	-	§ 2.2
B	② Drill hole for M12 anchor	13	-	§ 2.2
A	③ Base plate for gantry	1	-	§ 2.2
A	④ Base plate for patient table	1	-	§ 2.2

- Responsibilities:
- A Delivered and installed by Philips
  - B Delivered and installed by customer
  - C Delivered by Philips and installed by customer
  - D Delivered by customer and installed by Philips
  - E Existing
- Works symbology
- Construction works
  - Electrical works
  - Mechanical works
  - Equipment works

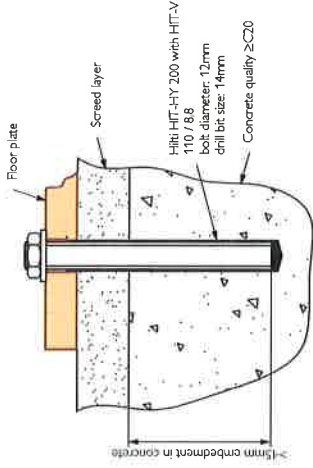

Gantry and patient table fixing detail  
(not to scale)  
Not delivered by Philips

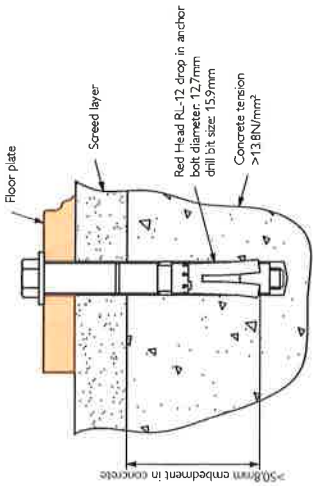

Gantry and patient table fixing detail  
(not to scale)  
Delivered by Philips

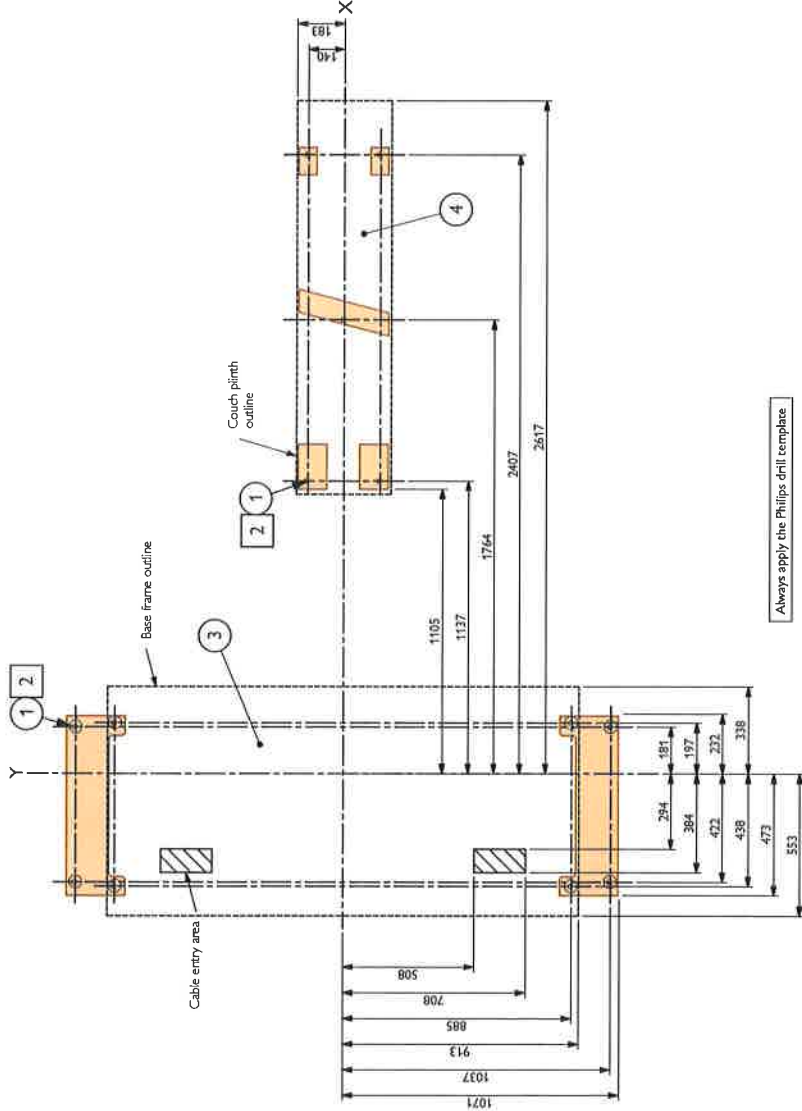

Detail - Scanner gantry/patient table base frame (scale 1:20)