



**Bashkia Shkodër**

# PROJEKT ZBATIMI

## RIKONSTRUKSION RRUGA "SELIM GJYREZI"

- 1- *Hoorografia*
- 2- *Topografia e rruges*
- 3- *Planimetria e rruges*
- 4- *Profili gjatësor*
- 5- *Profilat tërthore*
- 6- *Profili tërthore tip*
- 7- *Plani i KUZ*
- 8- *Plani i KUSH*
- 8- *Sinjalistika rrugore dhe detajet*

MIRATOHET  
KRYETARI I BASHKISË  
Z. BARDH SPAHIA

PROJEKTOI:  
"LENI-ING" SH.P.K  
&  
"ANGERBA" SH.P.K

TIRANË 2023





MBARIMI I  
RRUGES

FILLIMI I  
RRUGES

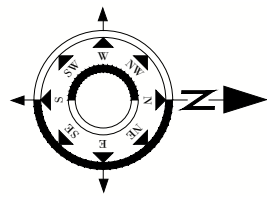

Porositi :



**Bashkia Shkodër**

Projektoi:

**"LENI-ING" sh.p.k  
&  
"ANGERBA" sh.p.k**

Adresa: Rr. Uran Pano, Pallati 12 kat, Kati 2  
Mobile: 0682042270  
Email: leni-ing@hotmail.com

Objekti: <b>Rikonstrukcion Rruga "Selim Gjyrezi"</b>		
Faza: <b>Projekt - Zbatim</b>		
Emërtimi i Fletës: <b>HOOROGRAFIA E RRUGES</b>	Shkalla: Sh 1:500	Tiranë 2023  HO





**Bashkia Shkodër**

# PROJEKT ZBATIMI

## RIKONSTRUKSION RRUGA "SELIM GJYREZI"

- 1- Hoorografia
- 2- Topografia e rruges
- 3- Planimetria e rruges
- 4- Profili gjatësor
- 5- Profilat tërthore
- 6- Profili tërthore tip
- 7- Plani i KUZ
- 8- Plani i KUSH
- 8- Sinjalistika rrugore dhe detajet

MIRATOHET  
KRYETARI I BASHKISË  
Z. BARDH SPAHIA

PROJEKTOI:  
"LENI-ING" SH.P.K  
&  
"ANGERBA" SH.P.K

TIRANË 2023

MBARIMI I RRUGES

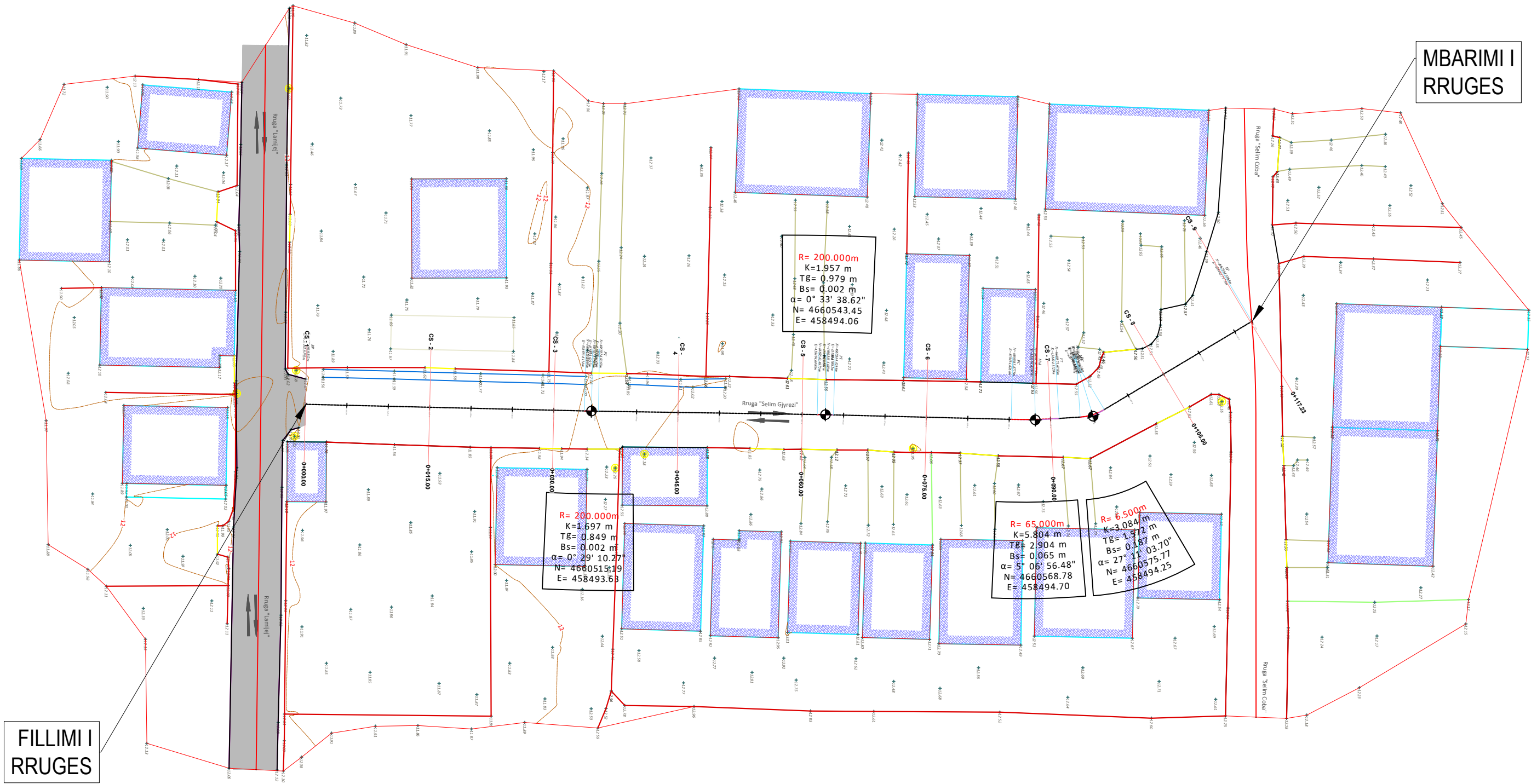

FILLIMI I RRUGES

R= 200.000m  
K=1.957 m  
Tg= 0.979 m  
Bs= 0.002 m  
 $\alpha = 0^{\circ} 33' 38.62''$   
N= 4660543.45  
E= 458494.06

R= 200.000m  
K=1.697 m  
Tg= 0.849 m  
Bs= 0.002 m  
 $\alpha = 0^{\circ} 29' 10.27''$   
N= 4660515.19  
E= 458493.63

R= 65.000m  
K=5.804 m  
Tg= 2.904 m  
Bs= 0.065 m  
 $\alpha = 5^{\circ} 06' 56.48''$   
N= 4660568.78  
E= 458494.70

R= 6.500m  
K=3.084 m  
Tg= 1.972 m  
Bs= 0.187 m  
 $\alpha = 27^{\circ} 11' 03.70''$   
N= 4660575.77  
E= 458494.25

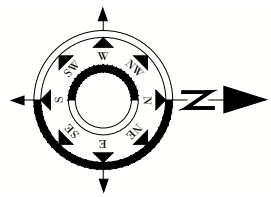

- SHPJEGUES**
- 156.95 Pike detaje
  - 158.0 Izohipse
  - Objekt
  - Kanal Natyral
  - Rrethim
  - Mur Rrethues

Porositi :



**Bashkia Shkodër**

Projektoi:

**"LENI-ING" sh.p.k**  
&  
**"ANGERBA" sh.p.k**

Adresa: Rr. Uran Pano, Pallati 12 kat, Kati 2  
Mobile: 0682042270  
Email: leni-ing@hotmail.com

Objekti: <b>Rikonstrukcion Rruga "Selim Gjyzezi"</b>		
Faza: <b>Projekt - Zbatim</b>		
Emërtimi i Fletës: <b>TOPOGRAFIA E RRUGES</b>	Shkalla: Sh 1:200	Tiranë 2023 <b>TOPO_(01)</b>

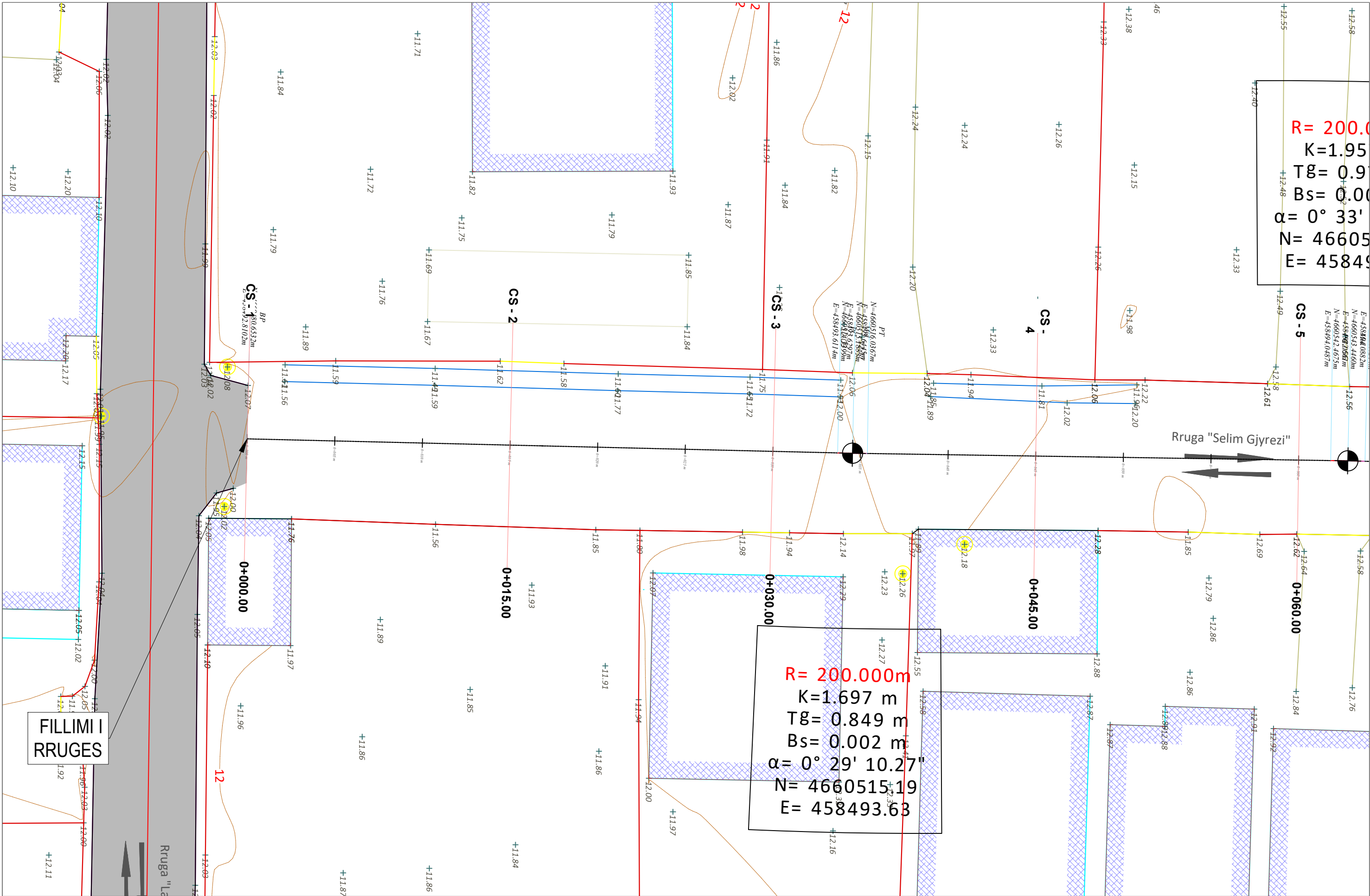

**R= 200.0**  
**K=1.95**  
**Tg= 0.9**  
**Bs= 0.00**  
**α= 0° 33'**  
**N= 46605**  
**E= 45849**

**R= 200.000m**  
**K=1.697 m**  
**Tg= 0.849 m**  
**Bs= 0.002 m**  
**α= 0° 29' 10.27"**  
**N= 4660515.19**  
**E= 458493.63**

**FILLIMI I RRUGES**

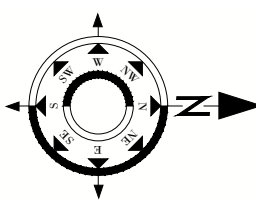

- SHPJEGUES**
- Pike detaje
  - Izohipse
  - Objekt
  - Kanal Natyral
  - Rrethim
  - Mur Rrethues

Porositi :



**Bashkia Shkodër**

Projektoi:

**"LENI-ING" sh.p.k**  
**&**  
**"ANGERBA" sh.p.k**

Adresa: Rr. Uran Pano, Pallati 12 kat, Kati 2  
 Mobile: 0682042270  
 Email: leni-ing@hotmail.com

Objekti: <b>Rikonstruksion Rruga "Selim Gjyrezi"</b>		
Faza: <b>Projekt - Zbatim</b>		
Emërtimi i Fletës:	Shkalla:	Tiranë 2023
<b>TOPOGRAFIA</b> E RRUGES	Sh 1:200	TOPO_(2)

**MBARIMI I RRUGES**

**R= 200.000m**  
**K=1.957 m**  
**Tg= 0.979 m**  
**Bs= 0.002 m**  
**α= 0° 33' 38.62"**  
**N= 4660543.45**  
**E= 458494.06**

**R= 65.000m**  
**K=5.804 m**  
**Tg= 2.904 m**  
**Bs= 0.065 m**  
**α= 5° 06' 56.48"**  
**N= 4660568.78**  
**E= 458494.70**

**R= 6.500m**  
**K=3.084 m**  
**Tg= 1.572 m**  
**Bs= 0.187 m**  
**α= 27° 11' 03.70"**  
**N= 4660575.77**  
**E= 458494.25**

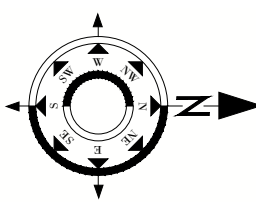
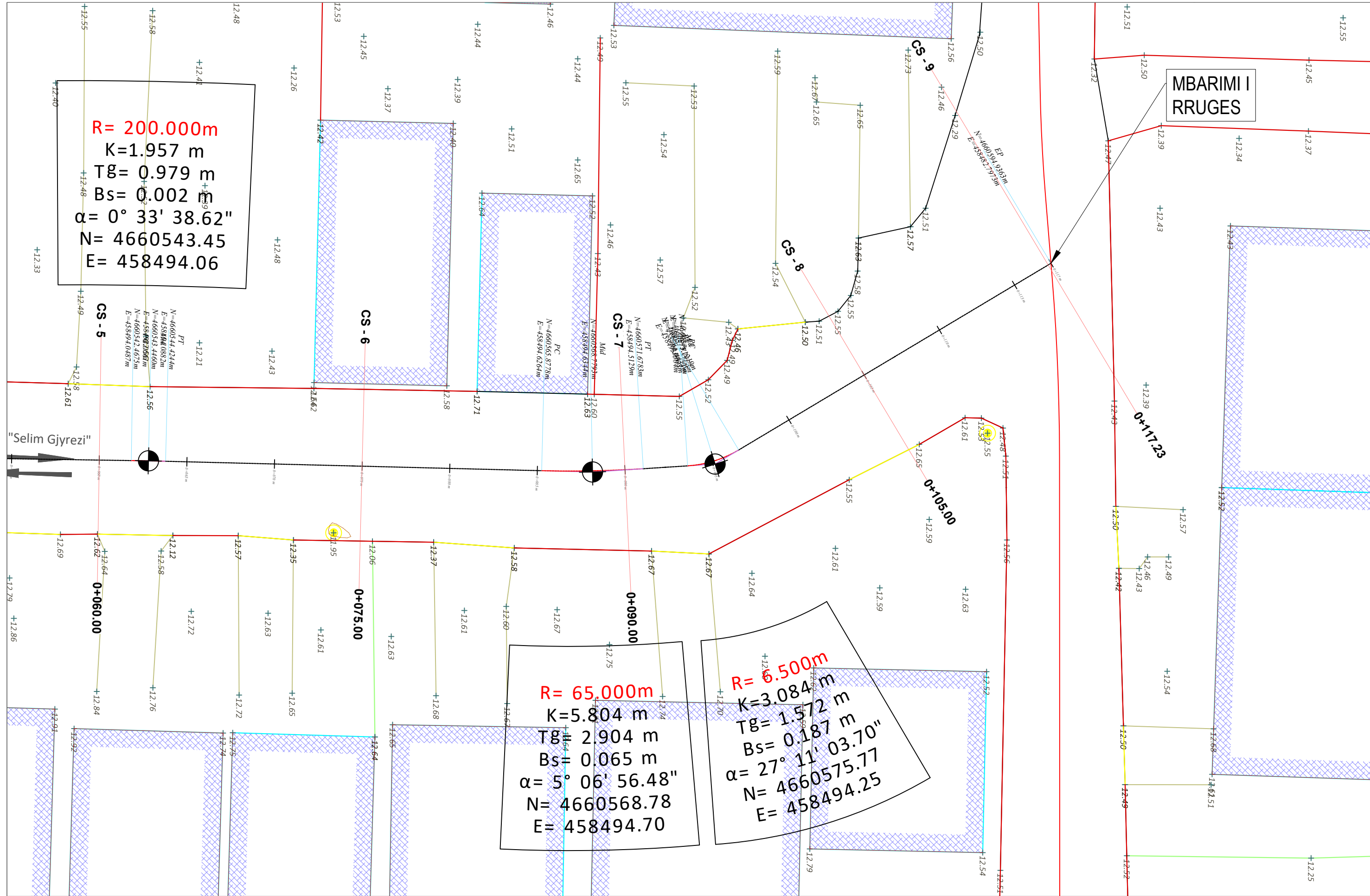

- SHPJEGUES**
- Pike detaje
  - Izohipse
  - Objekt
  - Kanal Natyral
  - Rrethim
  - Mur Rrethues

Porositi :



**Bashkia Shkodër**

Projektoi:

**"LENI-ING" sh.p.k**  
**&**  
**"ANGERBA" sh.p.k**

Adresa: Rr. Uran Pano, Pallati 12 kat, Kati 2  
 Mobile: 0682042270  
 Email: leni-ing@hotmail.com

Objekti: <b>Rikonstrukcion Rruga "Selim Gjyrezi"</b>		
Faza: <b>Projekt - Zbatim</b>		
Emërtimi i Fletës: <b>TOPOGRAFIA E RRUGES</b>	Shkalla: Sh 1:200	Tiranë 2023 <b>TOPO_(3)</b>





**Bashkia Shkodër**

# PROJEKT ZBATIMI

## RIKONSTRUKSION RRUGA "SELIM GJYREZI"

- 1- Hoorografia
- 2- Topografia e rruges
- 3- Planimetria e rruges
- 4- Profili gjatësor
- 5- Profilat tërthore
- 6- Profili tërthore tip
- 7- Plani i KUZ
- 8- Plani i KUSH
- 8- Sinjalistika rrugore dhe detajet

MIRATOHET  
KRYETARI I BASHKISË  
Z. BARDH SPAHIA

PROJEKTOI:  
"LENI-ING" SH.P.K  
&  
"ANGERBA" SH.P.K

TIRANË 2023

MBARIMI I RRUGES

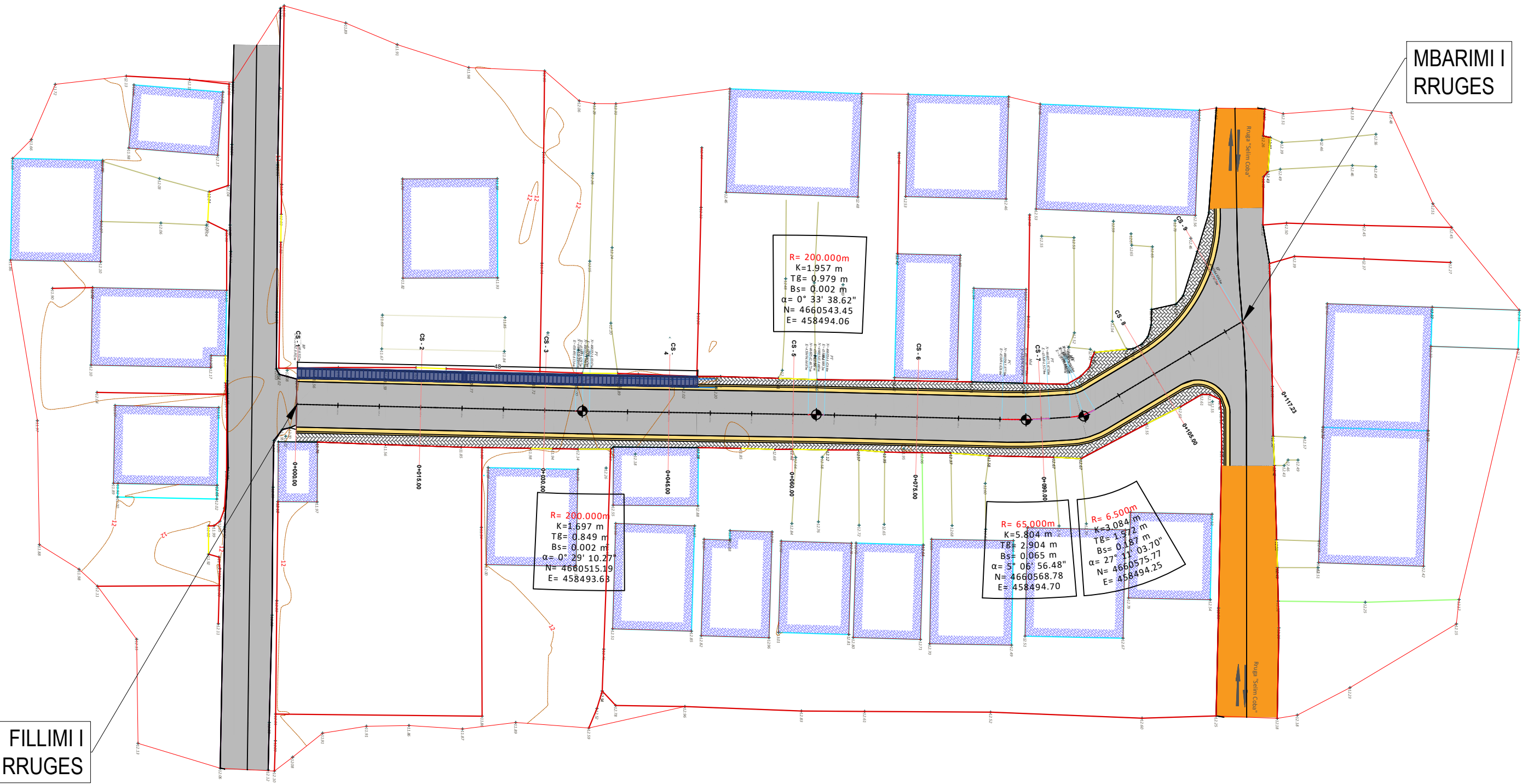

FILLIMI I RRUGES

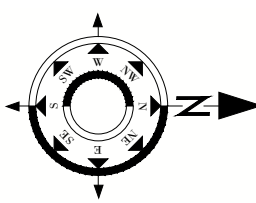

- SHPJEGUES**
- 156.95 Pike detaje
  - 158.0 Izohipse
  - Objekt
  - Kanal Natyral
  - Rrethim
  - Mur Rrethues

Porositi :



**Bashkia Shkodër**

Projektoi:

**"LENI-ING" sh.p.k**  
&  
**"ANGERBA" sh.p.k**

Adresa: Rr. Uran Pano, Pallati 12 kat, Kati 2  
Mobile: 0682042270  
Email: leni-ing@hotmail.com

Objekti: <b>Rikonstrukcion Rruga "Selim Gjyzezi"</b>		
Faza: <b>Projekt - Zbatim</b>		
Emërtimi i Fletës:	Shkalla:	Tiranë 2023
<b>PLANIMETRIA</b>	Sh 1:200	PL_(1)
<b>E RRUGES</b>		



**R= 200.0**  
**K=1.95**  
**Tg= 0.9**  
**Bs= 0.00**  
 **$\alpha = 0^\circ 33'$**   
**N= 46605**  
**E= 45849**

CS - 5  
 N=458494.0487m  
 E=458494.0487m  
 N=4600543.4460m  
 E=458494.0487m  
 N=4600542.4075m  
 E=458494.0487m

**R= 200.000m**  
**K=1.697 m**  
**Tg= 0.849 m**  
**Bs= 0.002 m**  
 **$\alpha = 0^\circ 29' 10.27''$**   
**N= 4660515.19**  
**E= 458493.63**

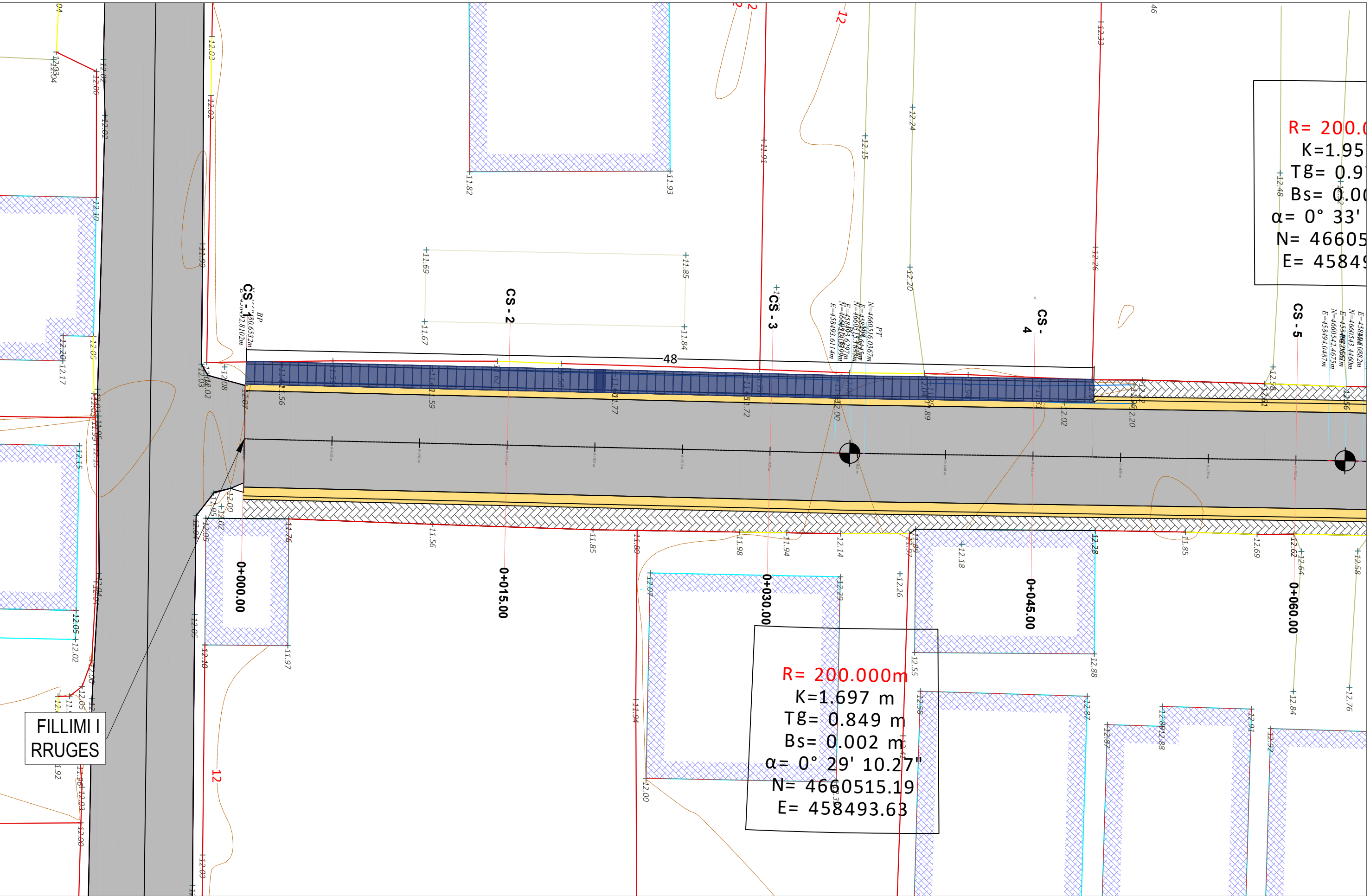

FILLIMI I RRUGES

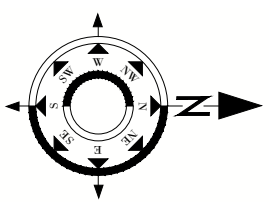

- SHPJEGUES**
- 156.95 Pike detaje
  - 158.0 Izohipse
  - ▭ Objekt
  - Kanal Natyral
  - Rrethim
  - Mur Rrethues

Porositi :



**Bashkia Shkodër**

Projektoi:

**"LENI-ING" sh.p.k**  
**&**  
**"ANGERBA" sh.p.k**

Adresa: Rr. Uran Pano, Pallati 12 kat, Kati 2  
 Mobile: 0682042270  
 Email: leni-ing@hotmail.com

Objekti: <b>Rikonstrukcion Rruga "Selim Gjyzezi"</b>		
Faza: <b>Projekt - Zbatim</b>		
Emërtimi i Fletës:	Shkalla:	Tiranë 2023
<b>PLANIMETRIA</b> E RRUGES	Sh 1:200	PL_(2)

**MBARIMI I RRUGES**

**R= 200.000m**  
**K=1.957 m**  
**Tg= 0.979 m**  
**Bs= 0.002 m**  
 **$\alpha= 0^\circ 33' 38.62''$**   
**N= 4660543.45**  
**E= 458494.06**

**R= 65.000m**  
**K=5.804 m**  
**Tg= 2.904 m**  
**Bs= 0.065 m**  
 **$\alpha= 5^\circ 06' 56.48''$**   
**N= 4660568.78**  
**E= 458494.70**

**R= 6.500m**  
**K=3.084 m**  
**Tg= 1.572 m**  
**Bs= 0.187 m**  
 **$\alpha= 27^\circ 11' 03.70''$**   
**N= 4660575.77**  
**E= 458494.25**

**CS - 5**  
 PT  
 N=4660544.4244m  
 E=458494.0852m  
 N=4660543.4460m  
 E=458494.0667m  
 N=4660542.4675m  
 E=458494.0487m

**CS - 6**

**PC**  
 N=4660565.8775m  
 E=458494.6264m

**CS - 7**  
 PT  
 N=4660571.6783m  
 E=458494.5129m

**0+105.00**

**0+117.23**

**0+060.00**

**0+075.00**

**0+090.00**

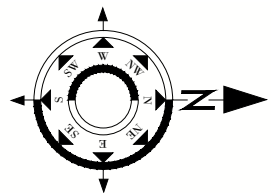

- SHPJEGUES**
- 156.95 Pike detaje
  - 158.0 Izohipse
  - Objekt
  - Kanal Natyral
  - Rrethim
  - Mur Rrethues

Porositi :



**Bashkia Shkodër**

Projektoi:

**"LENI-ING" sh.p.k**  
**&**  
**"ANGERBA" sh.p.k**

Adresa: Rr. Uran Pano, Pallati 12 kat, Kati 2  
 Mobile: 0682042270  
 Email: leni-ing@hotmail.com

Objekti: **Rikonstrukcion Rruga "Selim Gjyzezi"**

Faza: **Projekt - Zbatim**

Emërtimi i Fletës: **PLANIMETRIA E RRUGES**

Shkalla: **Sh 1:200**

Tiranë 2023

PL\_(3)



**Bashkia Shkodër**

# PROJEKT ZBATIMI

## RIKONSTRUKSION RRUGA "SELIM GJYREZI"

- 1- Hoorografia
- 2- Topografia e rruges
- 3- Planimetria e rruges
- 4- Profili gjatësor
- 5- Profilat tërthore
- 6- Profili tërthore tip
- 7- Plani i KUZ
- 8- Plani i KUSH
- 8- Sinjalistika rrugore dhe detajet

MIRATOHET  
KRYETARI I BASHKISË  
Z. BARDH SPAHIA

PROJEKTOI:  
"LENI-ING" SH.P.K  
&  
"ANGERBA" SH.P.K

TIRANË 2023



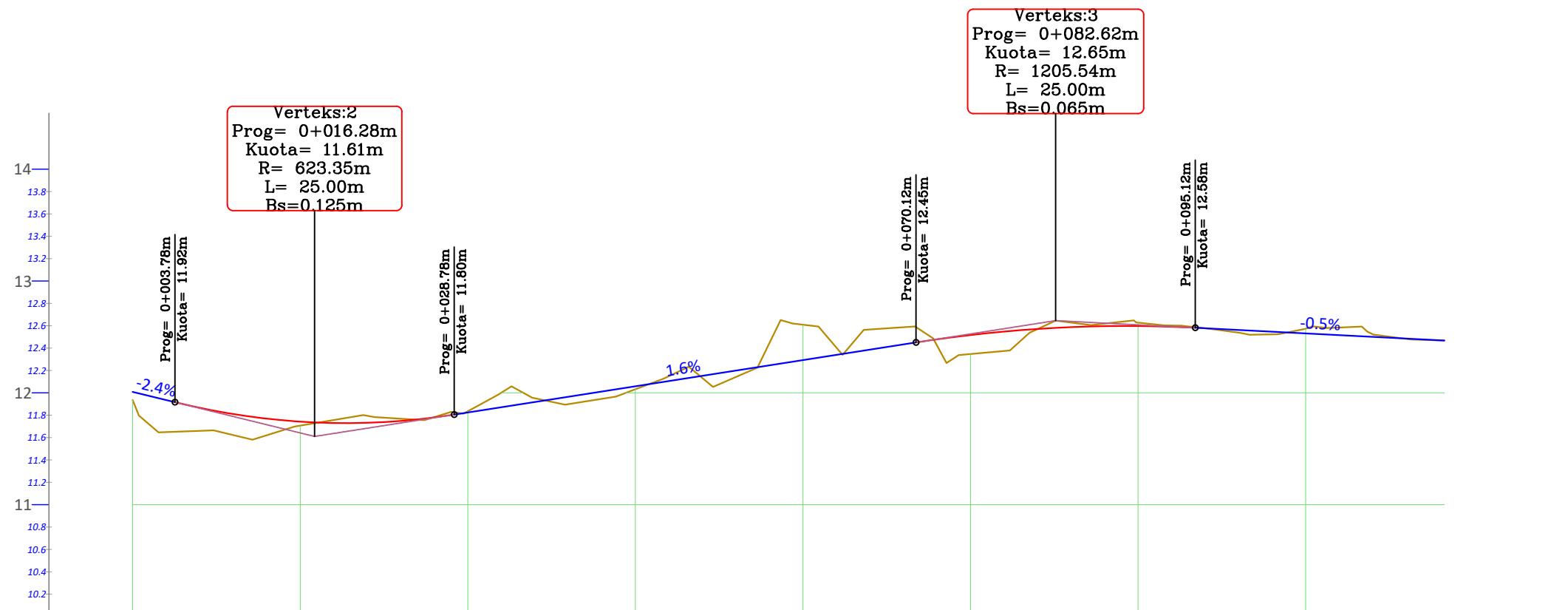

NR I PRERJES	CS - 1	CS - 2	CS - 3	CS - 4	CS - 5	CS - 6	CS - 7	CS - 8	CS - 9
DIST. PJESORE	15.0 m	15.0 m	15.0 m	15.0 m	15.0 m	15.0 m	15.0 m	12.2 m	
DIST. PROGRESIVE	0+000	0+015	0+030	0+045	0+060	0+075	0+090	0+105	0+117
KUOTA TOKES	11.94	11.71	11.83	12.03	12.61	12.35	12.63	12.57	12.47
KUOTA PROJEKTTIT	12.01	11.74	11.82	12.06	12.29	12.52	12.60	12.53	12.47
KUOTA PUNES	0.07	0.04	-0.01	0.03	-0.32	0.17	-0.03	-0.04	0.00
GJEO. VERTIKALE	$i = -2.4\%$	$R = 623.35$ $K = 25.00$	$L = 41.34$ $i = 1.56\%$	$R = 1205.54$ $K = 25.00$	$L = 22.29$ $i = -0.51\%$				
GJEO. HORIZONTALE		$L = 33.70$	$\varphi = 0^{\circ}29'10''$ $L = 1.70$ $R = 200.00$	$L = 26.43$	$\varphi = 0^{\circ}33'39''$ $L = 1.96$ $R = 200.00$	$L = 21.46$	$\varphi = 5^{\circ}06'56''$ $L = 5.80$ $R = 65.00$	$\varphi = 27^{\circ}11'04''$ $L = 2.54$ $R = 6.50$	$L = 20.75$
KILOMETRAZHI	0.01	0.02	0.03	0.04	0.06	0.08	0.09	0.10	0.12

Porositi :



**Bashkia Shkodër**

Projektoi:

**"LENI-ING" sh.p.k**  
&  
**"ANGERBA" sh.p.k**

Adresa: Rr. Uran Pano, Pallati 12 kat, Kati 2  
Mobile: 0682042270  
Email: leni-ing@hotmail.com

Objekti: **Rikonstrukcion Rruga "Selim Gjyzezi"**

Faza: **Projekt - Zbatim**

Emërtimi i Fletës:	Shkalla:	Tiranë 2023
<b>PROFILI GJATESORE</b>	Sh V 1:50 Sh H 1:500	PGJ_01



**Bashkia Shkodër**

# PROJEKT ZBATIMI

## RIKONSTRUKSION RRUGA "SELIM GJYREZI"

- 1- Hoorografia
- 2- Topografia e rruges
- 3- Planimetria e rruges
- 4- Profili gjatësor
- 5- Profilat tërthore
- 6- Profili tërthore tip
- 7- Plani i KUZ
- 8- Plani i KUSH
- 8- Sinjalistika rrugore dhe detajet

MIRATOHET  
KRYETARI I BASHKISË  
Z. BARDH SPAHIA

PROJEKTOI:  
"LENI-ING" SH.P.K







TABELA VOLUMEVE							
PROGRESIVA	SIP. GERMIM	SIP. MBUSHJE	VOL. GERMIM	VOL. MBUSHJE	G. PROGRESIV	M. PROGRESIV	G-M
0+00.00	5.44	0.01	0.00	0.00	0.00	0.00	<b>0.00</b>
0+15.00	5.26	0.00	80.22	0.09	80.22	0.09	<b>80.13</b>
0+30.00	6.11	0.00	85.26	0.02	165.48	0.11	<b>165.37</b>
0+45.00	5.57	0.00	87.64	0.00	253.12	0.11	<b>253.01</b>
0+60.00	7.36	0.00	97.02	0.00	350.14	0.11	<b>350.03</b>
0+75.00	3.54	0.32	81.79	2.38	431.93	2.49	<b>429.44</b>
0+90.00	4.96	0.00	63.72	2.43	495.64	4.92	<b>490.72</b>
1+05.00	5.14	0.00	76.19	0.00	571.83	4.92	<b>566.91</b>
1+17.23	0.00	0.00	31.40	0.00	603.23	4.92	<b>598.32</b>

Porositi :

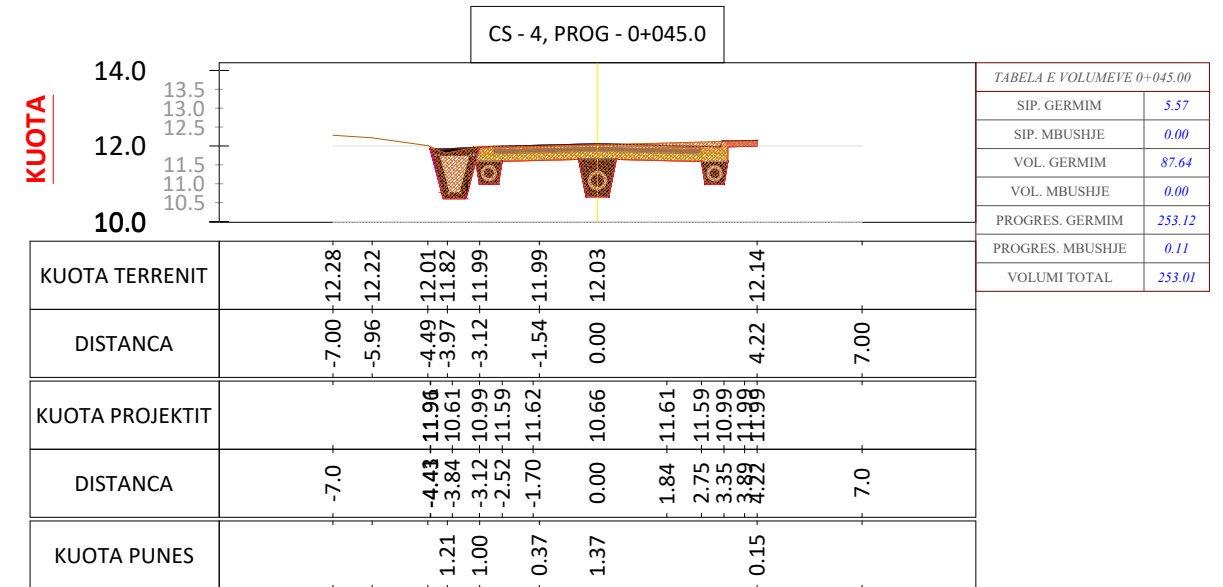
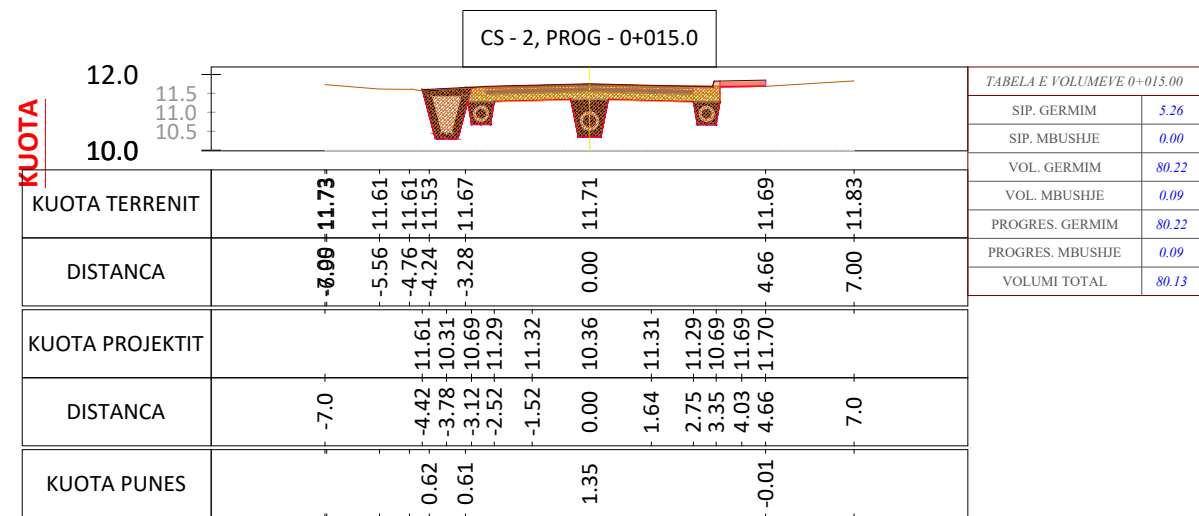
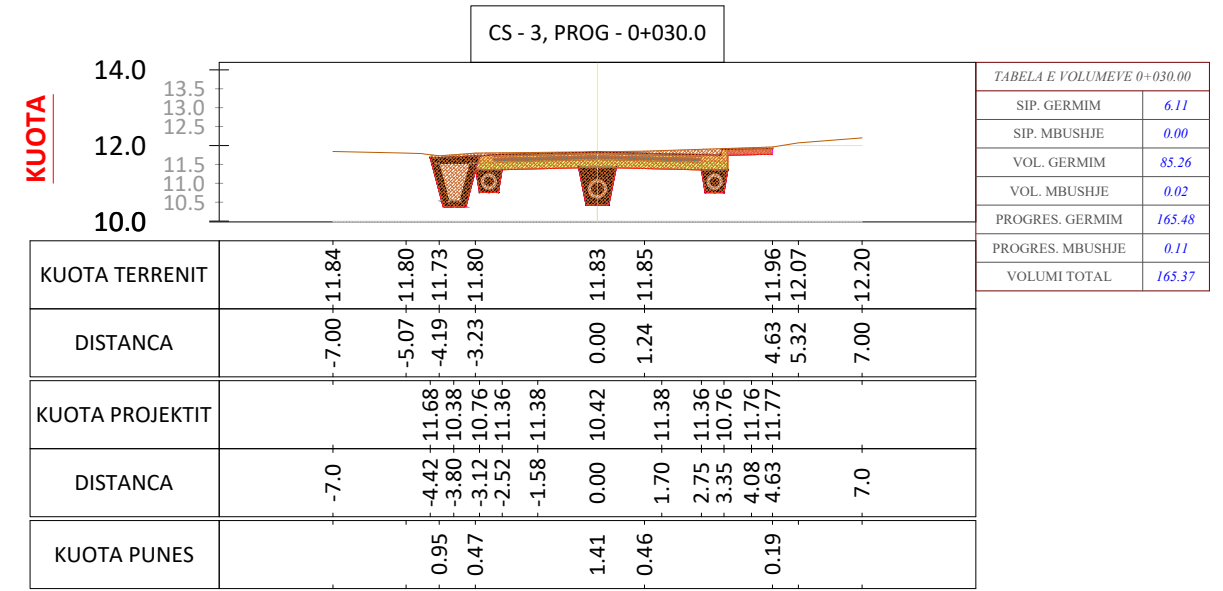
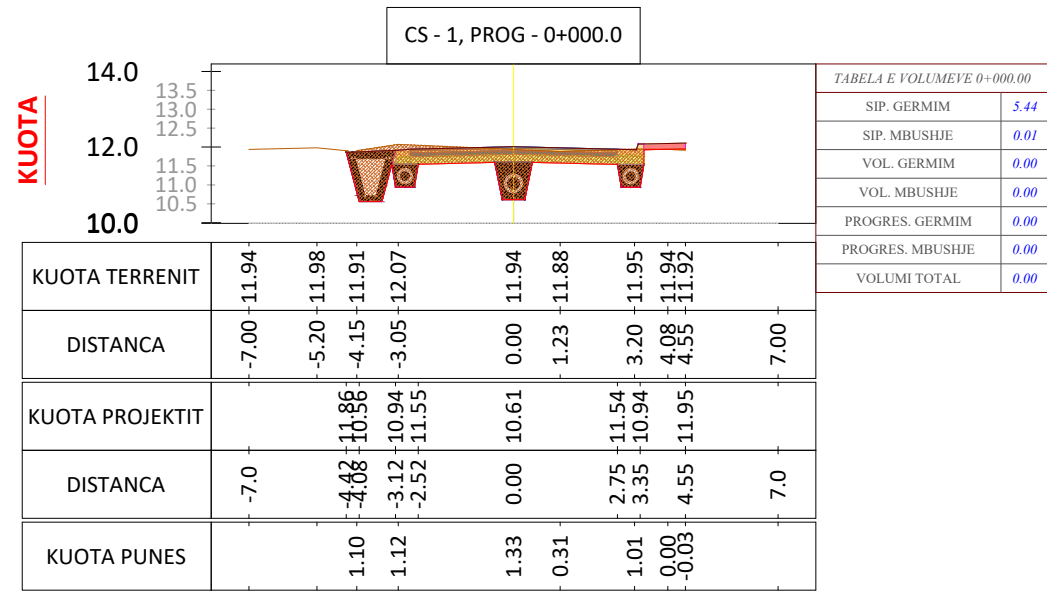

Projektoi:

**"LENI-ING" sh.p.k**  
**&**  
**"ANGERBA" sh.p.k**

Adresa: Rr. Uran Pano, Pallati 12 kat, Kati 2  
 Mobile: 0682042270  
 Email: leni-ing@hotmail.com

Objekti: **Rikonstruksion Rruga "Selim Gjyrezi"**

Faza: **Projekt - Zbatim**

Emërtimi i Fletës:  
**PROFILAT  
 TERTHORE**

Shkalla:  
 Sh 1:200

Tiranë 2023

TV



**Bashkia Shkodër**

# PROJEKT ZBATIMI

## RIKONSTRUKSION RRUGA "SELIM GJYREZI"

- 1- Hoorografia
- 2- Topografia e rruges
- 3- Planimetria e rruges
- 4- Profili gjatësor
- 5- Profilat tërthore
- 6- Profili tërthore tip
- 7- Plani i KUZ
- 8- Plani i KUSH
- 8- Sinjalistika rrugore dhe detajet

MIRATOHET  
KRYETARI I BASHKISË  
Z. BARDH SPAHIA

PROJEKTOI:  
"LENI-ING" SH.P.K  
&  
"ANGERBA" SH.P.K

TIRANË 2023



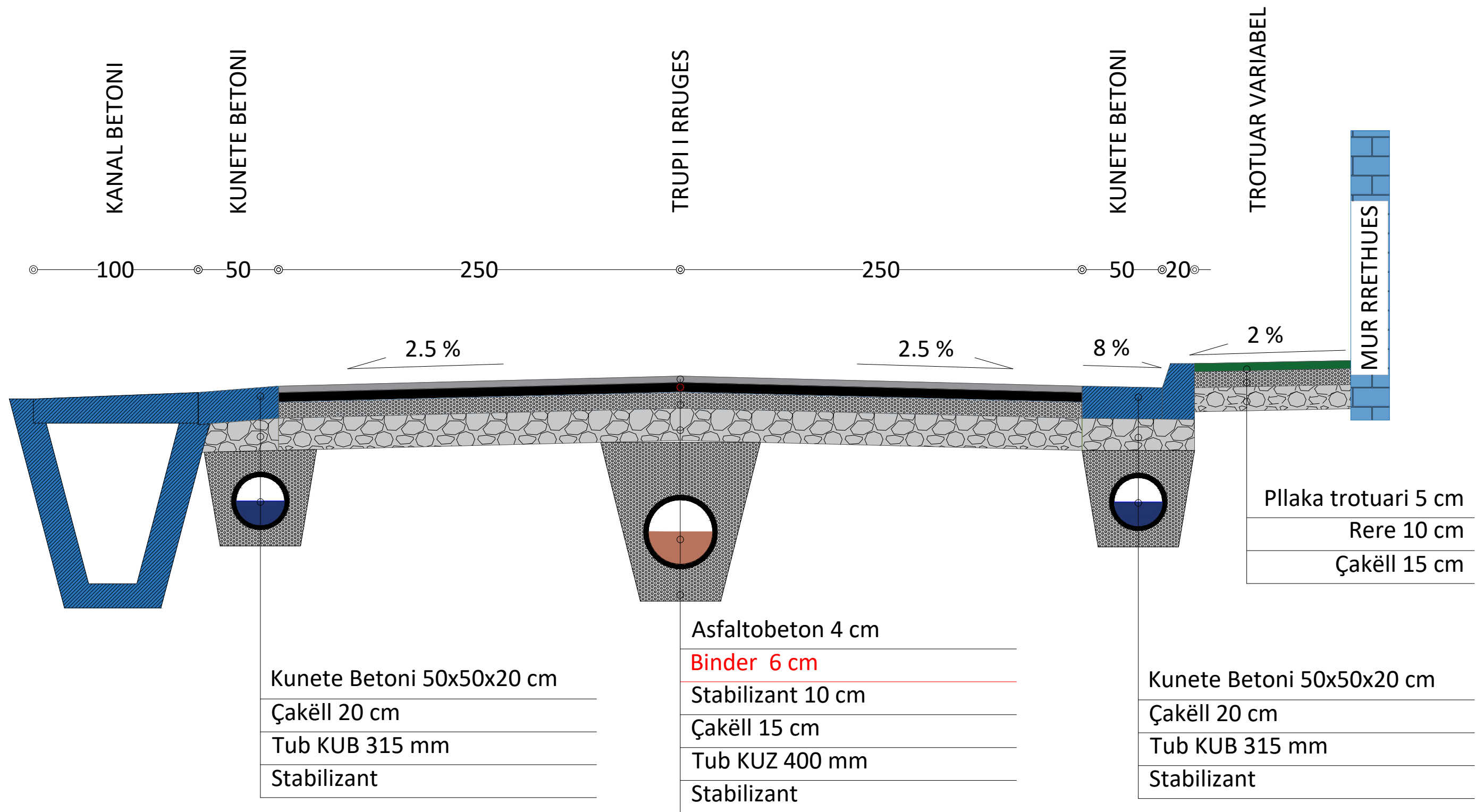

Porositi :



**Bashkia Shkodër**

Projektoi:

**"LENI-ING" sh.p.k**  
&  
**"ANGERBA" sh.p.k**

Adresa: Rr. Uran Pano, Pallati 12 kat, Kati 2  
Mobile: 0682042270  
Email: leni-ing@hotmail.com

Objekti: **Rikonstruksion Rruga "Selim Gjyrezi"**

Faza: **Projekt - Zbatim**

Emërtimi i Fletës:	Shkalla:	Tiranë 2023
<b>PROFILI TERTHORE</b>	Sh 1:25	PT

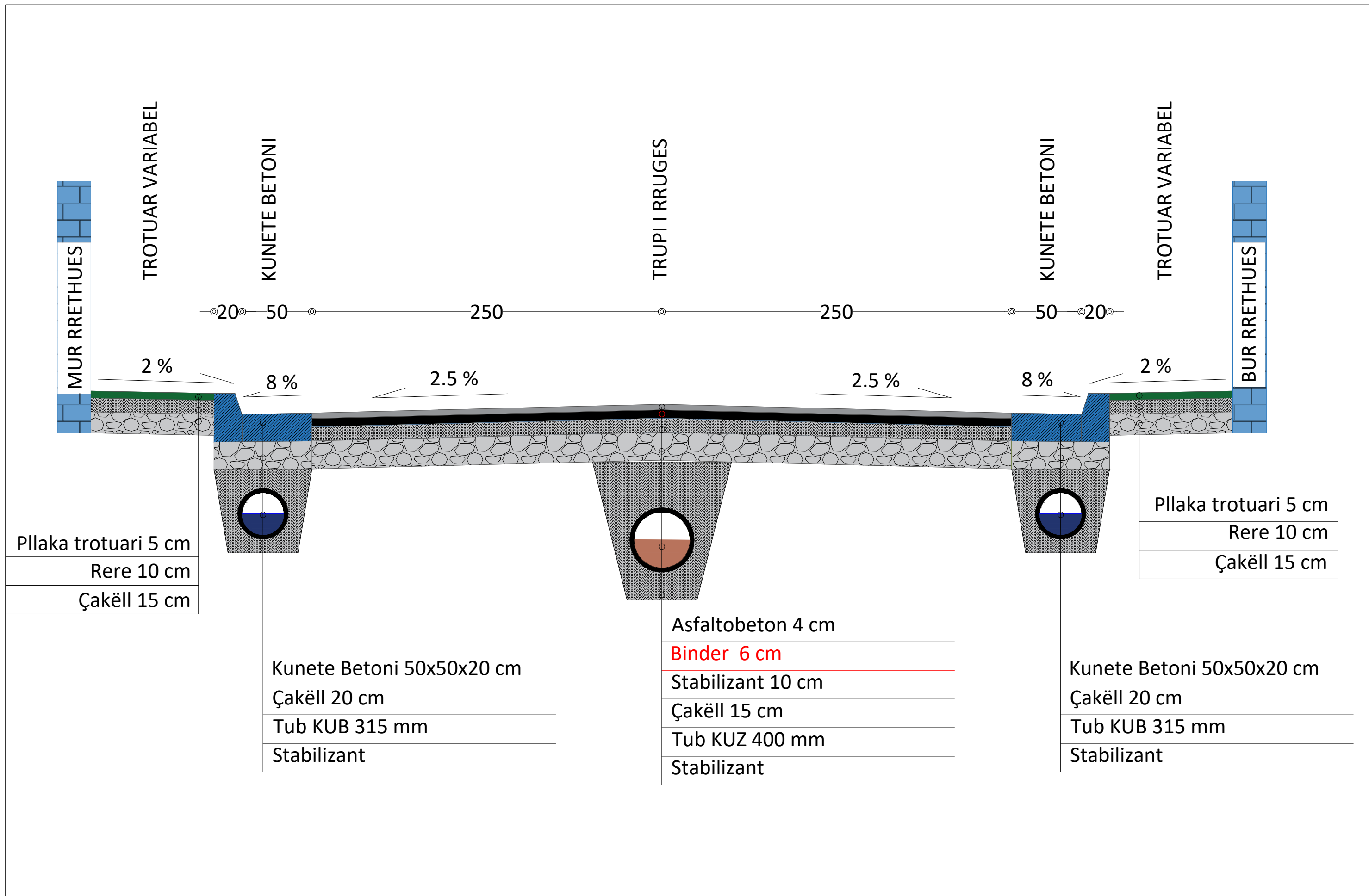



**Bashkia Shkodër**

# PROJEKT ZBATIMI

## RIKONSTRUKSION RRUGA "SELIM GJYREZI"

- 1- Hoorografia
- 2- Topografia e rruges
- 3- Planimetria e rruges
- 4- Profili gjatësor
- 5- Profilat tërthore
- 6- Profili tërthore tip
- 7- Plani i KUZ
- 8- Plani i KUSH
- 8- Sinjalistika rrugore dhe detajet

MIRATOHET  
KRYETARI I BASHKISË  
Z. BARDH SPAHIA

PROJEKTOI:  
"LENI-ING" SH.P.K  
&  
"ANGERBA" SH.P.K

TIRANË 2023



MBARIMI I RRUGES



FILLIMI I RRUGES

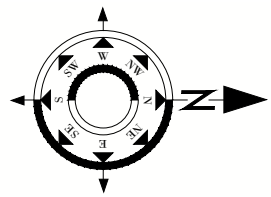

- SHPJEGUES**
- 156.95 Pike detaje
  - 158.0 Izohipse
  - Objekt
  - Kanal Natyral
  - Rrethim
  - Mur Rrethues

Porositi :



**Bashkia Shkodër**

Projektoi:

**"LENI-ING" sh.p.k**  
**&**  
**"ANGERBA" sh.p.k**

Adresa: Rr. Uran Pano, Pallati 12 kat, Kati 2  
 Mobile: 0682042270  
 Email: leni-ing@hotmail.com

Objekti: **Rikonstrukcion Rruga "Selim Gjezi"**

Faza: **Projekt - Zbatim**

Emërtimi i Fletës: <b>PLANIMETRIA KUZ</b>	Shkalla: Sh 1:200	Tiranë 2023 PKUZ
--	----------------------	---------------------

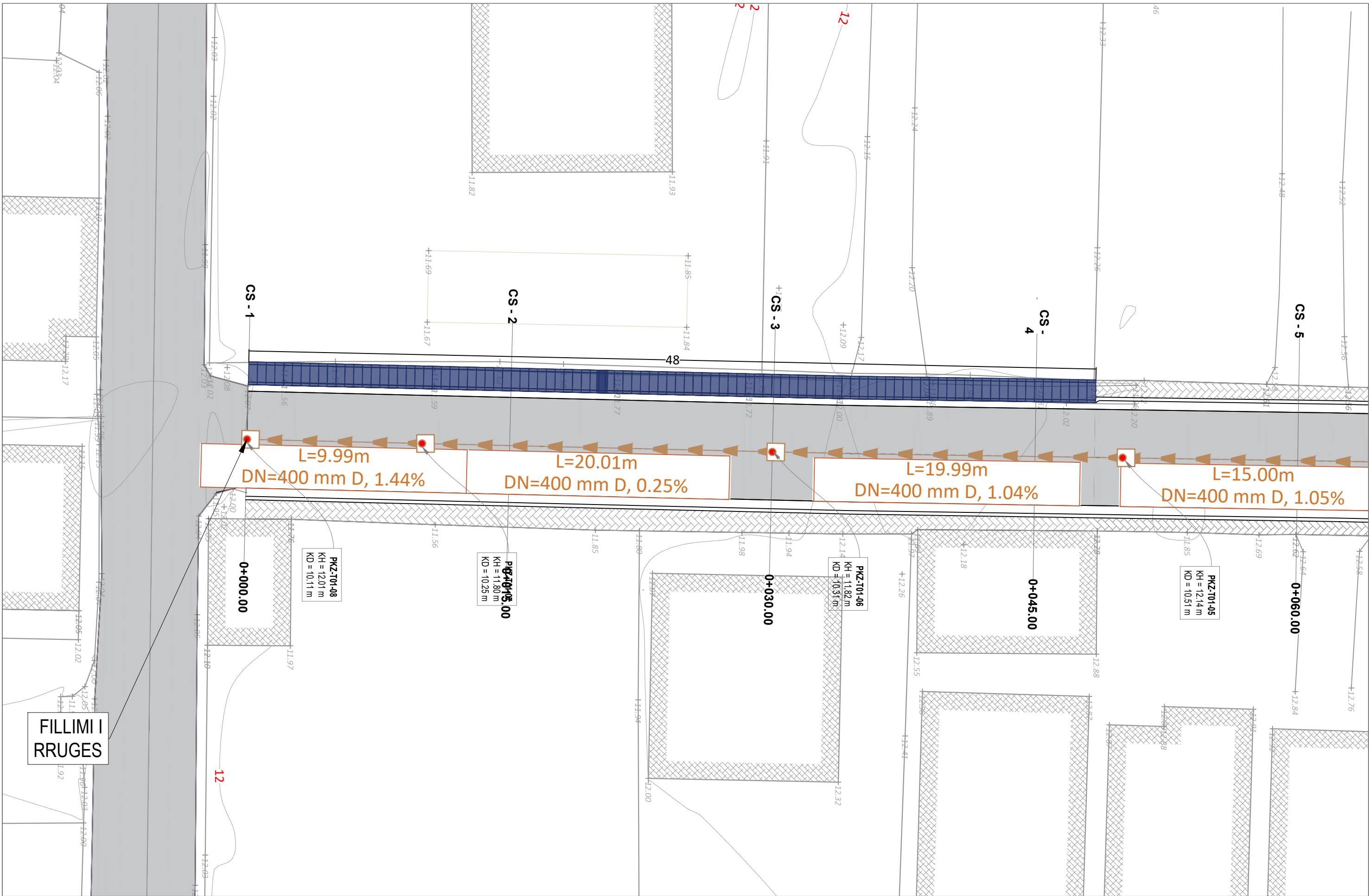

FILLIMI I  
RRUGES

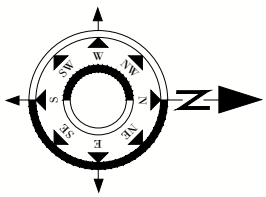

- SHPJEGUES**
- 156.95 Pike detaje
  - 158.0 Izohipse
  - Objekt
  - Kanal Natyral
  - Rrethim
  - Mur Rrethues

Porositi :



**Bashkia Shkodër**

Projektoi:

**"LENI-ING" sh.p.k**  
&  
**"ANGERBA" sh.p.k**

Adresa: Rr. Uran Pano, Pallati 12 kat, Kati 2  
Mobile: 0682042270  
Email: leni-ing@hotmail.com

Objekti: **Rikonstruksion Rruga "Selim Gjyzezi"**

Faza: **Projekt - Zbatim**

Emërtimi i Fletës: <b>PLANIMETRIA KUZ</b>	Shkalla: Sh 1:200	Tiranë 2023 PKUZ_1
--	----------------------	-----------------------



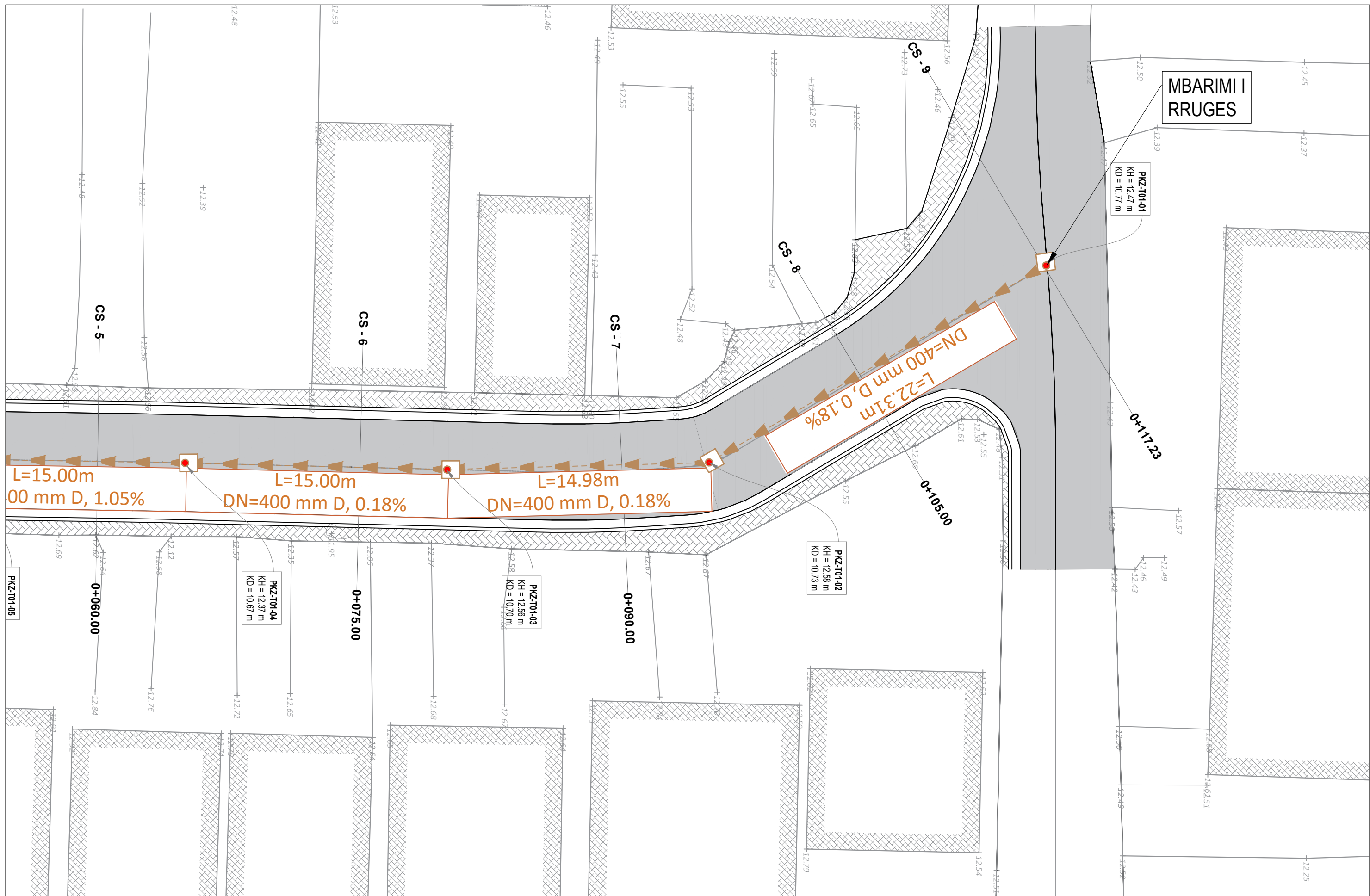

- SHPJEGUES**
- Pike detaje
  - Izohipse
  - Objekt
  - Kanal Natyral
  - Rrethim
  - Mur Rrethues

Porositi :



**Bashkia Shkodër**

Projektoi:

**"LENI-ING" sh.p.k**  
**&**  
**"ANGERBA" sh.p.k**

Adresa: Rr. Uran Pano, Pallati 12 kat, Kati 2  
 Mobile: 0682042270  
 Email: leni-ing@hotmail.com

Objekti: <b>Rikonstrukcion Rruga "Selim Gjyzezi"</b>		
Faza: <b>Projekt - Zbatim</b>		
Emërtimi i Fletës: <b>PLANIMETRIA KUZ</b>	Shkalla: Sh 1:200	Tiranë 2023 <b>PKUZ_2</b>

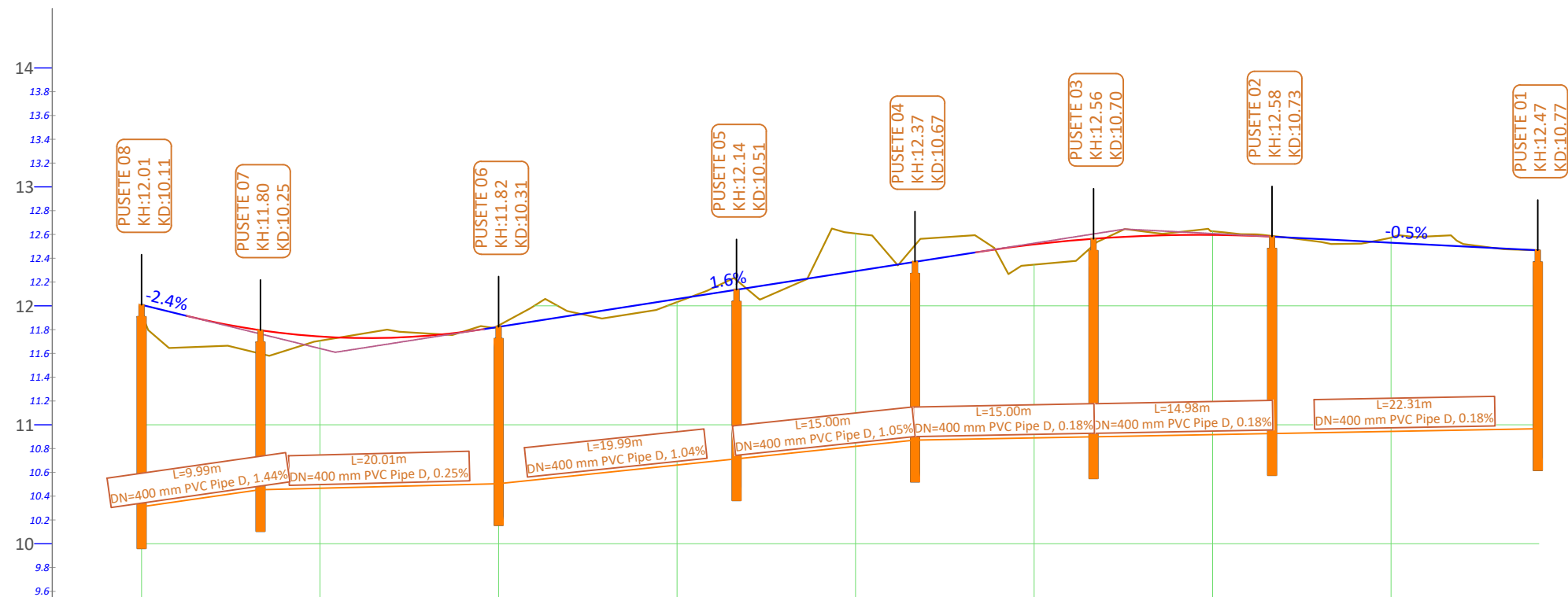

Gjatesia (Li)	L= 10.0m	L= 20.0m	L= 20.0m	L= 15.0m	L= 15.0m	L= 15.0m	L= 22.3m	
Nr.Pusetes	Pusete D=400mm	D=400mm	D=400mm	D=400mm	D=400mm	D=400mm	D=400mm	Pusete 01
Kuote Tubi (Rrjedhes)	10.11m	10.25m	10.31m	10.51m	10.67m	10.70m	10.73m	10.77m
Pjeresia (i%)	i=1.44%	i=0.25%	i=1.04%	i=1.05%	i=0.18%	i=0.18%	i=0.18%	

Porositi :



**Bashkia Shkodër**

Projektoi:

**"LENI-ING" sh.p.k**  
 Liçense: N.2969

Administrator: Nikoll PALUCA

Adresa: Rr. Uran Pano, Pallati 12 kat, Kati 2  
 Mobile: 0682042270  
 Email: leni-ing@hotmail.com

Objekti: **Rikonstruksion Rruga "Selim Gjyzezi"**

Faza: **Projekt - Zbatim**

Emërtimi i Fletës:	Shkalla:	Tiranë 2023
PROFILI GJATESORE KUZ	Sh V 1:50 Sh H 1:500	PGJ_KUZ



PUSETE TIP D=100cm  
PER TUBA (THELLESIA MBI 2.4m)

PRERJA 1-1  
SH.1:50

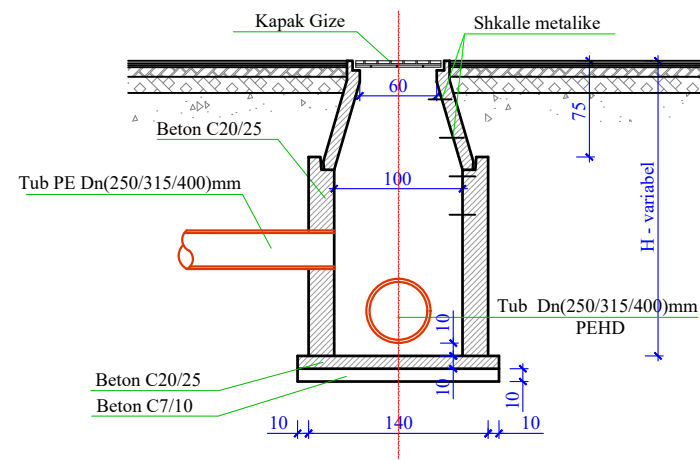

PLAN  
SH.1:50

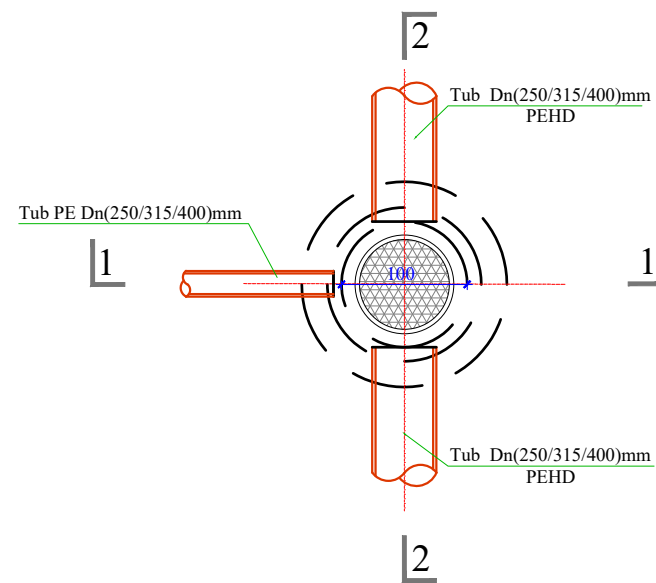

PRERJA 2-2  
SH.1:50

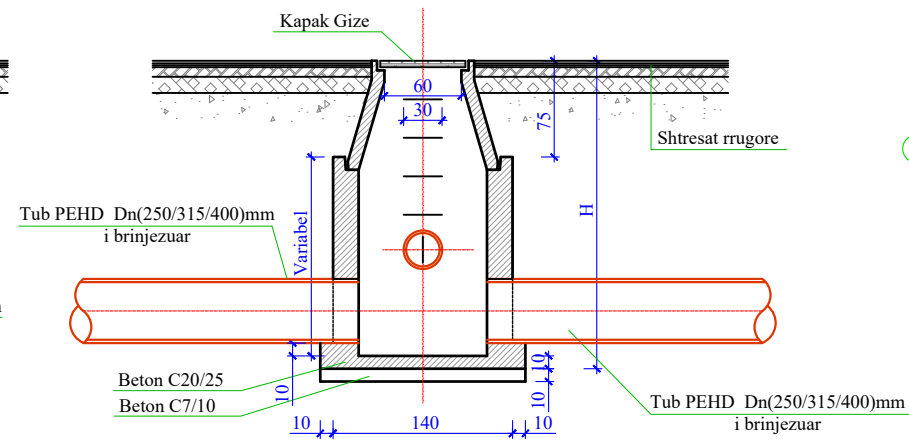

SPIRALI I JASHEM SH.1:20

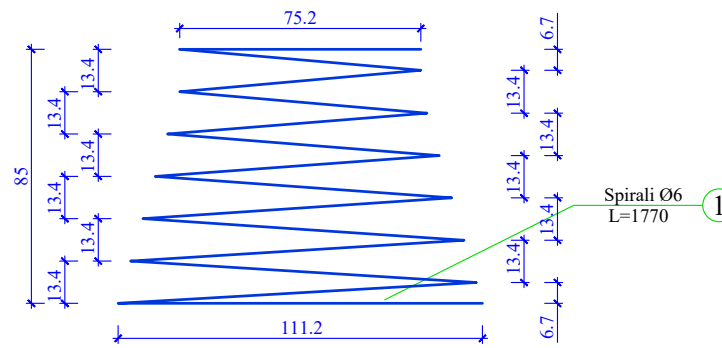

SPIRALI I BRENDESHEM SH.1:20

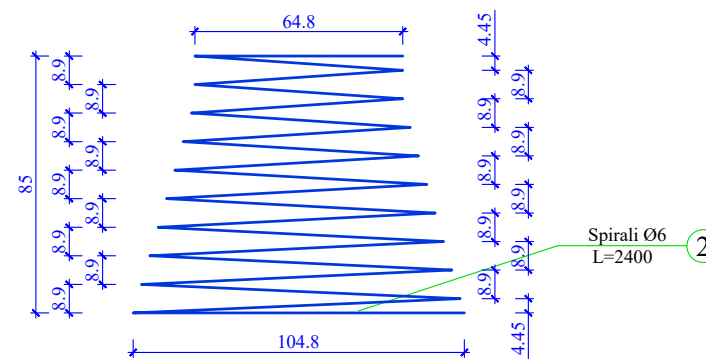

ELEMENT BETONI  
SH.1:20

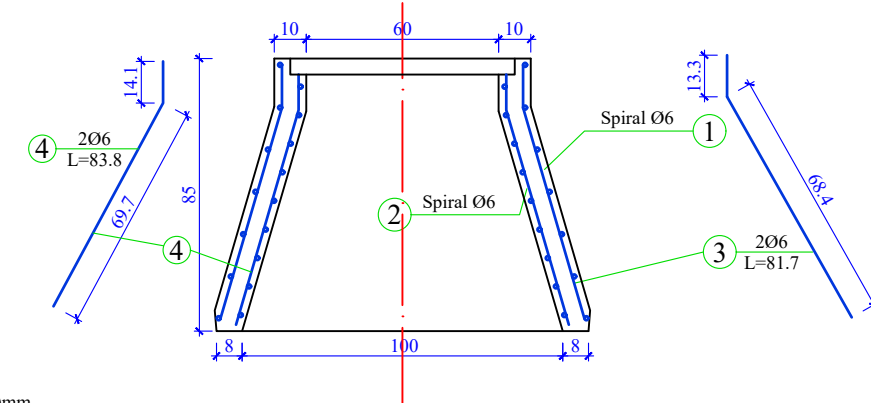

PLAN  
SH.1:20

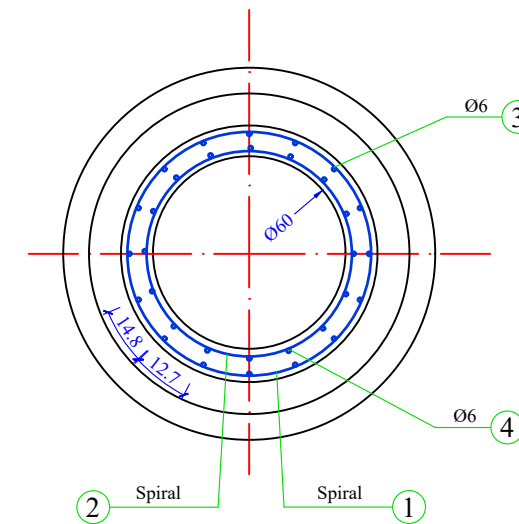

**SHËNIM:**

1. Numri i degëve të kolektorëve dhe pozicionimi i tyre do të merret sipas planimetrisë së rrjetit të K.U.SH.
2. Lartësia e pusëtës do të merret sipas profilit gjatësor të K.U.SH.
3. Për realizimin e pusëtës do të përdoret beton C20/25.
4. Poshtë pusëtës do të vendoset shtresë 10cm beton C7/10 dhe nën të 10cm shtresë çakëll ose zhavor.
5. Kapaku i gizës do të ketë diametër Ø60cm dhe do t'i rezistojë një ngarkese jo më të vogël se 15ton.
6. Detajet janë vizatuar në cm.



**Bashkia Shkodër**

# PROJEKT ZBATIMI

## RIKONSTRUKSION RRUGA "SELIM GJYREZI"

- 1- Hoorografia
- 2- Topografia e rruges
- 3- Planimetria e rruges
- 4- Profili gjatësor
- 5- Profilat tërthore
- 6- Profili tërthore tip
- 7- Plani i KUZ
- 8- Plani i KUSH
- 8- Sinjalistika rrugore dhe detajet

MIRATOHET  
KRYETARI I BASHKISË  
Z. BARDH SPAHIA

PROJEKTOI:  
"LENI-ING" SH.P.K  
&  
"ANGERBA" SH.P.K

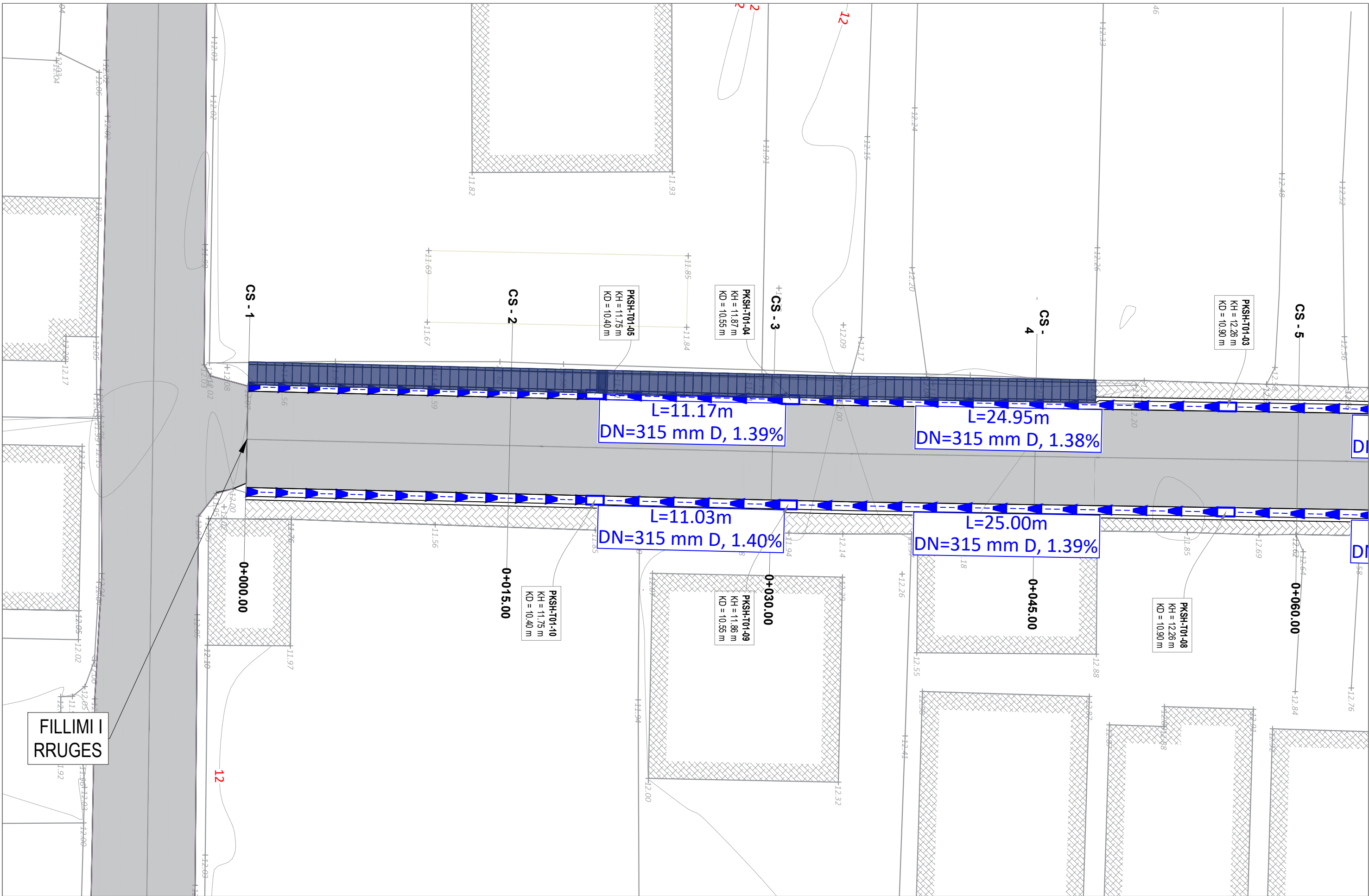

FILLIMI I RRUGES

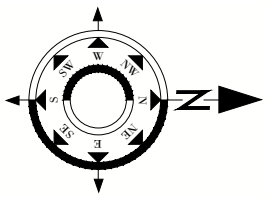

- SHPJEGUES**
- 156.95 Pike detaje
  - 158.0 Izohipse
  - Objekt
  - Kanal Natyral
  - Rrethim
  - Mur Rrethues

Porositi :



**Bashkia Shkodër**

Projektoi:

**"LENI-ING" sh.p.k**  
**&**  
**"ANGERBA" sh.p.k**

Adresa: Rr. Uran Pano, Pallati 12 kat, Kati 2  
 Mobile: 0682042270  
 Email: leni-ing@hotmail.com

Objekti: **Rikonstrukcion Rruga "Selim Gjyzezi"**

Faza: **Projekt - Zbatim**

Emërtimi i Fletës: <b>PLANIMETRIA KUZ</b>	Shkalla: Sh 1:200	Tiranë 2023  PKUSH_1
--	----------------------	----------------------------

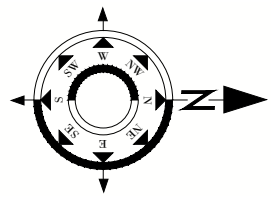
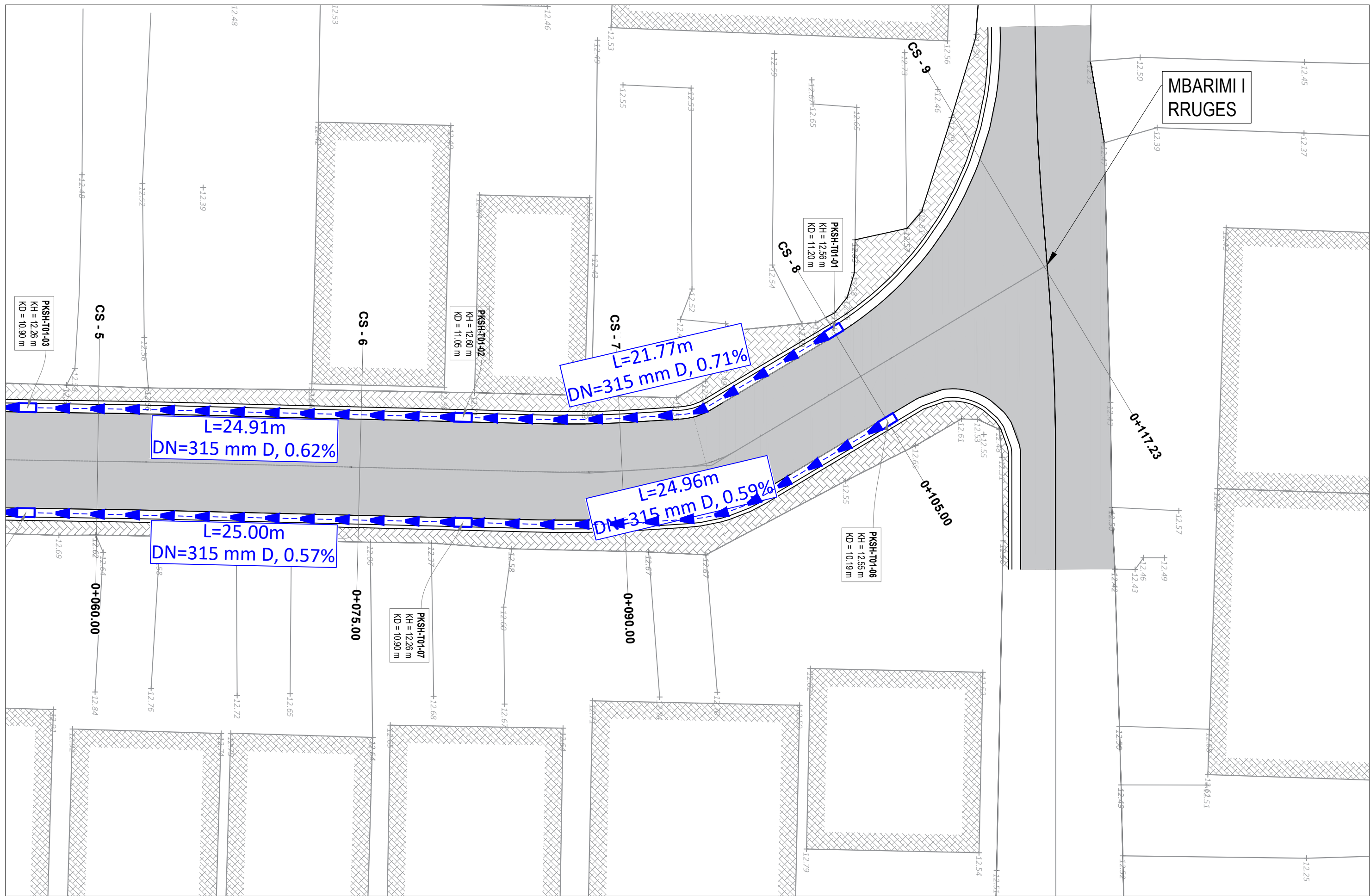

- SHPJEGUES**
- 156.95 Pike detaje
  - 158.0 Izohipse
  - Objekt
  - Kanal Natyral
  - Rrethim
  - Mur Rrethues

Porositi :



**Bashkia Shkodër**

Projektoi:

**"LENI-ING" sh.p.k**  
**&**  
**"ANGERBA" sh.p.k**

Adresa: Rr. Uran Pano, Pallati 12 kat, Kati 2  
 Mobile: 0682042270  
 Email: leni-ing@hotmail.com

Objekti: **Rikonstrukcion Rruga "Selim Gjyzezi"**

Faza: **Projekt - Zbatim**

Emërtimi i Fletës:	Shkalla:	Tiranë 2023
PLANIMETRIA KUZ	Sh 1:200	PKUSH_2



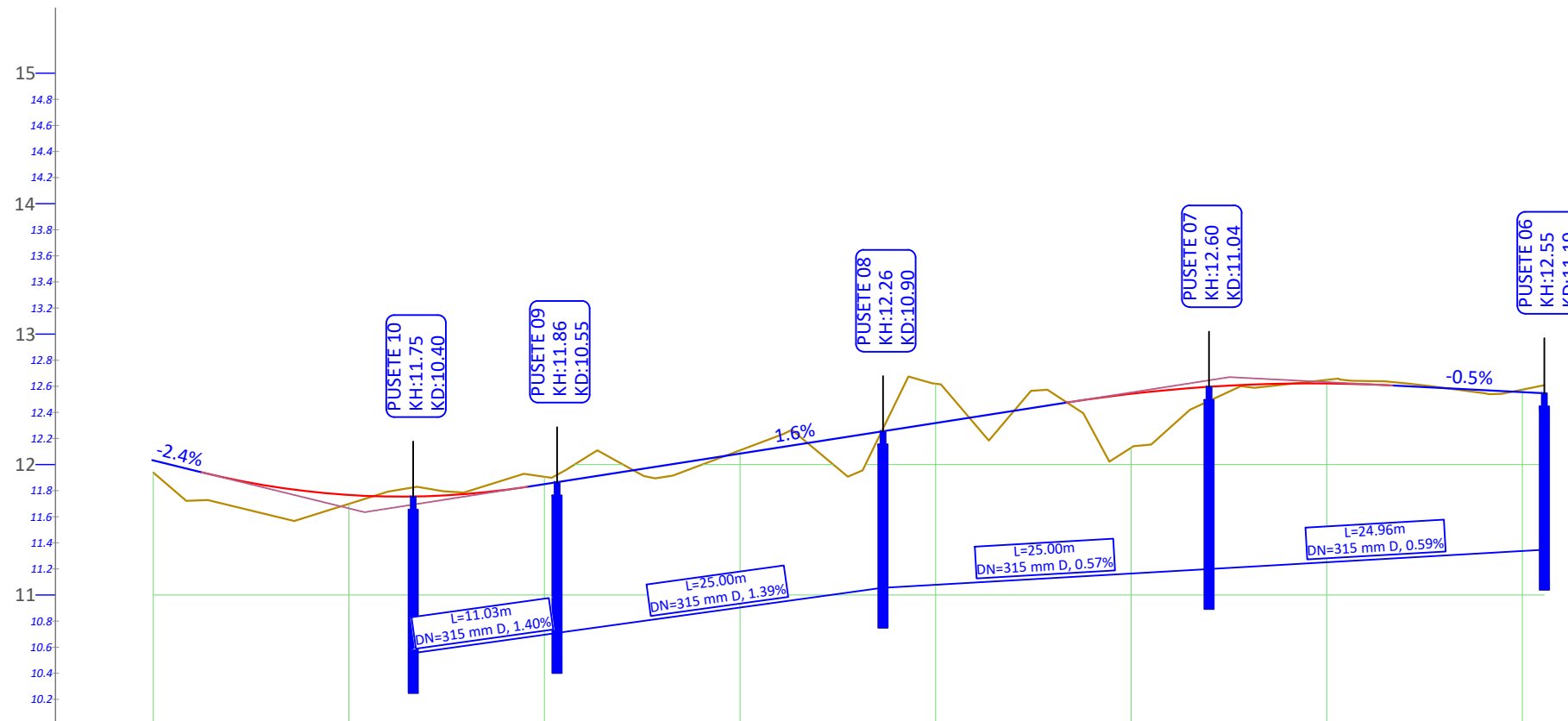

Gjatesia ( $L_i$ )	L= 11.0m	L= 25.0m	L= 25.0m	L= 25.0m	
Nr.Pusetes	D=315mm	D=315mm	D=315mm	D=315mm	
Pjeresia ( $i\%$ )	$i=1.40\%$	$i=1.39\%$	$i=0.57\%$	$i=0.59\%$	
Kuote Tubi (Rrjedhes)	10.40m	10.55m	10.90m	11.04m	11.19m

Porositi :



**Bashkia Shkodër**

Projektoi:

**"LENI-ING" sh.p.k**  
 Liçense: N.2969

Administrator: Nikoll PALUCA

Adresa: Rr. Uran Pano, Pallati 12 kat, Kati 2  
 Mobile: 0682042270  
 Email: leni-ing@hotmail.com

Objekti: **Rikonstruksion Rruga "Selim Gjyzezi"**

Faza: **Projekt - Zbatim**

Emërtimi i Fletës:	Shkalla:	Tiranë 2023
PROFILI GJATESORE KUSH	Sh V 1:50 Sh H 1:500	PGJ_KUSH

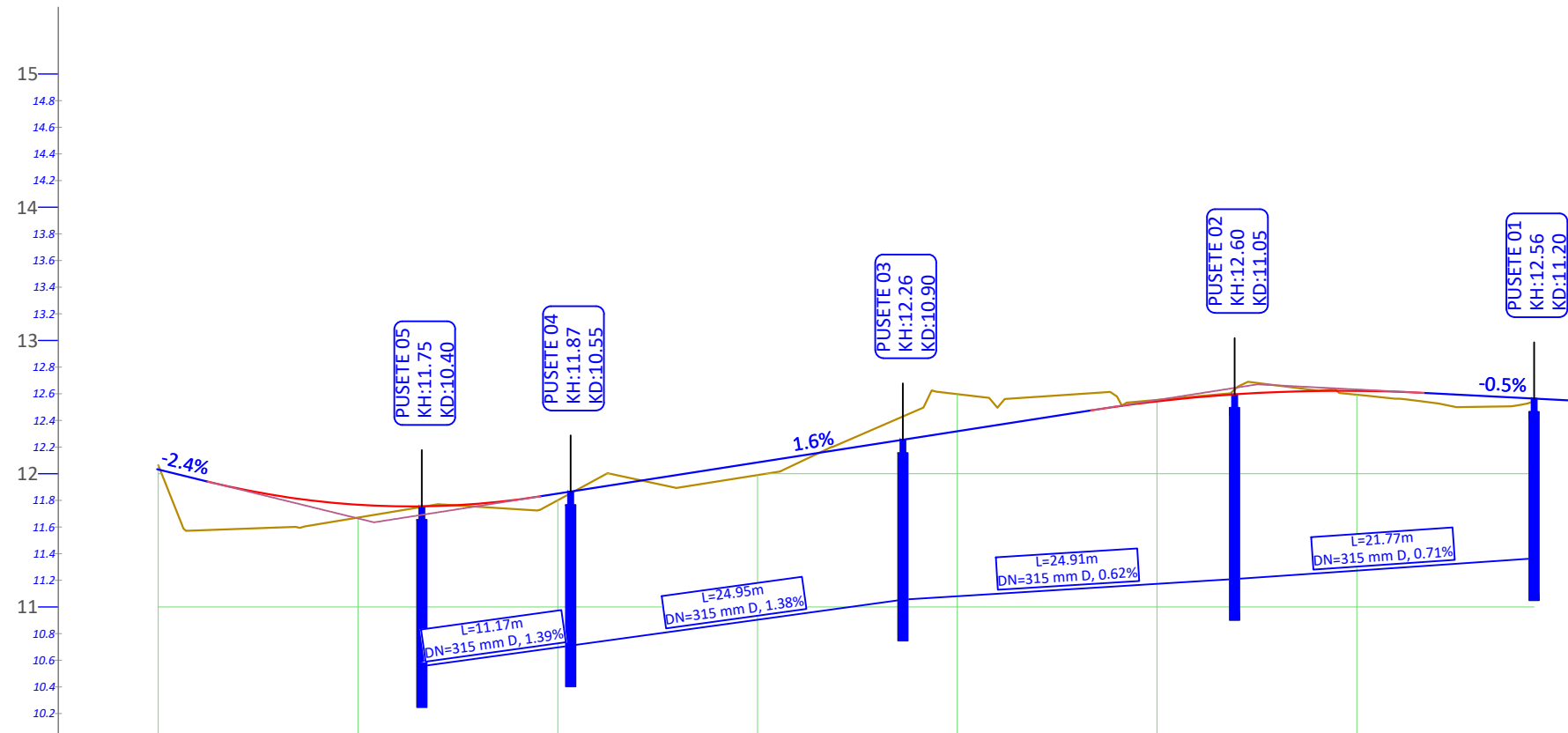

Gjatesia (Li)	L= 11.2m	L= 25.0m	L= 24.9m	L= 21.8m
Nr.Pusetes	Pusetete 05	Pusetete 04	Pusetete 03	Pusetete 02
Pjeresia (i%)	D=315mm	D=315mm	D=315mm	D=315mm
Kuote Tubi (Rrjedhes)	i=1.39%	i=1.38%	i=0.62%	i=0.71%
	10.40m	10.55m 10.55m	10.90m 10.90m	11.05m 11.05m
				11.21m

Porositi :



**Bashkia Shkodër**

Projektoi:

**"LENI-ING" sh.p.k**  
 Liçense: N.2969  
 Administrator: Nikoll PALUCA

Adresa: Rr. Uran Pano, Pallati 12 kat, Kati 2  
 Mobile: 0682042270  
 Email: leni-ing@hotmail.com

Objekti: **Rikonstruksion Rruga "Selim Gjyrezi"**

Faza: **Projekt - Zbatim**

Emërtimi i Fletës:	Shkalla:	Tiranë 2023
PROFILI GJATESORE KUSH	Sh V 1:50 Sh H 1:500	PGJ_KUSH 1

**PUSETE KONTROLI PER UJRAT E SHIUT  
SH 1:25**

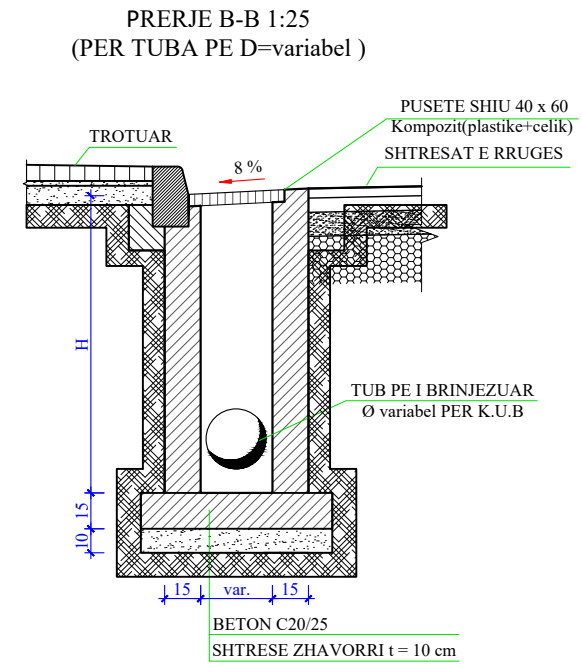
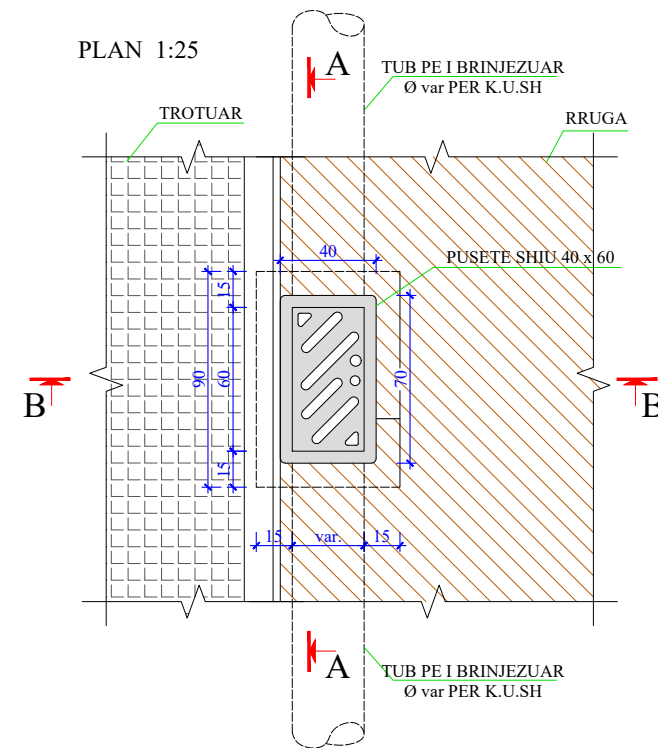

**PRERJE TERTHORE KANALI PER TUBACIONET K.U.SH  
SH 1:25**

Tubacion PEHD i brinjezuar D 315 mm

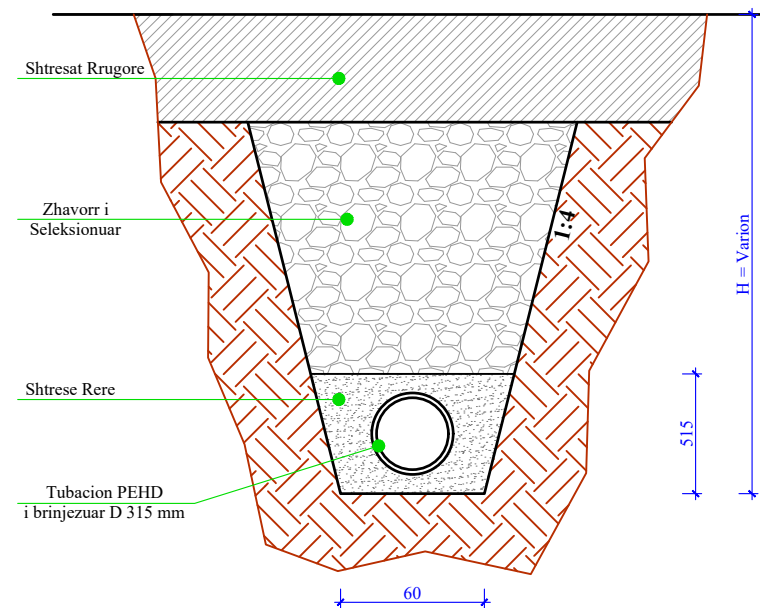

PRERJE A-A 1:25

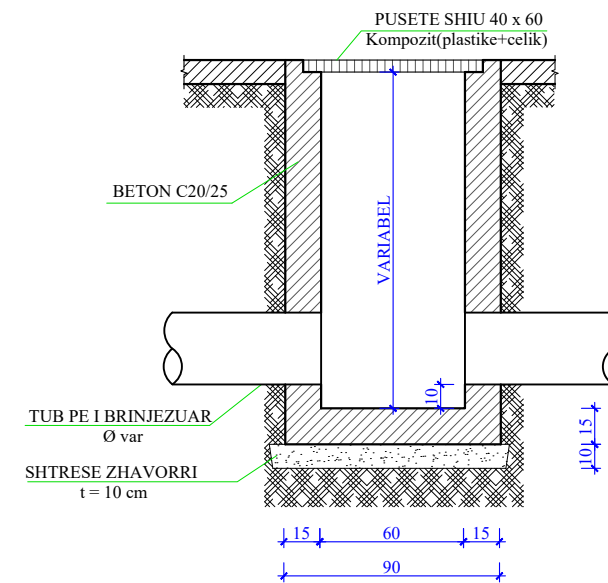

Porositi :



Projektoi:

"LENI-ING" sh.p.k  
Liqense: N.2969

Administrator: Nikoll PALUCA

Adresa: Rr. Uran Pano, Pallati 12 kat, Kati 2  
Mobile: 0682042270  
Email: leni-ing@hotmail.com

Objekti: **Rikonstruksion Rruga "LULAJ"**

Faza: **Projekt - Zbatim**

Emërtimi i Fletës:  
**DETAJE KUSH**

Shkalla:  
Sh 1:200

Tiranë 2023

KUSH



**Bashkia Shkodër**

# PROJEKT ZBATIMI

## RIKONSTRUKSION RRUGA "SELIM GJYREZI"

- 1- Hoorografia
- 2- Topografia e rruges
- 3- Planimetria e rruges
- 4- Profili gjatësor
- 5- Profilat tërthore
- 6- Profili tërthore tip
- 7- Plani i KUZ
- 8- Plani i KUSH
- 9- Sinjalistika rrugore dhe detajet

MIRATOHET  
KRYETARI I BASHKISË  
Z. BARDH SPAHIA

PROJEKTOI:  
"LENI-ING" SH.P.K  
&  
"ANGERBA" SH.P.K

TIRANË 2023



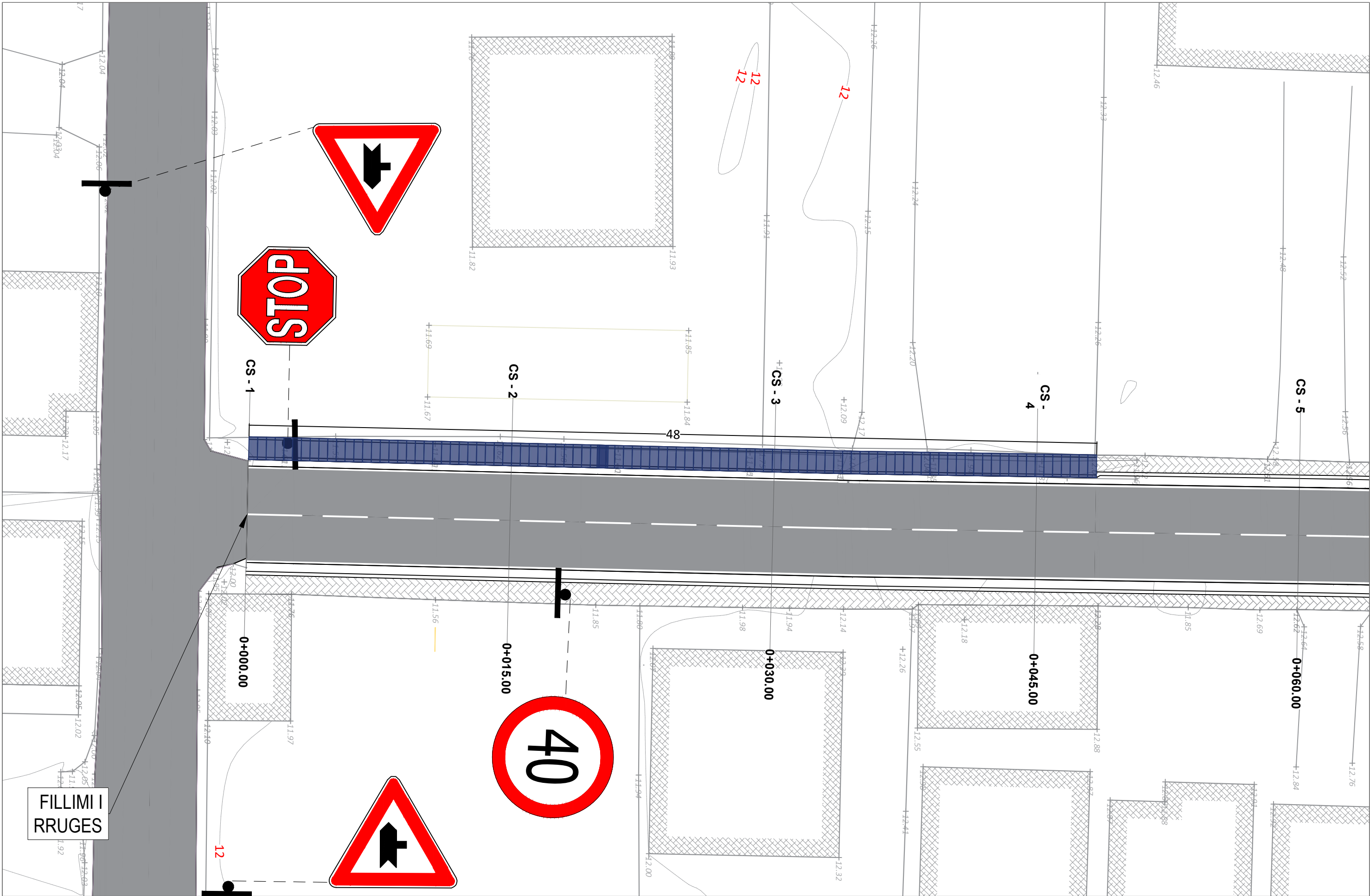

FILLIMI I RRUGES

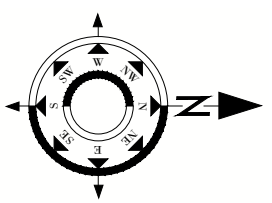

- SHPJEGUES**
- 156.95 Pike detaje
  - 158.0 Izohipse
  - Objekt
  - Kanal Natyral
  - Rrethim
  - Mur Rrethues

Porositi :



**Bashkia Shkodër**

Projektoi:

**"LENI-ING" sh.p.k**  
**&**  
**"ANGERBA" sh.p.k**

Adresa: Rr. Uran Pano, Pallati 12 kat, Kati 2  
 Mobile: 0682042270  
 Email: leni-ing@hotmail.com

Objekti: <b>Rikonstrukcion Rruga "Selim Gjyzezi"</b>		
Faza: <b>Projekt - Zbatim</b>		
Emërtimi i Fletës: <b>PLANIMETRIA KUZ</b>	Shkalla: Sh 1:200	Tiranë 2023 PSI_1

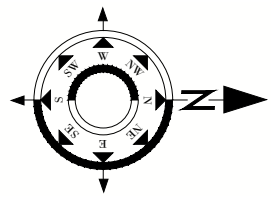
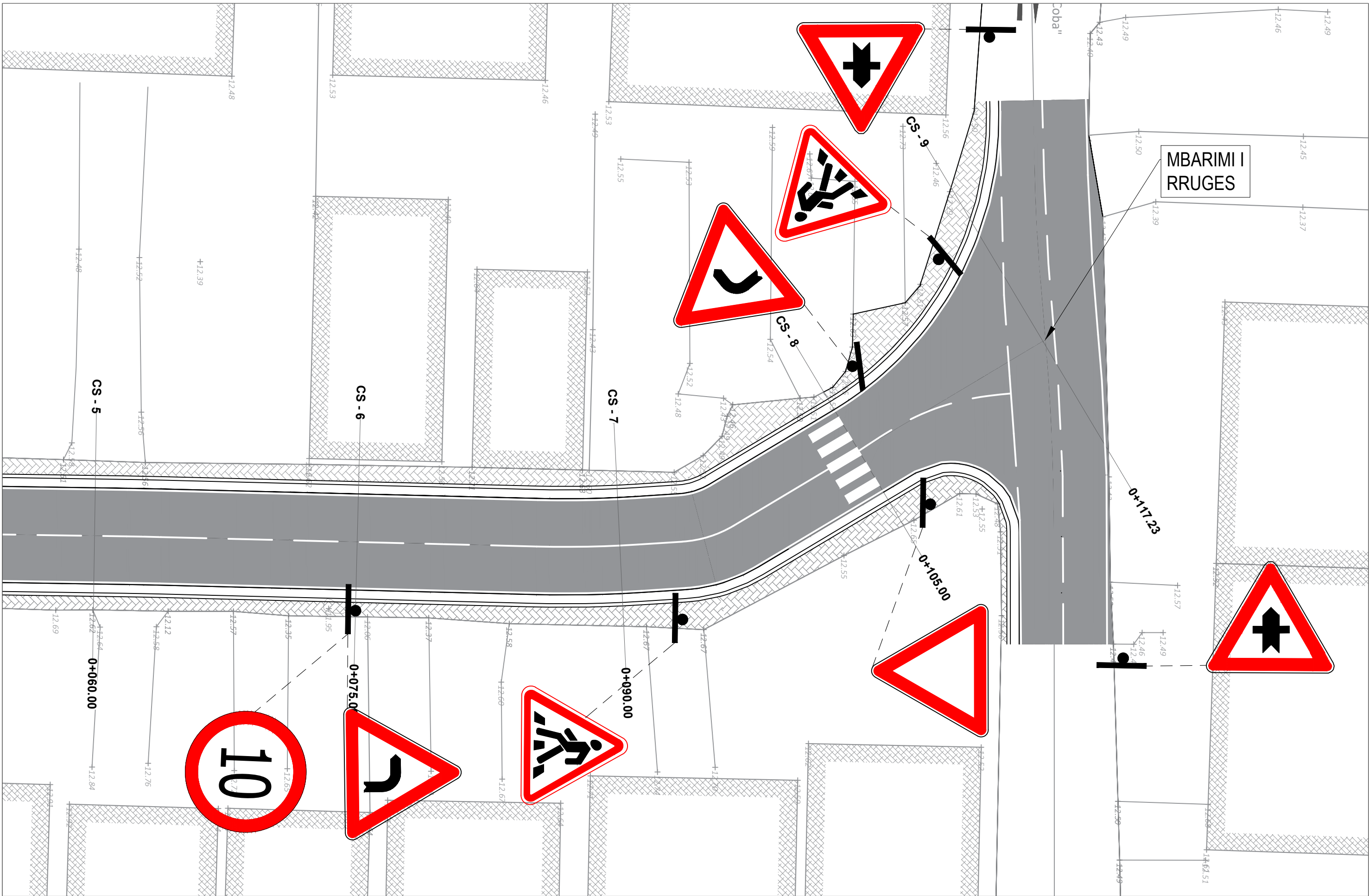

- SHPJEGUES**
- 156.95 Pike detaje
  - 158.0 Izohipse
  - Objekt
  - Kanal Natyral
  - Rrethim
  - Mur Rrethues

Porositi :



**Bashkia Shkodër**

Projektoi:

**"LENI-ING" sh.p.k**  
**&**  
**"ANGERBA" sh.p.k**

Adresa: Rr. Uran Pano, Pallati 12 kat, Kati 2  
 Mobile: 0682042270  
 Email: leni-ing@hotmail.com

Objekti: <b>Rikonstrukcion Rruga "Selim Gjyzezi"</b>		
Faza: <b>Projekt - Zbatim</b>		
Emërtimi i Fletës: <b>PLANIMETRIA KUZ</b>	Shkalla: Sh 1:200	Tiranë 2023 <b>PSI_2</b>

# PERMASAT E TABELAVE RRUGORE

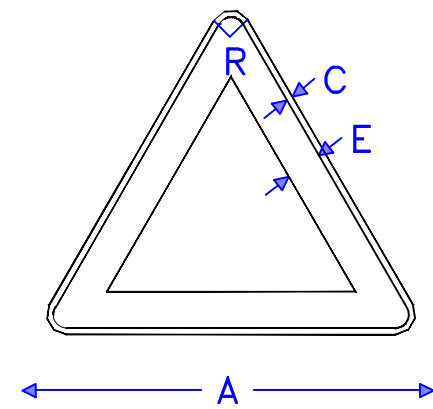

A	C	E	R
90	1.5	8	4.5

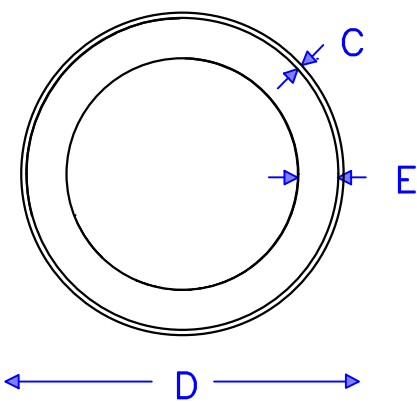

C	D	E
1	60	7.5

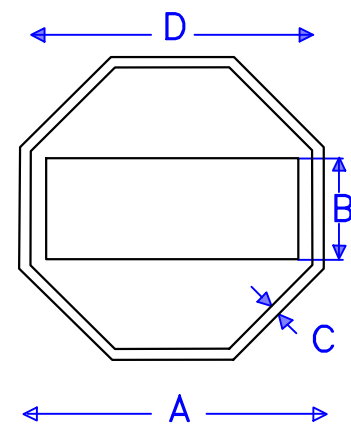

A	C	E	D
90	30	3	75
Dim vogel			
60	20	2	50

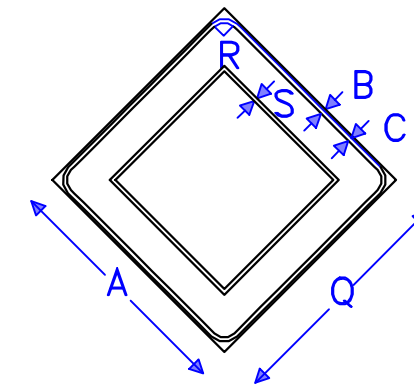

A	B	C	Q	R	S
60	0.5	1	40	3.5	11

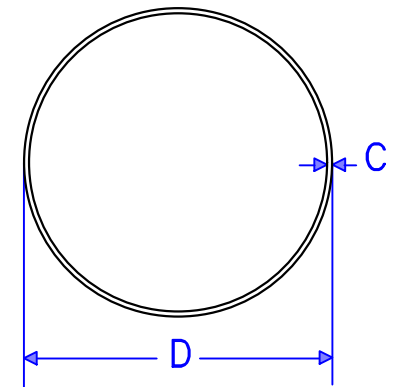

C	D
1	60
Dim vogel	
0.8	40

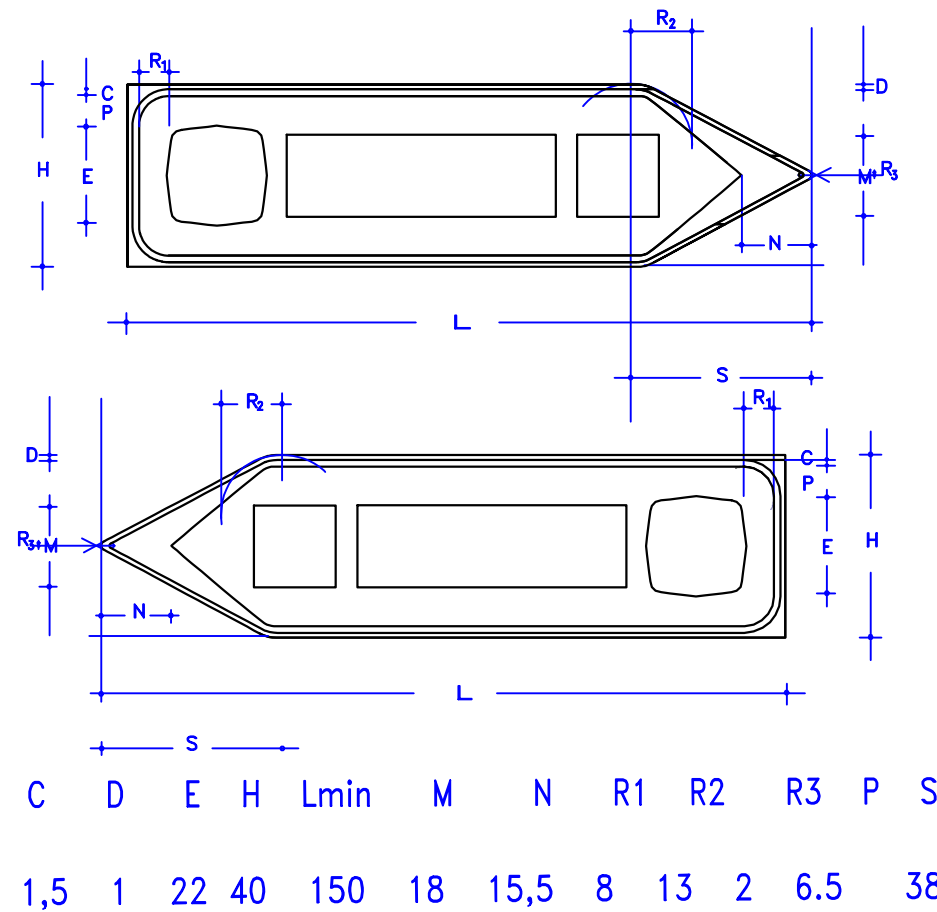

## TABELA KUADRATIKE

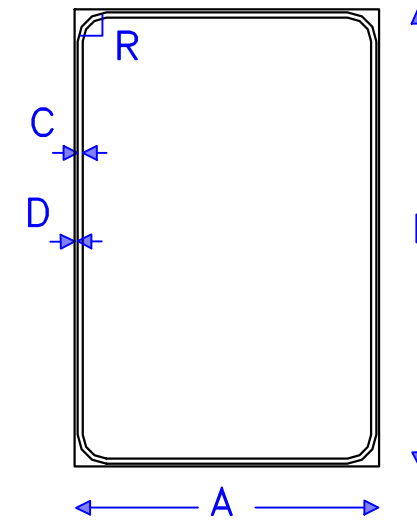

A	B	C	D	R
90	135	1.6	0.8	7
90	135	1.6	0.8	7

Modular i tabelave terkendore

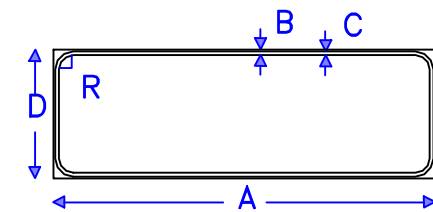

A	B	C	D	R
80	0.4	0.8	27	3

Porositi :



Projektoi:

"LENI-ING" sh.p.k  
Liçense: N.2969

Administrator: Nikoll PALUCA

Adresa: Rr. Uran Pano, Pallati 12 kat, Kati 2  
Mobile: 0682042270  
Email: leni-ing@hotmail.com

Objekti: Rikonstruksion Rruga "Selim Gjyzezi"

Faza: Projekt - Zbatim

Emërtimi i Fletës:  
DETAJE  
TABELASH

Shkalla:

Tiranë 2023

DS (2)

# VENDOSJA E TABELAVE RRUGORE

