

Stacioni i Pompave Ekzistues Shk 1:50

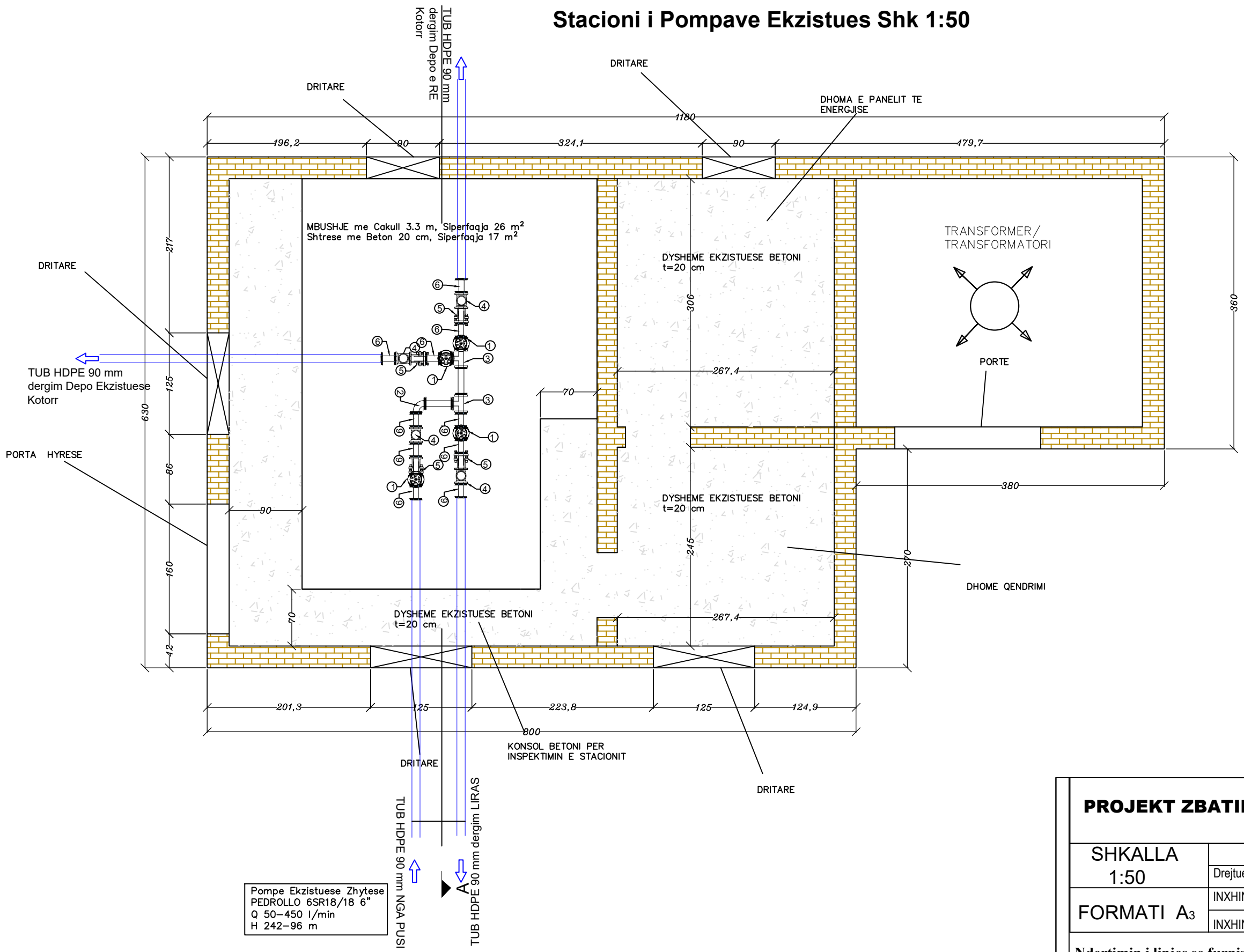

Pompe Ekzistuese Zhytuese
 PEDROLLO 6SR18/18 6"
 Q 50-450 l/min
 H 242-96 m

LEGJENDA	
	Struktura St. Pompave Ekzistues
	Tubacione Hidraulike
	Dritare ekzistuese
	Toke natyrore
	Cakull
	Beton i varfer
	Beton C25/30
	Bar
	Mur tulle t = 25 cm
	Strukture ekzistuese betoni

LEGJENDA	
	1—SARACINESKE
	2—BRRYL 90°
	3—Tee
	4—Mates Uji
	5—Valvul Moskthimi
	6—Pjese / Nyje Cmontuese

PROJEKT ZBATIMI		 INVESTITORI: SH.A. UJESJELLES GRAMSH PROJEKTUESI: HYDROWATER-ALBANIA	
SHKALLA 1:50	Drejtimes teknik. Hidro	G.PUSTINA	PRILL 2021
	INXHINIER. Hidroteknik	J.BETI	NR I VIZATIMIT
FORMATI A3	INXHINIER.Gjeodet	B. ISUFATI	GR-DET-KOT-STC-A3-01
	Ndertimin i linjes se furnizim me uje i fshatrave Kotorr, Liras, Stror, Bashkia Gramsh		

PRERJA A-A Shk 1:50

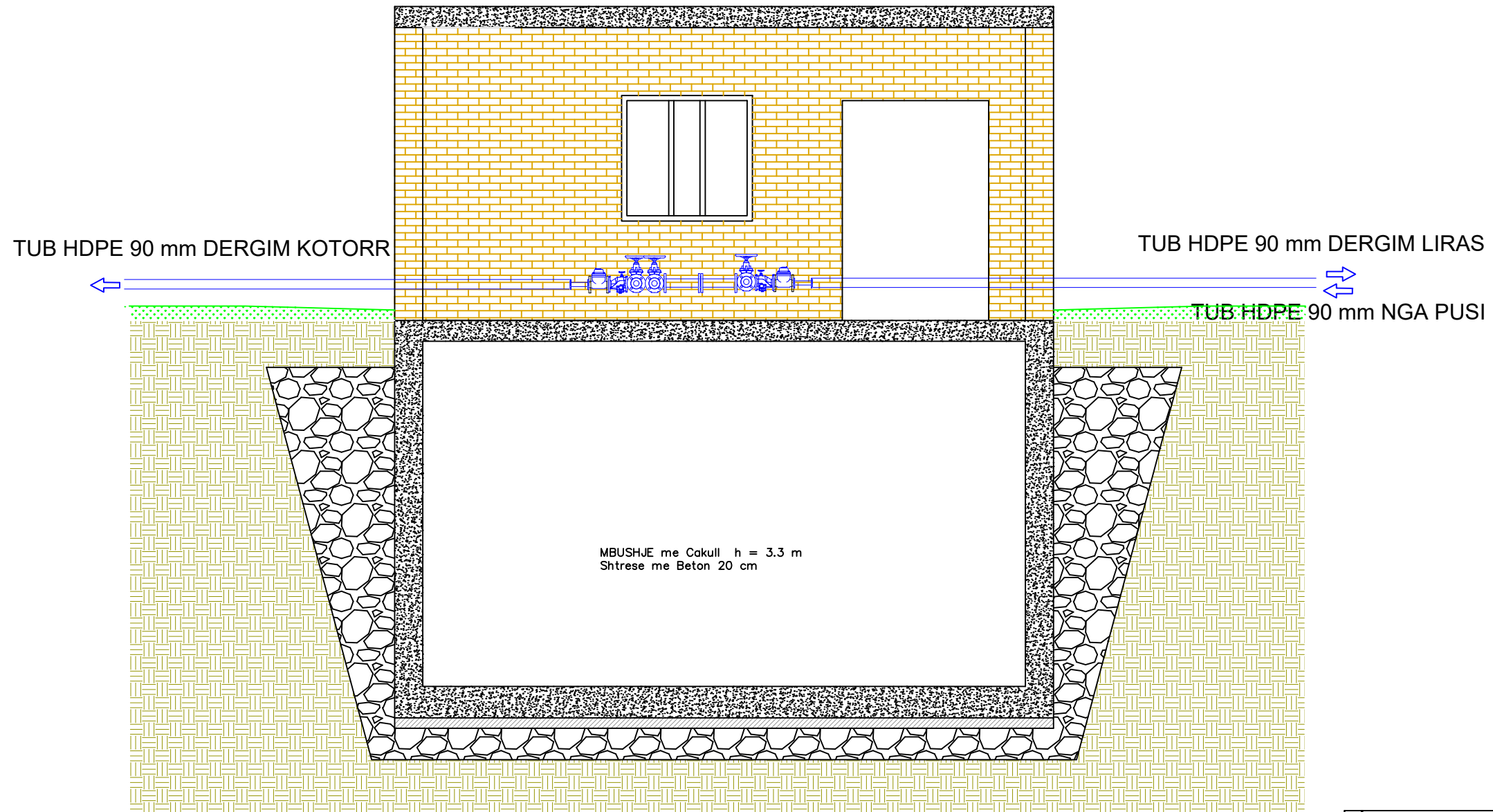

LEGJENDA	
	Struktura St. Pompave Ekzistues
	Tubacione Hidraulike
	Dritare ekzituese
	Toke natyrore
	Cakull
	Beton i varfer
	Beton C25/30
	Bar
	Mur tulle t = 25 cm
	Strukture ekzistuese betoni

PROJEKT ZBATIMI

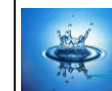

INVESTITORI: SH.A. UJESJELLES GRAMSH

PROJEKTUESI: HYDROWATER-ALBANIA

SHKALLA
1:50

Drejtues teknik. Hidro

G.PUSTINA

PRILL 2021

FORMATI A₃

INXHINIER. Hidroteknik

J.BETI

NR I VIZATIMIT

INXHINIER.Gjeodet

B. ISUFATI

GR-DET-KOT-STC-A3-02

Ndertimin i linjes se furnizim me uje i fshatrave Kotorr, Liras, Stror, Bashkia Gramsh

DETAJE RRETHIMI SHK 1:30

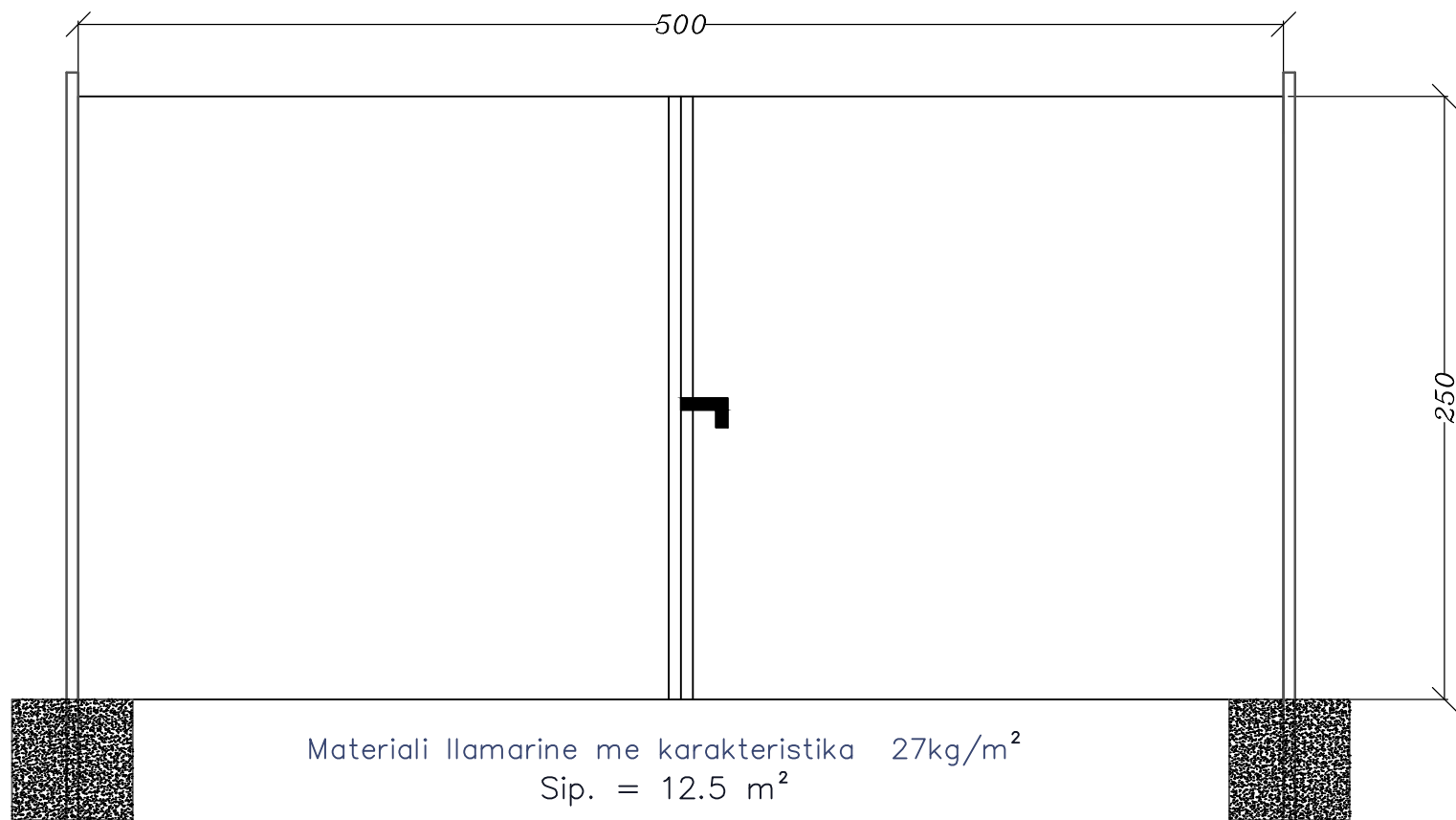
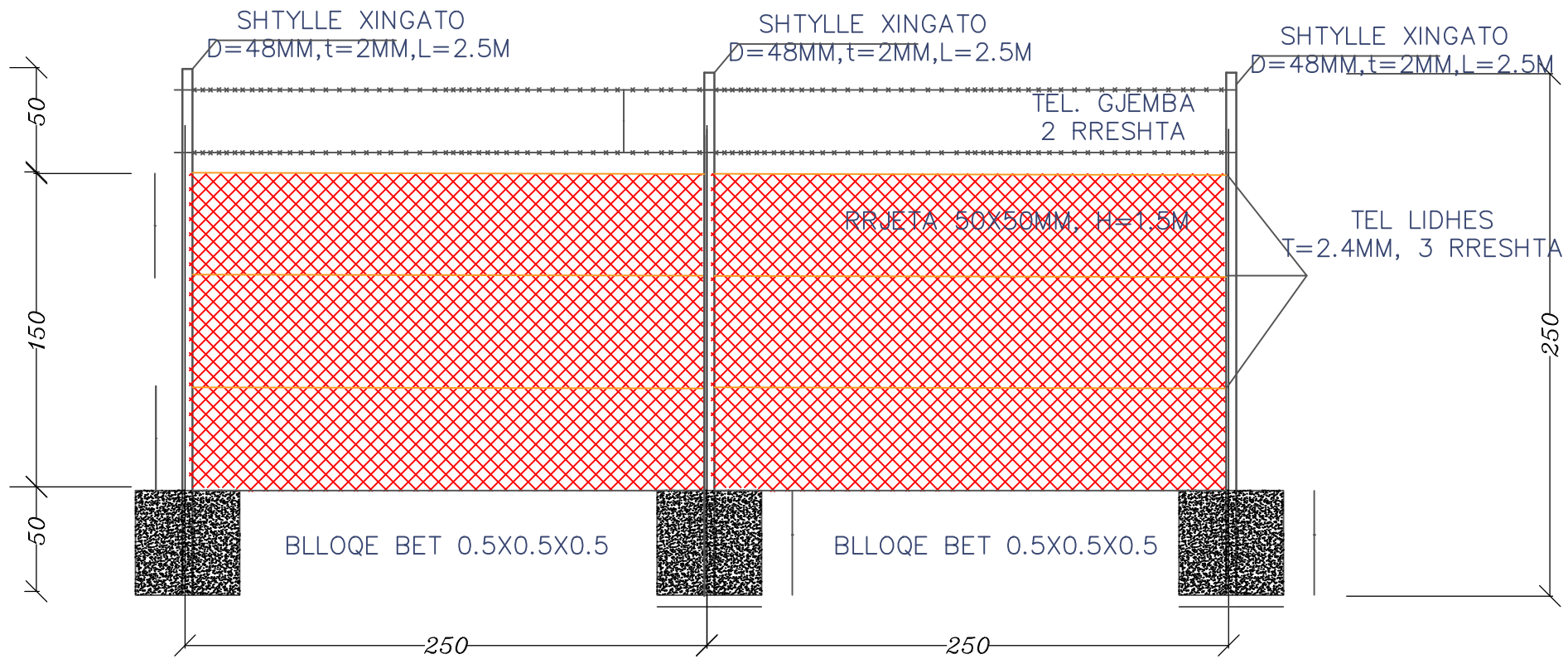

PLANVENDOSJA E RRETHIMI SHK 1:150

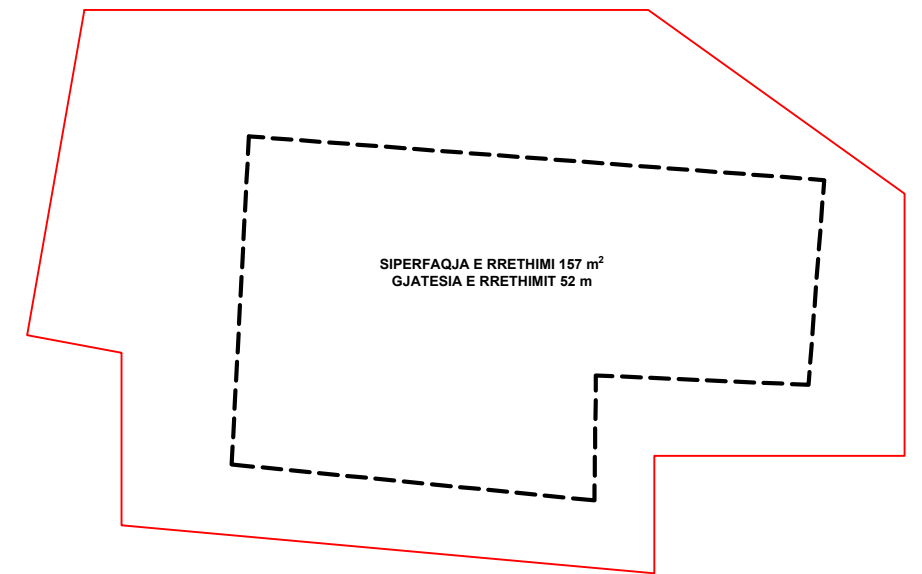

PROJEKT ZBATIMI

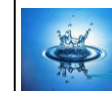

INVESTITORI: SH.A. UJESJELLES GRAMSH

PROJEKTUESI: HYDROWATER-ALBANIA

SHKALLA
1:30

Drejtues teknik. Hidro

G.PUSTINA

PRILL 2021

FORMATI A3

INXHINIER. Hidroteknik

J.BETI

NR I VIZATIMIT

INXHINIER.Gjeodet

B. ISUFATI

GR-DET-KOT-RRETH-A3-03

Ndertimin i linjes se furnizim me uje i fshatrave Kotorr, Liras, Storr, Bashkia Gramsh