



MIRATOHET
KRYETARI I BASHKISE
BESION AJAZI



DREJTORI
DREJTORIA E PLANIFIKIMIT
TE TERRITORIT

ING. ORGENT ÇONIKU



PUNOI

ING. EDION SHTYLLA
 Ark. AMARILDO KARAJ



Investitori:	Prirësi:	E rrethimi i fletes:	Shkalla:	Nr i fletes:	Shenime:
Bashkia Gramsh	Rehabilitimi i rrugëve Pishaj	HORODRAFIA	1:7500	A-1	



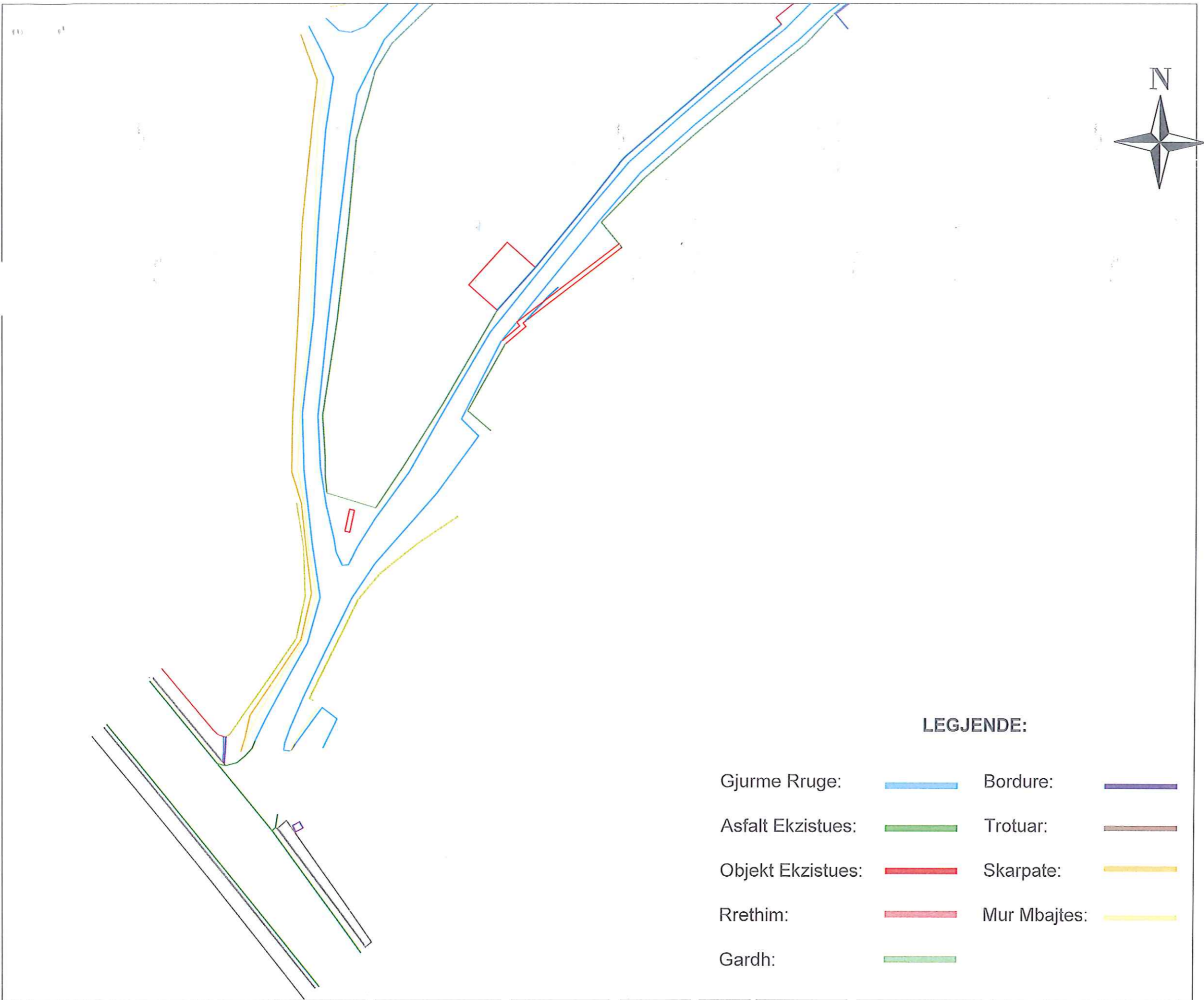

LEGJENDE:

Gjurmë Rruge:		Bordure:	
Asfalt Ekzistues:		Trotuar:	
Objekt Ekzistues:		Skarpate:	
Rrethim:		Mur Mbajtes:	
Gardh:			

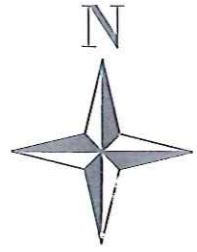

LEGJENDE:

- | | | | |
|-------------------|--|--------------|--|
| Gjurme Rruge: | | Bordure: | |
| Asfalt Ekzistues: | | Trotuar: | |
| Objekt Ekzistues: | | Skarpate: | |
| Rrethim: | | Mur Mbajtes: | |
| Gardh: | | | |

MIRATOHET
KRYETARI I BASHKISE

BESION AJAZI



DREJTORI
DREJTORIA E PLANIFIKIMIT
TE TERRITORIT

ING. ORGENT ÇONIKU



PUNOI

ING. EDION SHTYLLA
Ark. AMARILDO KARAJ



Investitori:
Bashkia Gramsh



Objekti:
Rehabilitimi i rrugëve Pishaj

Ekzistimi fotos:
TOPC GRAFIA

Skalla:
1:500

Nr. fletes:
B-2

Shenime:

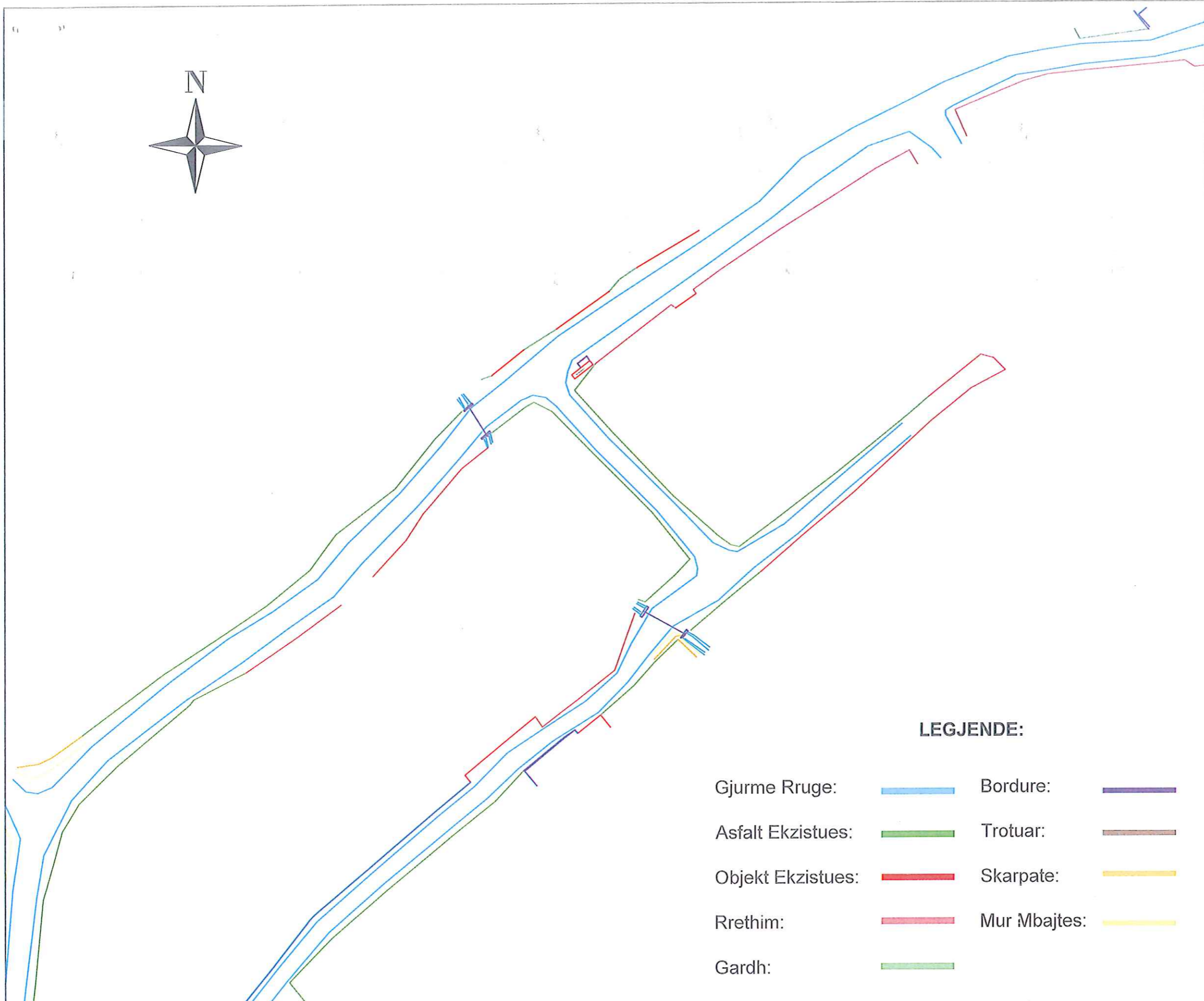
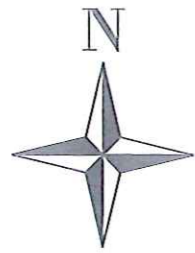

MIRATOHET
KRYETARI I BASHKISE
BES ON AJAZI

DREJTORI
DREJTORIA E PLANIFIKIMIT
TE TERRITORIT
ING. ORGENT ÇONIKU

PUNOI
ING. EDION SHTYLLA
Ark. AMARILDO KARAI

LEGJENDE:

- | | | | |
|-------------------|--|--------------|--|
| Gjurme Rruge: | | Bordure: | |
| Asfalt Ekzistues: | | Trotuar: | |
| Objekt Ekzistues: | | Skarpate: | |
| Rrethim: | | Mur Mbajtes: | |
| Gardh: | | | |

Investori:
Bashtakia Gramsh

Projekti:
Rrethimi i rrugëve Pishaj

Emertimi i fletës:
TOPOGRAFIJA

Shkallë:
1:500

Nr i fletës:
B-2

Shënim:

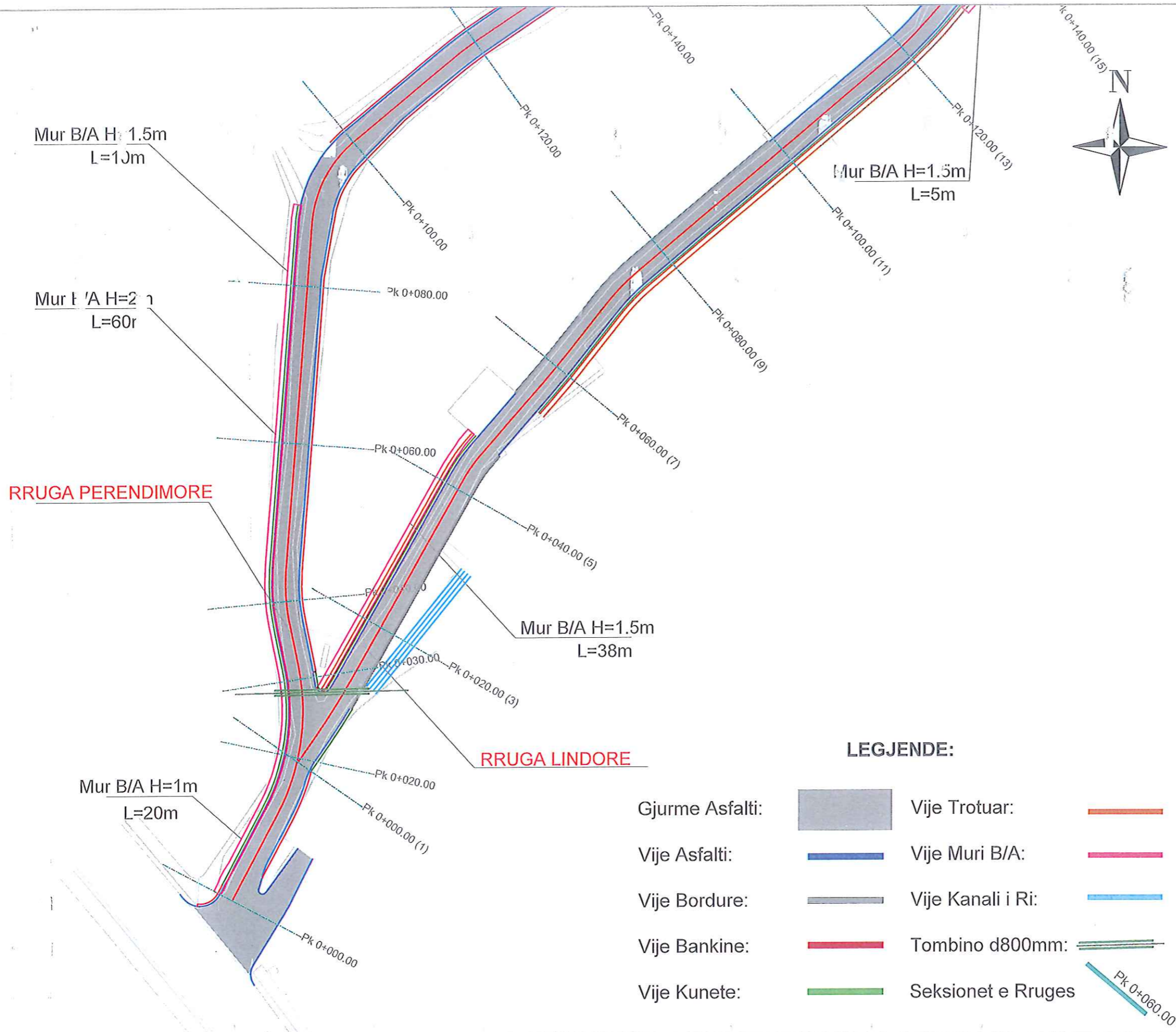

MIRATOHET
 KRYETARI I BASHKISE
 BESHON AJAZ

DREJTORI
 DREJTORIA E PLANIFIKIMIT
 TE TERRITORIT

ING. ORGENT ÇONIKU

PUNOI

ING. EDION SHTYLLA
 Ark. AMARILDO KARAJ

I veštitor: Bashkia Gramsh	Projekti Rehimimi i rrugëve Pëllaj	Niveli i fletës: PLANIMETRIA C-1	Shkalla:	Mbiqarkimi:	Shenime:
-------------------------------	---------------------------------------	-------------------------------------	----------	-------------	----------



RRUGA PERENDIMORE

RRUGA LIDHESE

RRUGA LINDORE

Mur B/A H=1.5m
L=5m

LEGJENDE:

Gjurme Asfalti:



Vije Trotuar:



Vije Asfalti:



Vije Muri B/A:



Vije Bordure:



Vije Kanali i Ri:



Vije Bankine:



Tombino d800mm:



Vije Kunete:



Seksionet e Rruges

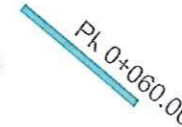

Inveshitori:
Bashkia e Gramsh



Projekti:
Rehabilitimi i rruges ne Pishaj

Emri i timi i fletes:
PLANIMETRIJA

Shalla:
1:500

Tripletet:

Skenime:

MIRATCHET

KRYETARI I FASHKISE

BESION AJAZI



DREJTORI
DREJTORIA E PLANIFIKIMIT
TE TERRITORIT

ING. ORGENT ÇONIKU

PUNOI

ING. EDION SHTYLLA
Ark. AMARILDO KARAJ

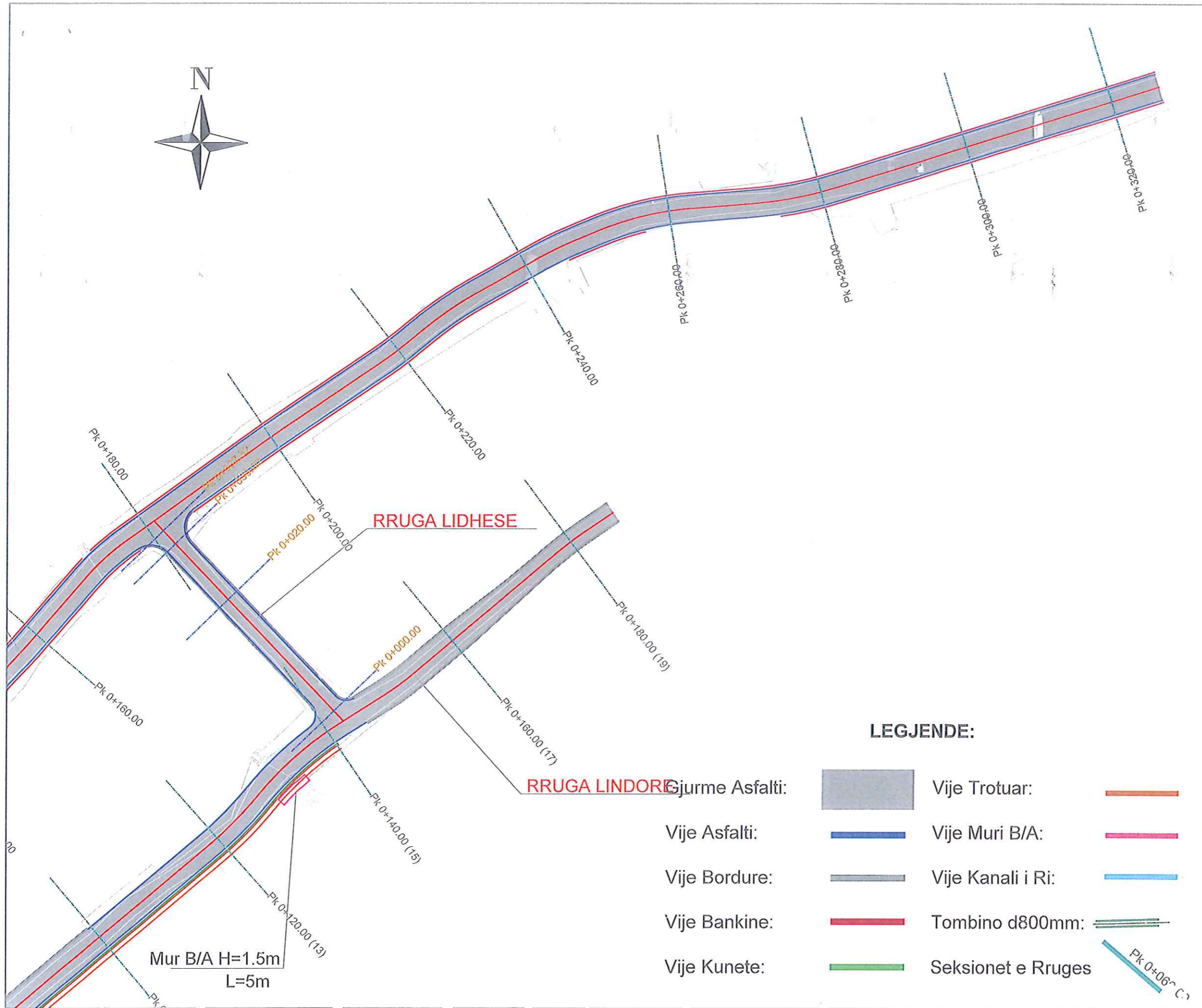
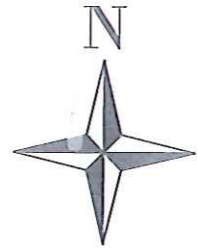

MIRATOHEJ
 KRYETAR I BASHKISË
 BESHON AJAZI

DREJTORI
 DREJTORIA E PLANIFIKIMIT
 TE TERRITORIT

ING. ORGENT ÇONIKU

PUNOI

ING. EDION SHTYLLA
 Ark. AMARILDO KARAJ

LEGJENDE:

- Gjurme Asfalti:
- Vije Trotuar:
- Vije Asfalti:
- Vije Muri B/A:
- Vije Bordure:
- Vije Kanali i Ri:
- Vije Bankine:
- Tombino d800mm:
- Vije Kunete:
- Seksionet e Rrugës:

Institucioni: Bashkia Gramsh	Projekti: Rehabilitimi i rrugëve Pishaj	Emertimi i planimit: PLANIMETRI	Shkalla: 1:500	Nr i planit:	Shenime:
---------------------------------	--	------------------------------------	-------------------	--------------	----------

PROFILI GJATESOR
Rruga Perenimore L=320m

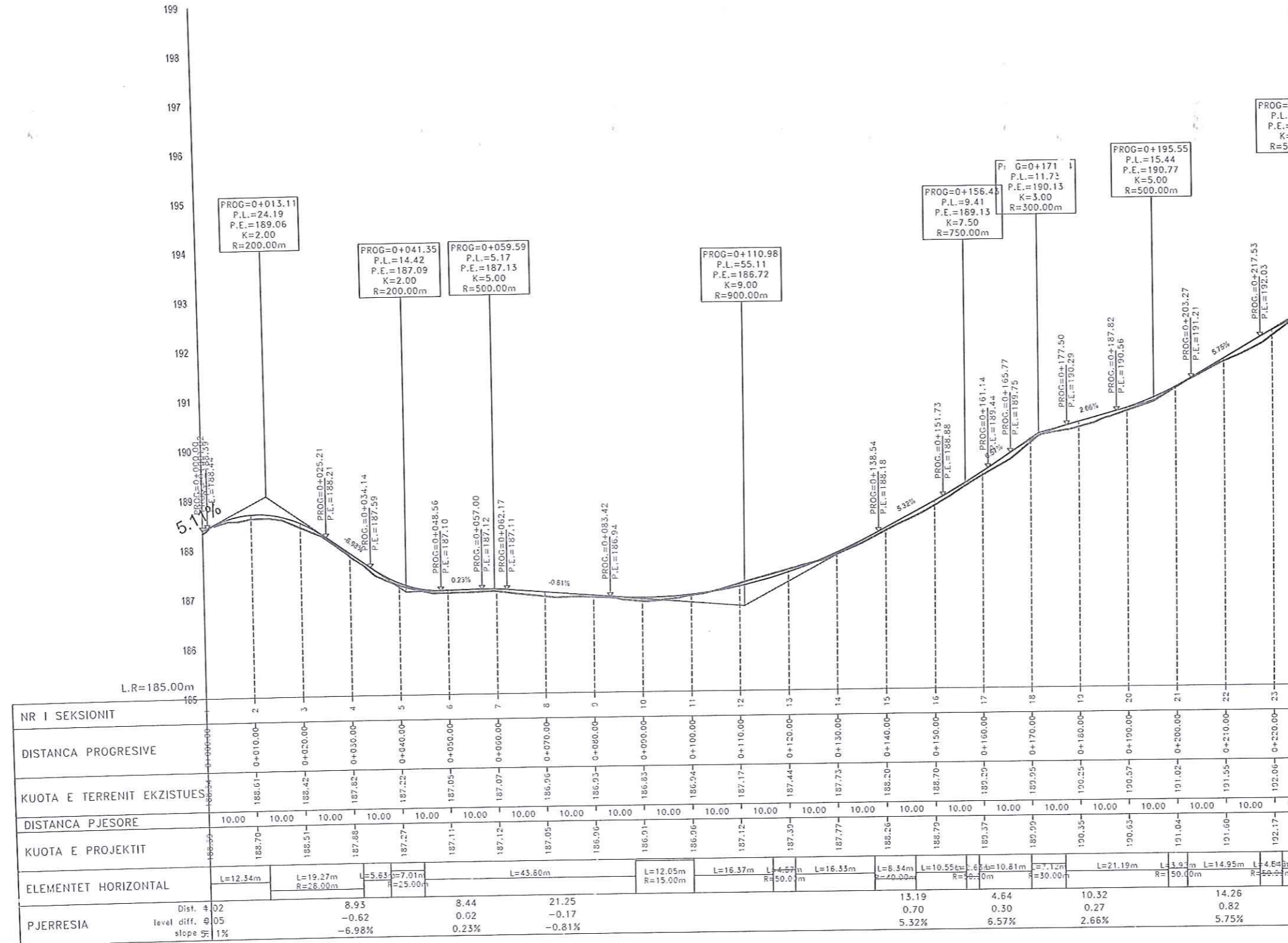

MIRATOHET
KRYETARI I BASHKISË
EDHON AJAZI
DREJTORI
DREJTORIA E PLANIFIKIMIT
TE TERRITORIT

ING. ORGENT ÇONIKU

PUNOI

ING. EDION SHTYLLA
Ark. AMARILDO KARAJ

Veprimtari:
bashkia Gramsh



Projekti:
Rehabilitimi i rrugëve Pisha

Emërtimi i objektit:
PROFILI GJATESOR
Rruga Perenimore L=320m

Shkallë:
H-1:100
V-1:100

Numri i fletës:
D-1

Shenime

PROFILI GJATESOR
Rruga Lindore L=180m

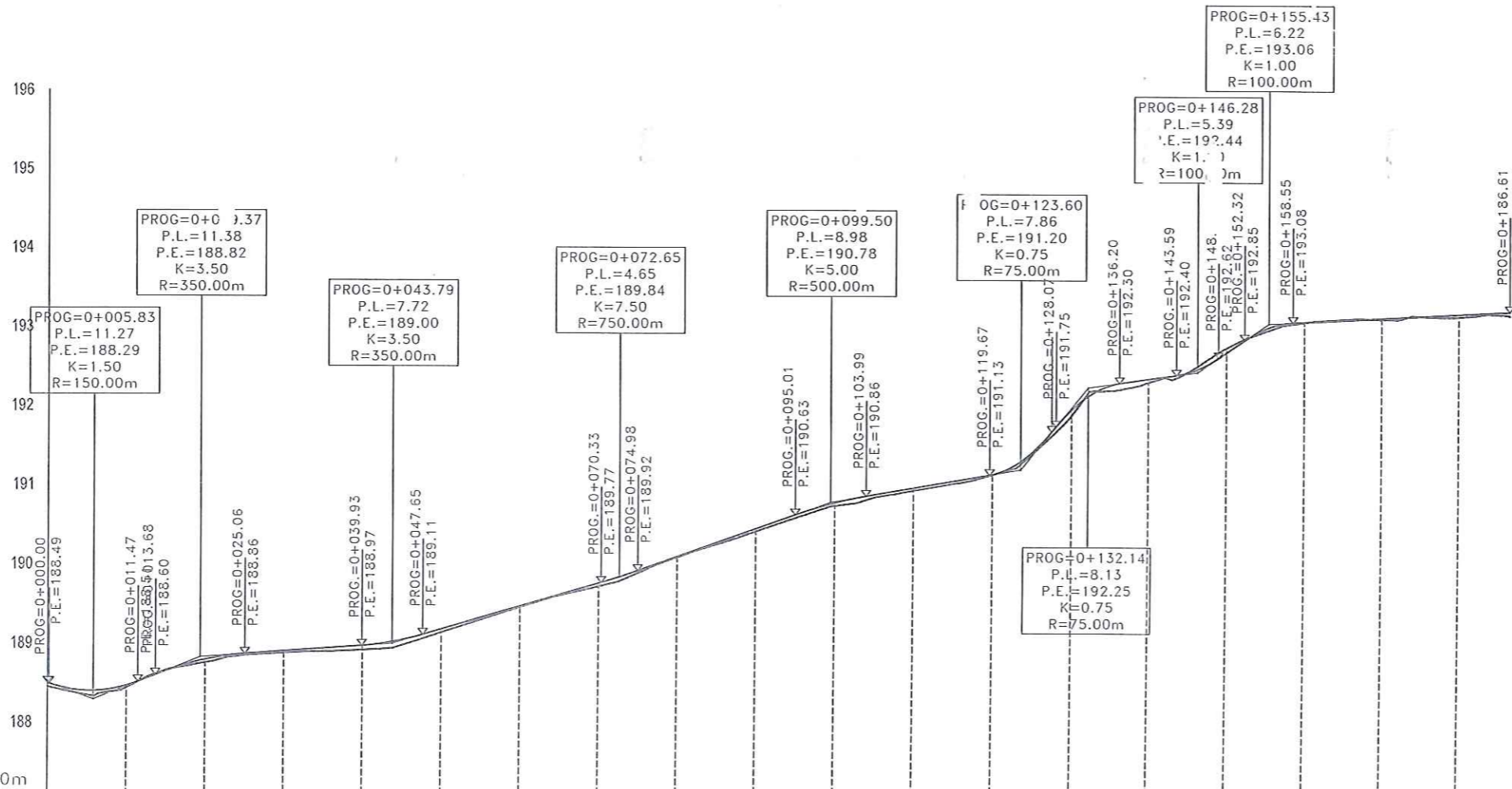

NR I SEKSIONIT	1	2	3	4	5	6	7	8	9	10	11	12	13	14	15	16	17	18	19
DISTANCA PROGRESIVE	0+000.00	0+010.00	0+020.00	0+030.00	0+040.00	0+050.00	0+060.00	0+070.00	0+080.00	0+090.00	0+100.00	0+110.00	0+120.00	0+130.00	0+140.00	0+150.00	0+160.00	0+170.00	0+180.00
KUOTA E TERRENIT EKZISTUES	188.43	188.43	188.75	188.88	188.91	189.13	189.46	189.72	190.09	190.41	190.74	190.93	191.14	191.89	192.31	192.75	193.08	193.13	193.16
DISTANCA PJESORE	10.00	10.00	10.00	10.00	10.00	10.00	10.00	10.00	10.00	10.00	10.00	10.00	10.00	10.00	10.00	10.00	10.00	10.00	10.00
KUOTA E PROJEKTIT	188.46	188.79	188.90	188.97	189.18	189.47	189.76	190.09	190.45	190.78	190.97	191.14	191.96	192.35	192.69	193.08	193.14	193.19	193.19
ELEMENTET HORIZONTAL	L=3.68m R=100.00m	L=8.93m R=100.00m	L=28.77m R=20.00m	L=3.99m R=20.00m	L=10.81m R=150.00m	L=6.47m R=150.00m	L=7.46m R=30.00m	L=5.87m R=30.00m	L=42.33m	L=8.76m R=50.00m	L=14.01m R=45.00m	L=6.37m R=40.00m	L=5.44m R=40.00m	L=23.74m	L=5.06m R=50.00m	L=4.13m R=50.00m			
PJERRESIA	Dist. @ 20 level diff. ±0.01 slope -3.55%	2.21 0.09 3.96%	14.87 0.11 0.71%		22.68 0.66 2.91%		20.04 0.71 3.53%		15.68 0.27 1.74%	0.54 0.07 12.22%	7.39 0.10 1.38%	3.35 0.23 6.77%		28.07 0.15 0.54%					

MIRATOHET
KRYETARI I BASHKISE



DREJTORI
DREJTORIA E PLANIFIKIMIT
TE TERRITORIT

ING. ORGENT ÇONIKU

PUNOI

ING. EDION SHTYLLA
Ark. AMARILDO KARAJ

Investitori:
Bashkia Gramsh



Projekti:
Rehabilitimi i rrugeve Pshaj

Emri i objektit:
PROFILI GJATESOR
Rruga Lindore L=180m

Shkalla:
H-1:750
V-1:75

Nr i flotes:
D-2

Shurime:

PROFILI GJATESOR
Rrugë Lidhëse L=32.2m

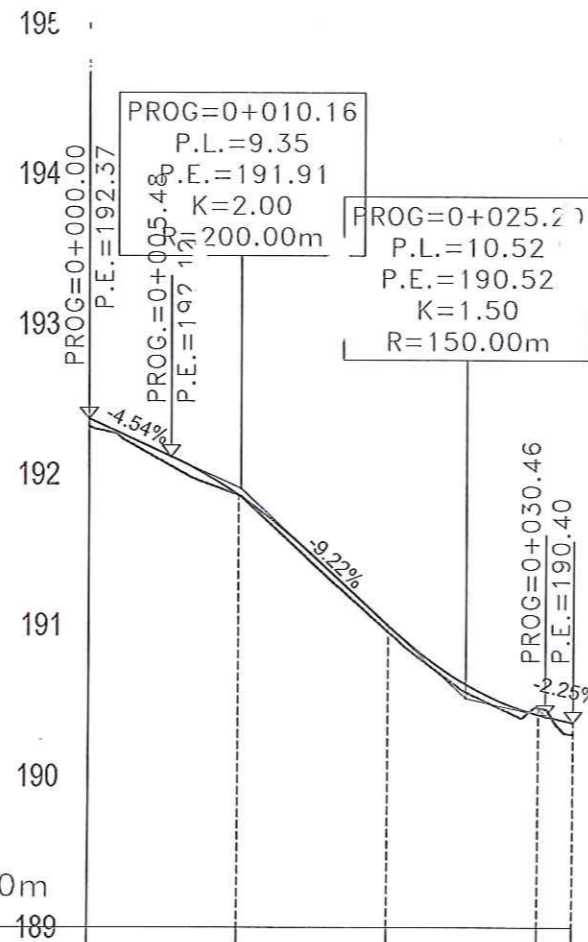

NR I SEKSIONIT	1	2	3	4	5
DISTANCA PROGRESIVE	0+000.00	0+010.00	0+020.00	0+030.00	0+032.52
KUOTA E TERRENIT EKZISTUES	192.52	191.86	190.96	190.45	190.28
DISTANCA PJESORE		10.00	10.00	10.00	2.32
KUOTA E PROJEKTIT	192.57	191.86	191.00	190.41	190.36
ELEMENTET HORIZONTAL					
PJERRESIA	Dist. = 5.48				1.86
	level diff. = -0.25	-0.25			-0.04
	slope = -4.54%	-9.22%			-2.25%

MIRATOHET
KRYETAR I B. SHKISE

BESION ALAZI

DREJTORI
DREJTORIA E PLANIFIKIMIT
TE TERRITORIT

ING. ORGENT ÇONIKU

PUNOI

ING. EDION SHTYLLA
Ark. AMARILDO KARAJ

PROFILI GJATESOR
Fruga Perendimore L=320m

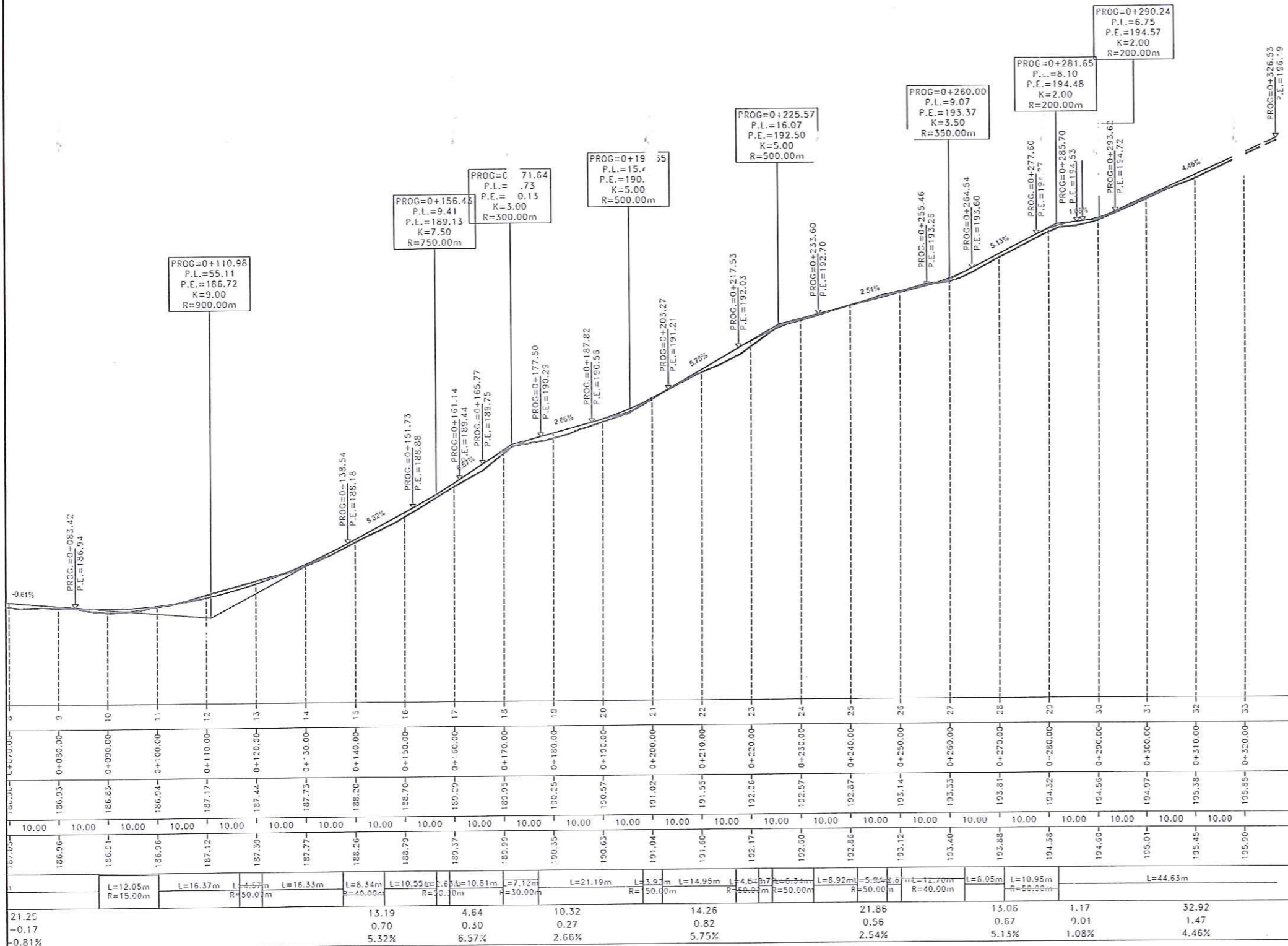

MIRATOHET
KRYETARI I BASHKISE
BESIO JAJAZI

DREJTORI
DREJTORIA E PLANIFIKIMIT
TE TERRITORIT
ING. ORGENT ÇONIKU

PUNOI
ING. EDION SHTYLLA
Ark. AMARILDO KARAJ

Investitri:
Bashkia Gramsh

Projekti:
Rehabilitimi i rrugeve Pishaj

Emertimi i titullit:
PROFILI GJATESOR
Fruga Perendimore L=320m

Shkalla:
H-1:1000
V-1:100

Nr i fletës:
D-1

Shenime

PROFILI TERTHOR
Rruga Perendimore L=320m

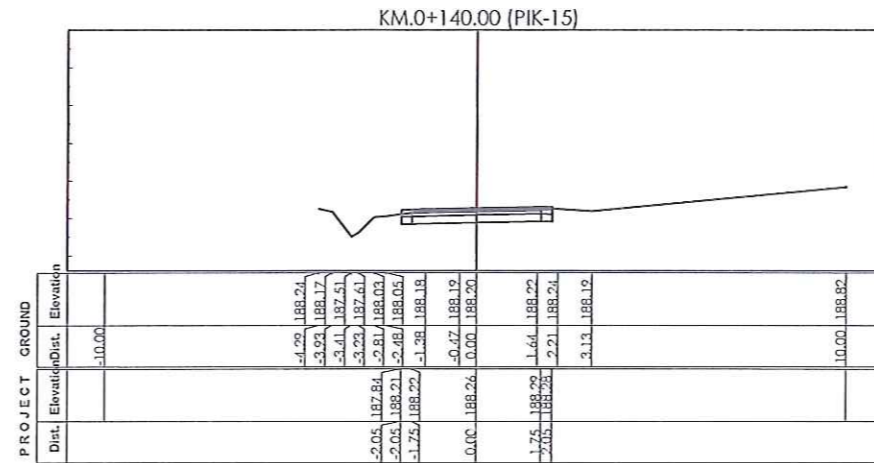
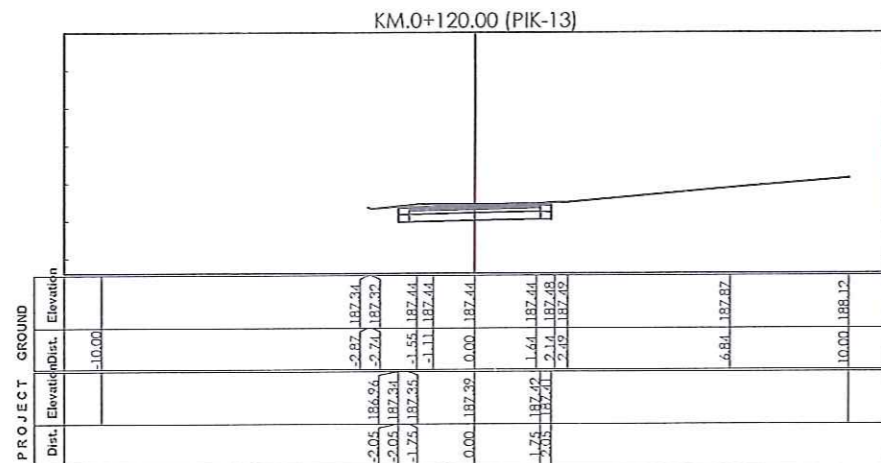
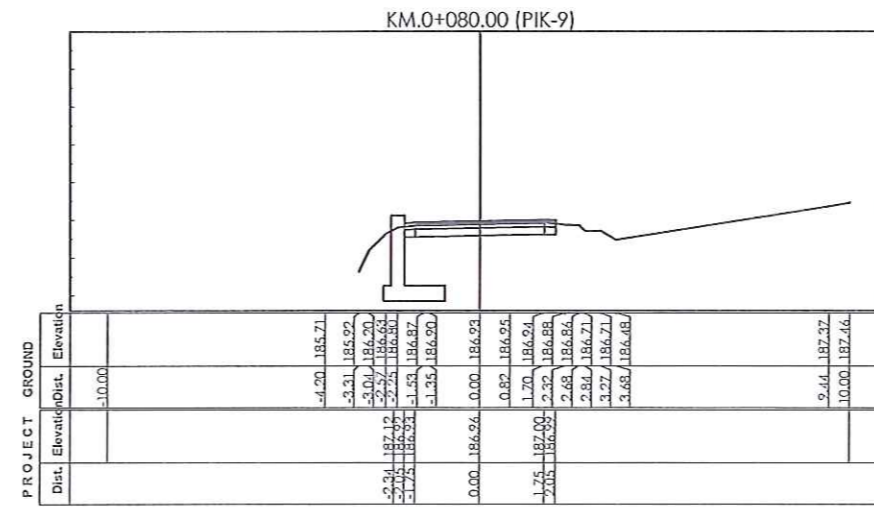
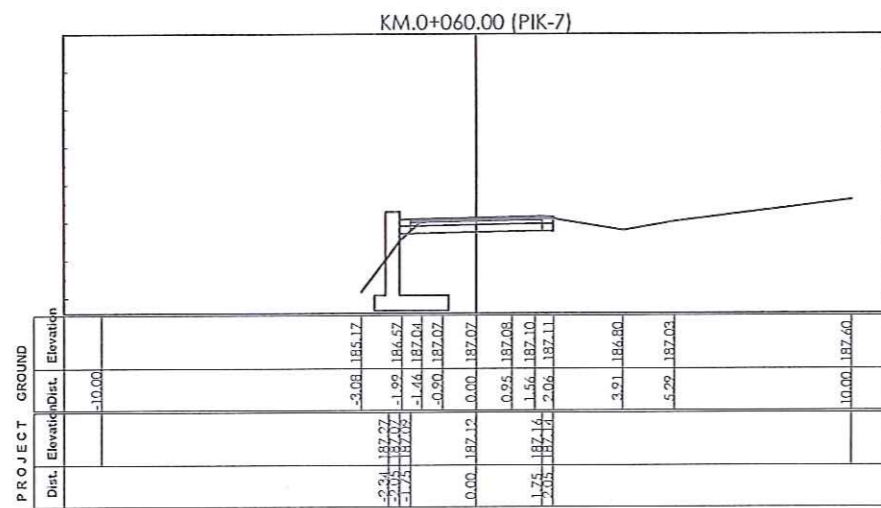
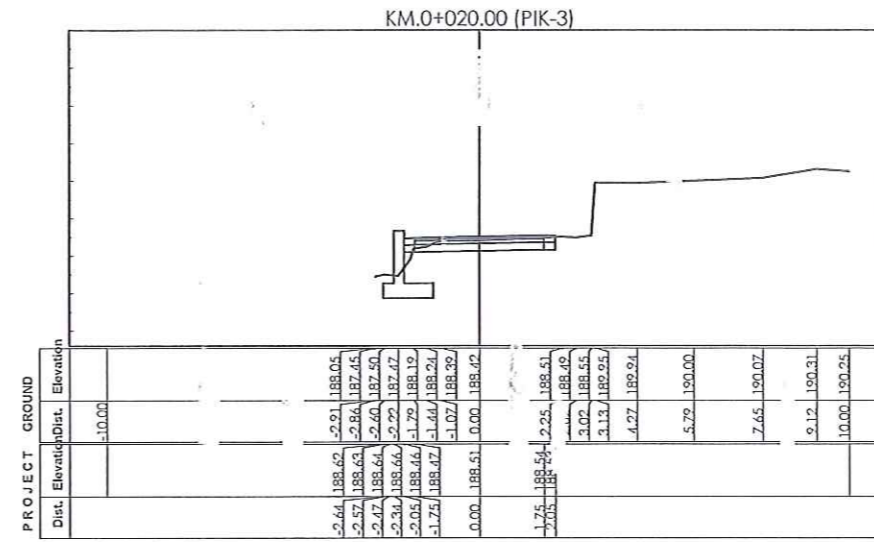
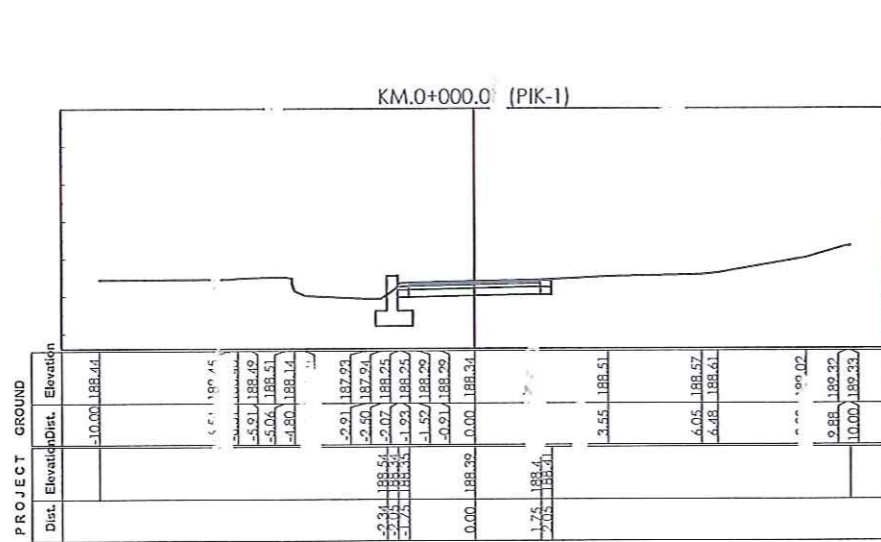

MIRATOHET
KRYETARI I BASHKISE
BEJON AJAZI

DREJTORI
DREJTORIA E PLANIFIKIMIT
TE TERRITORIT

ING. ORGENT ÇONIKU

PUNOI
ING. EDION SHTYLLA
Ark. AMARILDO KARAJ

PROFILI TERTHOR
Rruga Perendimore L=320m

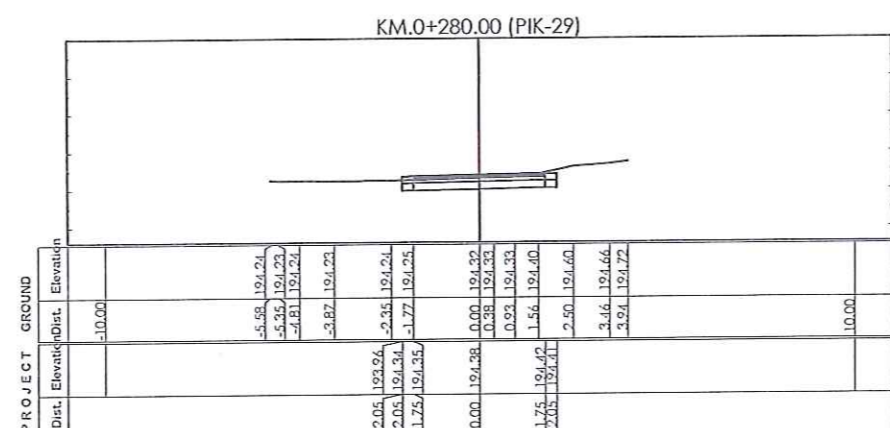
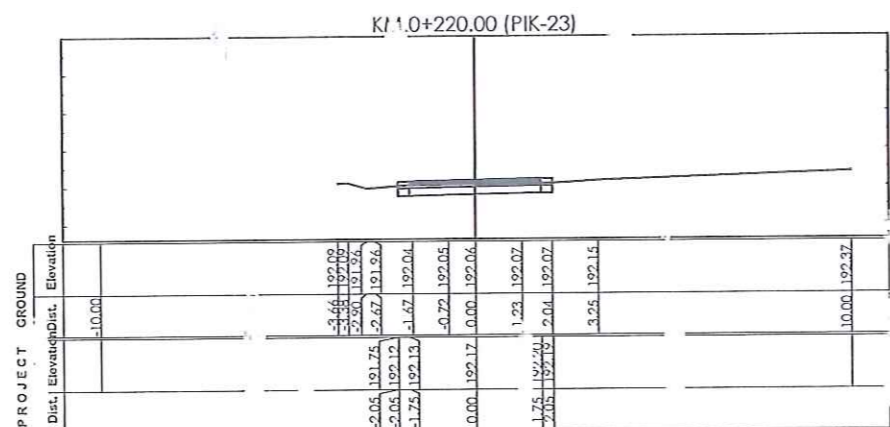

MIRATOHET

KR. ETARLI BASHKISE

BESION AJAZI



DREJTORI
DREJTORIA E PLANIFIKIMIT
TE TERRITORIT

ING. ORGENT ÇONIKU

PUNOI

ING. EDION SHTYLLA
Ark. AMARILDO KARAJ

Investitori:
Bashkia Gramsh



Projekt:
Rehabilitimi i rrugeve Pishaj

Enjertimi i fletes:
PROFILI TERTHOR
Rruga Perendimore L=320m

Shkalla:
1:200

Nr i fletes:
E-2

Shenime:

PROFILI TERHOR
Rruga Lindore L=180m

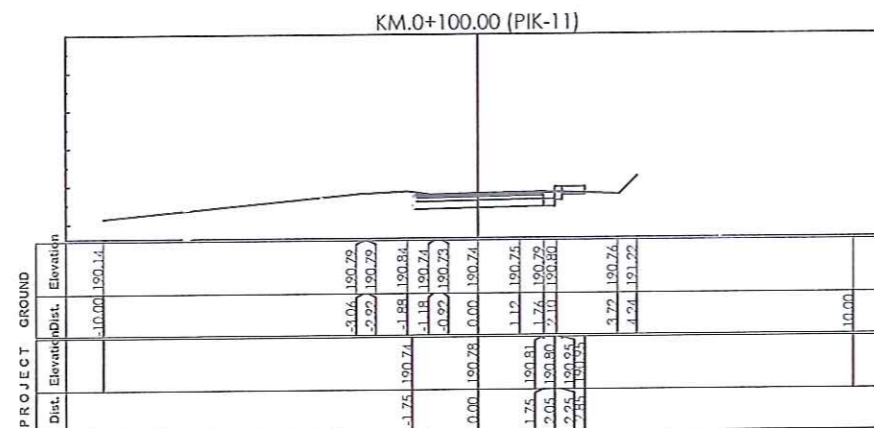
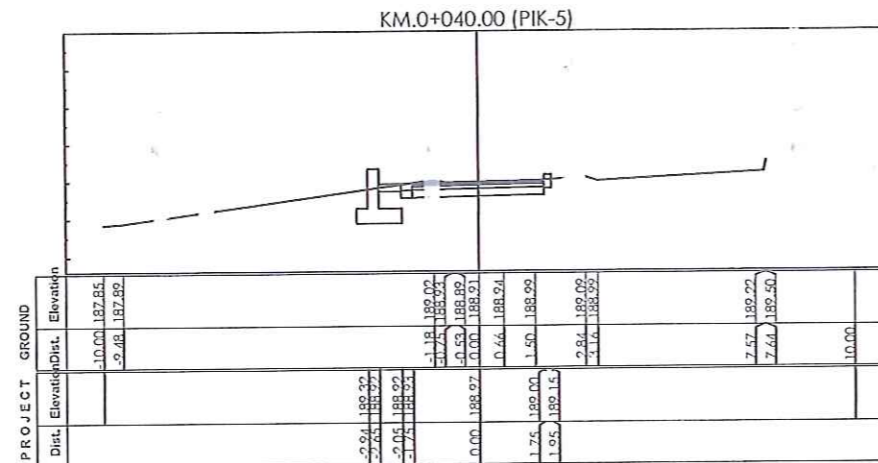

MIRATOHET
KRYETARI I BASHKISE
BESION AJAZI



DREJTORI
DREJTORIA E PLANIFIKIMIT
TE TERRITORIT

ING. ORGENT ÇONIKU

PUNOI

ING. EDION SHTYLLA
Ark. AMARILDO KARAJ

PROFILI TERTHOR
Rruga Lidhese L=32m

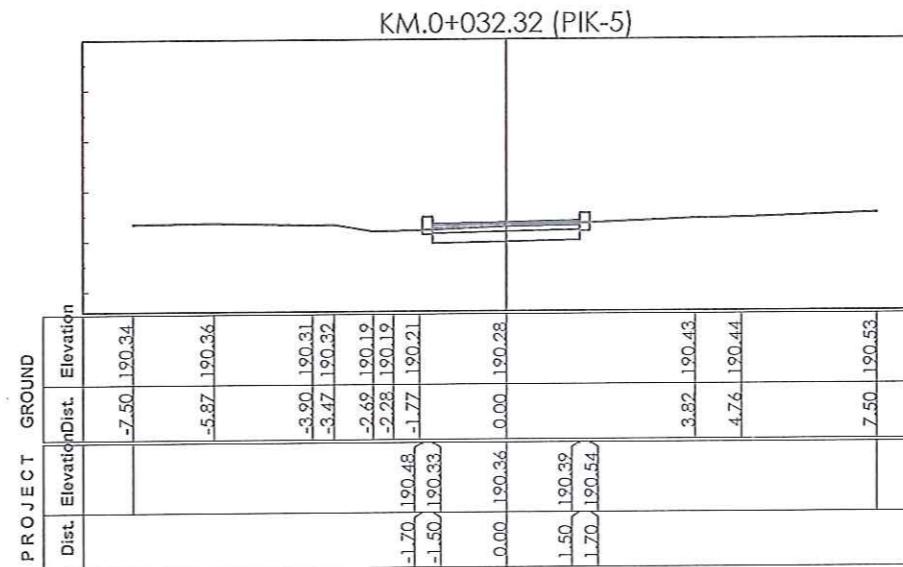
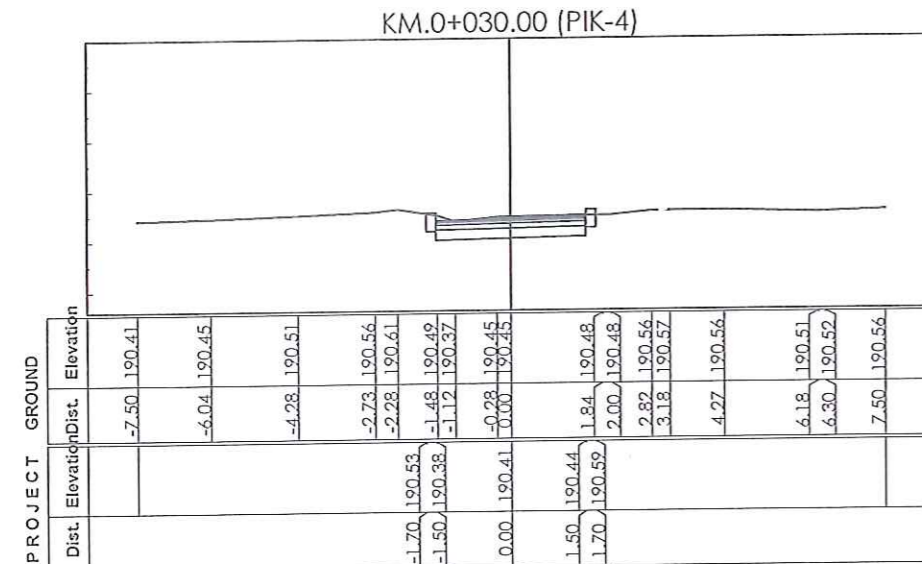
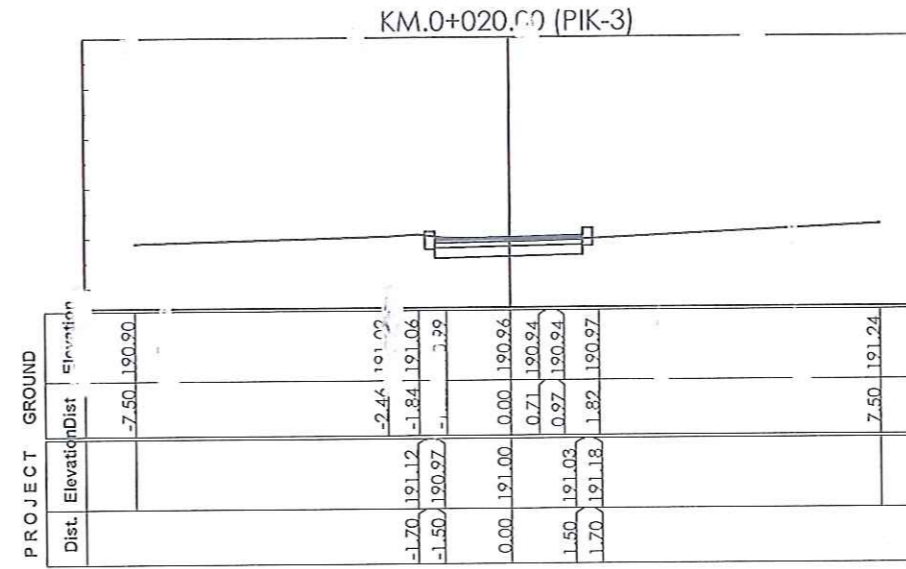
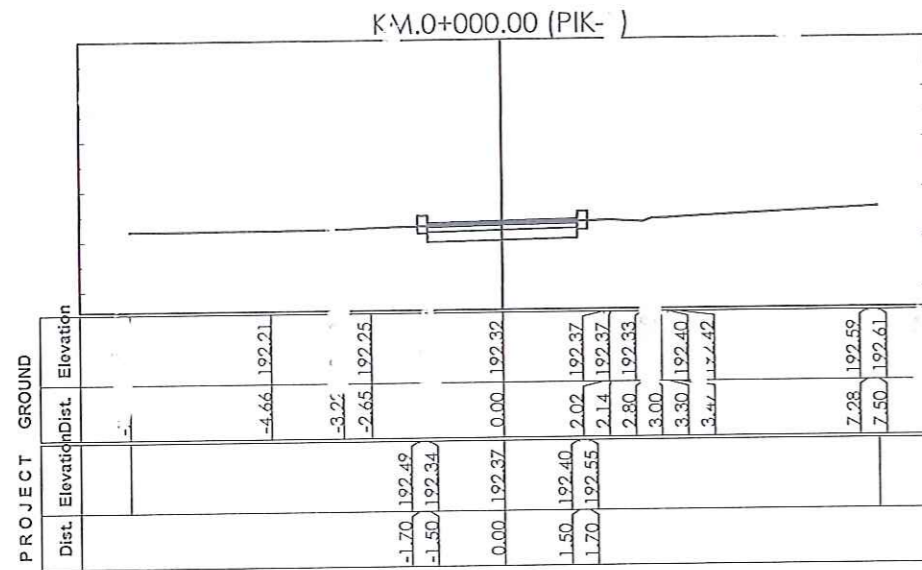

MIRATOHET
KRYETARI BASHKISE
BILION AJAZI

DREJTORI
DREJTORIA E PLANIFIKIMIT
TE TERRITORIT

ING. ORGENT ÇONIKU

PUNOI

ING. EDION SHTYLLA
Ark. AMARILDO KARAJ

Investitor:
Bashkia e Gramsh



Projekti:
Rehabilitimi i rrugeve Pishnjaj

Emërtimi i tejes:
PROFILI TERTHOR
Rruga Lidhese L=32m

Skala:
1: 50

Nr. i fletes:
E-5

Shtesime:

PROFILI TERTHOR
Rruga Lindore L=180m

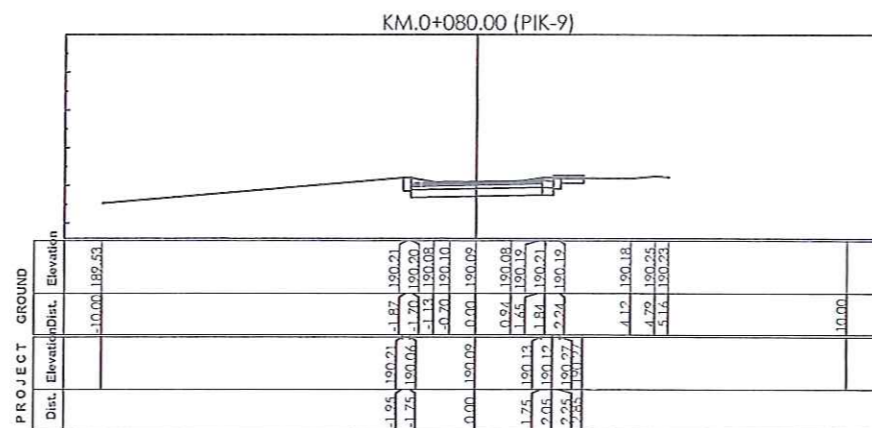
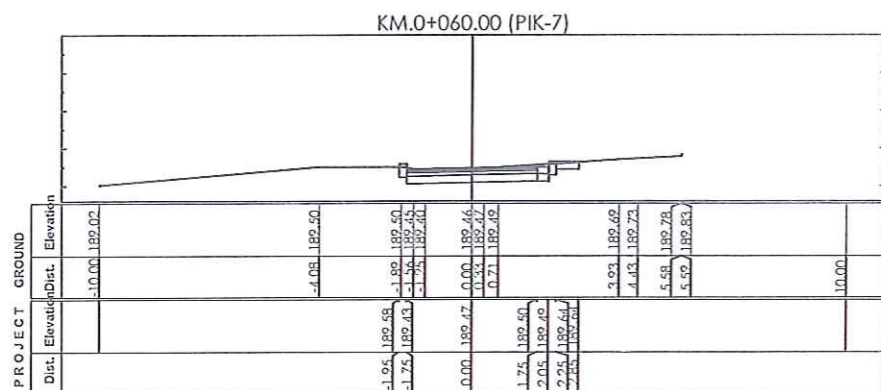
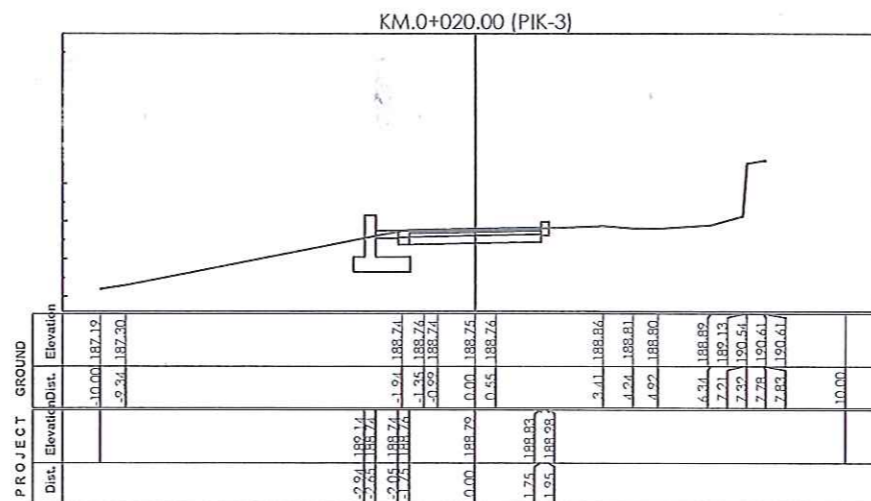
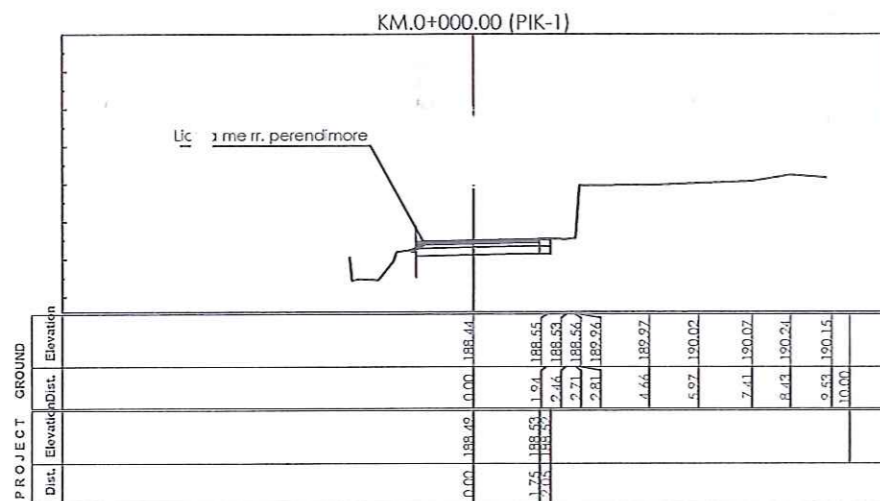

MIRATOHET
KRYETARI I BASHKISIA
BESION AJAZI

DREJTORI
DREJTORIA E PLANIFIKIMIT
TE TERRITORIT

ING. ORGENT ÇONIKU

PUNCI

ING. EDION SHTYLLA
Ark. AMARILDO KARAI

Investitor:
Bashkia Gramsh



Projekti:
Rehabilitimi i rrugës Pishaj

Emërtimi i flësës:
PROFILI TERTHOR
Rruga Lindore L=180m

Shkalla:
1:200

Nr i flësës:
E-3

Shenime:

PROFILI TERTHOR
Rruga Perendimore L=320m

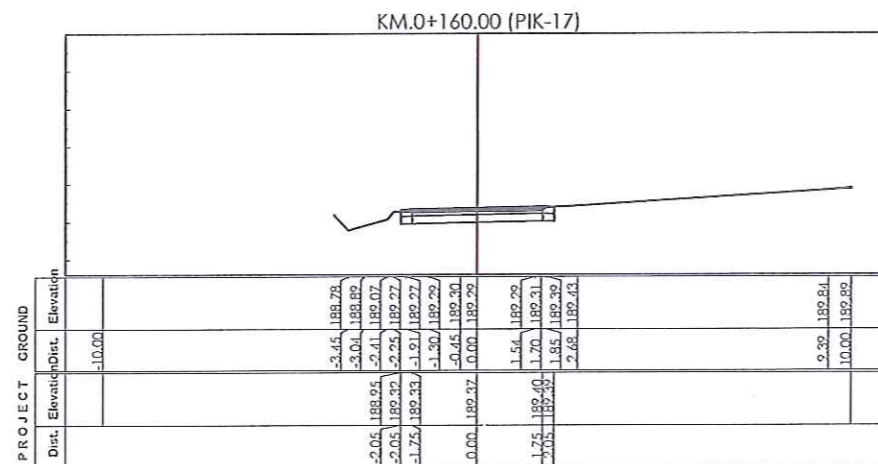
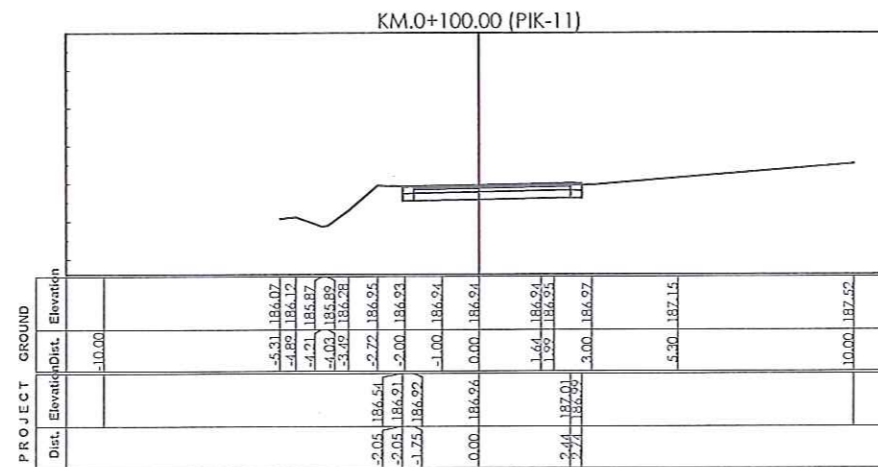
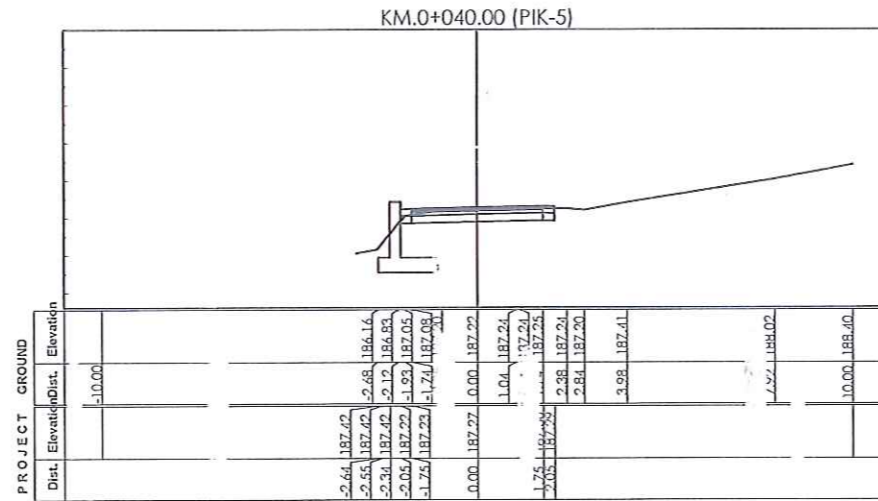

MIRATOIET
KRYETARI I BASHKISE
BESION A. AZI

DREJTORI
DREJTORIA E PLANIFIKIMIT
TE TERRITORIT

ING. ORGENT ÇONIKU

PUNOI

ING. EDION SHTYLLA
Ark. AMARILDO KARAJ

PROFILI TIP Nr. 1

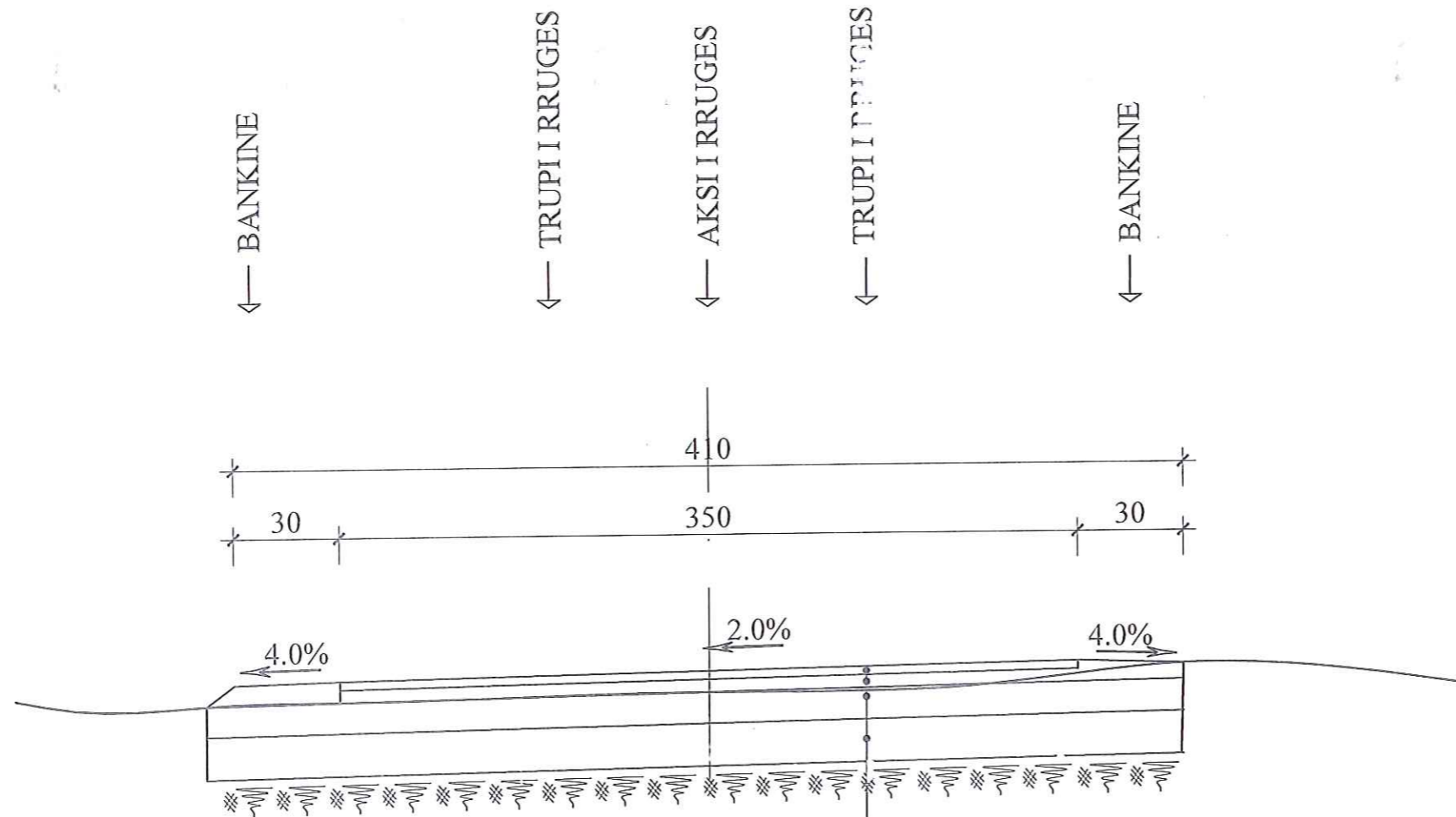

Asfaltobeton	3 cm
Binder	5 cm
Stabilizant	10 cm
Çakell	20 cm

MIRATOHET
KRYETARI I BASHKISE



DREJTORI
DREJTORIA E PLANIFIKIMIT
TE TERRITORIT

ING. ORGENT ÇONIKU

PUNOI

ING. EDION SHTYLLA
Ark. AMARILDO KARAJ

PROFLI TIP Nr. 2 Rruga Lidhese

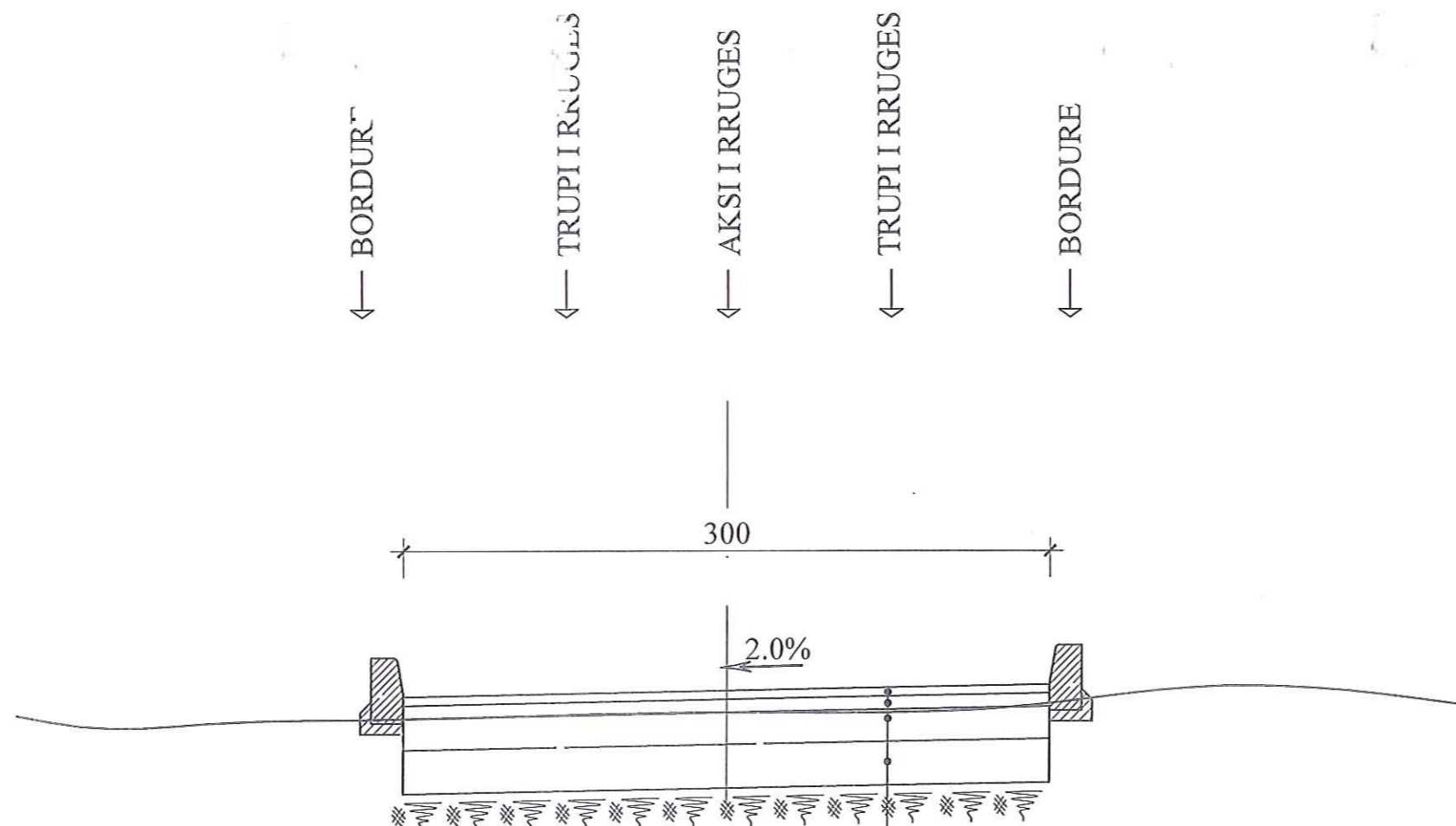

Asfaltobeton	3 cm
Binder	5 cm
Stabilizant	10 cm
Çakell	20 cm

MIRATOHET
KRYETARI I BASHKISE

BEJON AJAZI

DREJTORI
DREJTORIA E PLANIFIKIMIT
TE TERRITORIT

ING. ORGENT ÇONIKU

PUNOI

ING. EDION SHTYLLA
Ark. AMARILDO KARAJ

li vestitori:

Bashkia Gramsh



Projekti:

Rehabilitimi i rrugëve Pishaj

Emertimi i objektit:

PROFLI TIP

Shifra la:

13)

Nr i fletës:

F 2

Shenime:

PROFILI TIP Nr. 3

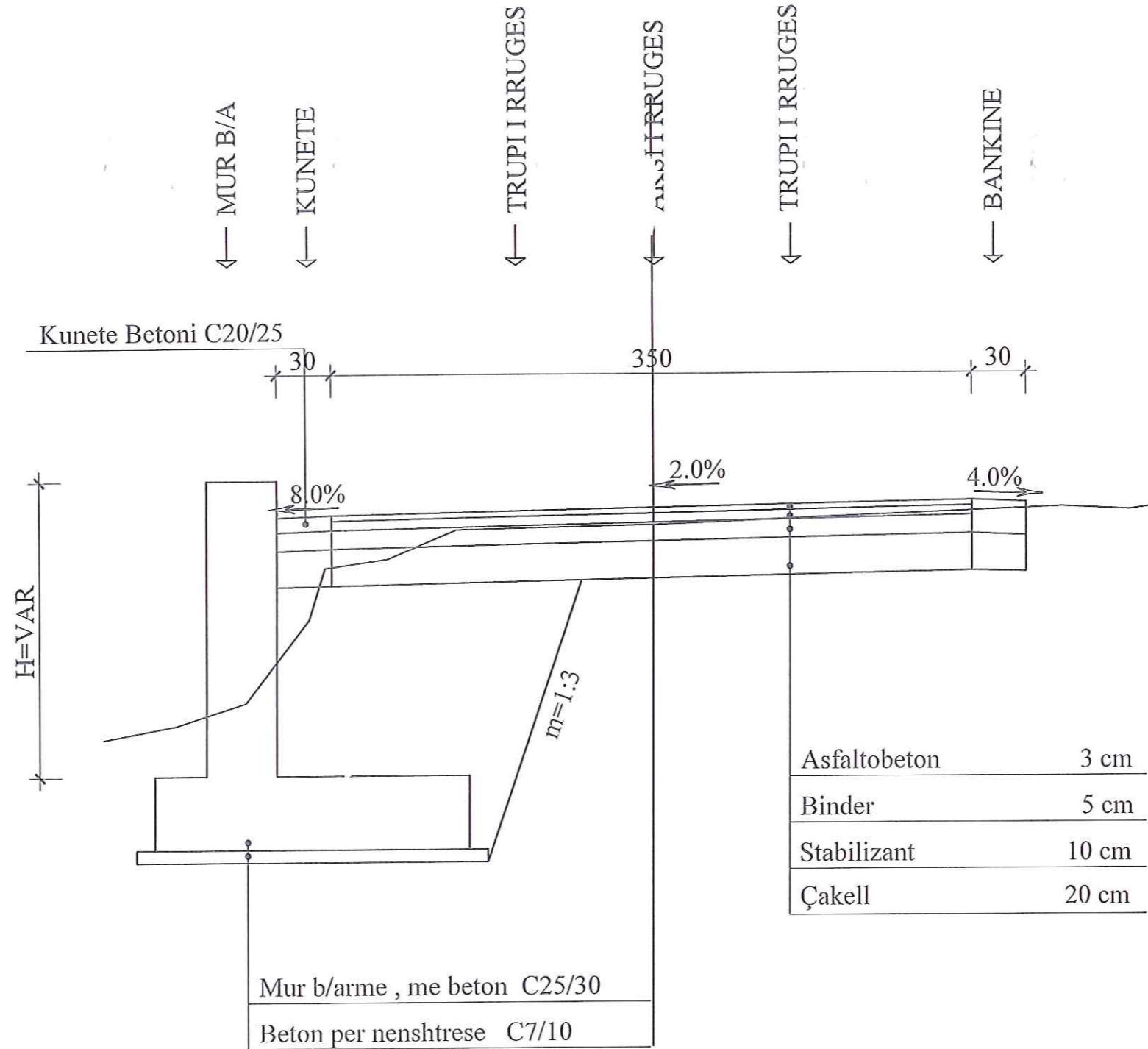

MIRATOHET
 KR. ETARI I BASHKISE
 BESION AJAZI

DREJTORI
 DREJTORIA E PLANIFIKIMIT
 TE TERRITORIT
 ING. ORGENT ÇONIKU

[Signature]
 PUNOI

ING. EDION SHTYLLA
 Ark. AMARILDO KARAJ

Investitori:
 Bashkia Gramsl



Projekti:
 Rehabilitimi i rrugëve Pishaj

Emërimi i fletës:
 PROFILI TIP

Shkalla:
 1:50

Nr i fletës:
 F-3

Shefiti re:

PROFILI TIP Nr. 4

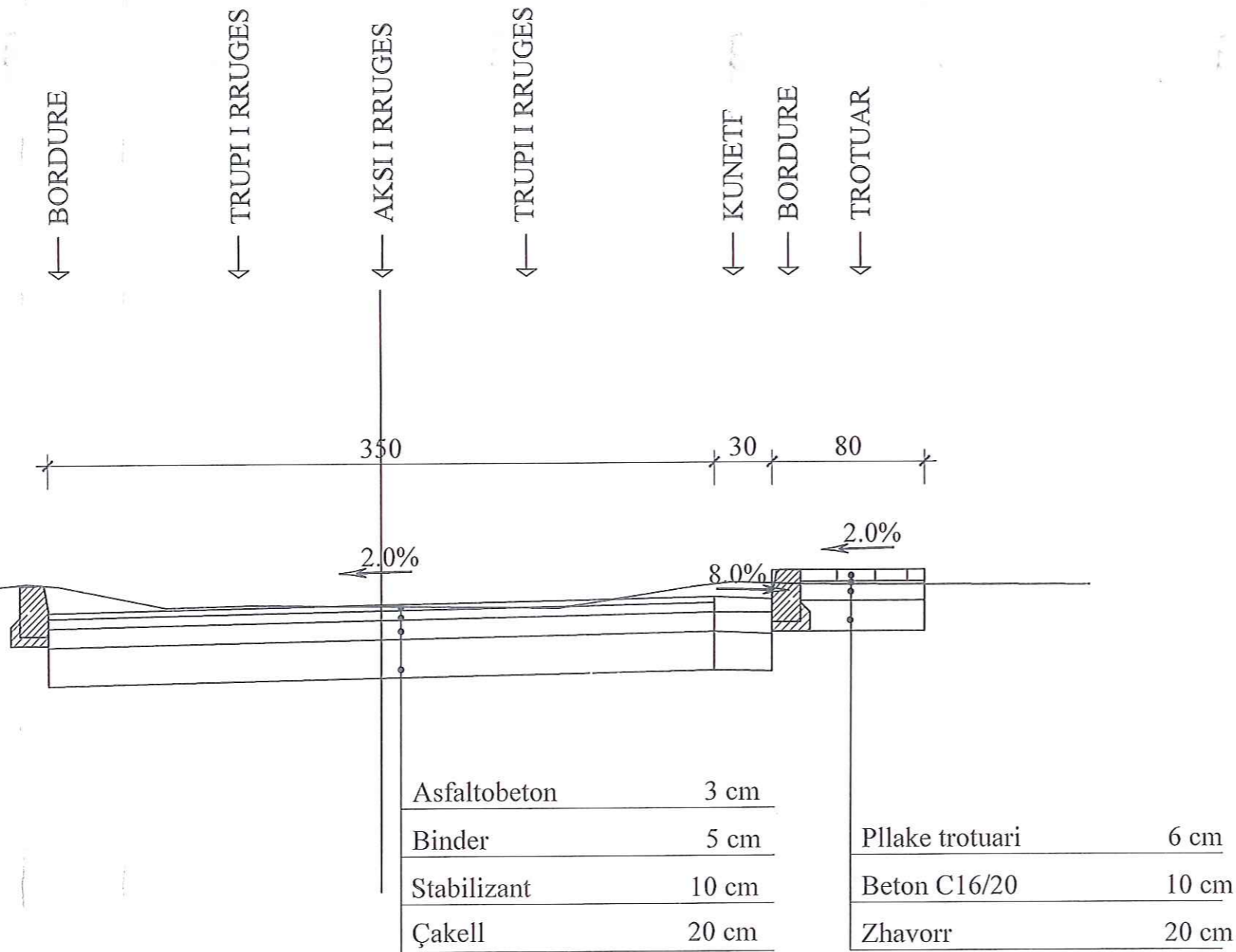

MIRATOHET
 KRYETARI I BASHKISE
 BESION AJAZI

DREJTORI
 DREJTORIA E PLANIFIKIMIT
 TE TERRITORIT

ING. ORGENT ÇONIKU

PUNOI

ING. EDION SHTYLLA
 Ark. AMARILDO KARAJ

vestitori:
 bashkia Gramsh



Projekti:
 Rehabilitimi i rrugëve Pishaj

Emëtimi i letes:
 I PROFILI TIP

Shifra:
 130

Vr i letes:
 F-4

Skenime:

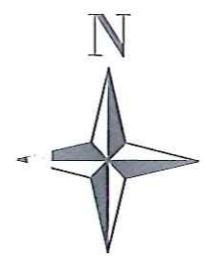

MIRATOHET
KRYETARI I BASHKISE
BESION AJAZI

DREJTORI
DREJTORIA E PLANIFIKIMIT
TE TERRITORIT

ING. ORGENT ÇONIKU

PUNOI

ING. EDION SHTYLLA
 Ark. AMARILDO KARAJ

LEGJENDE:

- TUB PE d32mm
- Vije Kanali i Ri:
- Tombino d800mm:

Inves itori
Bashkia Gramsh



Projekti:
R ehabilitimi i rruqeve Pishaj

Emertimi i fletës:
I'LANIME TRIA F J

Shkalla:
1:500

Nr i fletës :
G-1

Sheqerime:



MIRATOHET
KRYETARI I BASHKISE

BESNONAJAZI



DREJTORI
DREJTORIA E PLANIFIKIMIT
TE TERRITORIT

ING. ORGENT ÇONIKU

PUNOI

ING. EDION SHTYLLA
Ark. AMARILDO KARAJ

LEGJENDE:

TUB PE d32mm 

Vije Kanali i Ri: 

Tombino d800mm: 

Emri i bashkisë:
Bashkia Gramsh



Emri i objektit:
Rehabilitimi i rrugeve Pishaj

Skala e planimit:
PLANIMETRIK (FU)

Skala e shprehjes:
1:100

Nr. i fletës:
G-1

Shenimi:



MIRATOHET

KRYETARI I BASHKISE

DESION AJAZI





**DREJTORI
DREJTORIA E PLANIFIKIMIT
TE TERRITORIT**

ING. ORGENT ÇONIKU

PUNOI

ING. EDION SHTYLLA
Ark. AMARILDO KARAJ

LEGJENDE:

- TUB PE d32mm 
- Vije Kanali i Ri: 
- Tombino d800mm: 

Investori:
Bashkia Gramsh



Projekti:
Rehabilitimi i rrugeve Pishqj

Emri timi i fletës:
FLANIM BIRIAFU

Skalla:
1:500

Nr. fletës:
G 2

S. enime:

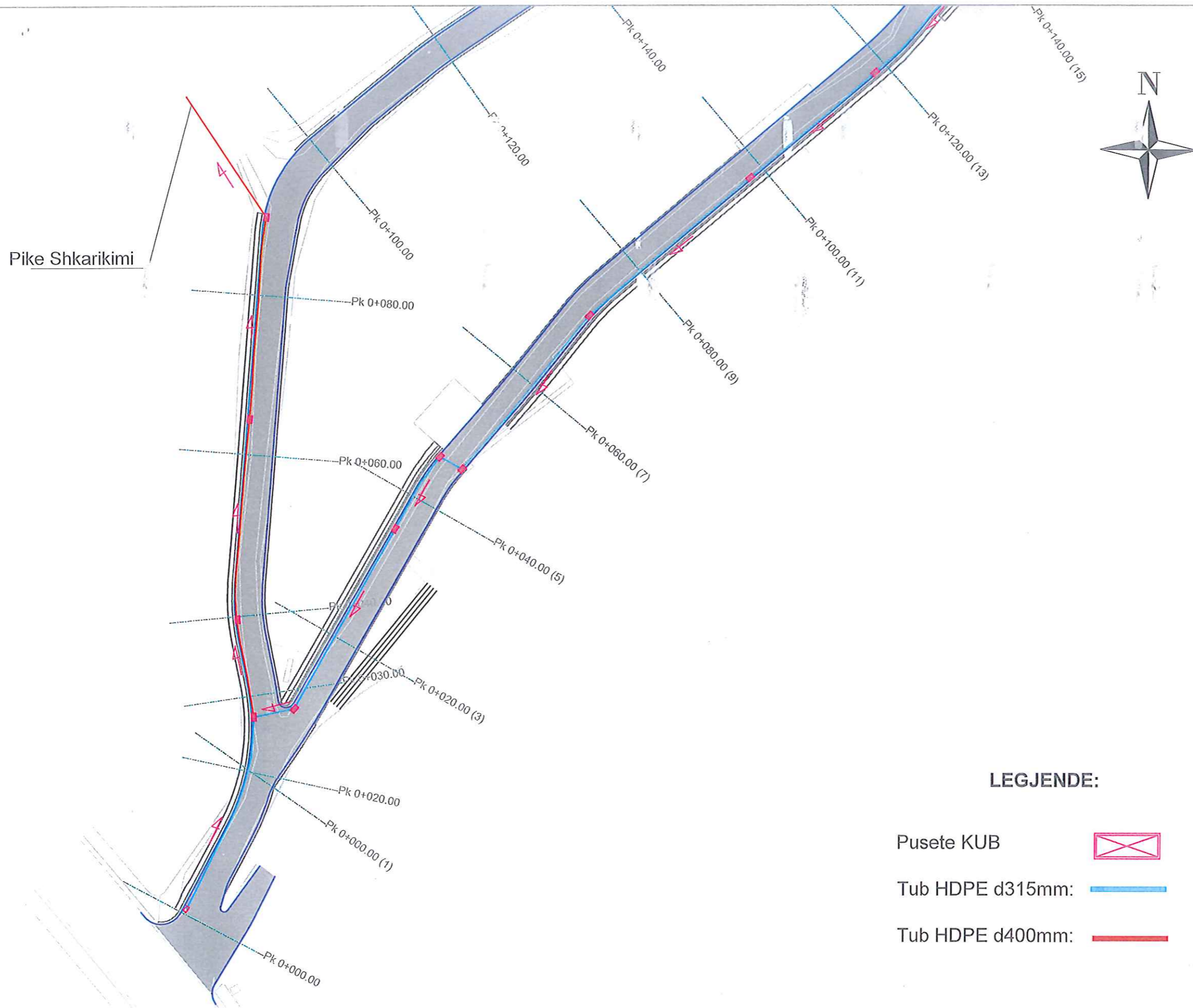

MIRATOHET
 KRJETARI I BASHKISE
 BESION AJAZI
 DREJTORI
 DREJTORIA E PLANIFIKIMIT
 TE TERRITORIT

ING. ORGENT ÇONIKU
 ING. EDION SHTYLLI
 Ark. AMARILDO KARAJ

- LEGJENDE:**
- Pusete KUB 
 - Tub HDPE d315mm: 
 - Tub HDPE d400mm: 

Investitor: Bashkia Grams	Projekti: Rehabilitimi i rrugeve te ishaj	Niveli i punimit: PLANIMETRIA KUSH	Shkalla: 1:500	Nr i fletes: H-1	Shenime:
-------------------------------------	---	--	--------------------------	----------------------------	----------

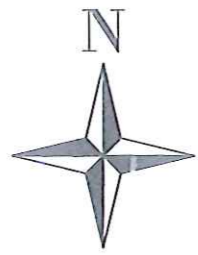

MIRATOHET
KRYETARI BASHKISE
BESION AJAZI

DREJTORI
DREJTORIA E PLANIFIKIMIT
TE TERRITORIT

ING. ORGENT ÇONIKU

PUNOI

ING. EDION SHTYLLA
Ark. AMARILDO KARAL

LEGJENDE:

- Pusete KUB
- Tub HDPE d315mm:
- Tub HDPE d400mm:

Investitori:
Bashkia Gramsh

Projekti:
Rrëfshë dhe Pishaj

Emri i fletës:
PLANIMETRIA KUSH

Shkala:
1:500

Vrëfshja:
H

Shënimet:

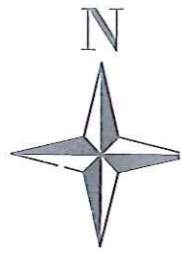

LEGJENDE:

- Pusete KUB 
- Tub HDPE d315mm: 
- Tub HDPE d400mm: 

MIRATOHET
KRYETARI I BASHKISE
BEË ION AJAZI

DREJTORI
DREJTORIA E PLANIFIKIMIT
TE TERRITORIT

ING. ORGENT ÇONIKU



PUNOI

ING. EDION SHTYLLA 
Ark. AMARILDO KARAJ 

investitor:
Bashkia e Gramsh

objekti:
Rehabilitimi i rrugëve Pish i

Emërtimi i fletës:
PLANIMETRIJA KUSH

Skalë:
1:500

Nr. fletës:
H-2

Shenime:



MIRATOHET
 KRYETARI I BASHKISE
 BESION AJAZI
 DREJTORI
 DREJTORIA E PLANIFIKIMIT
 TE TERRITORIT



ING. ORGENT ÇONIKU

PUNOI

ING. EDION SHTYLLA
 Ark. AMARILDO KARAL

LEGJENDE:

- Pusete Kontrolli BA
- Tub HDPE d315mm:
- Tub HDPE d400mm:
- Grope Septike 4x2x2.5m

© 2023 Microsoft Corporation © 2023 Maxar © CNES (2023) Distributi

Investori: Bashkia Gramsh	Projekti: Rehabilitimi i rrugeve pishaj	Emertimi i fletës: PLANIMETRIA KUZ	Skala'le: 1:500	Nr i fletës: 1	Shenime:
------------------------------	--	---------------------------------------	--------------------	-------------------	----------

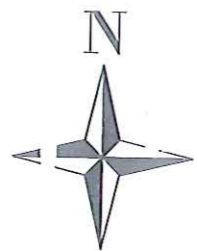

MIRATOHET
KRYI TARI BASHKISIA
BESION AJAZI





DREJTORI
DREJTORIA E PLANIFIKIMIT
TE TERRITORIT

ING. ORGENT ÇONIKU

PUNOI

ING. EDION SHTYLLA
Ark. AMARILDO KARAJ

LEGJENDE:

- Pusete Kontrolli BA 
- Tub HDPE d315mm: 
- Tub HDPE d400mm: 
- Grope Septike 4x2x2.5m 

Ir. i stitortit: Bashkia Gramsh 	Projet i: Rehat. lirim i rrugave dhe Pisl. a	Emertimi i nates: PLANIMETRIA KUZ	Sh. i alla: 1.500	Nr i lejes: I-2	Shenime
--	---	--------------------------------------	----------------------	--------------------	---------

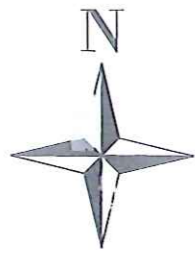

MIRATOHET
KRYETARI I BASHKISE
BESION AJAZI

DREJTORI
DREJTORIA E PLANIFIKIMIT
TE TERRITORIT
ING. ORGENT ÇONIKU

PUNOI
ING. EDION SHTYLLA
Ark. AMARILDO KARAJ

LEGJENDE:

- Pusete Kontrolli BA
- Tub HDPE d315mm:
- Tub HDPE d400mm:
- Grope Septike 4x2x2.5m

Inve:titori:
Bashkia Gramsh

Proje ti:
Rehabilitimi i rrugeve bashaj

Emri i ri i fletes:
F ANIMETRIA KUZ

Shkëlq: **1:500**

Numri i fletës: **1-2**

Sheqimi:

MUR TIPI A1 (H=1.5m)
SH 1:50



TABELA E VOLUMIT TE BETONIT PER MURIN ME H=1.5m PER 1 ML

NR	ELEMENTI	SIPERFAQJA	SASIA	GJATESIA (SPESORI)	VOLUMI total
		m ²	Cope	m	m ³
1	BETON C7/10	0.08	1	1	0.08
2	BETON C25/30	1.3	1	1	1.30

TABELA E SPECIFIKIMIT TE HEKURIT PER MURIN ME H=1.5 m PER 1 ML

MURI	POZICIONI	DIAMETRI Ø (mm)	GJATESIA A L (cm)	Cope	GJATESIA Ltotal (m)	TOTALE			
						DIAMETRI I Ø (mm)	Ltot (m)	Pesha/ml	Pesha (kg)
1	12	230	5	11.50	8	17.50	0.395	6.91	
2	12	230	5	11.50	12	77.00	0.888	69.38	
3	12	100	33	33.00	14	-	1.210	-	
4	8	70	7	4.90					
5	8	180	7	12.60					
6	12	210	10	21.00					
TOTALE (kg)									75.29

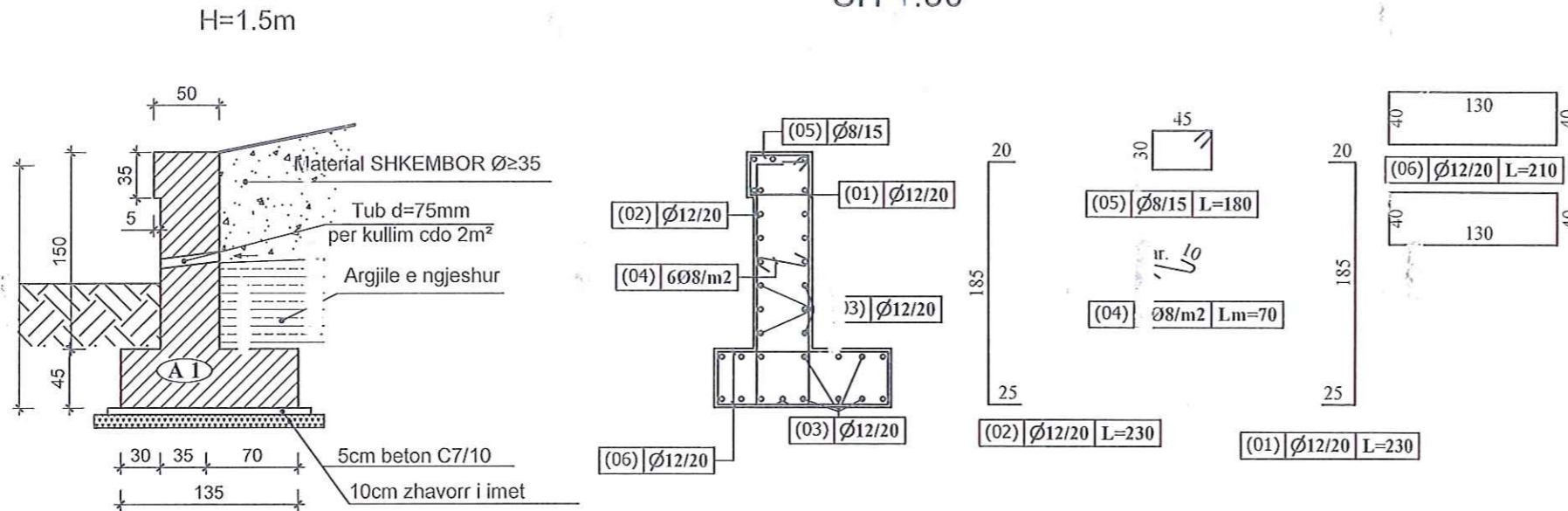
SHENIME:

- Muret jane projektuar me beton C25/30 pergatitur me cemento antisulfat, armatura e hekurit e tipit S-500s.
- Mbushja mbrapa mureve duhet te behet me material me kend te ferkimit te brendshem $\geq 35^\circ$.
- Ankorimi dhe xhuntimi i hekurave do te behet me mbivendosje te tyre jo me pak se 50Ø.
- Cepat e betonit qe jane te ekspozuar duhet te rumbullakosen me rreze $r=20\text{mm}$.
- Ne rastet e perdorimit te larteseve ndermjetese per permasat e betonit dhe sasine e armatures se hekurit duhet te aplikohen ato te larteseve me te madhe te afert.
- Faqet e betonit te armuar ne kontakt me dheun duhet te lyhen me tre duar bitum te nxehte.
- Ne rastet e bazamenteve prej dherash shtresa e betonit te varfer 5cm, vendoset mbi nje shtrese prej 10cm zhavorri te imet. Ne rastet e tabaneve shkembor e gjysem shkembor shtresa e zhavorrit nuk eshte e nevojshme.
- Te realizohen fuga 4-5 cm cdo 12-15 ml gjatesi muri
- Themeli i murit te vendoset ne nje thellesi te atille qe te sigurohet nga rreshqitja (Sipas rekomandimeve te Inxhinierit Rezident).
- Perpara ndertimit, te konfirmohen parametrat e shenimeve teknike.
- Ne rast se verehen ndryshime te tyre, te njoftohet Njesia e Projektimit.

MIRATOHET
KRYETARI I KONSILIT
BESION AJAZI

DREJTORI
DREJTORIA E PLANIFIKIMIT
TE TERRITORIT

ING. ORGENT ÇONIKU

PUNOI

ING. EDION SHTYLLA
Ark. AMARILDO KARAJ

Investitori:

Bashkia Gramsh



Projekti:

Rehabilitimi i rrugës në Pishaj

Emertimi i fletës:

DETAJE
MUR IBAJTES

Skalla:

1:50

Nr i fletës:

L-1

Shenime:

MUR TIPI A2 (H=2.0m)
SH 1:50



TABELA E VOLUMIT TE BETONIT PER MURIN ME H=2m PER 1 ML

NR	ELEMENTI	SIPERFAQJA	SASIA	GJATESIA (SPESORI)	VOLUMI total
		m ²	Cope	m	m ³
1	C7/10	0.08	1	1	0.08
2	C25/30	1.62	1	1	1.62

TABELA E SPECIFIKIMIT TE HEKURIT PER MURIN ME H=2 m PER 1 ML

MURI	POZICIONI	DIAMETRI ϕ (mm)	GJATESIA A L (cm)	Cope	GJATESIA Ltotal (m)	TOTALE			
						DIAMETRI I ϕ (mm)	Ltot (m)	Pesha/ml	Pesha (kg)
1	14	290	5	14.50	8	19.60	0.395	7.74	
2	12	280	5	14.00	12	55.00	0.888	49.84	
3	12	100	41	41.00	14	37.50	1.210	45.38	
4	8	70	10	7.00					
5	8	180	7	12.60					
6	14	230	10	23.00					
TOTALE (kg)									101.96

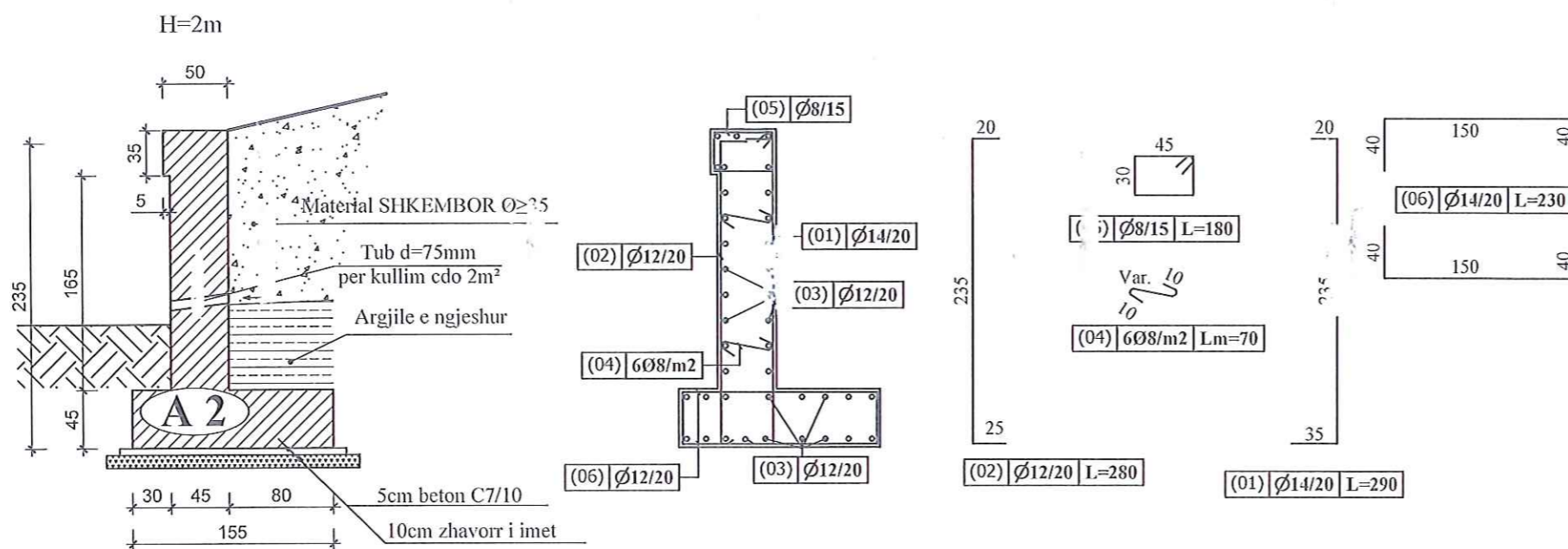
SHENIME:

- Muret jane projektuar me beton C25/30 pergatitur me cimento antisulfat, armatura e hekurit e tipit S-500s.
- Mbushja mbrapa mureve duhet te behet me material me kend te ferkimit te brendshem $\phi \geq 35^\circ$.
- Ankorimi dhe xhuntimi i hekurave do te behet me mbivendosje te tyre jo me pak se 50Ø.
- Cepat e betonit qe jane te ekspozuar duhet te rrumbullakosen me rreze $r = 20\text{mm}$.
- Ne rastet e perdorimit te lartesisve ndermjetese per permasat e betonit dhe sasine e armatures se hekurit duhet te aplikohen ato te lartesisve me te madhe te afert.
- Faqet e betonit te armuar ne kontakt me dheun duhet te lyhen me tre duar bitum te nxehte.
- Ne rastet e bazamenteve prej dherash shtresa e betonit te varfer 5cm, vendoset mbi nje shtrese prej 10cm zhavorri te imet. Ne rastet e tabaneve shkembor e gjysem shkembor shtresa e zhavorrit nuk eshte e nevojshme.
- Te realizohen fuga 4-5 cm cdo 12-15 ml gjatesi muri
- Themeli i murit te vendoset ne nje thellesi te atille qe te sigurohet nga rreshqitja (Sipas rekomandimeve te Inxhinierit Rezident).
- Perpara ndertimit, te konfirmohen parametrat e shenimeve teknike.
- Ne rast se verehen ndryshime te tyre, te njoftohet Njesia e Projektimit.



DREJTORI
DREJTORIA E PLANIFIKIMIT
TE TERRITORIT

ING. ORGENT ÇONIKU

PUNOI

ING. EDION SHTYLLA
Ark. AMARILDO KARAJ

PUSETE TIP D=100cm
PER TUBA

PRERJA 1-1

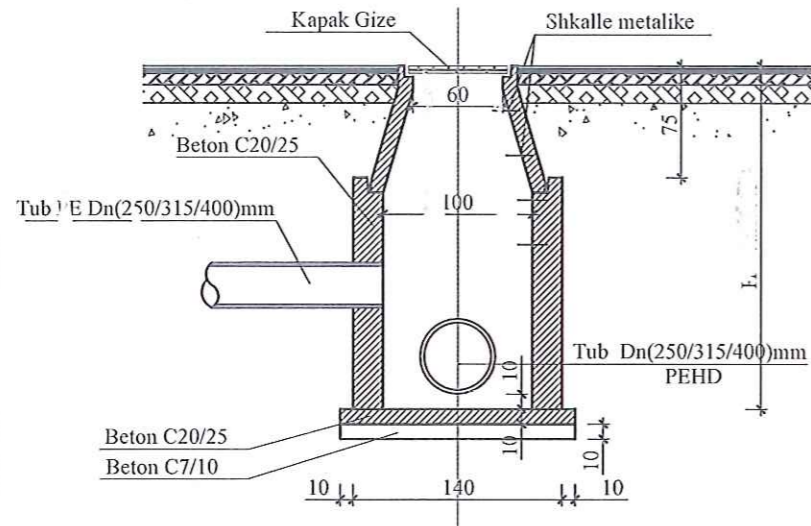

PLAN

PRERJA 2-2

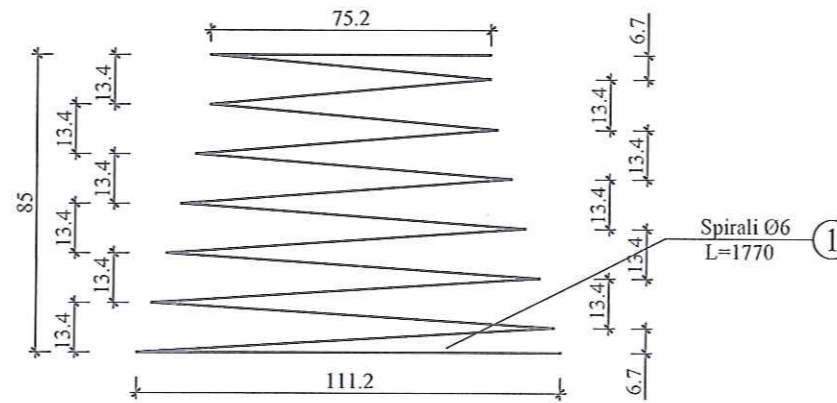
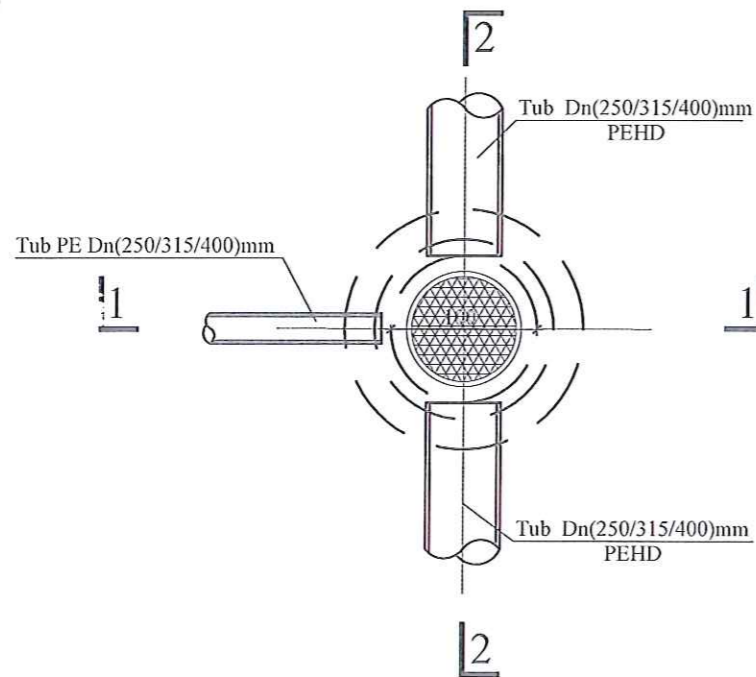
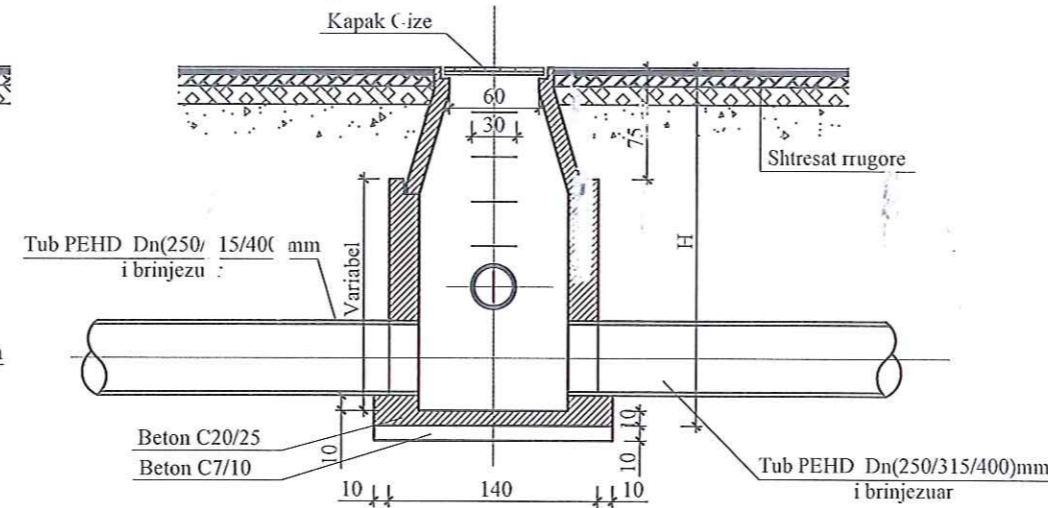

SPIRALI I BRENDESHEM

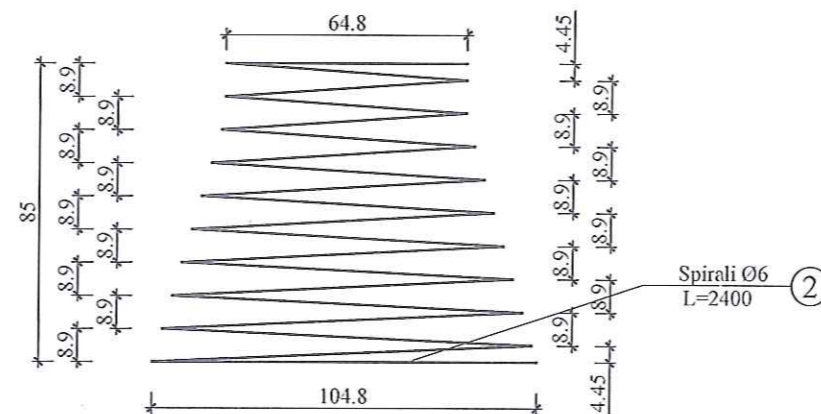

MIRATOHET
KRYETARI I BASHKISE
BESHIA AJAZI

DREJTORI
DREJTORIA E PLANIFIKIMIT
TE TERRITORIT

ING. ORGENT ÇONIKU

PUNOI

ING. EDION SHTYLLI
Ark. AMARILDO KARAJ

Investitori:

Bashkia Gramsh



Fojet:

Rrëmbajtja e rrugëve Pishaj

Emertimi i letes:

DETAJ
PUSETA KUZ

Skalë:

1:5

Niveli i letes:

L-3

Sheqimi:

PRERJE TERTHORE KANALI PER TUBACIONET K.U.SH SH 1:25

Tul acic i PEHD i brinjezuar D 315 mm

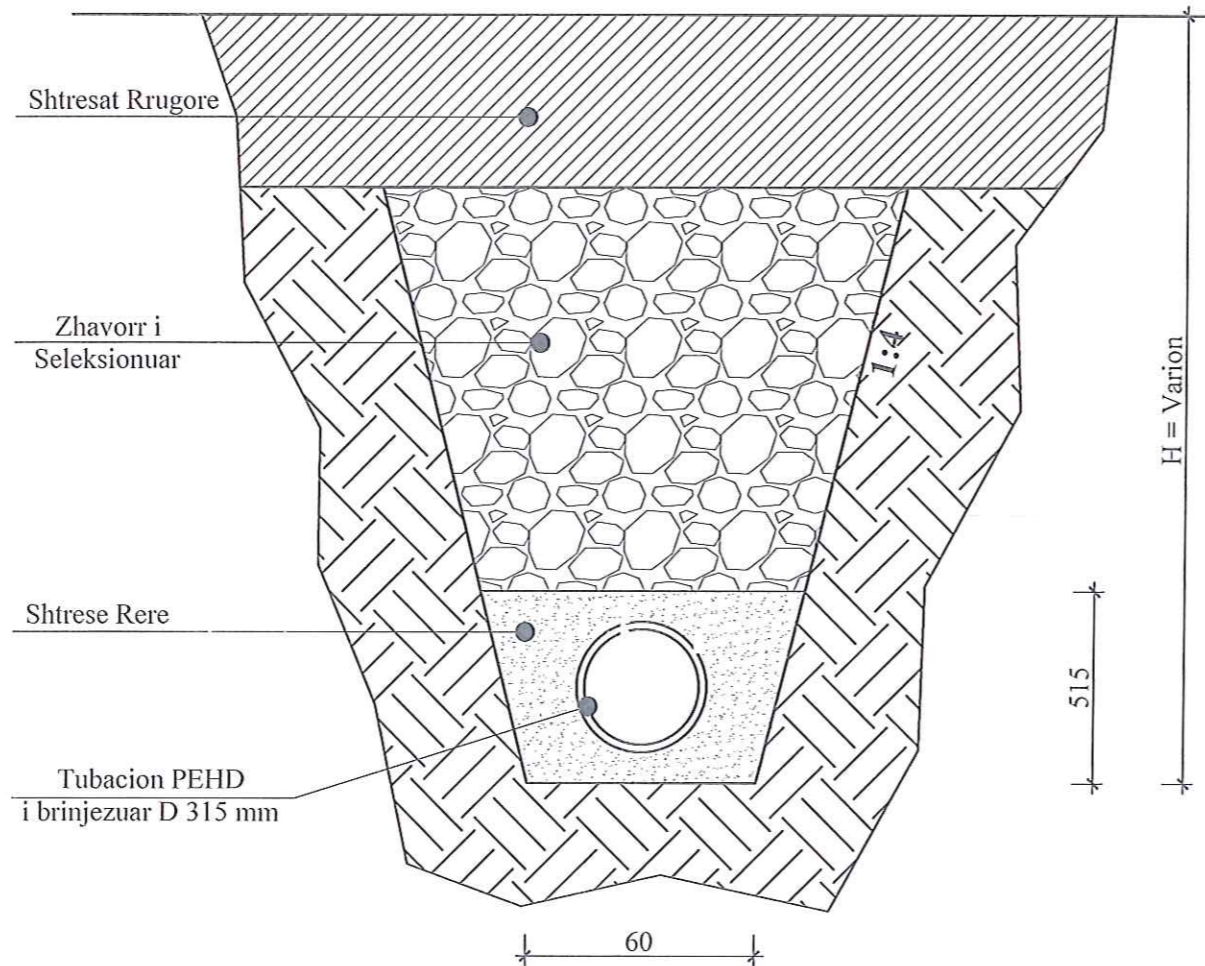

MIRATOHET
 PËRZYETARI I BASHKISE
 BESIONIAJAZI

DREJTORI
 DREJTORIA E PLANIFIKIMIT
 TE TERRITORIT

ING. ORGENT ÇONIKU

PUNOI

ING. EDION SHTYLLA
 Ark. AMARILDO KARAJ

Investitori: Bashkia Gramsh	Fojetk i: Rrethi i rrugeve F ishaj	Emertimi i fletes: DE TAJE TUBACION KUSH	Shkalla: 1:25	Ni fletes: L-4	Shejme:
--------------------------------	---------------------------------------	--	------------------	-------------------	---------

Section C-C

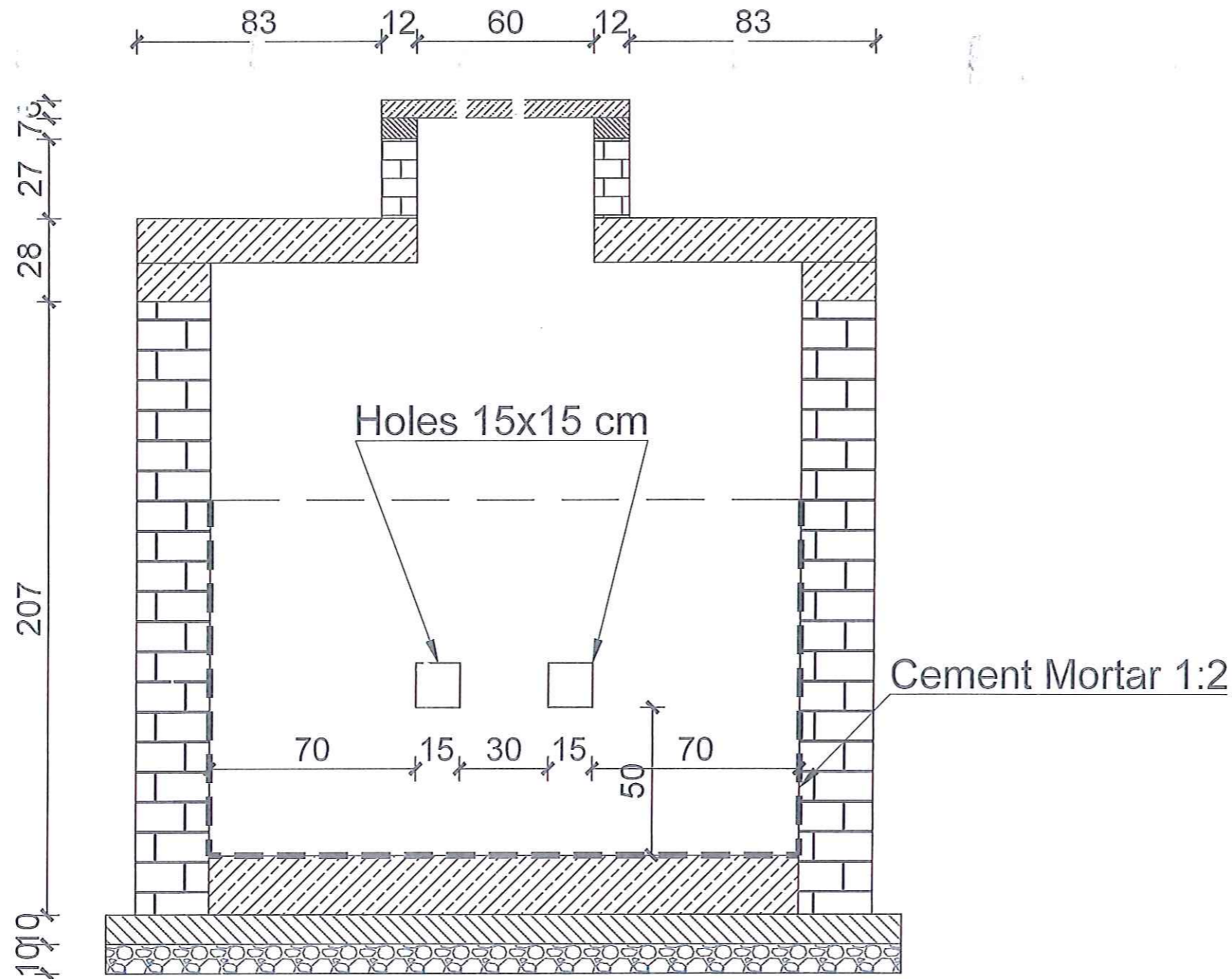

MIRATOHET
 KRYETARI I BASHKISE
 BESION AJAZI

DREJTORI
 DREJTORIA E PLANIFIKIMIT
 TE TERRITORIT

ING. ORGENT ÇONIKU

PUNOI

ING. EDION SHTYLLA
 Ark. AMARILDO KARAJ

Investitori: Bashkia e Gramsh	Projekti: Rindërtimi i rrugëve Pishaj	E. rërtimi i letës: DETAJE GROPA SEPTIKE	Shkallë: 1:40	Nr i fletës L-5	Shenime
----------------------------------	--	--	------------------	--------------------	---------

Septic Tank - Discharge Point 3

R/C Slab

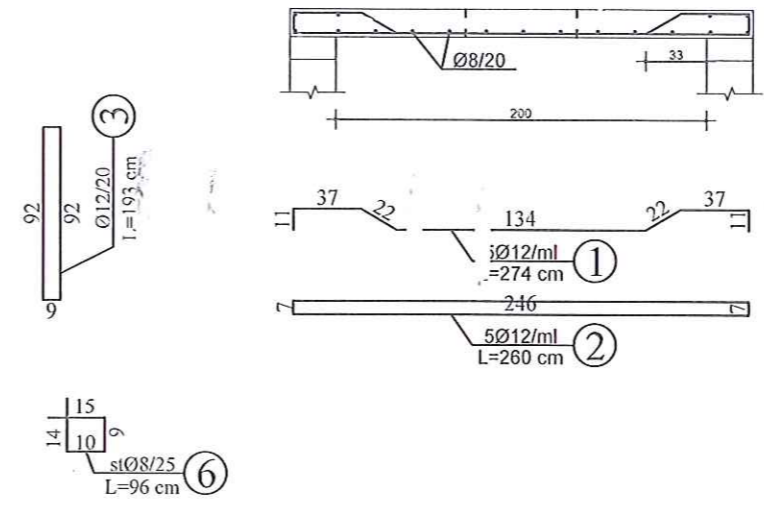
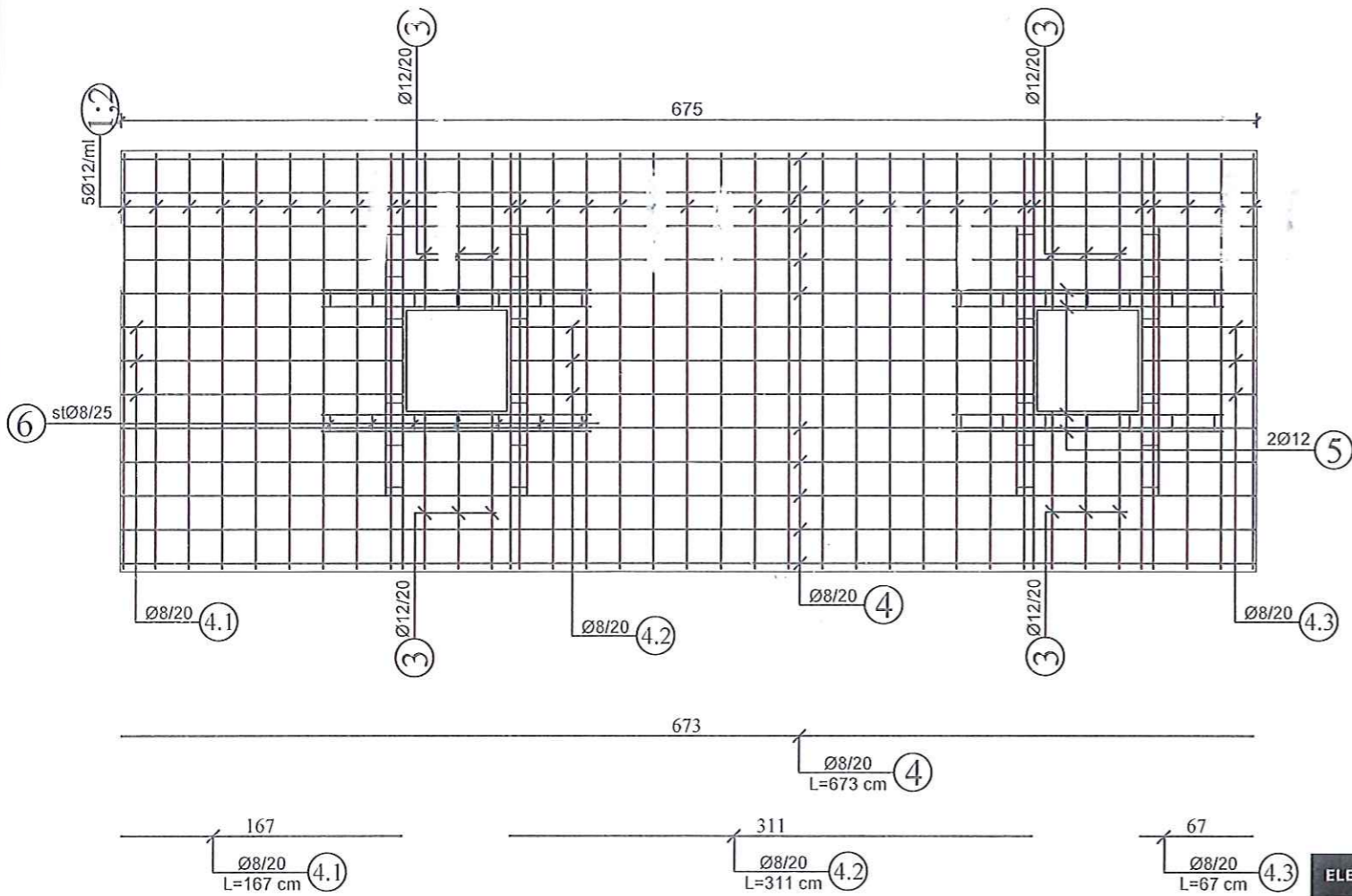

R/C Cover

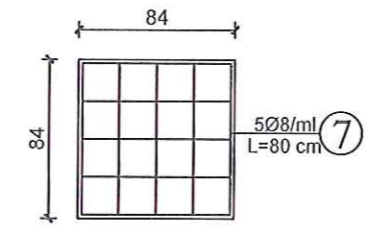

ELEMENTI		SPECIFIKIMI I ARMATURES					SPECIFIKIMI I ELEMENTIT			TOTALI (KG)
Tipi	Cop	Poz	φ	l (cm)	cope	L (m)	φ	ΣLtot(m)	Pesha (per kg)	
1		1	12	274	33	90.42	6	0	0.222	0
		2	12	260	33	85.8	8	180	0.395	71
		3	12	193	12	23.16	10	0	0.617	0
		4	8	673	14	94.22	12	251	0.888	222
		4.1	8	167	3	5.01	14	0	1.208	0
		4.2	8	311	3	9.33	16	0	1.578	0
		4.3	8	67	3	2.01	18	0	1.998	0
		5	12	160	32	51.2	20	0	2.466	0
		6	8	96	56	53.76	22	0	2.984	0
		7	8	80	20	16	24	0	3.551	0
					0	25	0	3.853	0	
					0	0	0			
					0	0	0			
									294	

Technical notes:

- The septic tank is built with a full brick wall 25cm with mortar
- The floor and walls of the pit are plastered with 1: 2 cement mortar.
- The septic tank is covered with R/C slab C25 / 30. (In the slab are left two holes 60x60 that serve for the control of the pit. On the holes left in the slab there is built a full brick wall 12cm with mortar M30. covered with lid R/C C25 / 30 (see project)).
- For all works to apply the technical conditions of construction.

MIRATOHET
 KRYETAR I BASHKISE
 BLSIC N AJAZI

DREJTORI
 DREJTORIA E PLANIFIKIMIT
 TE TERRITORIT

ING. ORGENT ÇONIKU

PUNOI

ING. EDION SHTYLLA
 Ark. AMARILDO KARAJ

ELEMENT BËGON

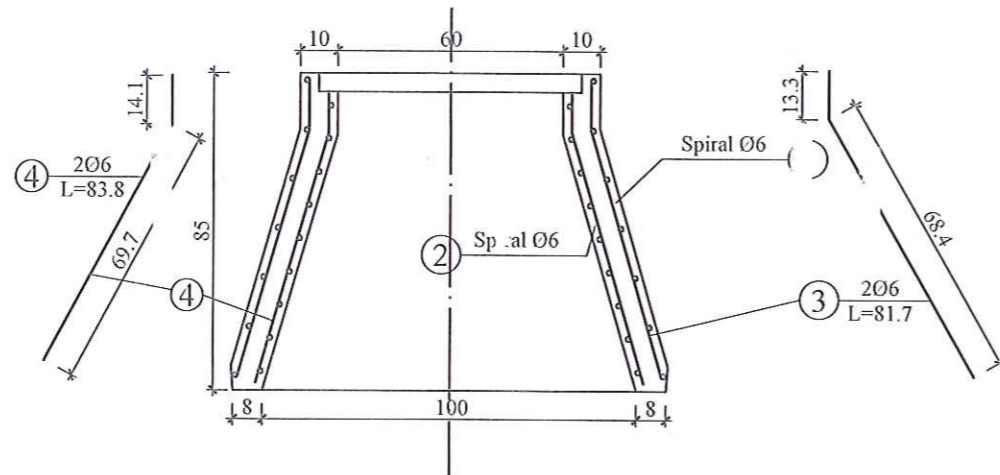

PLAN

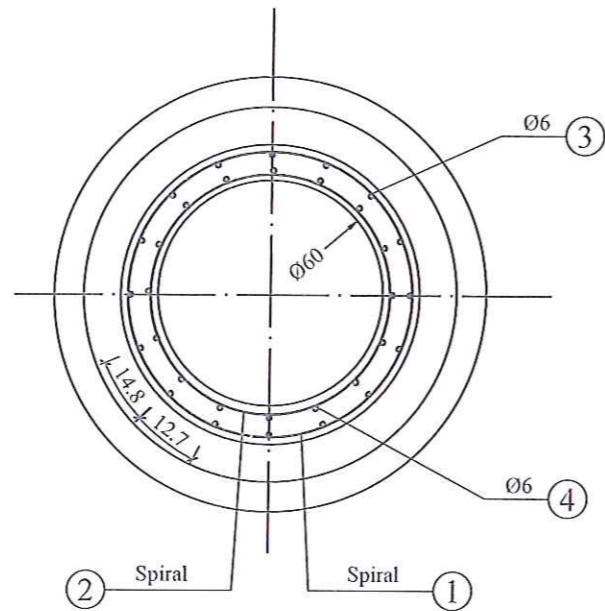

MIRATOHET

KI YETARËTË SHKËSIE

BESION AJAJ

DREJTORI
DREJTORIA E PLANIFIKIMIT
TE TERRITORIT

ING. ORGENT ÇONIKU

PUNOI

ING. EDION SHTYLLA

Ark. AMARILDO KARAJ

Investitori:

Bashkia Gramsh



Projekti:

Rehabilitimi i rrugëve Pishaj

E rrethit i fletës:

DELTA I E.
PUSETA KUIZ

Shkalla:

1:50

Fletës:

L-3

Sheqer