



**REPUBLIKA E SHQIPËRISË
BASHKIA BERAT**

**MIRATOHET
KRYETARI I BASHKISE
PETRIT SINAJ**

PROJEKT ZBATIMI

**OBJEKTI: NDRIÇIMI I RRUGËVE NË FSHATIN DUSHNIK,
NJËSIA ADMINISTRATIVE OTLLAK, BASHKIA BERAT**

PUNOI:

INXHINIER	VALENTINA KARABINA
ARKITEKT	MIRJAN BREGU
INXHINIER	GERALDO SULI
INXHINIER	ANDI SHEME
TEK	FLAMUR TOSKA

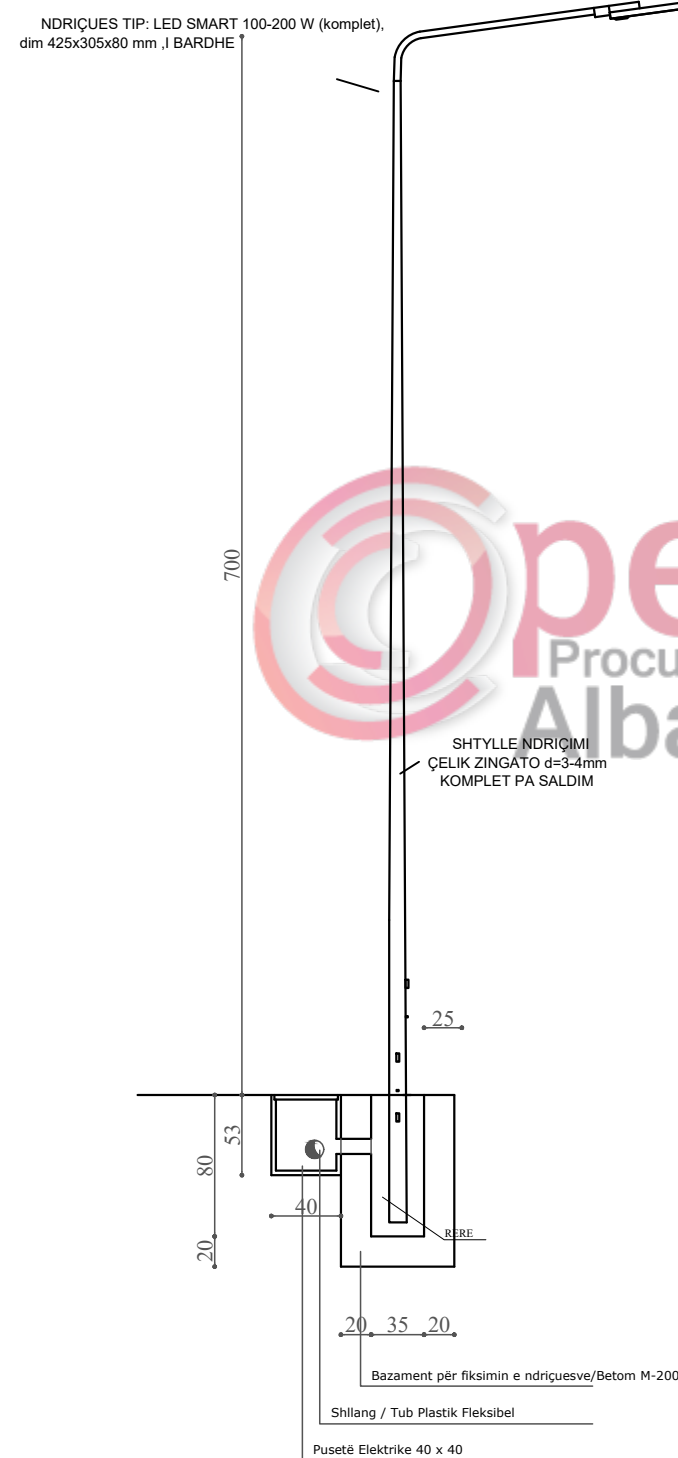

NDRICUES LED 50 W - 120 W



SHËNIME PER NDRICUESIN:

- Input Voltage(V) 230v AC
- Color Temperature(CCT) 5000-6500k
- Luminous Flux (lumen) 5000 - 8000
- Lighting Color Cool White
- Certification CE
- IP Rating IP66
- Application Street Light
- Surge Protection 5kv
- Lifetime 50000 hours
- Protections IP 66
- Power W 50W - 120 W
- Driver Efficiency 85
- Product Code MLEDSL50PC
- Brand MATADOR
- Lumens 5000
- Body Material ALUMINIUM
- Lighting Type LED
- Optical Cover PC
- Led Make Osram/philips
- Led Beam Angle 120degree
- Cri 80
- LED Street Light
- Pressure Die Cast aluminium Housing
- Polycarbonate Transparent Diffuser
- weather Proof: IP 66
- Silicon GASKet, SS hardware
- MCPCB, with 1W LED Osram
- High efficiency LED Driver with PF>0.9
- SPD>5kv

OBJEKTI: NDRIÇIMI I RRUGËVE NË FSHATIN DUSHNIK,
NJËSIA ADMINISTRATIVE OTLLAK,BASHKIA BERAT

PUNOI:

INXHINIER	VALENTINA KARABINA
ARKITEKT	MIRJAN BREGU
INXHINIER	GERALDO SULI
INXHINIER	ANDI SHEME
TEK	FLAMUR TOSKA

PLANNIMETRI E PËRGJITHSHME

SH. 1 - 5000

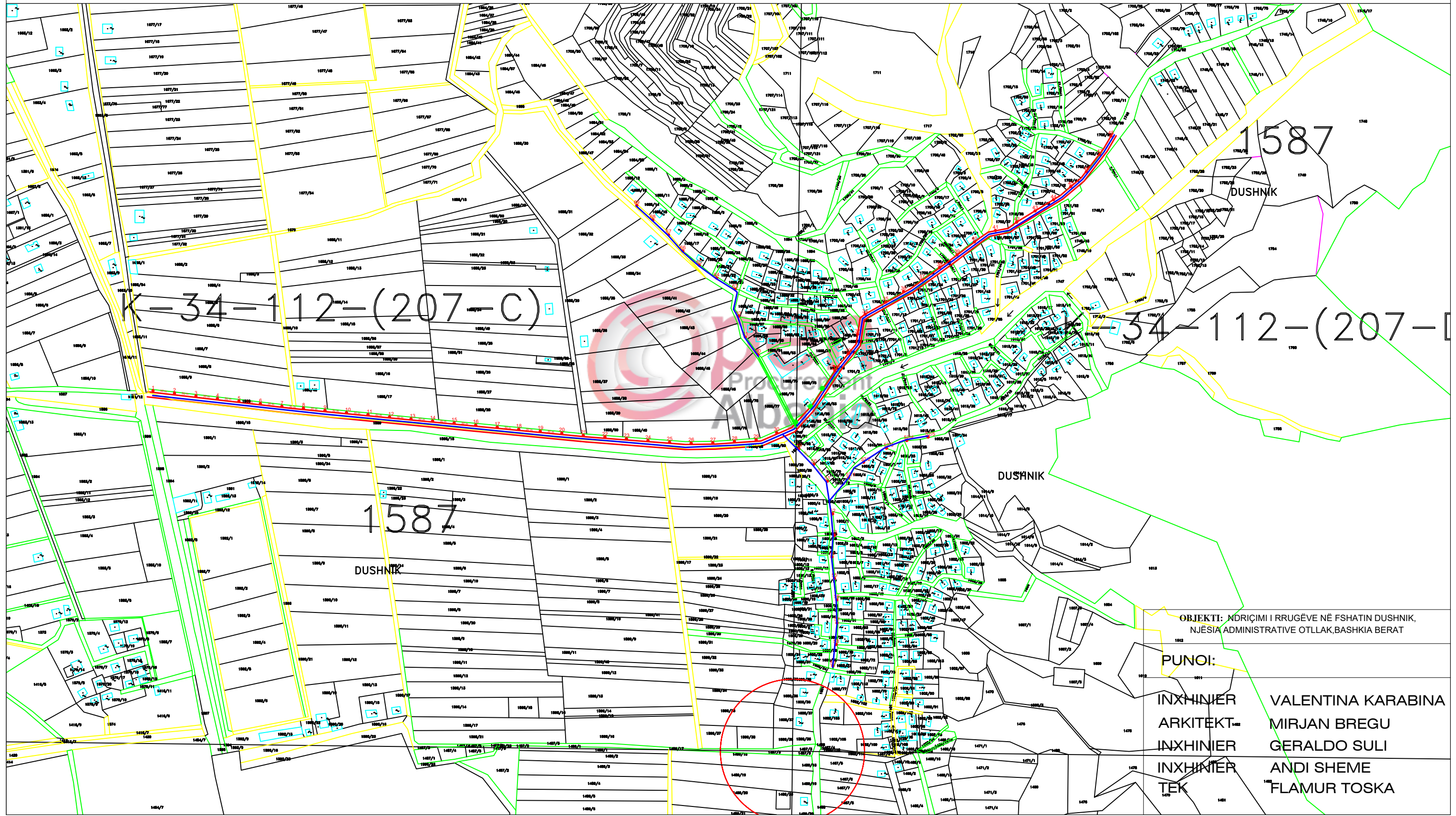

OBJEKTI: NDRICIMI I RRUGËVE NË FSHATIN DUSHNIK,
NJËSIA ADMINISTRATIVE OTLLAK, BASHKIA BERAT

PUNOI:

INXHINIER	VALENTINA KARABINA
ARKITEKT	MIRJAN BREGU
INXHINIER	GERALDO SULI
INXHINIER	ANDI SHEME
TEK	FLAMUR TOSKA

PLANNIMETRI TË PJESSHME

SH. 1 - 2000

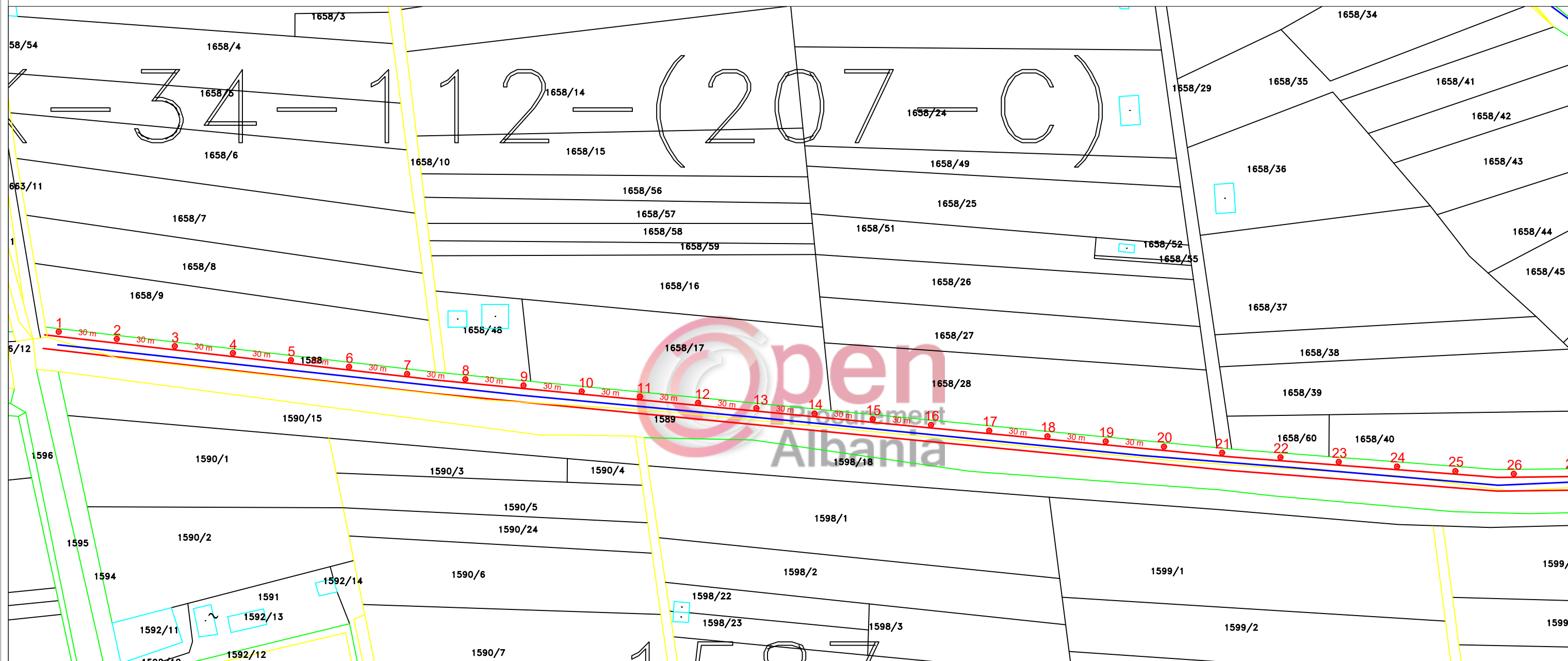

OBJEKTI: NDRIÇIMI I RRUGËVE NË FSHATIN DUSHNIK,
NJËSIA ADMINISTRATIVE OTLLAK, BASHKIA BERAT

PUNOI:

INXHINIER	VALENTINA KARABINA
ARKITEKT	MIRJAN BREGU
INXHINIER	GERALDO SULI
INXHINIER	ANDI SHEME
TEK	FLAMUR TOSKA

PLANNIMETRI TË PJESSHME

SH. 1 - 2000

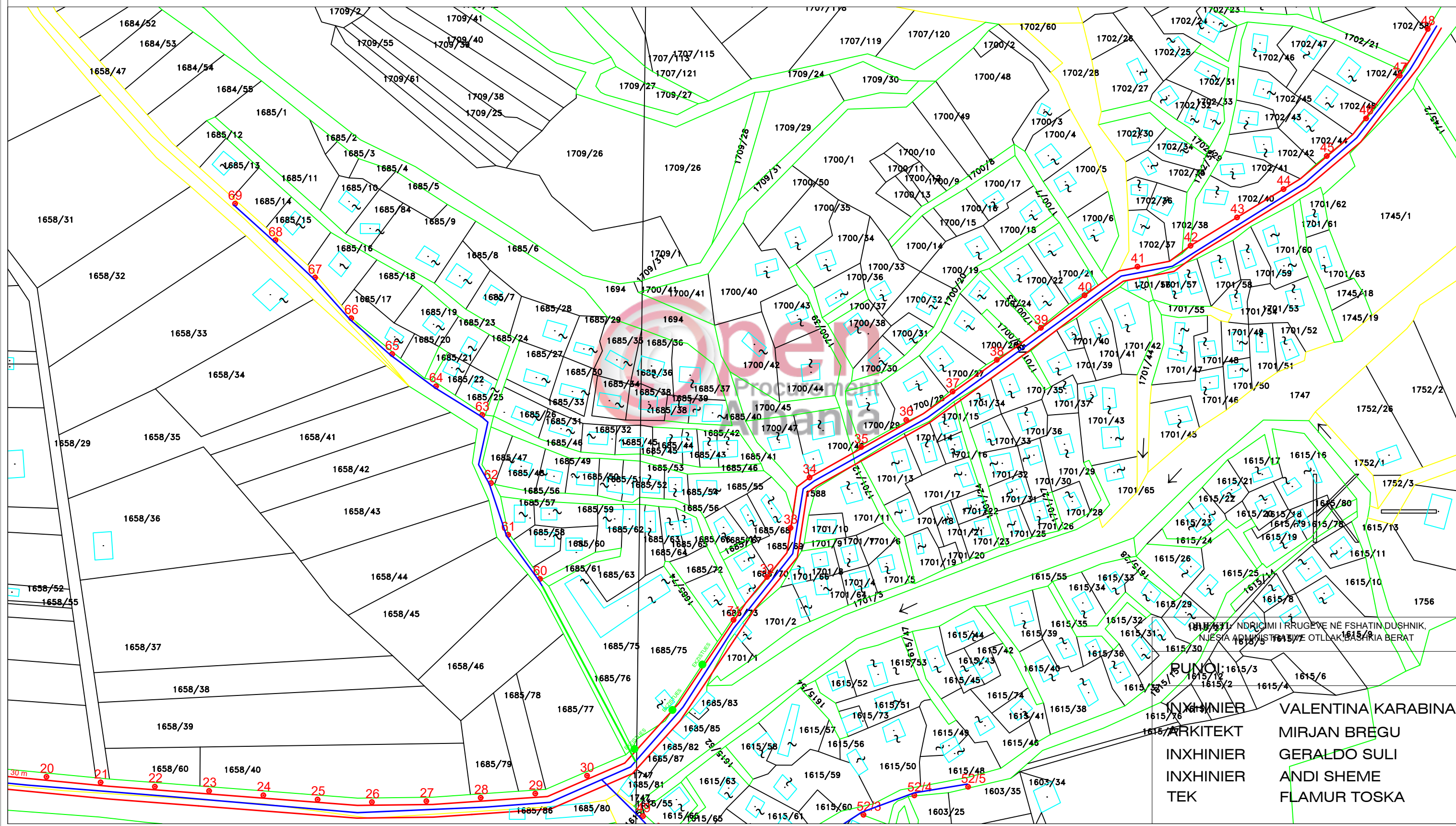

NDICIMI I RRUGËVE NË FSHATIN DUSHNIK,
NJËSIA ADMINISTRATIVE OTLLAKI BASHKIA BERAT

RUNOJ: 1615/3, 1615/4, 1615/5, 1615/6, 1615/7, 1615/8, 1615/9, 1615/10, 1615/11, 1615/12, 1615/13, 1615/14, 1615/15, 1615/16, 1615/17, 1615/18, 1615/19, 1615/20, 1615/21, 1615/22, 1615/23, 1615/24, 1615/25, 1615/26, 1615/27, 1615/28, 1615/29, 1615/30, 1615/31, 1615/32, 1615/33, 1615/34, 1615/35, 1615/36, 1615/37, 1615/38, 1615/39, 1615/40, 1615/41, 1615/42, 1615/43, 1615/44, 1615/45, 1615/46, 1615/47, 1615/48, 1615/49, 1615/50, 1615/51, 1615/52, 1615/53, 1615/54, 1615/55, 1615/56, 1615/57, 1615/58, 1615/59, 1615/60, 1615/61, 1615/62, 1615/63, 1615/64, 1615/65, 1615/66, 1615/67, 1615/68, 1615/69, 1615/70, 1615/71, 1615/72, 1615/73, 1615/74, 1615/75, 1615/76, 1615/77, 1615/78, 1615/79, 1615/80, 1615/81, 1615/82, 1615/83, 1615/84, 1615/85, 1615/86, 1615/87, 1615/88, 1615/89, 1615/90, 1615/91, 1615/92, 1615/93, 1615/94, 1615/95, 1615/96, 1615/97, 1615/98, 1615/99, 1615/100, 1603/25, 1603/26, 1603/27, 1603/28, 1603/29, 1603/30, 1603/31, 1603/32, 1603/33, 1603/34, 1603/35, 1603/36, 1603/37, 1603/38, 1603/39, 1603/40, 1603/41, 1603/42, 1603/43, 1603/44, 1603/45, 1603/46, 1603/47, 1603/48, 1603/49, 1603/50, 1603/51, 1603/52, 1603/53, 1603/54, 1603/55, 1603/56, 1603/57, 1603/58, 1603/59, 1603/60, 1603/61, 1603/62, 1603/63, 1603/64, 1603/65, 1603/66, 1603/67, 1603/68, 1603/69, 1603/70, 1603/71, 1603/72, 1603/73, 1603/74, 1603/75, 1603/76, 1603/77, 1603/78, 1603/79, 1603/80, 1603/81, 1603/82, 1603/83, 1603/84, 1603/85, 1603/86, 1603/87, 1603/88, 1603/89, 1603/90, 1603/91, 1603/92, 1603/93, 1603/94, 1603/95, 1603/96, 1603/97, 1603/98, 1603/99, 1603/100.

INXHINIER VALENTINA KARABINA
ARKITEKT MIRJAN BREGU
INXHINIER GERALDO SULI
INXHINIER TEK ANDI SHEME
INXHINIER FLAMUR TOSKA

PLANNIMETRI TË PJESSHME

SH. 1 - 2000

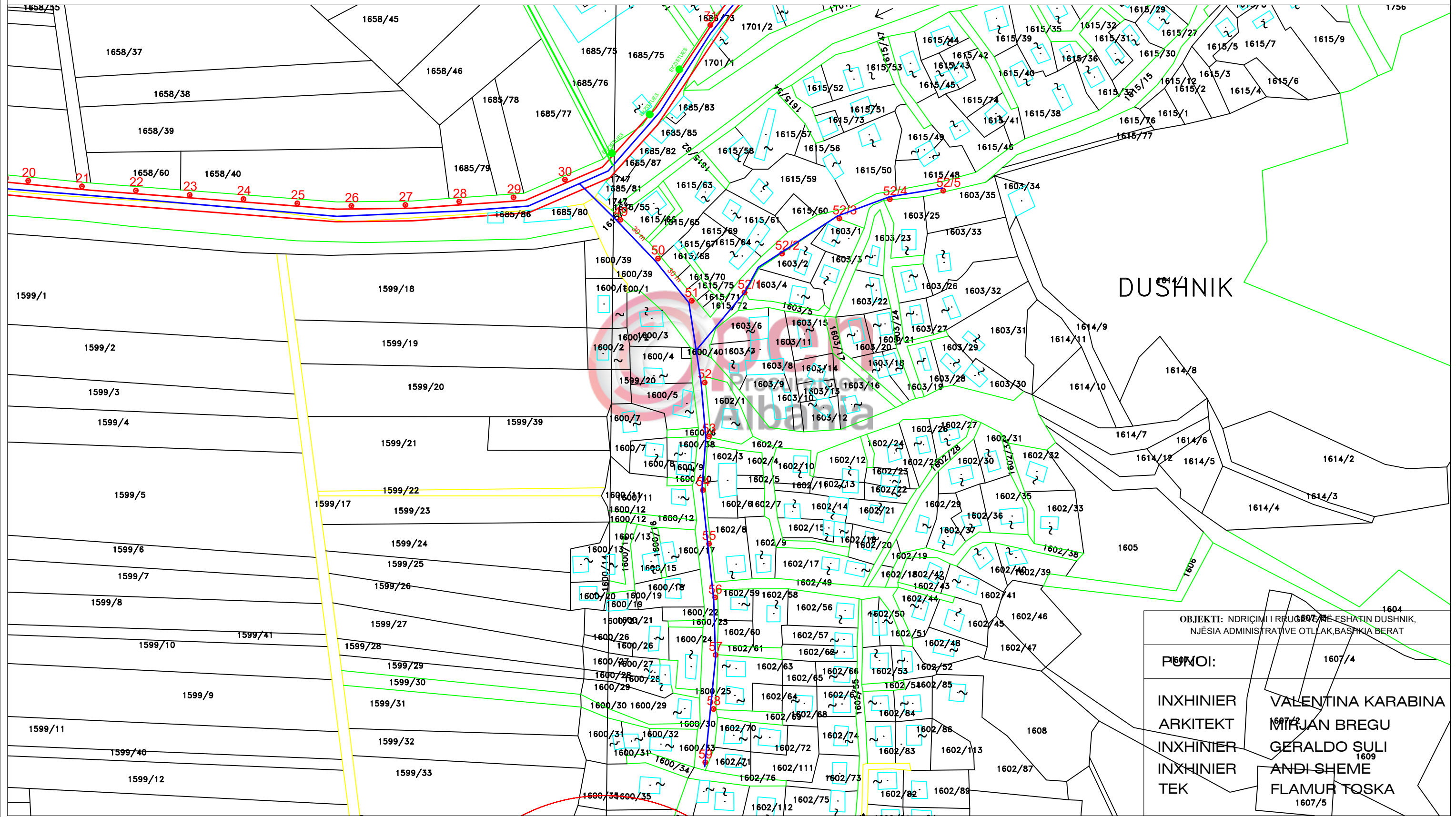

DUSHNIK

OBJEKTI: NDRICIMI I RRUGES NE FSHATIN DUSHNIK,
NJESIA ADMINISTRATIVE OTLLAK, BASHKIA BERAT

PUNOI:	1607/4
INXHIKIER	VALENTINA KARABINA
ARKITEKT	MIRJAN BREGU
INXHIKIER	GERALDO SULI
INXHIKIER	ANDI SHEME
TEK	FLAMUR TOSKA